

Requested By:  
First Centennial - Reno  
Douglas County - NV  
Karen Ellison - Recorder  
Page: 1 of 7 Fee: \$20.00  
BK-911 PG-5372 RPTT: 1981.20



APN: 1418-03-812-001

Escrow No. 00187627 - 001 -  
RPTT \$1,981.20  
When Recorded Return to:  
**Michael Thompson**  
**639 N Frederic St.**  
**Burbank CA 91505**  
Mail Tax Statements to:  
Grantee same as above

SPACE ABOVE FOR RECORDERS USE

**Grant, Bargain, Sale Deed**

**\*\*\*This Document is executed in Counterpart \*\*\***

/ Lawrence O. Irvin who acquired title as  
THIS INDENTURE WITNESSETH: That Larry O. Irvin and Sharon M. Irvin, husband and wife and I-CLAD Investments, LLC, an Arizona limited liability company and Christopher J. Irvin, a married man as his sole and separate property

In consideration of \$10.00, the receipt of which is hereby acknowledged, do(es) hereby Grant, Bargain, Sell and Convey to Michael Thompson and Gloria Thompson, Husband and Wife as joint tenants

all that real property situated in the County of Douglas, State of Nevada, described as follows:

**See Exhibit A attached hereto and made a part hereof.**

Together with all and singular the tenements, hereditaments and appurtenances thereunto belonging or in anywise appertaining.

Witness my/our hand(s) this 21<sup>st</sup> day of September, 2011

I-CLAD Investments, LLC, an Arizona limited liability company

By: Carol Irvin, Managing Member

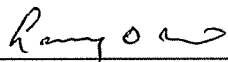
  
\_\_\_\_\_  
Lawrence O. Irvin

  
\_\_\_\_\_  
Sharon M. Irvin

\_\_\_\_\_  
Christopher J. Irvin

**SEE ATTACHED FOR NOTARY ACKNOWLEDGEMENTS**

SPACE BELOW FOR RECORDER



APN: 1418-03-812-001

Escrow No. 00187627 - 001 -  
RPTT \$1,981.20  
When Recorded Return to:  
**Michael Thompson**  
**639 N Frederic St.**  
**Burbank CA 91505**  
Mail Tax Statements to:  
Grantee same as above

SPACE ABOVE FOR RECORDERS USE

**Grant, Bargain, Sale Deed**

**\*\*\*This Document is executed in Counterpart \*\*\***

THIS INDENTURE WITNESSETH: That Larry O. Irvin and Sharon M. Irvin, husband and wife and I-CLAD Investments, LLC, an Arizona limited liability company and Christopher J. Irvin, a married man as his sole and separate property

In consideration of \$10.00, the receipt of which is hereby acknowledged, do(es) hereby Grant, Bargain, Sell and Convey to Michael Thompson and Gloria Thompson

all that real property situated in the County of Douglas, State of Nevada, described as follows:

**See Exhibit A attached hereto and made a part hereof.**

Together with all and singular the tenements, hereditaments and appurtenances thereunto belonging or in anywise appertaining.

Witness my/our hand(s) this 21<sup>st</sup> day of September, 2011

I-CLAD Investments, LLC, an Arizona limited liability company

Carol J. Irvin  
By: Carol Irvin, Managing Member

9-27-11

\_\_\_\_\_  
Larry O. Irvin

\_\_\_\_\_  
Sharon M. Irvin

\_\_\_\_\_  
Christopher J. Irvin

**SEE ATTACHED FOR NOTARY ACKNOWLEDGEMENTS**

SPACE BELOW FOR RECORDER



APN: 1418-03-812-001

Escrow No. 00187627 - 001 -  
RPTT \$1,981.20  
When Recorded Return to:  
**Michael Thompson**  
**639 N Frederic St.**  
**Burbank CA 91505**  
Mail Tax Statements to:  
Grantee same as above

SPACE ABOVE FOR RECORDERS USE

**Grant, Bargain, Sale Deed**

**\*\*\*This Document is executed in Counterpart \*\*\***

THIS INDENTURE WITNESSETH: That Larry O. Irvin and Sharon M. Irvin, husband and wife and I-CLAD Investments, LLC, an Arizona limited liability company and Christopher J. Irvin, a married man as his sole and separate property

In consideration of \$10.00, the receipt of which is hereby acknowledged, do(es) hereby Grant, Bargain, Sell and Convey to Michael Thompson and Gloria Thompson

all that real property situated in the County of Douglas, State of Nevada, described as follows:

**See Exhibit A attached hereto and made a part hereof.**

Together with all and singular the tenements, hereditaments and appurtenances thereunto belonging or in anywise appertaining.

Witness my/our hand(s) this 21<sup>st</sup> day of September, 2011

I-CLAD Investments, LLC, an Arizona limited liability company

By: Carol Irvin, Managing Member

Larry O. Irvin

Sharon M. Irvin

Christopher J. Irvin

**SEE ATTACHED FOR NOTARY ACKNOWLEDGEMENTS**

SPACE BELOW FOR RECORDER



STATE OF NEVADA  
COUNTY OF WASHOE

This instrument was acknowledged before me on \_\_\_\_\_,  
By Larry O. Irvin and Sharon M. Irvin

\_\_\_\_\_  
NOTARY PUBLIC

STATE OF CALIFORNIA  
COUNTY OF San Mateo

On 09-27-11, before me, the undersigned Notary Public, personally appeared Carol Irvin who proved to me on the basis of satisfactory evidence) to be the person (s) whose names (s) is/are subscribed to the within instrument and acknowledged to me that he/she/they executed the same in his/her/their authorized capacity(ies), and that by his/her/their signature(s), on the instrument the person(s), or the entity upon behalf of which the person (s) acted, executed the instrument.

I certify under PENALTY OF PURJURY under the laws of the State Of California that the foregoing paragraph is true and correct.

WITNESS my hand and Official Seal

\_\_\_\_\_  
NOTARY PUBLIC

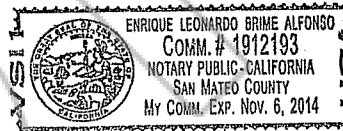

STATE OF CALIFORNIA  
COUNTY OF \_\_\_\_\_

On \_\_\_\_\_ before me, the undersigned Notary Public, personally appeared Christopher J. Irvin who proved to me on the basis of satisfactory evidence) to be the person (s) whose names (s) is/are subscribed to the within instrument and acknowledged to me that he/she/they executed the same in his/her/their authorized capacity(ies), and that by his/her/their signature(s), on the instrument the person(s), or the entity upon behalf of which the person (s) acted, executed the instrument.

I certify under PENALTY OF PURJURY under the laws of the State Of California that the foregoing paragraph is true and correct.

WITNESS my hand and Official Seal

\_\_\_\_\_  
NOTARY PUBLIC

SPACE BELOW FOR RECORDER



STATE OF NEVADA  
COUNTY OF WASHOE

This instrument was acknowledged before me on September 24, 2011  
By Lawrence O. Irvin and Sharon M. Irvin

Maryann Infantino  
NOTARY PUBLIC



STATE OF CALIFORNIA  
COUNTY OF \_\_\_\_\_

On \_\_\_\_\_, before me, the undersigned Notary Public, personally appeared Carol Irvin who proved to me on the basis of satisfactory evidence) to be the person (s) whose names (s) is/are subscribed to the within instrument and acknowledged to me that he/she/they executed the same in his/her/their authorized capacity(ies), and that by his/her/their signature(s), on the instrument the person(s), or the entity upon behalf of which the person (s) acted, executed the instrument.

I certify under PENALTY OF PURJURY under the laws of the State Of California that the foregoing paragraph is true and correct.

WITNESS my hand and Official Seal

\_\_\_\_\_  
NOTARY PUBLIC

STATE OF CALIFORNIA  
COUNTY OF \_\_\_\_\_

On \_\_\_\_\_, before me, the undersigned Notary Public, personally appeared Christopher J. Irvin who proved to me on the basis of satisfactory evidence) to be the person (s) whose names (s) is/are subscribed to the within instrument and acknowledged to me that he/she/they executed the same in his/her/their authorized capacity(ies), and that by his/her/their signature(s), on the instrument the person(s), or the entity upon behalf of which the person (s) acted, executed the instrument.

I certify under PENALTY OF PURJURY under the laws of the State Of California that the foregoing paragraph is true and correct.

WITNESS my hand and Official Seal

\_\_\_\_\_  
NOTARY PUBLIC

SPACE BELOW FOR RECORDER \_\_\_\_\_



STATE OF NEVADA  
COUNTY OF WASHOE

This instrument was acknowledged before me on \_\_\_\_\_,  
By Larry O. Irvin and Sharon M. Irvin

\_\_\_\_\_  
NOTARY PUBLIC

STATE OF CALIFORNIA  
COUNTY OF \_\_\_\_\_

On \_\_\_\_\_, before me, the undersigned Notary Public, personally appeared Carol Irvin who proved to me on the basis of satisfactory evidence) to be the person (s) whose names (s) is/are subscribed to the within instrument and acknowledged to me that he/she/they executed the same in his/her/their authorized capacity(ies), and that by his/her/their signature(s), on the instrument the person(s), or the entity upon behalf of which the person (s) acted, executed the instrument.

I certify under PENALTY OF PURJURY under the laws of the State Of California that the foregoing paragraph is true and correct.

WITNESS my hand and Official Seal

\_\_\_\_\_  
NOTARY PUBLIC

STATE OF CALIFORNIA  
COUNTY OF Los Angeles

On Sept 26, 2011, before me, the undersigned Notary Public, personally appeared Christopher J. Irvin who proved to me on the basis of satisfactory evidence) to be the person (s) whose names (s) is/are subscribed to the within instrument and acknowledged to me that he/she/they executed the same in his/her/their authorized capacity(ies), and that by his/her/their signature(s), on the instrument the person(s), or the entity upon behalf of which the person (s) acted, executed the instrument.

I certify under PENALTY OF PURJURY under the laws of the State Of California that the foregoing paragraph is true and correct.

WITNESS my hand and Official Seal

Sylvia Daves Grieb  
NOTARY PUBLIC

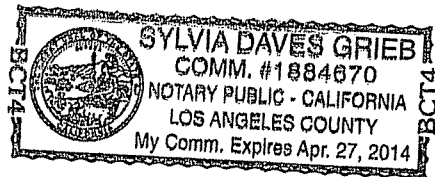

SPACE BELOW FOR RECORDER \_\_\_\_\_



**Exhibit A**

**Lot 10, in Block A, of GLENBROOK UNIT 3-A, as shown on the map of Glenbrook Unit No. 3, filed in the Office of the Recorder of Douglas County, Nevada, June 13, 1980, as instrument No. 45299, in Book 680 of maps, at Page 1269, and amendment thereto recorded March 3, 1981 in Book 381, Page 117, Document No. 53983, Official Records of Douglas County, Nevada.**

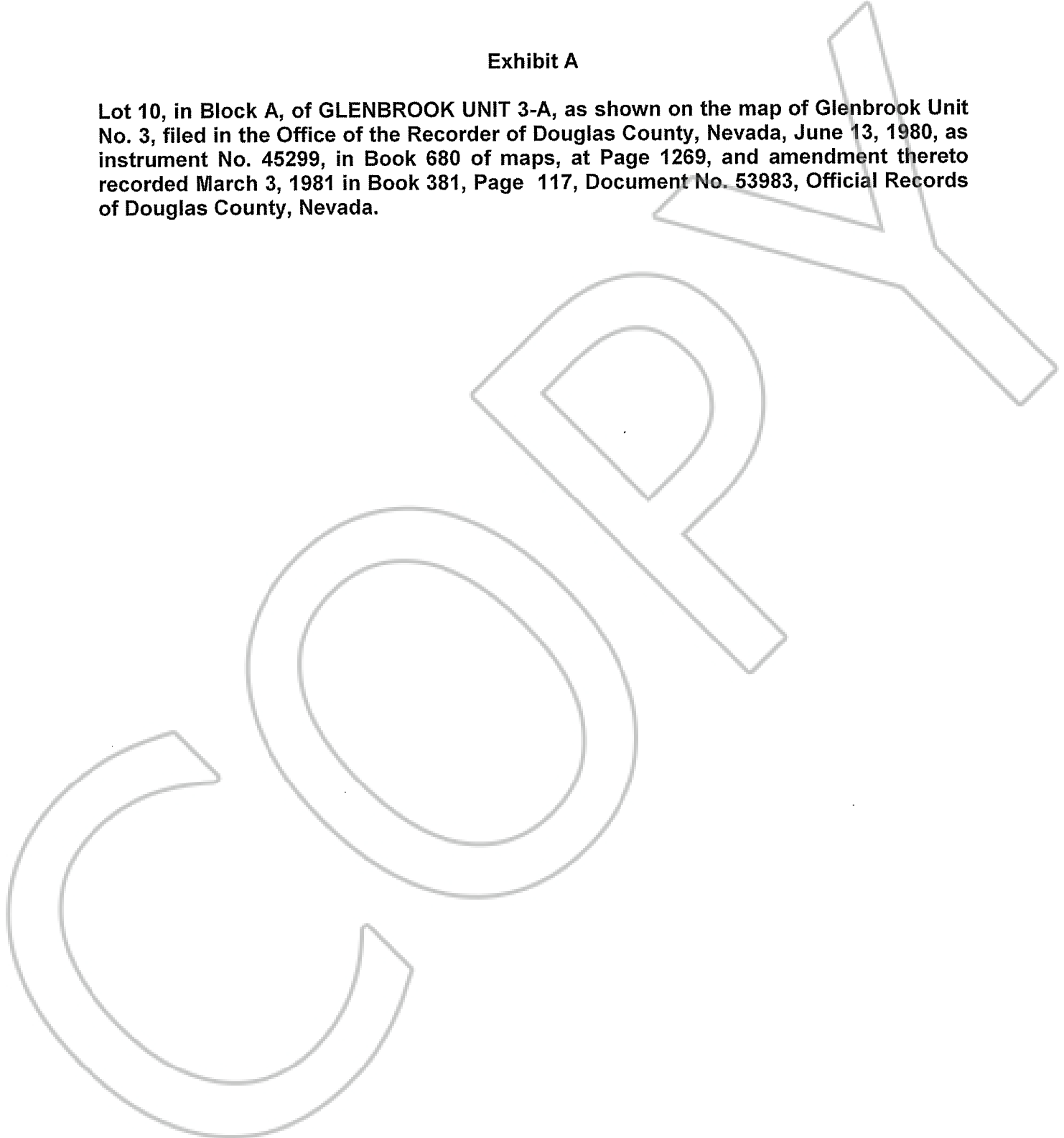

SPACE BELOW FOR RECORDER