

VICINITY MAP  
NOT TO SCALE

SCALE: 1" = 100'

**SURVEYOR'S CERTIFICATE**

I, TODD A. ENKE, A PROFESSIONAL LAND SURVEYOR LICENSED IN THE STATE OF NEVADA CERTIFY THAT:

- 1) THIS PLAT REPRESENTS THE RESULTS OF A SURVEY CONDUCTED UNDER MY DIRECT SUPERVISION AT THE INSTANCE OF DAVID McCLELLAND.
- 2) THE LANDS SURVEYED LIE WITHIN A PORTION OF SECTION 6, T.14N., R.20E., M.D.M. AND THE SURVEY WAS COMPLETED IN JULY OF 2011.
- 3) THIS PLAT COMPLIES WITH THE APPLICABLE STATE STATUTES AND ANY LOCAL ORDINANCE IN EFFECT ON THE DATE THAT THE GOVERNING BODY GAVE ITS FINAL APPROVAL.
- 4) THE MONUMENTS DEPICTED ON THE PLAT ARE OF THE CHARACTER SHOWN, OCCUPY THE POSITIONS INDICATED AND ARE OF SUFFICIENT NUMBER AND DURABILITY.

*Todd A. Enke*  
TODD A. ENKE, P.L.S. 19734

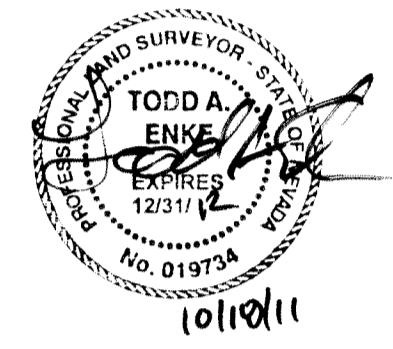

**RECORDER'S CERTIFICATE**

FILED FOR RECORD THIS 18<sup>th</sup> DAY OF October, 2011, AT 7 MINUTES PAST 1 O'CLOCK P.M., IN BOOK 1011 OF OFFICIAL RECORDS AT PAGE 285, DOCUMENT NO. 791120. RECORDED AT THE REQUEST OF DAVID McCLELLAND.

*Douglas County Recorder*  
DOUGLAS COUNTY RECORDER

- LEGEND**
- ▲ FOUND 1/4 CORNER
  - ⊗ 1/4 CORNER PER DOC. NO. 514956
  - ⊗ SECTION CORNER PER DOC. NO. 514956
  - NOTHING FOUND OR SET
  - FOUND 5/8" REBAR WITH PLASTIC CAP PLS 5547
  - △ FOUND 5/8" REBAR WITH PLASTIC CAP PLS 6099
  - FOUND 5/8" REBAR WITH PLASTIC CAP PLS 3209
  - ▲ SET 5/8" REBAR WITH PLASTIC CAP PLS 19734
  - (C) CALCULATED POSITION
- NOTES**
- AREA: 54,609 SF / 1.25 AC.
- THIS RECORD OF SURVEY HAS BEEN PREPARED TO INDICATE THE LIMITS OF A.P.N. 1420-06-301-023.
- THIS MAP REPRESENTS A SECTIONAL BREAKDOWN OF THE SOUTHEAST 1/4 OF THE NORTHEAST 1/4 OF THE NORTH 1/2 OF GOVERNMENT LOT 1 OF THE SOUTHWEST CORNER IN SECTION 6, TOWNSHIP 14 NORTH, RANGE 20 EAST, MOUNT DIABLO MERIDIAN AS SHOWN ON THE GRANT, BARGAIN, SALE DEED FOR EVERETT & DAVID McCLELLAND FILED FOR RECORD MAY 9, 1985 IN BOOK 585, AT PAGE 820.
- THIS MAP IS NOT IN CONFLICT WITH N.R.S. 278.010 TO 278.630 INCLUSIVE.
- (R1) PARCEL MAP FOR LARRY ALLAN THOMAS & MICHAEL WALTER THOMAS FILED FOR RECORD MARCH 22, 1979 AS DOC. NO. 30901
- (R2) PARCEL MAP FOR TOM MARTIN & ALICE MARTIN FILED FOR RECORD APRIL 5, 1989 AS DOC. NO. 199611
- (R3) RECORD OF SURVEY FOR WILLIAM E. & PATRICIA A. DAVIS FILED FOR RECORD MAY 25, 2001 AS DOC. NO. 514956
- (R4) PARCEL MAP FOR WILLIAM J. CASON & DIXIE L. VICIAN FILED FOR RECORD SEPTEMBER 17, 2002 AS DOC. NO. 552348

SCALE: 1" = 100' SHEET 1 OF 1

RECORD OF SURVEY  
FOR  
DAVID McCLELLAND

LOCATED WITHIN A PORTION OF SECTION 6,  
T.14N., R.20E., M.D.M.  
DOUGLAS COUNTY, NEVADA

1838-001  
1838-001BROS.dwg 10/14/11

**RO Anderson**  
1603 ESPERALDA AVENUE / POST OFFICE BOX 2229  
HENDER, NEVADA 89423  
PHONE: (775) 782-2322 / FAX: (775) 782-7084  
WEB SITE: WWW.ROANDERSON.COM