

DOC # 793161
 11/23/2011 03:54PM Deputy: SG
OFFICIAL RECORD
 Requested By:
 Stewart Title - Carson
 Douglas County - NV
 Karen Ellison - Recorder
 Page: 1 of 4 Fee: \$42.00
 BK-1111 PG-5447 RPTT: 39.00



A.P.N. #	1222-00-002-019
R.P.T.T.	\$39.00
Escrow No.	1042780
Recording Requested By:	
	
Mail Tax Statements To:	Same as below
When Recorded Mail To:	
William J Targosh	

GRANT, BARGAIN, SALE DEED

THIS INDENTURE WITNESSETH: That Carsten Michael Henningsen, an unmarried man and Mary Ann Henningsen, an unmarried woman as joint tenants, each to an undivided 1/2 interest for valuable consideration, the receipt of which is hereby acknowledged, does hereby Grant, Bargain Sell and Convey to William J Targosh and Sally A Targosh, husband and wife as Joint Tenants

, all that real property situated in the County of Douglas, State of Nevada, bounded and described as follows:

See Exhibit "A" attached hereto and by reference made a part hereof for complete legal description.

Together with all and singular the tenements, hereditaments and appurtenances thereunto belonging or in anywise appertaining, and any reversions, remainders, rents, issues or profits thereof.

Dated: 10-25-2011

Carsten M Henningsen
 Carsten M Henningsen

Mary Ann Henningsen
 Mary Ann Henningsen

State of ~~Nevada~~ California }
 County of ~~Douglas~~ Alameda } ss.

This instrument was acknowledged before me on _____
 by: Carsten M Henningsen, Mary Ann Henningsen

Signature: _____
 Notary Public



A.P.N. #	1222-00-002-019
R.P.T.T.	\$39.00
Escrow No.	1042780
Recording Requested By:	
	
Mail Tax Statements To:	Same as below
When Recorded Mail To:	
William J Targosh	

GRANT, BARGAIN, SALE DEED

THIS INDENTURE WITNESSETH: That Carsten Michael Henningsen, an unmarried man and Mary Ann Henningsen, an unmarried woman as joint tenants, each to an undivided 1/2 interest for valuable consideration, the receipt of which is hereby acknowledged, does hereby Grant, Bargain Sell and Convey to William J Targosh and Sally A Targosh, husband and wife as Joint Tenants

, all that real property situated in the County of Douglas, State of Nevada, bounded and described as follows:

See Exhibit "A" attached hereto and by reference made a part hereof for complete legal description.

Together with all and singular the tenements, hereditaments and appurtenances thereunto belonging or in anywise appertaining, and any reversions, remainders, rents, issues or profits thereof.

Dated: Oct 18, 2011

Carsten M Henningsen
Carsten M Henningsen

Mary Ann Henningsen
Mary Ann Henningsen

State of Nevada Oregon }
County of Douglas Multnomah } ss.

This instrument was acknowledged before me on 10-18-2011
by: Carsten M Henningsen, Mary Ann Henningsen

Signature: June Miller
Notary Public
Only Carsten Henningsen



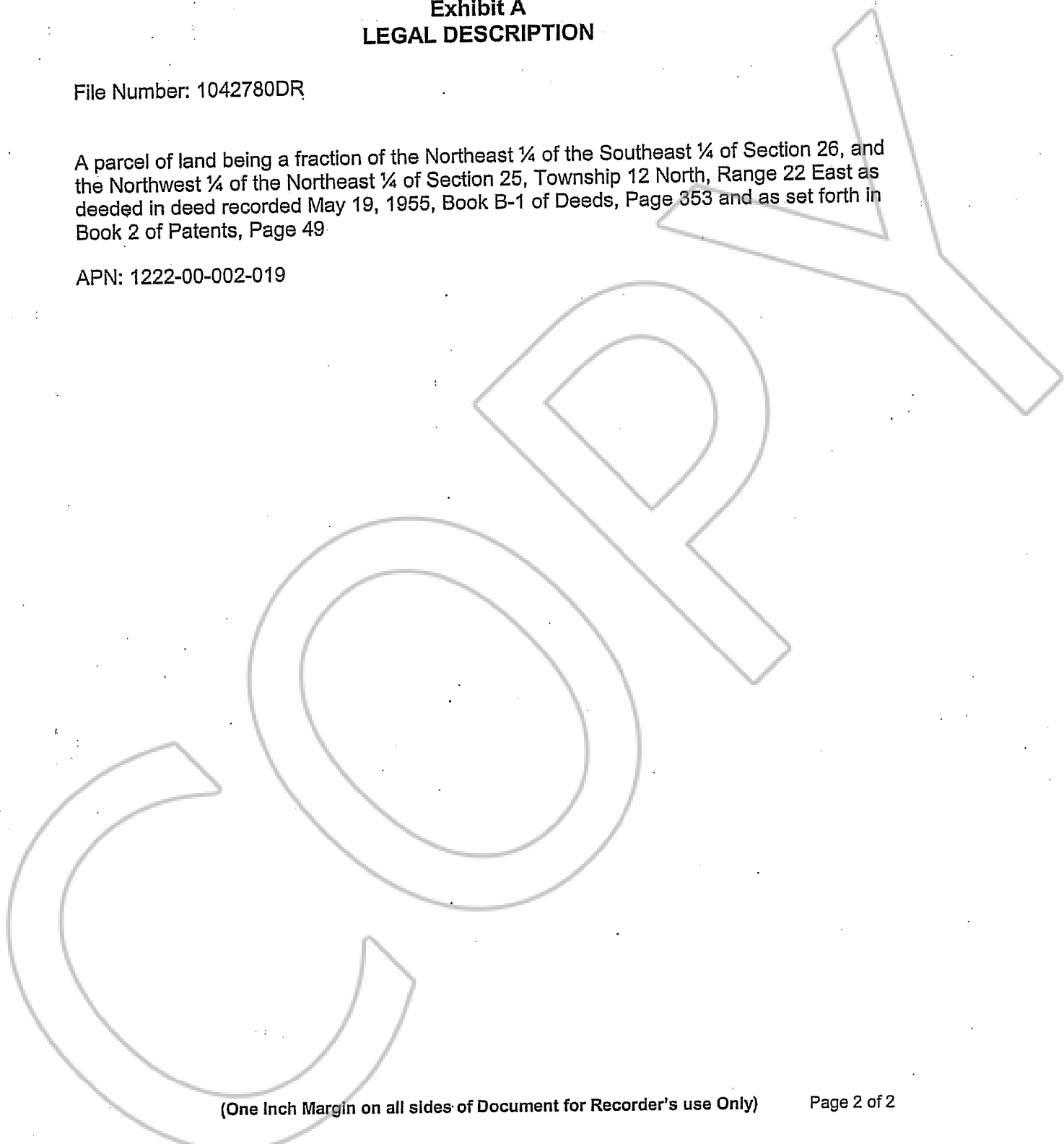

**Exhibit A
LEGAL DESCRIPTION**

File Number: 1042780DR

A parcel of land being a fraction of the Northeast $\frac{1}{4}$ of the Southeast $\frac{1}{4}$ of Section 26, and the Northwest $\frac{1}{4}$ of the Northeast $\frac{1}{4}$ of Section 25, Township 12 North, Range 22 East as deeded in deed recorded May 19, 1955, Book B-1 of Deeds, Page 353 and as set forth in Book 2 of Patents, Page 49

APN: 1222-00-002-019



CALIFORNIA ALL-PURPOSE CERTIFICATE OF ACKNOWLEDGMENT

State of California



BK 1111
PG-5450

793161 Page: 4 of 4 11/23/2011

County of ALAMEDA

On 10/25/2011 before me; VIKRAM RANDHAWA, NOTARY PUBLIC
(Here insert name and title of the officer)

personally appeared MARY ANN HENNINGSEN

who proved to me on the basis of satisfactory evidence to be the person(s) whose name(s) is/are subscribed to the within instrument and acknowledged to me that he/she/they executed the same in his/her/their authorized capacity(ies), and that by his/her/their signature(s) on the instrument the person(s), or the entity upon behalf of which the person(s) acted, executed the instrument.

I certify under PENALTY OF PERJURY under the laws of the State of California that the foregoing paragraph is true and correct.

WITNESS my hand and official seal.

Signature of Notary Public *[Handwritten Signature]*

(Notary Seal)

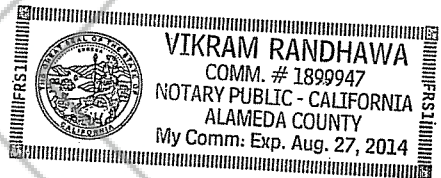

ADDITIONAL OPTIONAL INFORMATION

INSTRUCTIONS FOR COMPLETING THIS FORM

Any acknowledgment completed in California must contain verbiage exactly as appears above in the notary section or a separate acknowledgment form must be properly completed and attached to that document. The only exception is if a document is to be recorded outside of California. In such instances, any alternative acknowledgment verbiage as may be printed on such a document so long as the verbiage does not require the notary to do something that is illegal for a notary in California (i.e. certifying the authorized capacity of the signer). Please check the document carefully for proper notarial wording and attach this form if required.

- State and County information must be the State and County where the document signer(s) personally appeared before the notary public for acknowledgment.
- Date of notarization must be the date that the signer(s) personally appeared which must also be the same date the acknowledgment is completed.
- The notary public must print his or her name as it appears within his or her commission followed by a comma and then your title (notary public).
- Print the name(s) of document signer(s) who personally appear at the time of notarization.
- Indicate the correct singular or plural forms by crossing off incorrect forms (i.e. he/she/they-, is /are) or circling the correct forms. Failure to correctly indicate this information may lead to rejection of document recording.
- The notary seal impression must be clear and photographically reproducible. Impression must not cover text or lines. If seal impression smudges, re-seal if a sufficient area permits, otherwise complete a different acknowledgment form.
- Signature of the notary public must match the signature on file with the office of the county clerk.
 - ❖ Additional information is not required but could help to ensure this acknowledgment is not misused or attached to a different document.
 - ❖ Indicate title or type of attached document, number of pages and date.
 - ❖ Indicate the capacity claimed by the signer. If the claimed capacity is a corporate officer, indicate the title (i.e. CEO, CFO, Secretary).
- Securely attach this document to the signed document

DESCRIPTION OF THE ATTACHED DOCUMENT

(Title or description of attached document)

(Title or description of attached document continued)

Number of Pages _____ Document Date _____

(Additional information)

CAPACITY CLAIMED BY THE SIGNER

- Individual (s)
- Corporate Officer
- _____
(Title)
- Partner(s)
- Attorney-in-Fact
- Trustee(s)
- Other _____