

18

DOC # 0797531
02/17/2012 03:04 PM Deputy: PK
OFFICIAL RECORD
Requested By:
ALLISON & MACKENZIE ETAL

RECORDING REQUESTED BY

Douglas County - NV
Karen Ellison - Recorder
Page: 1 of 5 Fee: 18.00
BK-0212 PG- 3584 RPTT: 0.00

WHEN RECORDED MAIL TO
JENNIFER MAHE, ESQ.
ALLISON, MacKENZIE, PAVLAKIS,
WRIGHT & FAGAN, LTD.
402 North Division Street
P.O. Box 646
Carson City, NV 89702



SPACE ABOVE THIS LINE RESERVED FOR
RECORDER'S USE

The party executing this document hereby affirms
that this document submitted for recording does
not contain the social security number of any
person or persons pursuant to NRS 239B.030

The party executing this document hereby affirms
that this document submitted for recording does
contain the social security number of a person or
persons as required by NRS 239B.030(2).

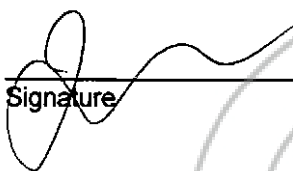

Signature

JUDGMENT

RECEIVED

FEB 13 2012

FILED

1 Case No. 09 CV 401

2 Dept. No. II

**DOUGLAS COUNTY
DISTRICT COURT CLERK**

2012 FEB 15 PM 3:02

TED THIRAN
CLERK

M. BIAGGINI
DEPUTY

BK- 0212
PG- 3585
02/17/2012



0797531 Page: 2 Of 5

3
4
5
6 IN THE NINTH JUDICIAL DISTRICT COURT OF THE STATE OF NEVADA

7 IN AND FOR THE COUNTY OF DOUGLAS

8
9 ROBERT A. KIMMERLING and
10 MARGERY A. KIMMERLING as
11 Co-Trustees of THE KIMMERLING
12 1990 TRUST dated June 12, 1990, MELVYN
13 L. FRENCH and YVONNE J. FRENCH as
14 Trustees of the FRENCH LIVING TRUST
15 dated June 17, 2003, STEPHEN O.
16 TRACKMAN, and JOSEPH J. FLYNN and
17 ELAINE L. FLYNN as Trustees of THE
18 JOSEPH J. AND ELAINE L. FLYNN
19 FAMILY TRUST dated December 22, 1995,

20 Plaintiffs,

21 vs.

JUDGMENT

22 MARSHA L. TOMERLIN, individually,
23 WILLIAM R. TOMERLIN, individually,
24 MARSHA TOMERLIN and WILLIAM
25 TOMERLIN as Trustees of THE
26 WILLIAM R. TOMERLIN TRUST dated
27 August 11, 1976, and subsequent
28 amendments thereto and restated in THE
TOMERLIN TRUST dated January 31,
1994, MARSHA TOMERLIN and
WILLIAM TOMERLIN as Trustees of
THE WILLIAM R. TOMERLIN TRUST
OF 1988, MARSHA TOMERLIN and
WILLIAM TOMERLIN as Trustees of
THE TOMERLIN TRUST U/A/D, dated
February 2, 1989; SIERRA COUNTRY, INC.,
a Nevada corporation; JACK MARCARELLI
and KIM MARCARELLI, husband and wife,
JAMES K. LEEG and MARSHA
LANDGRAF-LEEG as Trustees of THE
LEEG FAMILY TRUST dated June 18, 2005,
EVAN L. MAXWELL and ANN E. MAXWELL,
husband and wife, WILLIAM D. LONG,
COY SANDERS CONSTRUCTION, INC.,



1 a California corporation and pension fund,
 2 TIMOTHY T. PINTHER, LENNARD
 3 GLOGAUER and NANCI GLOGAUER as
 4 Trustees of THE GLOGAUER FAMILY TRUST
 5 dated December 24, 2004, GEOFFREY S.
 6 NORTHCOTE and SHERI NORTHCOTE as
 7 Trustees of THE NORTHCOTE LIVING
 8 TRUST dated November 13, 2002, PHILIP S.
 9 BUSHNELL and SHARON M. BUSHNELL,
 10 husband and wife, BRIAN D. COMPTON and
 11 VICCI A. COMPTON as Trustees of THE
 12 BRIAN D. COMPTON AND VICCI A.
 13 COMPTON REVOCABLE TRUST
 14 AGREEMENT dated May 1, 1998, JAMES
 15 HERD and JENNIFER WARE, husband and
 16 wife, JOHN PIFER and STACY PIFER, husband
 17 and wife, KEVIN O. SERVATIUS and
 18 REBECCA A. SERVATIUS as Trustees of THE
 19 KEVIN O. SERVATIUS FAMILY TRUST
 20 AGREEMENT dated July 10, 1995,
 21 TERRENCE E. LALONDE as Trustee of THE
 22 LALONDE FAMILY TRUST dated May 19,
 23 1997, C. RAY JOHNSON as Trustee of THE
 24 C. RAY JOHNSON FAMILY TRUST dated
 25 June 23, 1995, ROGER C. MEYER and
 26 MARRIA A. MEYER, husband and wife,
 27 PAMELA A. CONNER, CHARLES D.
 28 McDERMID, and DOES 1-10, inclusive.

Defendants.

SIERRA COUNTRY, INC., a Nevada
 corporation, MARSHA L. TOMERLIN,
 individually, and WILLIAM R.
 TOMERLIN, individually,

Counterclaimants,

vs.

ROBERT A. KIMMERLING and
 MARGERY A. KIMMERLING as
 Co-Trustees of THE KIMMERLING
 1990 TRUST dated June 12, 1990, MELVYN
 L. FRENCH and YVONNE J. FRENCH as
 Trustees of the FRENCH LIVING TRUST
 dated June 17, 2003, STEPHEN O.
 TRACKMAN, JOSEPH J. FLYNN and
 ELAINE L. FLYNN as Trustees of THE
 JOSEPH J. AND ELAINE L. FLYNN FAMILY
 TRUST dated December 22, 1995, and
 DOES I-X, inclusive,

Counterdefendants.

1 NOW, THEREFORE, IT IS HEREBY ORDERED, ADJUDGED AND DECREED
2 AND JUDGMENT ENTERED AS FOLLOWS:

3 1. NRS Chapter 116 applies to the real property commonly referred to as the
4 Sierra Country Estates subdivision and more particularly identified in Exhibit "1" attached hereto
5 and incorporated herein by this reference.

6 2. Sierra Country Estates Homeowners Association is recognized as the validly
7 formed entity required by NRS Chapter 116 to govern Sierra Country Estates.

8 3. The Amendment to the Declaration of Covenants, Conditions and Restrictions
9 for Sierra Country Estates Subdivision recorded on March 22, 2001, as Document No. 0510837 is
10 invalid and non-binding.

11 4. All claims between the parties are dismissed and each party shall bear its own
12 attorneys' fees and costs.

13 JUDGMENT RENDERED this 15 day of Feb., 2012.

14 
15 _____
16 DISTRICT COURT JUDGE

17 Submitted By:
18 ALLISON, MacKENZIE, PAVLAKIS,
19 WRIGHT & FAGAN, LTD.
20 402 North Division Street
21 P.O. Box 646
22 Carson City, NV 89702

21 By: 
22 JOAN C. WRIGHT, ESQ.
23 Nevada State Bar No. 1042
24 JENNIFER MAHE, ESQ.
25 Nevada State Bar No. 9620
26 Attorneys for Plaintiffs
27
28



1
2
3
4
5
6
7
8
9
10
11
12
13
14
15
16
17
18
19
20
21
22
23
24
25
26
27
28

EXHIBIT "1"

All that certain real property situated in the county of Douglas, state of Nevada, more particularly described as follows:

Lots 1 through 13 as more particularly identified on the parcel map recorded in the Office of the Douglas County Recorder on March 28, 1996 as Document Number 384282, and Lots 14 through 23 as more particularly identified on the parcel map recorded in the Office of the Douglas County Recorder on January 27, 2000 as Document Number 485130.

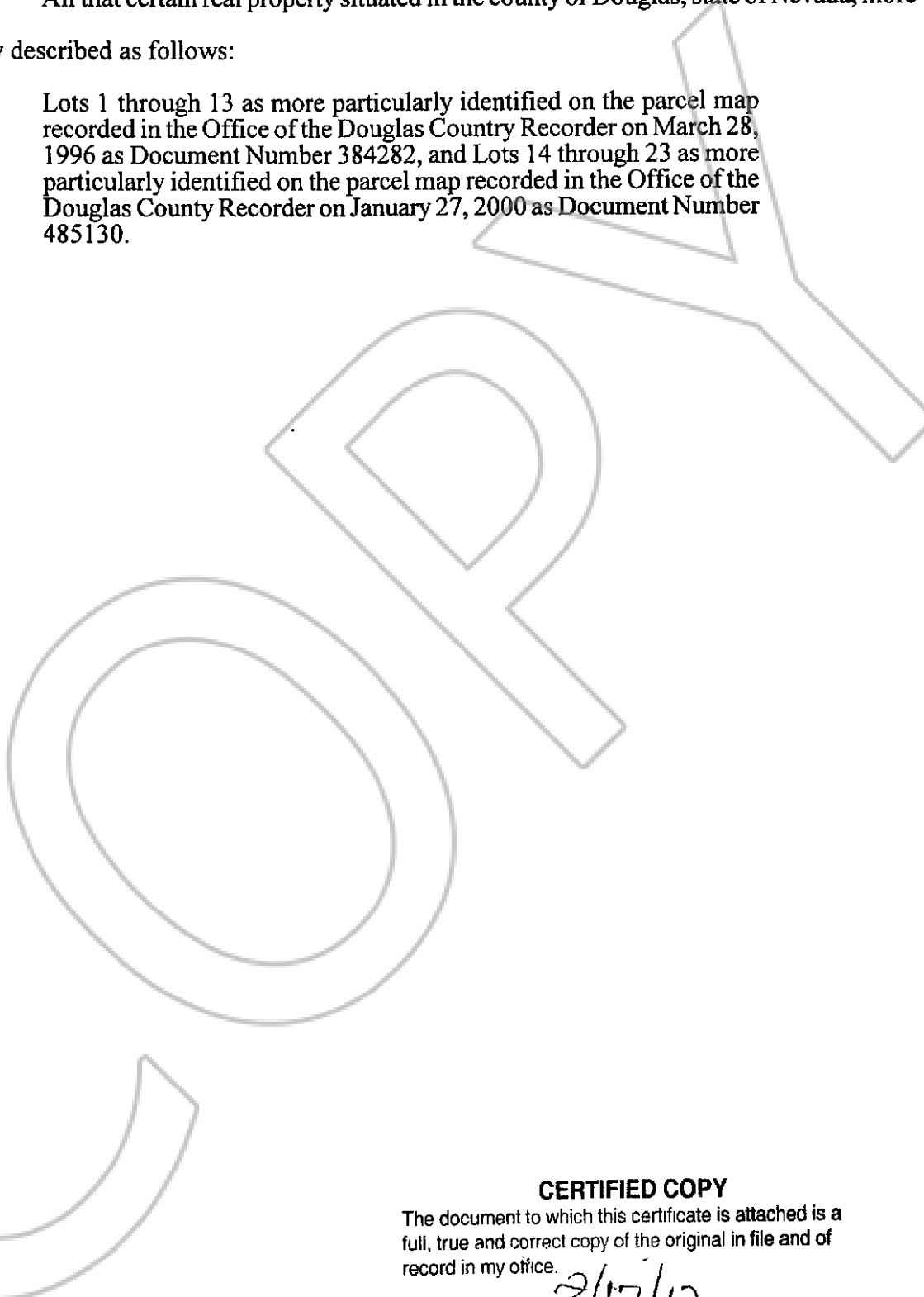

CERTIFIED COPY

The document to which this certificate is attached is a full, true and correct copy of the original in file and of record in my office.

DATE 2/17/12

TED THIRAN Clerk of the 9th Judicial District Court of the State of Nevada, in and for the County of Douglas,

By [Signature] Deputy