

16-

APN: 1418-22-610-002

When recorded, return to:
PO Box 412
Zeplins Cove, NV 89448

Douglas County - NV
Karen Ellison - Recorder
Page: 1 Of 3 Fee: 16.00
BK-0212 PG- 4186 RPTT: 0.00



NOTICE OF LIEN CLAIM

NOTICE IS HEREBY GIVEN that:

1. VANCE KEENEY hereby claims a mechanic's lien pursuant to the provisions of NRS 108.221, et seq., laws of the State of Nevada, in the amount of \$4209.28 on the real property and improvements located in the City of GLENBROOK, County of DOUGLAS, State of Nevada, commonly known as _____, and more particularly described as follows:

(Insert legal description here, or reference exhibit A attached and incorporated by reference. Check NRS 111.312 concerning the recordation of documents pertaining to property with metes and bounds legal description.)

2. The owner or reputed owner of the above-described property is 1686 LOGAN CREEK LLC, whose address is PO BOX 3390 STATELINE, Nevada.

3. This lien is claimed for materials and labor for (specify work performed) at the above address. SNOW REMOVAL & BMP WORK

4. Said labor and materials were supplied at the express direction and order of the owner, 1686 Logan Creek LLC pursuant to (specify terms of engagement) Net 30, with terms and conditions which provided for payment to be made when the work was completed.

NA Notice to the reputed owner of labor and materials being supplied was delivered by certified mail on the _____ day of _____, 20____, all in accordance with NRS 108.245.

6. Ninety (90) days have not elapsed since the completion of the work or improvement on the property described above. The last date lien claimant furnished labor or materials was 4/12/2011. (State whether a Certificate of Completion has been filed.)

7. The claimant herein is entitled to reasonable attorney's fees, statutory interest on the amount of this lien claim, and costs incurred in perfecting this lien claim.

DATED this 22nd day of FEB, 2012

(NAME OF LIEN CLAIMANT)

By [Signature]

Print name VANCE D. KEENE

(ACKNOWLEDGMENT)

NOTE: Effective July 1, 2003, all documents (except maps) submitted for recording in Nevada must be on 8½ inch by 11 inch paper, have a margin of 1 inch on the left and right sides and at the bottom of each page, have a space of 3 inches by 3 inches at the upper right corner of the first page, and have a margin of 1 inch at the top of each succeeding page. (NRS 247.110(4), effective July 1, 2003) Documents recorded in Clark County, Nevada, were required to be in that format prior to July 1, 2003.

See NRS 108.226.

Service should be made pursuant to NRS 108.227.

EXHIBIT "A"

LEGAL DESCRIPTION

ESCROW NO.: 010203546

Lot 2, in Block C, as shown on the map of LOGAN CREEK ESTATES; filed in the Office of the County Recorder of Douglas County, Nevada, on March 8, 1960, as Document No. 15688.

TOGETHER WITH the right of owners to have access to the water of Lake Tahoe as set forth in Deed recorded December 17, 1973, in Book 1273, Page 387, Document No. 70682, Official Records of Douglas County, State of Nevada.

Assessors Parcel No. 03-022-290

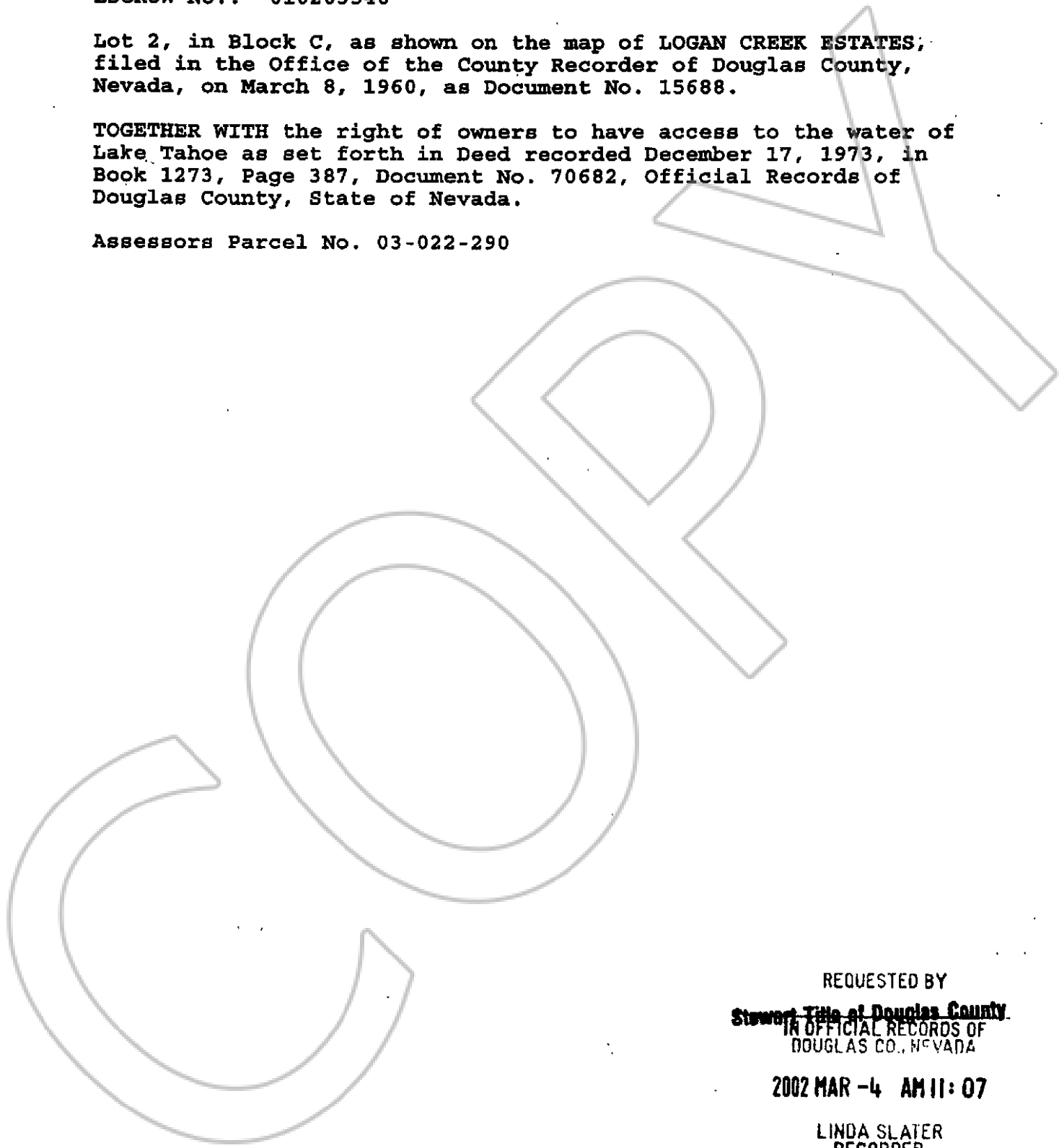

REQUESTED BY
~~Stewart Title of Douglas County~~
IN OFFICIAL RECORDS OF
DOUGLAS CO., NEVADA

2002 MAR -4 AM 11:07

LINDA SLATER
RECORDER

\$ 16.00 PAID *BL* DEPUTY

0536102