

18

DOC # 0800666  
04/12/2012 02:15 PM Deputy: SG

OFFICIAL RECORD

Requested By:

MCCARTHY & HOLTHUS

Douglas County - NV  
Karen Ellison - Recorder

Page: 1 Of 5 Fee: 18.00  
BK-0412 PG- 3352 RPTT: 0.00



Assessor's Parcel Number: 1220-21-810-250

Recording Requested By:

Name: McCarthy & Holthus, LLP

Address: 9510 W. Sahara Suite 110

City/State/Zip Las Vegas, NV 89117

Real Property Transfer Tax:

\$ \_\_\_\_\_

Notice of Pendency of Action

(Title of Document)

This page added to provide additional information required by NRS 111.312 Sections 1-2. (Additional recording fee applies)

*This cover page must be typed or legibly hand printed.*

1 Kristin A. Schuler-Hintz, Esq., SBN 7170  
2 Stephanie Richter, Esq., SBN 12075  
3 McCarthy & Holthus, LLP  
4 9510 W. Sahara Ave., Suite 110  
5 Las Vegas, NV 89117  
6 Phone (702) 685-0329  
7 Fax (866) 339-5691  
8 Email NVJud@McCarthyHolthus.com

RECEIVED

MAR 28 2012

DOUGLAS COUNTY  
DISTRICT COURT CLERK

FILED

2012 MAR 28 PM 3:42

TED THUAN  
CLERK

BY:  DEPUTY

Attorneys for Plaintiff,  
DEUTSCHE BANK NATIONAL TRUST COMPANY, AS TRUSTEE, FOR CARRINGTON  
MORTGAGE LOAN TRUST, SERIES 2005

IN THE NINTH JUDICIAL DISTRICT COURT FOR THE STATE OF NEVADA  
IN AND FOR THE COUNTY OF DOUGLAS

DEUTSCHE BANK NATIONAL TRUST  
COMPANY, AS TRUSTEE, FOR  
CARRINGTON MORTGAGE LOAN  
TRUST, SERIES 2005,

Case No. 12 CV 0097

Department: #

Plaintiff,

NOTICE OF PENDENCY OF ACTION

v.

GREGORY LEE WILBER; JACQUELYN  
BARBOUR WILBER, husband and wife;  
CAVALRY PORTFOLIO SERVICES, LLC;  
NATIONAL BUSINESS FACTORS  
COLLECTION SERVICE; DOES I-X; and  
ROES 1 -10 inclusive,

Defendants.

PLEASE TAKE NOTICE that this action commenced in the above court on or about  
March 27, 2012 by Plaintiff DEUTSCHE BANK NATIONAL TRUST COMPANY, AS

1  
2  
3  
4  
5  
6  
7  
8  
9  
10  
11  
12  
13  
14  
15  
16  
17  
18  
19  
20  
21  
22  
23  
24  
25  
26  
27  
28

TRUSTEE, FOR CARRINGTON MORTGAGE LOAN TRUST, SERIES 2005 against  
Defendants GREGORY LEE WILBER, JACQUELYN BARBOUR WILBER.

The Complaint for Judicial Foreclosure and Deficiency Judgment of Deed of Trust  
alleges a real property claim affecting real property commonly known as 625 Adaline Way,  
Gardnerville, NV 89460 and legally described as attached hereto as Exhibit "1":

Dated: March 27, 2012

Respectfully submitted,  
MCCARTHY & HOLTHUS, LLP

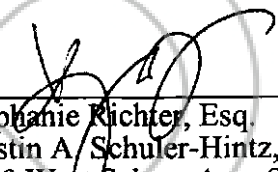
By:   
Stephanie Richter, Esq.  
Kristin A. Schuler-Hintz, Esq.  
9510 West Sahara Ave. Suite 110  
Las Vegas, NV 89117

**EXHIBIT "1"**

COPY

LOT 284, AS SHOWN ON THE MAP OF GARDNERVILLE RANCHOS UNIT NO. 7, FILED FOR RECORD IN THE OFFICE OF THE COUNTY RECORDER OF DOUGLAS COUNTY, NEVADA, ON MARCH 27, 1974, PAGE 676, AS FILE NO. 72456.

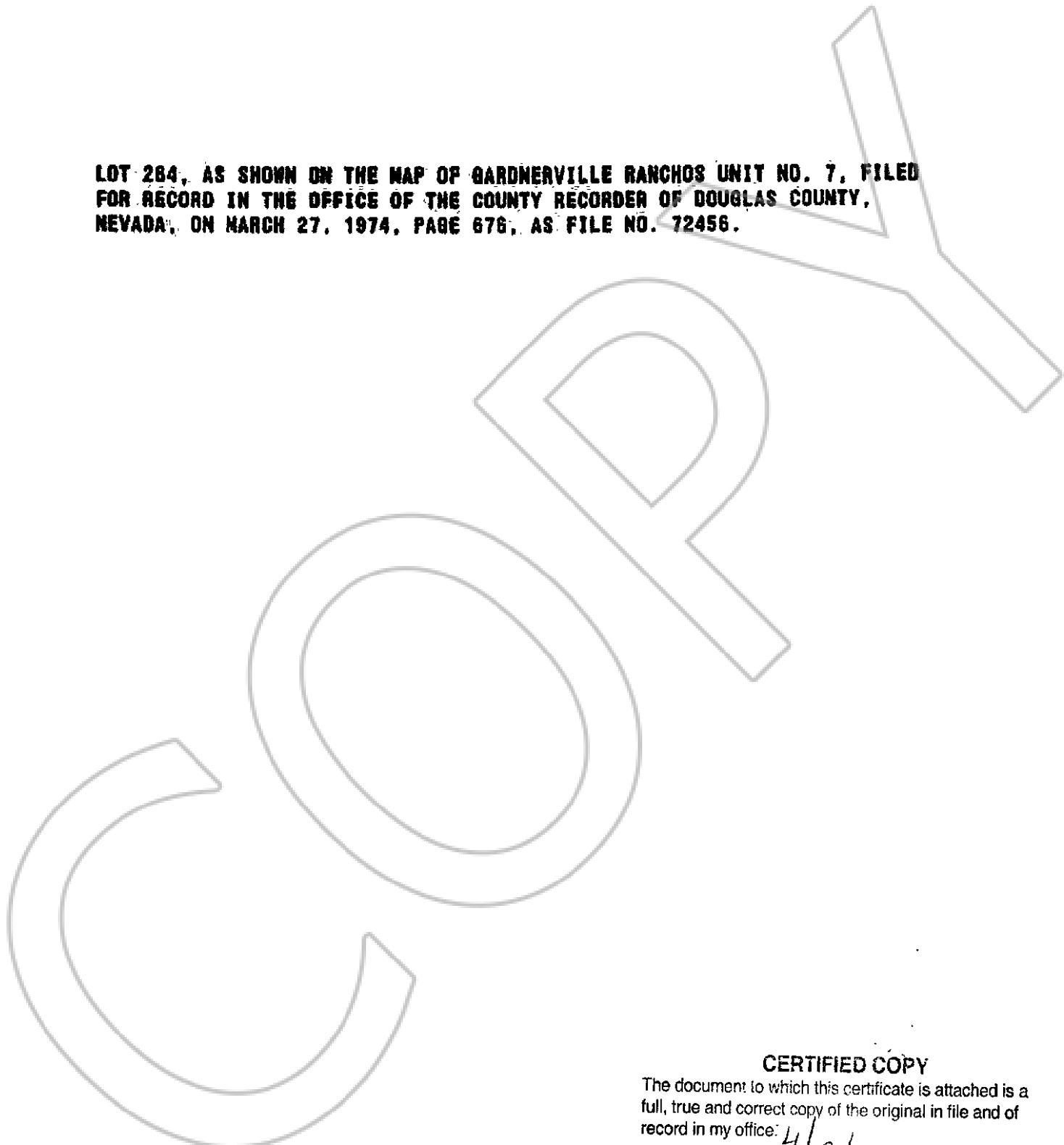

**CERTIFIED COPY**

The document to which this certificate is attached is a full, true and correct copy of the original in file and of record in my office.

DATE 4/3/12

TED THUAN Clerk of the 3rd Judicial District Court of the State of Nevada, in and for the County of Douglas,

By [Signature] Deputy