

32

APNs: 1419-03-000-013;
1419-03-000-012; 1419-04-000-021;
1419-09-000-005; 1419-10-000-009;
1419-10-000-008

Douglas County - NV
Karen Ellison - Recorder

Page: 1 of 19 Fee: 32.00
BK-0612 PG- 3648 RPTT: 0.00

RECORDING REQUESTED BY
AND WHEN RECORDED MAIL TO:

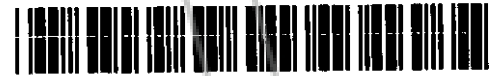

Amy N. Tirre, Esq.
Law Offices of Amy N. Tirre, APC
✓ 3715 Lakeside Drive, Suite A
Reno, NV 89509

PARTIAL RELEASE OF LIEN

WHEAREAS, a Lien against certain real property was recorded on July 12, 2011 as Instrument No. 0786286 of Official Records of Douglas County, Nevada for work, materials, equipment furnished by the undersigned claimant.

WHEREAS, the undersigned claimant has been requested to grant a partial release of said lien,

NOW, THEREFORE, the undersigned claimant does hereby remise, release and forever discharge only a portion of the property described in said lien, which portion is particularly described with the following APNs:

1419-03-000-013; 1419-03-000-012; 1419-04-000-021; 1419-09-000-005; 1419-10-000-009;
1419-10-000-008

And the Legal Descriptions attached hereto as Exhibit 1.

Dated: June 11, 2012.

MANHARD CONSULTING, LTD.

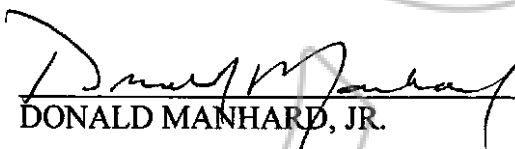
By: 
DONALD MANHARD, JR.

Its: President

STATE OF ILLINOIS)
) SS.
COUNTY OF LAKE)

On before me, William M. Laytin, Notary Public, personally appeared Donald Manhard, Jr. in his capacity as President of Manhard Consulting, Ltd., who proved to me on the basis of satisfactory evidence to be the person whose name is subscribed to the within instrument and acknowledged to me that he executed the same in his authorized capacity, and that by his signature on the instrument the person, or the entity upon behalf of which the person acted, executed the instrument.

I certify under PENALTY OF PERJURY under the laws of the State of Nevada that the foregoing paragraph is true and correct.

WITNESS my hand and official seal.

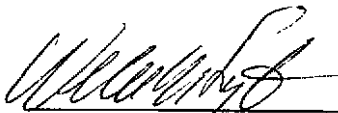

FOR NOTARY STAMP

•••••
"OFFICIAL SEAL"
WILLIAM M. LAYTIN
Notary Public, State of Illinois
My Commission Expires 11/22/2014
•••••



COPY

EXHIBIT 1

**Adjusted Parcel 11
LEGAL DESCRIPTION**

A parcel of land situate in Section 3, Township 14 North, Range 19 East, MDM, Douglas County, Nevada and being more particularly described as follows:

COMMENCING at the Southwest corner of said Section 3;

Thence North $42^{\circ}58'36''$ East a distance of 2807.20 feet to the **POINT OF BEGINNING**;

Thence along the arc of a non tangent curve to the left having a tangent bearing of North $42^{\circ}38'58''$ West, a radius of 1522.50 feet, a central angle of $23^{\circ}15'08''$, a distance of 617.87 feet;

Thence along the arc of a reverse curve to the right having a radius of 327.50 feet, a central angle of $59^{\circ}57'58''$, a distance of 342.76 feet to a point on the North line of the Southwest Quarter of said Section 3;

Thence along the North line of the said Southwest Quarter, North $89^{\circ}13'59''$ East a distance of 1436.81 feet;

Thence leaving said North line and along the North line of the Northwest Quarter of the Southeast Quarter of said Section 3, North $89^{\circ}12'25''$ East a distance of 273.07 feet;

Thence leaving said North line, South $01^{\circ}38'41''$ East a distance of 110.72 feet;

Thence South $06^{\circ}08'05''$ West a distance of 99.36 feet;

Thence South $27^{\circ}32'44''$ West a distance of 107.74 feet;

Thence South $03^{\circ}18'44''$ West a distance of 98.96 feet;

Thence South $70^{\circ}40'55''$ West a distance of 202.10 feet;

Thence South $66^{\circ}44'07''$ West a distance of 117.97 feet;

Thence North $88^{\circ}18'58''$ West a distance of 475.67 feet;

Thence South $57^{\circ}11'57''$ West a distance of 105.37 feet;

Thence South $47^{\circ}21'02''$ West a distance of 127.01 to the **POINT OF BEGINNING**.

Containing 16.97 Acres, more or less.

Prepared By:

Harlan King & Associates
P.O. Box 70098
Reno, Nevada 89570
Office: 775.852.1777



COOPY

**Adjusted Parcel 12
LEGAL DESCRIPTION**

A parcel of land situate in Section 3, Township 14 North, Range 19 East, MDM, Douglas County, Nevada and being more particularly described as follows:

COMMENCING at the Southwest corner of said Section 3;

Thence North 13°09'03" East a distance of 1827.13 feet to the **POINT OF BEGINNING**;

Thence North 68°42'00" West a distance of 295.69 feet;

Thence along the arc of a curve to the left having a radius of 322.50 feet, a central angle of 11°44'24", a distance of 66.08 feet;

Thence along the arc of a reverse curve to the right having a radius of 277.50 feet, a central angle of 06°12'11", a distance of 30.04 feet;

Thence North 61°58'38" East a distance of 276.39 feet;

Thence North 36°35'53" West a distance of 14.28 feet;

Thence North 59°39'19" East a distance of 352.28 feet;

Thence along the arc of a curve to the right having a radius of 117.02 feet, a central angle of 57°34'32", a distance of 117.59 feet;

Thence along the arc of a non tangent curve to the right having a tangent bearing of North 49°16'12" East, a radius of 161.05 feet, a central angle of 59°14'49", a distance of 166.53 feet;

Thence South 73°21'10" East a distance of 759.79 feet;

Thence along the arc of a non tangent curve to the right having a tangent bearing of South 31°37'42" West, a radius of 377.50 feet, a central angle of 48°38'31", a distance of 320.48 feet;

Thence along the arc of a reverse curve to the left having a radius of 272.50 feet, a central angle of 09°31'15", a distance of 45.28 feet;

Thence North 20°23'08 West a distance of 27.59 feet;

Thence North 87°41'11 West a distance of 439.95 feet;

Thence along the arc of a curve to the right having a radius of 150.00 feet, a central angle of 46°45'37", a distance of 122.42 feet;

Thence North 40°55'34" West a distance of 73.05 feet;

Thence South 49°41'07" West a distance of 343.67 feet to the **POINT OF BEGINNING**.

Containing 8.75 Acres, more or less.

Prepared By:

Harlan King & Associates
P.O. Box 70098
Reno, Nevada 89570
Office: 775.852.1777

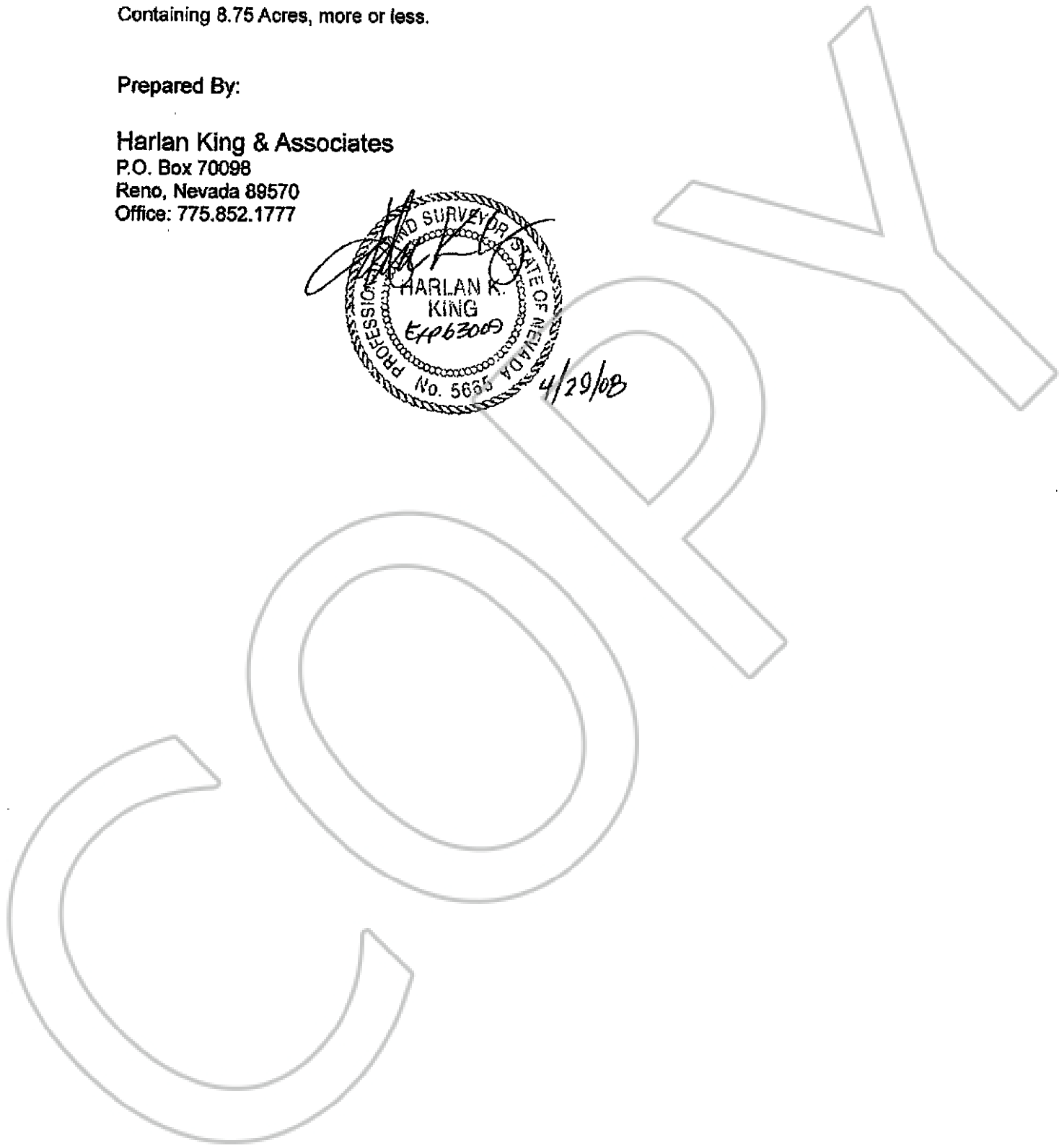

**Adjusted Parcel 13
LEGAL DESCRIPTION**

A parcel of land situate in Sections 3 and 4, Township 14 North, Range 19 East, MDM, Douglas County, Nevada and being more particularly described as follows:

COMMENCING at the Southwest corner of said Section 3;

Thence North 05°40'03" West a distance of 689.88 feet to the **POINT OF BEGINNING**;

Thence South 85°00'14" West a distance of 534.04 feet;

Thence along the arc of a non tangent curve to the left having a tangent bearing of North 65°49'46" West, a radius of 222.50 feet, a central angle of 16°27'06", a distance of 63.89 feet;

Thence North 07°43'08" East a distance of 29.40 feet;

Thence North 46°20'38" West a distance of 49.78 feet;

Thence North 68°02'52" West a distance of 618.70 feet;

Thence North 50°16'20" West a distance of 291.77 feet;

Thence North 45°23'56" West a distance of 550.14 feet;

Thence North 28°04'26" West a distance of 97.08 feet;

Thence North 01°10'43" West a distance of 128.24 feet;

Thence North 36°11'32" East a distance of 172.82 feet;

Thence North 67°19'25" East a distance of 626.05 feet;

Thence along the arc of a non tangent curve to the left having a tangent bearing of South 68°41'59" East, a radius of 272.50 feet, a central angle of 44°47'51", a distance of 213.06 feet;

Thence South 61°11'42" East a distance of 933.74 feet;

Thence North 40°18'09" East a distance of 293.13 feet;

Thence along the arc of a non tangent curve to the left having a tangent bearing of South 60°24'31" East, a radius of 322.50 feet, a central angle of 20°01'53", a distance of 112.75 feet;

Thence along the arc of a reverse curve to the right having a radius of 277.50 feet, a central angle of 11°44'24", a distance of 56.86 feet;

Thence South 68°42'00" East a distance of 260.74 feet;

Thence South 47°08'37" West a distance of 532.92 feet'

Thence along the arc of a non tangent curve to the right having a tangent bearing of South 40°40'26" East, a radius of 205.00 feet, a central angle of 137°48'08", a distance of 493.05 feet;

Thence North 73°26'00" West a distance of 773.35 feet;

Thence South 68°03'39" West a distance of 457.83 feet;

Thence South 00°37'40" West a distance of 32.62 feet;

Thence South 61°24'58" East a distance of 620.39 feet;

Thence along the arc of a non tangent curve to the left having a tangent bearing of South 35°59'42" East, a radius of 223.07 feet, a central angle of 38°53'48", a distance of 151.44 feet;

Thence along the arc of a non tangent curve to the left having a tangent bearing of South 20°44'56" East, a radius of 50.00 feet, a central angle of 122°54'51", a distance of 107.26 feet;

Thence along the arc of a reverse curve to the right having a radius of 25.50 feet, a central angle of 45°30'42", a distance of 20.26 feet;

Thence North 81°50'55" East a distance of 28.01 feet;

Thence South 67°19'03" East a distance of 188.26 feet;

Thence along the arc of a curve to the right having a radius of 160.00 feet, a central angle of 60°22'49", a distance of 168.61 feet;

Thence South 06°56'14" East a distance of 43.86 feet;

Thence North 64°46'43" East a distance of 434.49 feet;

Thence along the arc of a non tangent curve to the left having a tangent bearing of South 85°41'44" East, a radius of 437.50 feet, a central angle of 00°34'52", a distance of 4.44 feet;

Thence along the arc of a reverse curve to the right having a radius of 302.50 feet, a central angle of 21°57'01", a distance of 115.89 feet;

Thence South 64°19'35" East a distance of 7.54 feet;

Thence along the arc of a curve to the right having a radius of 25.50 feet, a central angle of 78°50'25", a distance of 35.09 feet;

Thence along the arc of a reverse curve to the left having a radius of 222.50 feet, a central angle of 33°45'55", a distance of 131.12 feet;

Thence along the arc of a reverse curve to the right having a radius of 277.50 feet, a central angle of 48°15'35", a distance of 233.74 feet;

Thence South 29°00'30" West a distance of 67.42 feet;

Thence North 47°39'18" West a distance of 101.73 feet to the POINT OF BEGINNING.

Containing 34.05 Acres, more or less.

Prepared By:

Harlan King & Associates
P.O. Box 70098
Reno, Nevada 89570
Office: 775.852.1777

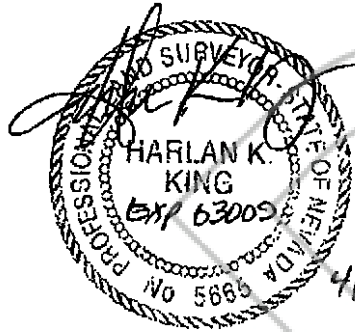

**Adjusted Parcel 14
LEGAL DESCRIPTION**

A parcel of land situate in Sections 3, 4, 9 and 10, Township 14 North, Range 19 East, MDM, Douglas County, Nevada and being more particularly described as follows:

COMMENCING at the Southwest corner of said Section 3;

Thence South 58°18'31" West a distance of 331.86 feet to the **POINT OF BEGINNING**;

Thence North 22°33'05" East a distance of 39.91 feet;

Thence along the arc of a curve to the right having a radius of 215.00 feet, a central angle of 57°01'16", a distance of 213.97 feet;

Thence North 79°34'20" East a distance of 285.30 feet;

Thence South 83°49'43" East a distance of 234.37 feet;

Thence North 65°07'48" East a distance of 324.52 feet;

Thence North 22°11'41" West a distance of 37.34 feet;

Thence along the arc of a non tangent curve to the right having a tangent bearing of South 82°04'30" West, a radius of 310.00 feet, a central angle of 48°47'14", a distance of 263.96 feet;

Thence along the arc of a reverse curve to the left having a radius of 365.00 feet, a central angle of 28°02'36", a distance of 178.65 feet;

Thence along the arc of a reverse curve to the right having a radius of 240.00 feet, a central angle of 52°59'50", a distance of 221.99 feet;

Thence along the arc of a reverse curve to the left having a radius of 150.00 feet, a central angle of 42°21'11", a distance of 110.88 feet;

Thence North 29°00'30" East a distance of 120.56 feet;

Thence along the arc of a curve to the left having a radius of 322.50 feet; a central angle of 48°15'35", a distance of 271.64;

Thence along the arc of a reverse curve to the right having a radius of 177.50 feet, a central angle of 32°14'34", a distance of 99.89 feet;

Thence South 50°39'58" East a distance of 705.40 feet;

Thence North 89°15'43" East a distance of 401.46 feet;

Thence along the arc of a curve to the right having a radius of 150.00 feet; a central angle of 61°28'23", a distance of 160.94 feet;

- Thence South 29°15'54" East a distance of 8.03 feet;
- Thence North 74°22'53" East a distance of 321.90 feet;
- Thence North 13°33'21" West a distance of 418.99 feet;
- Thence North 13°00'35" West a distance of 208.16 feet;
- Thence North 08°15'21" East a distance of 198.49 feet;
- Thence North 10°23'00" East a distance of 480.75 feet;
- Thence along the arc of a non tangent curve to the left having a tangent bearing of North 63°07'05" East, a radius of 422.50 feet, a central angle of 31°29'23", a distance of 232.21 feet;
- Thence along the arc of a reverse curve to the right having a radius of 277.50 feet, a central angle of 27°49'16", a distance of 134.75 feet;
- Thence along the arc of a reverse curve to the left having a radius of 222.50 feet; a central angle of 08°01'37", a distance of 31.17 feet;
- Thence along the arc of a reverse curve to the right having a radius of 28.50 feet; a central angle of 80°25'13", a distance of 40.00 feet;
- Thence along the arc of a compound curve to the right having a radius of 1477.50 feet, a central angle of 10°10'09", a distance of 262.23 feet;
- Thence South 52°00'43" West a distance of 110.26 feet;
- Thence South 27°03'03" West a distance of 215.25 feet;
- Thence South 09°28'15" West a distance of 419.47 feet;
- Thence South 08°37'32" East a distance of 806.80 feet;
- Thence South 06°53'04" West a distance of 46.51 feet;
- Thence South 35°48'00" West a distance of 42.21 feet;
- Thence South 60°28'16" West a distance of 54.92 feet;
- Thence North 88°56'22" West a distance of 43.02 feet;
- Thence South 05°49'43" East a distance of 39.22 feet;
- Thence South 11°56'56" West a distance of 42.32 feet;
- Thence South 31°57'03" West a distance of 115.43 feet;
- Thence North 78°50'35" East a distance of 296.06 feet;

Thence South 86°37'44" East a distance of 888.56 feet;

Thence along the arc of a non tangent curve to the right having a tangent bearing of South 19°51'12" East, a radius of 177.50 feet, a central angle of 122°13'33", a distance of 378.65 feet;

Thence along the arc of a reverse curve to the left having a radius of 672.50 feet, a central angle of 36°16'17", a distance of 425.73 feet;

Thence South 66°06'04" West a distance of 140.48 feet;

Thence along the arc of a curve to the right having a radius of 527.50 feet, a central angle of 16°06'40", a distance of 148.33 feet;

Thence North 47°18'21" West a distance of 67.11 feet;

Thence South 80°22'34" West a distance of 474.82 feet;

Thence South 04°27'19" East a distance of 192.36 feet;

Thence North 86°49'18" West a distance of 252.56 feet;

Thence along the arc of a curve to the left having a radius of 274.50 feet, a central angle of 32°24'16", a distance of 155.25 feet, to the beginning of a non tangent line;

Thence along said non tangent line, South 68°51'58" West a distance of 188.80 feet;

Thence South 65°50'16" West a distance of 720.59 feet;

Thence North 20°29'28" West a distance of 206.77 feet;

Thence North 51°38'14" West a distance of 48.93 feet;

Thence North 23°01'02" West a distance of 65.53 feet;

Thence North 59°36'49" East a distance of 291.94 feet;

Thence North 82°59'40" West a distance of 591.93 feet;

Thence South 55°47'42" West a distance of 82.54 feet;

Thence North 78°38'33" West a distance of 589.01 feet;

Thence South 27°29'02" West a distance of 38.46 feet;

Thence South 62°40'45" East a distance of 825.79 feet;

Thence South 86°07'21" East a distance of 77.83 feet;

Thence North 67°49'41" East a distance of 100.01 feet;



Thence South 79°30'35" East a distance of 80.02 feet;

Thence South 60°37'57" East a distance of 63.14 feet;

Thence South 20°29'28" East a distance of 199.68 feet;

Thence along the arc of a curve to the left having a radius of 350.00 feet, a central angle of 00°54'03", a distance of 5.50 feet;

Thence along the arc of a non tangent reverse curve to the right having tangent bearing of South 23°22'57" West, a radius of 190.24 feet, a central angle of 132°21'15", a distance of 439.46 feet;

Thence North 70°20'38" West a distance of 472.32 feet;

Thence North 46°59'26" West a distance of 666.05 feet;

Thence South 51°44'09" West a distance of 89.47 feet;

Thence South 17°56'11" East a distance of 240.88 feet;

Thence South 11°37'48" East a distance of 370.70 feet;

Thence along the arc of a curve to the right having a radius of 250.00 feet, a central angle of 45°32'37", a distance of 198.72 feet;

Thence South 33°54'49" West a distance of 200.32 feet;

Thence along the arc of a non tangent curve to the left having a tangent bearing of South 80°36'29" West, a radius of 872.50 feet, a central angle of 09°56'46", a distance of 151.46 feet;

Thence along the arc of a reverse curve to the right having a radius of 402.50 feet, a central angle of 17°51'58", a distance of 125.51 feet;

Thence North 15°02'27" West a distance of 331.55 feet;

Thence North 04°56'54" West a distance of 223.97 feet;

Thence North 47°17'26" West a distance of 598.02 feet;

Thence North 44°07'51" West a distance of 451.25 feet;

Thence North 53°16'52" East a distance of 249.86 feet;

Thence South 58°39'12" East a distance of 801.85 feet;

Thence North 30°58'50" East a distance of 200.22 feet;

Thence North 35°15'29" East a distance of 100.57 feet;

Thence North 30°11'41" West a distance of 89.77 feet;



Thence South 80°58'33" West a distance of 25.01 feet;

Thence along the arc of a curve to the right having a radius of 80.00, a central angle of 96°00'50", a distance of 134.06 feet;

Thence North 03°00'37" West a distance of 2.63 feet;

Thence North 56°33'27" West a distance of 29.30 feet;

Thence along the arc of a curve to the right having a radius of 40.00 feet, a central angle of 74°00'00", a distance of 51.66 feet;

Thence North 17°26'33" East a distance of 23.22 feet;

Thence along the arc of a curve to the left having a radius of 60.00 feet, a central angle of 107°26'33", a distance of 112.51 feet;

Thence North 90°00'00" West a distance of 28.33 feet;

Thence along the arc of a curve to the right having a radius of 80.00 feet, a central angle of 68°59'07", a distance of 96.32 feet;

Thence North 21°00'53" West a distance of 25.90 feet;

Thence South 50°41'00" West a distance of 357.90 feet;

Thence South 54°11'24" West a distance of 346.67 feet;

Thence North 32°34'32" West a distance of 114.56 feet;

Thence North 25°36'13" West a distance of 116.47 feet;

Thence North 25°32'10" East a distance of 68.64 feet;

Thence North 29°30'12" East a distance of 207.42 feet;

Thence North 64°46'58" East a distance of 886.88 feet;

Thence along the arc of a non tangent curve to the left having a tangent bearing of South 48°51'07" East, a radius of 372.50 feet, a central angle of 22°10'16", a distance of 144.14 feet;

Thence South 13°03'16" West a distance of 57.96 feet;

Thence South 43°10'33" East a distance of 410.79 feet;

Thence South 65°59'00" East a distance of 830.67 feet to the POINT OF BEGINNING.

Containing 110.08 Acres, more or less.

Prepared By:

Harlan King & Associates
P.O. Box 70098
Reno, Nevada 89570
Office: 775.852.1777

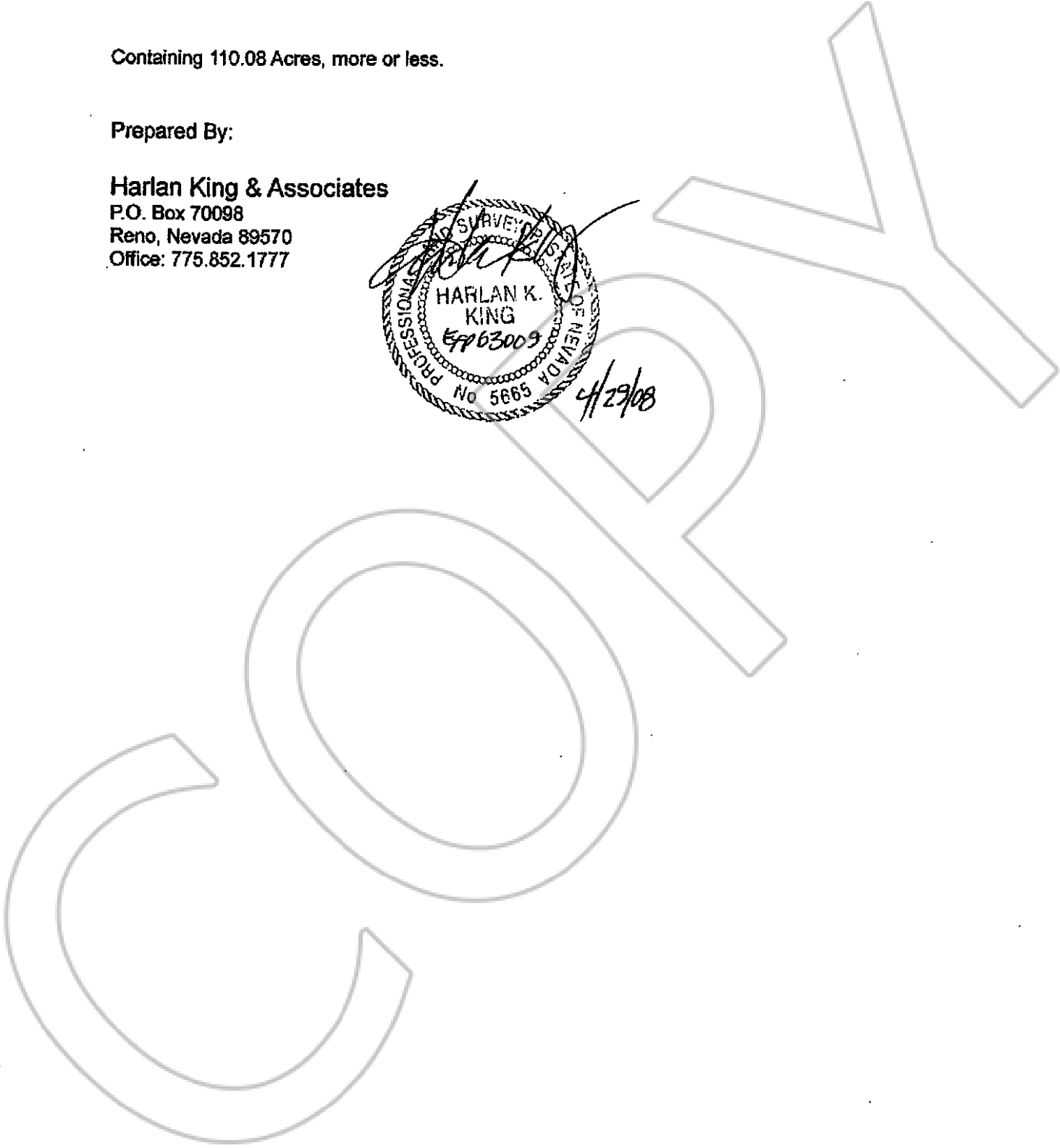
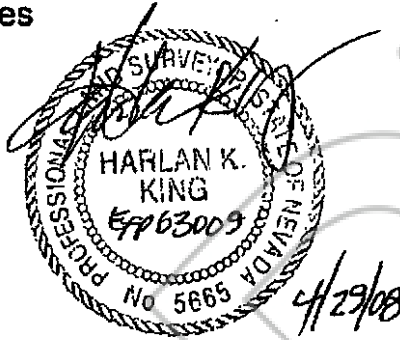

**Adjusted Parcel 15
LEGAL DESCRIPTION**

A parcel of land situate in Section 10, Township 14 North, Range 19 East, MDM, Douglas County, Nevada and being more particularly described as follows:

COMMENCING at the Northwest corner of Section 10;

Thence South 69°30'40" East a distance of 1288.77 feet to the **POINT OF BEGINNING**;

Thence South 86°49'18" East a distance of 309.87 feet;

Thence along the arc of a curve to the left having a radius of 247.50 feet, a central angle of 59°33'55", a distance of 257.30 feet;

Thence along the arc of a reverse curve to the right having a radius of 277.50 feet, a central angle of 48°35'57", a distance of 235.38 feet;

Thence along the arc of a reverse curve to the left having a radius of 572.50 feet, a central angle of 16°06'40", a distance of 160.98 feet;

Thence North 66°06'04" East a distance of 140.48 feet;

Thence along the arc of a curve to the right having a radius of 627.50 feet, a central angle of 04°36'22", a distance of 50.45 feet;

Thence South 69°06'18" East a distance of 729.87 feet;

Thence South 51°38'15" East a distance of 230.44 feet;

Thence South 05°03'22" East a distance of 226.16 feet;

Thence South 52°11'03" West a distance of 126.80 feet;

Thence North 89°59'02" West a distance of 139.18 feet;

Thence North 45°36'05" West a distance of 167.23 feet;

Thence North 66°27'30" West a distance of 546.81 feet;

Thence South 75°01'43" West a distance of 698.78 feet;

Thence along the arc of a non tangent curve to the right having a tangent bearing of South 18°00'42" West, a radius of 210.00 feet, a central angle of 135°28'23", a distance of 496.53 feet;

Thence North 02°48'16" West a distance of 247.01 feet to the **POINT OF BEGINNING**.

Containing 15.33 Acres, more or less.

Prepared By:

Harlan King & Associates
P.O. Box 70098
Reno, Nevada 89570
Office: 775.852.1777



4/29/08

COPY

**Adjusted Parcel 16
LEGAL DESCRIPTION**

A parcel of land situate in Sections 3 and 10, Township 14 North, Range 19 East, MDM, Douglas County, Nevada and being more particularly described as follows:

COMMENCING at the Southwest corner of said Section 3;

Thence South 87°01'18" East a distance of 2262.72 feet to the **POINT OF BEGINNING**;

Thence along the arc of a non tangent curve to the right having a tangent bearing of North 70°42'26" East, a radius of 627.50 feet, a central angle of 31°39'55", a distance of 346.80 feet;

Thence along the arc of a reverse curve to the left having a radius of 222.50 feet, a central angle of 122°13'33", a distance of 474.65 feet;

Thence along the arc of a reverse curve to the right having a radius of 427.50 feet, a central angle of 04°50'44", a distance of 36.15 feet;

Thence along the arc of a compound curve to the right having a radius of 25.50 feet, a central angle of 96°51'28", a distance of 43.11;

Thence North 81°51'00" East a distance of 52.27 feet;

Thence along the arc of a curve to the right having a radius of 177.50 feet, a central angle of 55°30'26", a distance of 171.96 feet;

Thence along the arc of a reverse curve to the left having a radius of 322.50 feet, a central angle of 24°48'51", a distance of 139.67 feet;

Thence South 13°45'40" West a distance of 121.96 feet;

Thence South 22°40'01" East a distance of 186.87 feet;

Thence South 65°01'02" East a distance of 192.69 feet;

Thence South 73°12'58" West a distance of 486.50 feet;

Thence North 69°06'18" West a distance of 729.87 feet to the **POINT OF BEGINNING**.

Containing 6.80 Acres, more or less.

Prepared By:

Harlan King & Associates
P.O. Box 70098
Reno, Nevada 89570
Office: 775.852.1777

