

APN: 1320-11-001-018

When Recorded Return to:
Glenn R. Lyon
1014 E Pomello
Claremont, Ca 91711
Mail Tax Statements to:
Grantee same as above

Douglas County - NV
Karen Ellison - Recorder
Page: 1 of 2 Fee: 15.00
BK-0712 PG- 6655 RPTT: # 7



SPACE ABOVE FOR RECORDERS USE

Grant, Bargain, Sale Deed

For valuable consideration, the receipt of which is hereby acknowledged, Glenn R. Lyon and Peggy L. Lyon, husband and wife, as joint tenants with right of survivorship

do(es) hereby Grant, Bargain, Sell and Convey to Glenn R. Lyon and Peggy L. Lyon, Trustees, or their successors in Trust, under the Lyon Living Trust of 1997, and any amendments thereto.

all that real property situated in the County of Douglas, State of Nevada, described as follows:

See Exhibit A attached hereto and made a part hereof.

Together with all and singular the tenements, hereditaments and appurtenances thereunto belonging or in anywise appertaining.

Dated: June 19, 2012

Glenn R. Lyon

Peggy L. Lyon

STATE OF NEVADA
COUNTY OF DOUGLAS

This instrument was acknowledged before me on 7/26/12,
by Glenn R. Lyon and Peggy L. Lyon

NOTARY PUBLIC

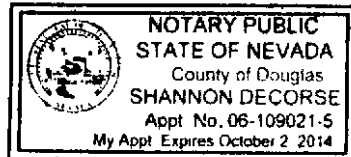

SPACE BELOW FOR RECORDER

Exhibit A

All that real property situate in the Northeast ¼ of Section 11, Township 13 North, Range 20 East, M.D.B. & M., more particularly described as follows:

Parcel No. 3, of that Parcel Map for Roy and Mary Collier, filed for record in the office of the Recorder of Douglas County, Nevada, on December 22, 1988 in Book 1288, at page 3079, Document No. 193135, Official Records.

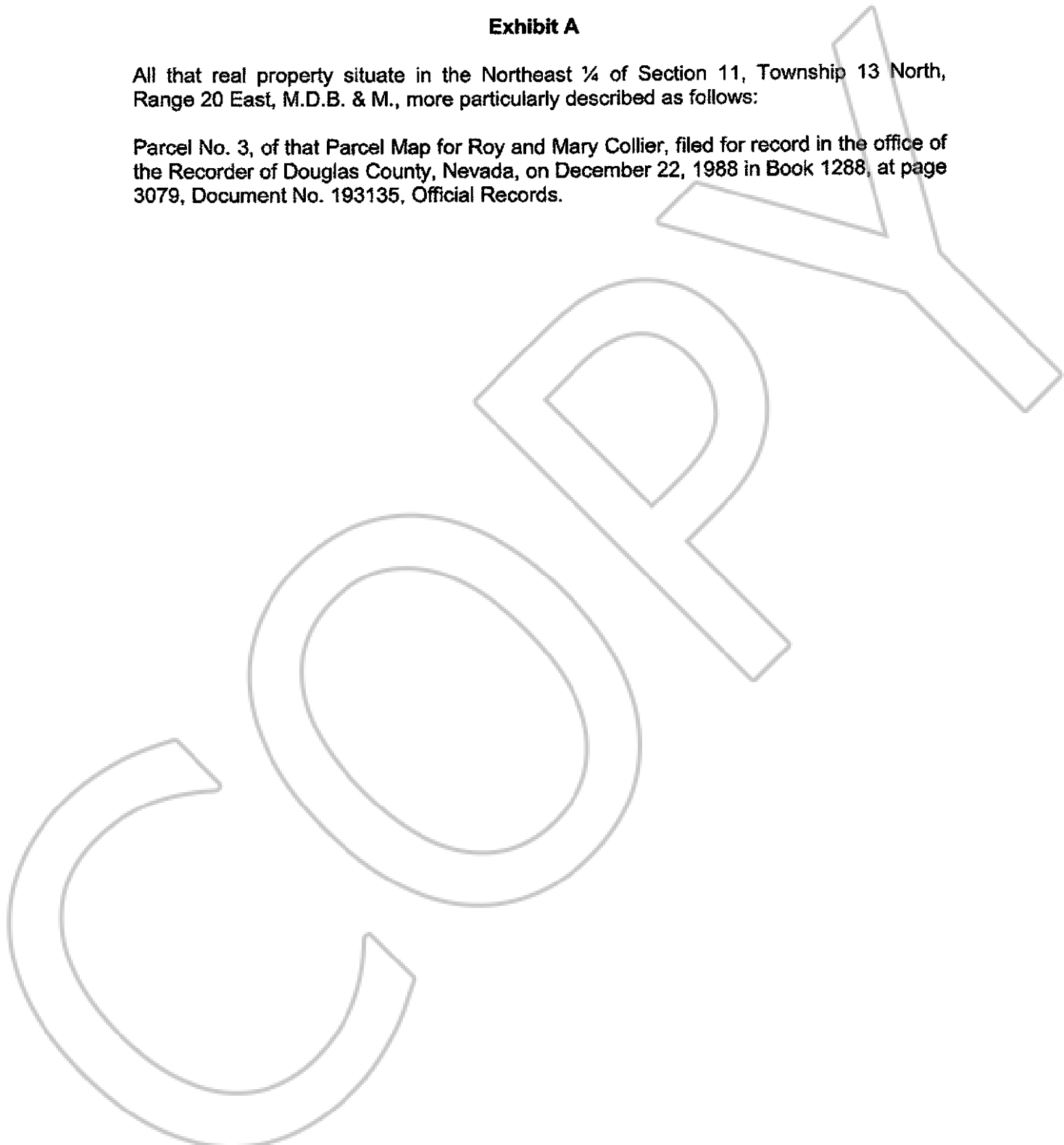

SPACE BELOW FOR RECORDER