

TOWNSHIP 11 NORTH, RANGE 20 EAST, MOUNT DIABLO MERIDIAN, NEVADA
SECTION 13
DEPENDENT RESURVEY AND SECTION SUBDIVISION

SURVEYOR'S CERTIFICATE

REFERENCES

- 1) 1861 BUTLER IVES FIELD NOTES OF THE SECOND STANDARD PARALLEL NORTH THROUGH RANGES 21, 22, 23 & 24 EAST OF MOUNT DIABLO MERIDIAN, CALIFORNIA AND NEVADA, APPROVED SEPTEMBER 18, 1861.
- 2) 1861 BUTLER IVES FIELD NOTES OF THE NORTH AND EAST BOUNDARY OF TOWNSHIP 11 NORTH, RANGE 20 EAST, AND THE SOUTH BOUNDARY OF TOWNSHIP 11 NORTH RANGE 21 EAST, MOUNT DIABLO MERIDIAN, NEVADA, APPROVED SEPTEMBER 18, 1861.
- 3) U.S. GLO PLAT OF TOWNSHIP 11 NORTH, RANGE 20 EAST, OF THE MOUNT DIABLO MERIDIAN, NEVADA, APPROVED NOVEMBER 9, 1865.
- 4) U.S. GLO PLAT OF TOWNSHIP 11 NORTH, RANGE 20 EAST, OF THE MOUNT DIABLO MERIDIAN, CALIFORNIA AND NEVADA, APPROVED NOVEMBER 9, 1865.
- 5) 1865 PORTER RECTOR FIELD NOTES OF THE SOUTH AND WEST BOUNDARIES OF TOWNSHIP 11 NORTH, RANGE 20 EAST, MOUNT DIABLO MERIDIAN, CALIFORNIA, APPROVED NOVEMBER 9, 1865.
- 6) 1865 PORTER RECTOR FIELD NOTES OF THE SUBDIVISION OF TOWNSHIP 11 NORTH, RANGE 20 EAST, MOUNT DIABLO MERIDIAN CALIFORNIA AND NEVADA, APPROVED NOVEMBER 9, 1865.
- 7) U.S. GLO PLAT OF TOWNSHIP 10 NORTH, RANGE 21 EAST, OF THE MOUNT DIABLO MERIDIAN, CALIFORNIA, APPROVED JANUARY 13, 1876.
- 8) 1875 J.R. GLOVER FIELD NOTES OF THE SUBDIVISIONAL LINES OF TOWNSHIP 10 NORTH, RANGE 21 EAST, MOUNT DIABLO MERIDIAN, CALIFORNIA, APPROVED JANUARY 13, 1876.
- 9) 1875 J.R. GLOVER FIELD NOTES OF THE EAST AND WEST BOUNDARIES OF TOWNSHIP 10 NORTH, RANGE 21 EAST, MOUNT DIABLO MERIDIAN, CALIFORNIA, APPROVED JANUARY 3, 1876.
- 10) 1873 ALLEKEY W. VON SCHMIDT FIELD NOTES OF THE EASTERN BOUNDARY OF THE STATE OF CALIFORNIA, APPROVED JANUARY 30, 1874.
- 11) 1875 W. H. CARLTON FIELD NOTES OF SECTION LINE CONNECTIONS TO THE VON SCHMIDT LINE IN TOWNSHIP 11 NORTH, RANGE 21 EAST, MOUNT DIABLO MERIDIAN, APPROVED JULY 8, 1875.
- 12) U.S. GLO PLAT OF TOWNSHIP 11 NORTH, RANGE 21 EAST, OF THE MOUNT DIABLO MERIDIAN, NEVADA AND CALIFORNIA, APPROVED OCTOBER 27, 1881.
- 13) U.S. GLO PLAT OF TOWNSHIP 10 NORTH, RANGE 20 EAST, OF THE MOUNT DIABLO MERIDIAN, CALIFORNIA, APPROVED MARCH 12, 1877.
- 14) U.S. GLO PLAT OF TOWNSHIP 10 NORTH, RANGE 21 EAST, OF THE MOUNT DIABLO MERIDIAN, NEVADA, APPROVED OCTOBER 27, 1881.
- 15) 1855 A. H. JONES FIELD NOTES OF THE SURVEY OF THE 2ND STANDARD PARALLEL NORTH & EAST, MOUNT DIABLO MERIDIAN, CALIFORNIA, TRANSCRIBED NOTES APPROVED OCTOBER 18, 1882.
- 16) 1941 ROGER F. WILSON FIELD NOTES OF THE DEPENDENT RESURVEY OF THE COAST AND GEODETIC SURVEY BOUNDARY LINE BETWEEN THE STATES OF CALIFORNIA AND NEVADA FROM MONUMENT NO. 20 TO MONUMENT NO. 30, GROUP NO. 280, APPROVED MAY 5, 1945.
- 17) U.S. BLM DEPENDENT RESURVEY PLAT OF THE SECOND STANDARD PARALLEL NORTH IN TOWNSHIP 11 NORTH, RANGE 21 EAST, OF THE MOUNT DIABLO MERIDIAN, NEVADA AND CALIFORNIA, ACCEPTED DECEMBER 14, 1949.
- 18) 1940 CARL S. SWANHOLM FIELD NOTES OF THE DEPENDENT RESURVEY OF THE SECOND STANDARD PARALLEL NORTH THROUGH RANGE 21 EAST (T11N R21E), MOUNT DIABLO MERIDIAN, CALIFORNIA AND NEVADA, GROUP NO. 246, APPROVED DECEMBER 11, 1949.
- 19) U.S. BLM DEPENDENT RESURVEY PLAT OF A PORTION OF THE SUBDIVISIONAL LINES OF TOWNSHIP 11 NORTH, RANGE 20 EAST, OF THE MOUNT DIABLO MERIDIAN, CALIFORNIA AND NEVADA, ACCEPTED FEBRUARY 18, 1954.
- 20) 1939-1948 CARL S. SWANHOLM FIELD NOTES OF THE DEPENDENT RESURVEY OF THE NORTH AND EAST BOUNDARIES, PORTIONS OF THE WEST AND SOUTH BOUNDARIES, A PORTION OF THE SUBDIVISION LINES AND SURVEY OF TRACTS 37 TO 56, INCLUSIVE, TOWNSHIP 11 NORTH, RANGE 20 EAST, MOUNT DIABLO MERIDIAN, CALIFORNIA AND NEVADA, GROUP NO. 281-C AND 245-N, APPROVED FEBRUARY 18, 1954.
- 21) 1948-1950 ROGER F. WILSON FIELD NOTES OF THE DEPENDENT RESURVEY OF THE VON SCHMIDT CALIFORNIA/NEVADA STATE BOUNDARY, MILES 211-231, GROUP NO. 281-C, APPROVED FEBRUARY 18, 1954.
- 22) 1946-1950 CARL S. SWANHOLM AND ROGER F. WILSON FIELD NOTES OF THE DEPENDENT RESURVEY OF THE COAST AND GEODETIC SURVEY BOUNDARY LINE BETWEEN THE STATES OF CALIFORNIA AND NEVADA FROM MONUMENT NO. 1 TO MONUMENT NO. 20, GROUP NO. 281-C, APPROVED FEBRUARY 18, 1954.
- 23) 1940 CARL S. SWANHOLM FIELD NOTES OF THE DEPENDENT RESURVEY OF THE SUBDIVISION OF TOWNSHIP 10 NORTH, RANGE 21 EAST, MOUNT DIABLO MERIDIAN, NEVADA, GROUP NO. 246 NEVADA, APPROVED AUGUST 23, 1956.
- 24) U.S. BLM DEPENDENT RESURVEY PLAT OF A PORTION OF THE SUBDIVISIONAL LINES OF TOWNSHIP 10 NORTH, RANGE 21 EAST, OF THE MOUNT DIABLO MERIDIAN, NEVADA, ACCEPTED AUGUST 23, 1956.
- 25) U.S. BLM DEPENDENT RESURVEY AND SURVEY PLAT OF A PORTION OF THE SECOND STANDARD PARALLEL NORTH AND A PORTION OF THE SUBDIVISIONAL LINES OF TOWNSHIP 10 NORTH, RANGE 21 EAST, OF THE MOUNT DIABLO MERIDIAN, CALIFORNIA, ACCEPTED JUNE 14, 1961.
- 26) U.S. BLM DEPENDENT RESURVEY PLAT OF A PORTION OF THE SECOND STANDARD PARALLEL NORTH AND A PORTION OF THE SUBDIVISIONAL LINES OF TOWNSHIP 10 NORTH, RANGE 20 EAST, OF THE MOUNT DIABLO MERIDIAN, CALIFORNIA, ACCEPTED AUGUST 1, 1962.
- 27) 1960 BEVERLY M. CAPELL FIELD NOTES OF THE DEPENDENT RESURVEY OF THE SECOND STANDARD PARALLEL NORTH ALONG PORTIONS OF THE SOUTH BOUNDARY OF TOWNSHIP 11 NORTH AND RANGES 19 AND 20 EAST AND A PORTION OF THE SUBDIVISIONAL LINES OF TOWNSHIP 10 NORTH, RANGE 20 EAST, GROUP NO. 463, APPROVED AUGUST 1, 1962.
- 28) 1990-1992 JOAN H. HONDA FIELD NOTES OF THE DEPENDENT RESURVEY OF A PORTION OF THE SUBDIVISIONAL LINES AND THE SUBDIVISION OF SECTIONS 20 AND 29, TOWNSHIP 11 NORTH, RANGE 20 EAST, MOUNT DIABLO MERIDIAN, CALIFORNIA, GROUP NO. 1079, APPROVED AUGUST 2, 1994.
- 29) U.S. BLM DEPENDENT RESURVEY AND SUBDIVISION PLAT OF A PORTION OF THE SUBDIVISIONAL LINES OF TOWNSHIP 11 NORTH, RANGE 20 EAST, OF THE MOUNT DIABLO MERIDIAN, CALIFORNIA AND NEVADA, ACCEPTED AUGUST 23, 2007.
- 30) 2003-2007 DON R. ASCHENBACH FIELD NOTES OF THE DEPENDENT RESURVEY OF A PORTION OF THE SUBDIVISION OF SECTION LINES OF SECTION 25, THE SUBDIVISION OF SECTIONS 14 AND 24 AND THE FURTHER SUBDIVISION OF SECTION 25, TOWNSHIP 11 NORTH, RANGE 20 EAST, MOUNT DIABLO MERIDIAN, NEVADA, GROUP NO. 816, APPROVED AUGUST 23, 2007.
- 31) MAP OF DIVISION INTO LARGE PARCELS FOR G. & S.R. SPRINGMEYER CO., FILED NOVEMBER 17, 1993 IN BOOK 1193 AT PAGE 3424 AS DOCUMENT NO. 322825 IN THE OFFICIAL RECORDS OF DOUGLAS COUNTY, NEVADA.
- 32) RECORD OF SURVEY FOR WEST FORK WATER COMPANY LLC, FILED MARCH 5, 1998 IN BOOK 398 AT PAGE 1113 AS DOCUMENT NO. 434171 IN THE OFFICIAL RECORD OF DOUGLAS COUNTY, NEVADA.
- 33) RECORD OF SURVEY FOR LONG VALLEY RANCH CO., FILED JANUARY 25, 1999 IN BOOK 199 AT PAGE 4639 AS DOCUMENT NO. 459510 IN THE OFFICIAL RECORDS OF DOUGLAS COUNTY, NEVADA.
- 34) RECORD OF SURVEY SUPPORTING A BOUNDARY LINE ADJUSTMENT FOR WESTSIDE NEVADA LLC, FILED APRIL 7, 2005 IN BOOK 0405 AT PAGE 2499 AS DOCUMENT NO. 641138 IN THE OFFICIAL RECORDS OF DOUGLAS COUNTY, NEVADA.
- 35) 1941 GLO, ROGER F. WILSON FIELD NOTES OF THE DEPENDENT RESURVEY OF THE VON SCHMIDT LINE FROM MILE POST 231 TO MILE POST 252, GROUP 280, APPROVED MAY 5, 1945

STATION	LATITUDE	LONGITUDE	METERS		U.S. SURVEY FEET	
			NORTHING	EASTING	NORTHING	EASTING
U.S.F.S. PARCEL CORNERS						
200	38 49 24.9986	119 41 28.0680	4452601.850	703806.073	14608244.57	2309070.42
200-RM1	38 49 23.8526	119 41 28.0570	4452566.510	703805.908	14608128.62	2309069.88
200-RM2	38 49 24.9890	119 41 26.2951	4452601.032	703484.832	14608241.89	2309210.71
201	38 49 11.9856	119 41 27.9404	4452200.558	703804.285	14606928.00	2309064.56
202	38 49 12.0833	119 41 44.5680	4452208.443	703403.227	14606953.87	2307748.75
203	38 48 58.9726	119 41 27.8129	4451799.267	703802.497	14605611.43	2309058.69
204	38 48 46.1517	119 41 27.6953	4451403.900	703800.543	14604314.30	2309052.28
205	38 48 46.0676	119 41 44.3000	4451406.172	703399.929	14604321.75	2307737.93
603	38 49 24.7347	119 40 38.1191	4452579.197	705010.796	14608170.25	2313022.92
606	38 48 58.6610	119 40 38.0865	4451775.211	705001.957	14605532.50	2312993.92
607	38 48 32.6741	119 40 38.1281	4450973.923	704991.365	14602903.61	2312959.17
616	38 48 33.0597	119 41 44.1742	4451005.041	703398.082	14603005.70	2307731.88
626	38 49 24.9054	119 41 11.4257	4452594.118	704207.467	14608219.20	2310387.33
629	38 48 33.6010	119 41 10.9812	4451012.027	704199.097	14603028.62	2310359.87
717	38 49 20.0913	119 41 44.7102	4452600.582	703404.679	14608269.94	2307753.52
858	38 48 59.0754	119 41 44.4258	4451807.304	703401.775	14605637.80	2307743.99

- I, CHARLES "KEN" IWAMURA, A PROFESSIONAL LAND SURVEYOR LICENSED IN THE STATE OF NEVADA, AS AGENT FOR TRI STATE SURVEYING, LTD., DO HEREBY CERTIFY THAT:
1. THIS PLAT REPRESENTS THE RESULTS OF A SURVEY CONDUCTED UNDER MY DIRECT SUPERVISION AT THE INSTANCE OF THE USDA, FOREST SERVICE.
 2. THE LANDS SURVEYED LIE WITHIN A PORTION OF SECTION 13 OF TOWNSHIP 11 NORTH, RANGE 20 EAST, MOUNT DIABLO MERIDIAN, DOUGLAS COUNTY, NEVADA, AND THE SURVEY WAS COMPLETED BETWEEN JANUARY 2011 AND DECEMBER 2011.
 3. THIS PLAT COMPLIES WITH THE APPLICABLE STATE STATUTES AND ANY LOCAL ORDINANCES IN EFFECT ON THE DATE THAT THE GOVERNING BODY GAVE ITS FINAL APPROVAL, AND THE SURVEY WAS CONDUCTED IN ACCORDANCE WITH CHAPTER 625 OF THE NEVADA ADMINISTRATIVE CODE.
 4. THE MONUMENTS DEPICTED ON THE PLAT ARE OF THE CHARACTER SHOWN, OCCUPY THE POSITIONS INDICATED AND ARE OF SUFFICIENT NUMBER AND DURABILITY.

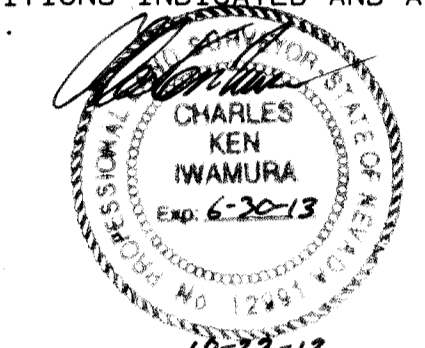

DATE: 10-29-12
 CHARLES "KEN" IWAMURA
 PROFESSIONAL LAND SURVEYOR
 NEVADA CERTIFICATE NO. 12991

NOTES

1. THIS RECORD OF SURVEY IS NOT IN CONFLICT WITH THE REQUIREMENTS OF NRS 278.010 TO 278.063 AND NO NEW PARCELS HAVE BEEN CREATED.
2. ALL DISTANCES SHOWN HEREON ARE GROUND DISTANCES.
3. THE COORDINATES SHOWN ARE STATE PLANE COORDINATES BASED ON THE NORTH AMERICAN DATUM 1983 (NAD83) EPOCH 2002.00 NEVADA STATE PLANE COORDINATE SYSTEM, ZONE WEST. THE PROJECT COMBINED FACTOR USED FOR THIS AREA IS 0.99975006

COUNTY RECORDER'S CERTIFICATE

FILED FOR RECORD AT THE REQUEST OF TRI STATE SURVEYING, LTD.
 ON THIS 29th DAY OF October, 2012, AT
9 MINUTES 9 O'CLOCK A.M. IN BOOK 1012
 PAGE 7049 THE OFFICIAL RECORDS OF DOUGLAS COUNTY, NEVADA.
 RECORDING FEE: \$41.00 BY: K. Ellison RECORDER
 FILE NUMBER: 811626 BY: Shawnae Taven DEPUTY



VICINITY MAP

(NOT TO SCALE)

RECORD OF SURVEY
 FOR
U.S. DEPARTMENT OF AGRICULTURE
FOREST SERVICE
HUMBOLDT-TOYABE NATIONAL FOREST
DEPENDENT RESURVEY
 SECTION 13, T.11N., R.20E., M.D.M.
 DOUGLAS COUNTY, NEVADA

TRI STATE SURVEYING, LTD JOB #10145-01.RM
 1925 E. PRATER WAY
 SPARKS, NEVADA 89434
 (775) 358-9491 FAX # 358-3664

SHEET 1
OF 3

TOWNSHIP 11 NORTH, RANGE 20 EAST, MOUNT DIABLO MERIDIAN, NEVADA
SECTION 13
DEPENDENT RESURVEY AND SECTION SUBDIVISION

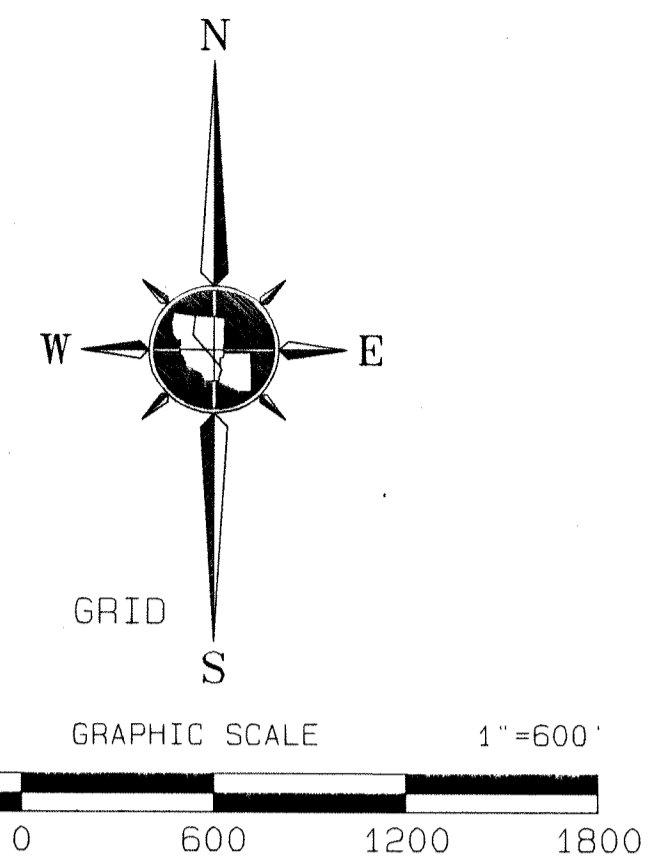

BASIS OF BEARINGS

NORTH 38°30'08.6" EAST, BEING THE GRID BEARING BETWEEN NATIONAL GEODETIC SURVEY (NGS) CONTINUOUSLY OPERATING REFERENCE STATIONS (CORS) CM88 AND UPSA BASED UPON THE NORTH AMERICAN DATUM 1983 (CORS) EPOCH 2002.00 NEVADA STATE PLANE COORDINATE SYSTEM, ZONE WEST.

CORS STATION CM88 - NAD83 (CORS)
 LATITUDE 38°02'03.01909" NORTH
 LONGITUDE 120°23'09.69114" WEST
 GRID NORTHING 14323889.95 US SURVEY FEET
 GRID EASTING 2105468.56 US SURVEY FEET

CORS STATION UPSA - NAD83 (CORS)
 LATITUDE 39°37'37.58721" NORTH
 LONGITUDE 118°48'08.15363" WEST
 GRID NORTHING 14899041.19 US SURVEY FEET
 GRID EASTING 2563003.95 US SURVEY FEET

CONVERGENCE ANGLE & COMBINED FACTOR

THE CONVERGENCE ANGLE FOR THIS SURVEY WAS DETERMINED AT THE SOUTHWEST CORNER OF SECTION 13, CORNER NO. 616 OF THIS SURVEY AND WAS TAKEN AS -00°41'50".
 GEODETIC BEARING = GRID BEARING + CONVERGENCE ANGLE

THE PROJECT COMBINED FACTOR USED FOR THIS AREA IS 0.99975006
 GRID DISTANCE = GROUND DISTANCE X COMBINED FACTOR

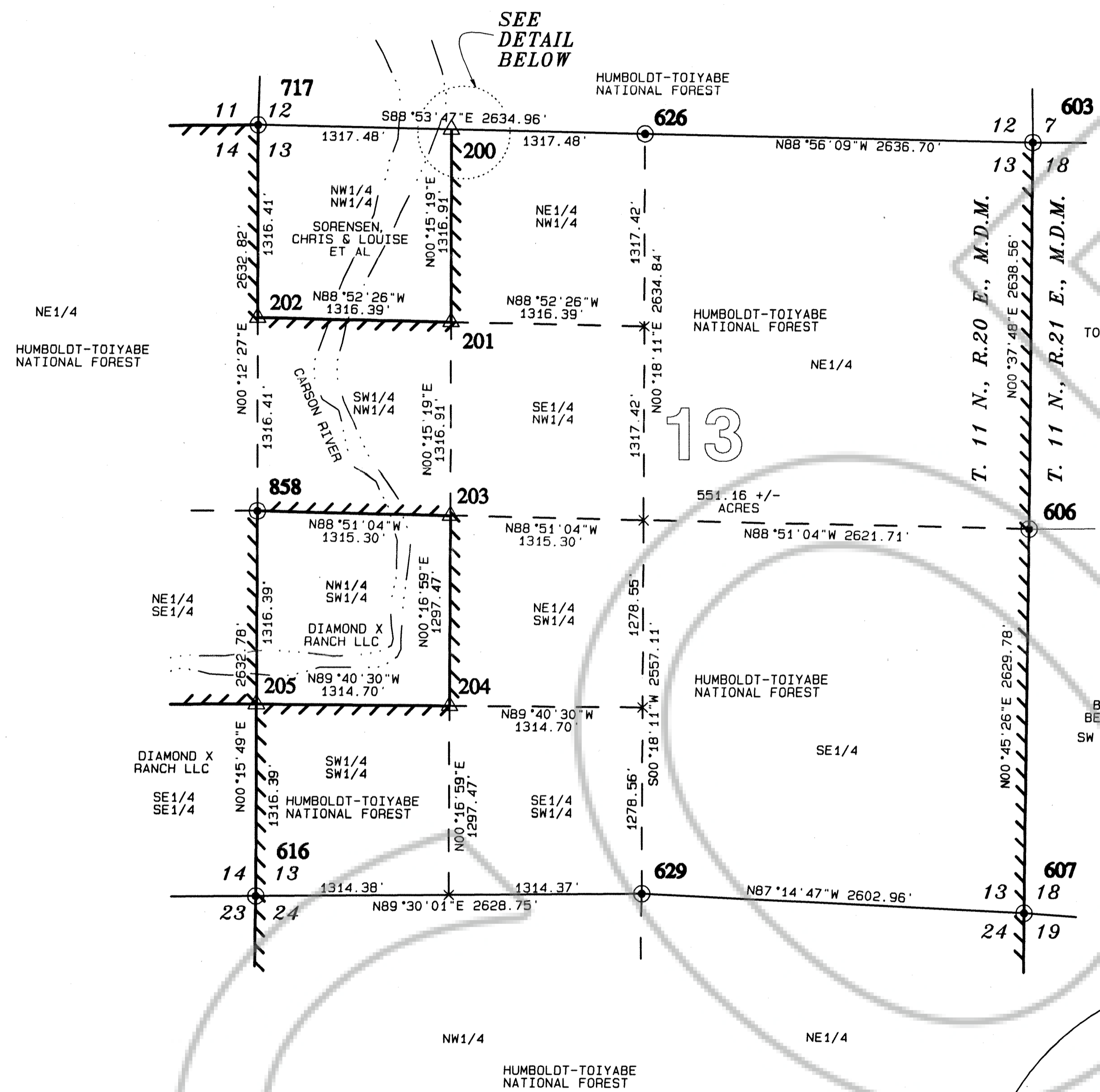

LEGEND

- NATIONAL FOREST BOUNDARY - SURVEYED, MARKED & POSTED
- SECTION LINE
- SECTIONAL BREAKDOWN LINE
- ADJACENT PARCEL LINE
- FOUND U.S. GENERAL LAND OFFICE (GLO) IRON POST/BRASS CAP
- FOUND U.S. BUREAU OF LAND MANAGEMENT (BLM) STAINLESS STEEL PIPE/BRASS CAP
- FOUND U.S. DEPT. OF AGRICULTURE 3-1/4" DIA. ALUM. CAP ON 2-1/2" DIA. ALUM. PIPE
- SET U.S. DEPT. OF AGRICULTURE 3-1/4" DIA. ALUM. CAP ON 2-1/2" DIA. BY 30" LONG ALUM. PIPE, WITH MAGNET BENEATH BASE.
- DIMENSION POINT
- 606** CORNER NUMBER (SEE COORDINATE DATA TABLE, SHEET 1)
- 54-9 SIGN U.S. FOREST SERVICE LAND SURVEY MONUMENT SIGN, NO. 54-9
- 54-2 SIGN U.S. FOREST SERVICE PROPERTY BOUNDARY SIGN, NO. 54-2
- 54-3 SIGN U.S. FOREST SERVICE BEARING TREE SIGN, NO. 54-3
- LKS LINKS
- 'BT' BEARING TREE
- B.I.A. INDIAN LAND HELD IN TRUST BY THE BUREAU OF INDIAN AFFAIRS

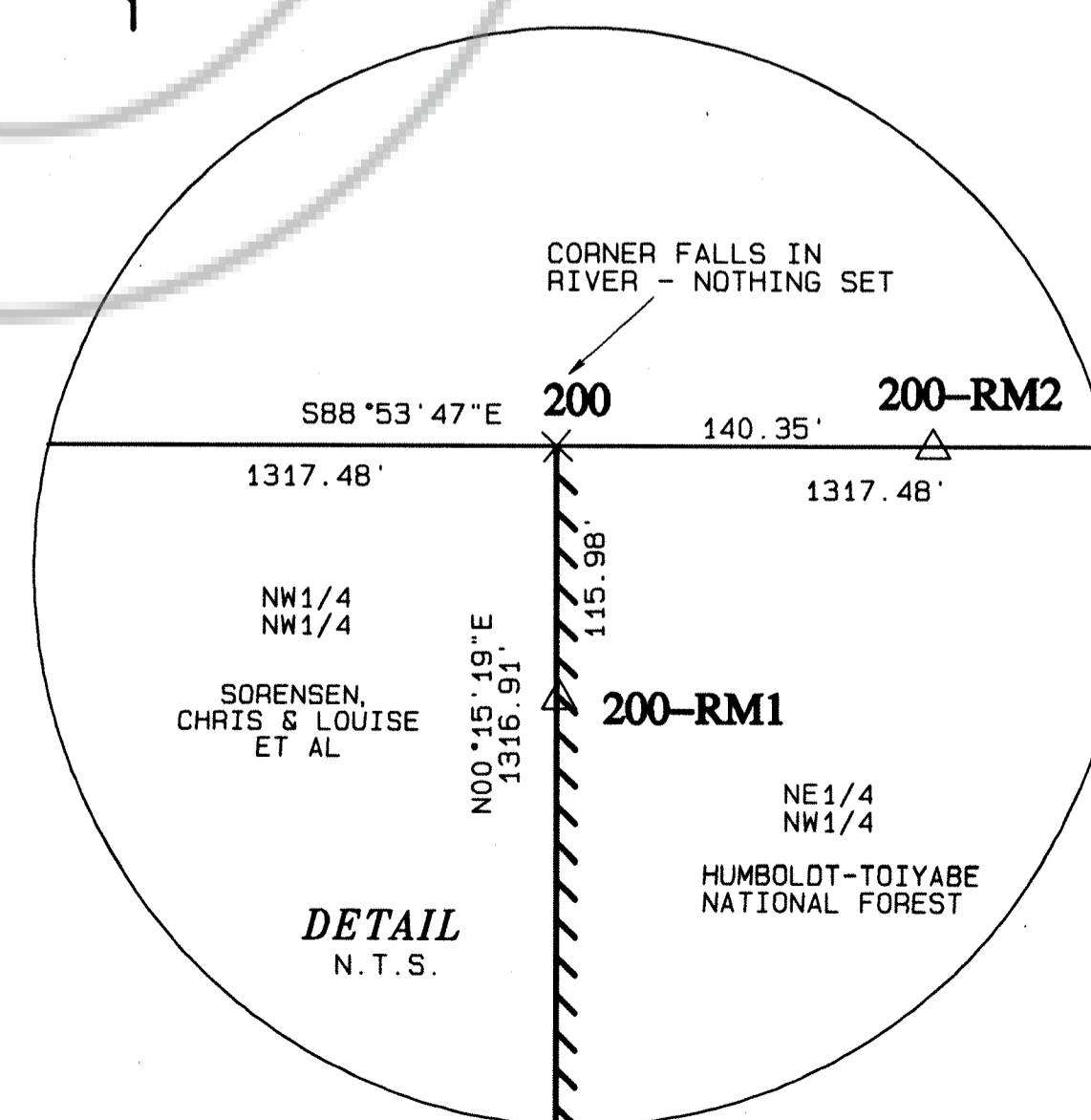

RECORD OF SURVEY
 FOR
 U.S. DEPARTMENT OF AGRICULTURE
 FOREST SERVICE
 HUMBOLDT-TOIYABE NATIONAL FOREST
 DEPENDENT RESURVEY
 SECTION 13, T.11N., R.20E., M.D.M.
 DOUGLAS COUNTY, NEVADA

TRI STATE SURVEYING, LTD JOB #10145.01.RM
 1925 E. PRATER WAY SHEET 2
 SPARKS, NEVADA 89434
 (775) 358-9491 FAX # 358-3664 OF 3

TOWNSHIP 11 NORTH, RANGE 20 EAST, MOUNT DIABLO MERIDIAN, NEVADA
SECTION 13
DEPENDENT RESURVEY AND SECTION SUBDIVISION

200-RM1

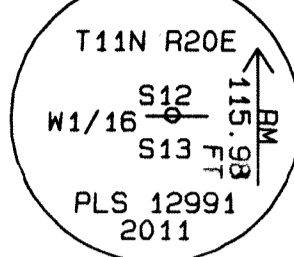

SET U.S. DEPT. OF AGRICULTURE 3-1/4" DIA. ALUM. CAP ON 2-1/2" DIA. BY 30" LONG ALUM. PIPE, WITH MAGNET BENEATH BASE. 0.3' ABOVE GROUND IN A 2.5' DIA. X 0.3' HIGH MOUND OF STONE. CAP STAMPED AS SHOWN. SET ALUM. POST WITH 54-2 & 54-9 SIGNS 1.1' EAST OF CAP. NO BEARING OBJECTS AVAILABLE.

200-RM2

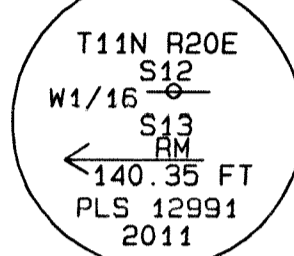

SET U.S. DEPT. OF AGRICULTURE 3-1/4" DIA. ALUM. CAP ON 2-1/2" DIA. BY 30" LONG ALUM. PIPE, WITH MAGNET BENEATH BASE. 0.1' ABOVE GROUND IN A 2.5' DIA. X 0.1' HIGH MOUND OF STONE. CAP STAMPED AS SHOWN. SET ALUM. POST WITH 54-2 & 54-9 SIGNS 1.6' EAST OF CAP. NO BEARING OBJECTS AVAILABLE.

201

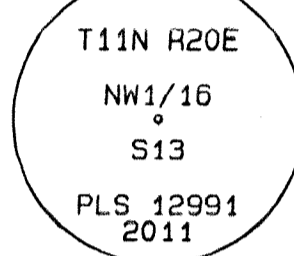

SET U.S. DEPT. OF AGRICULTURE 3-1/4" DIA. ALUM. CAP ON 2-1/2" DIA. BY 30" LONG ALUM. PIPE, WITH MAGNET BENEATH BASE. 0.6' ABOVE GROUND IN 3.5' DIA. X 0.8' HIGH MOUND OF STONE. CAP STAMPED AS SHOWN. SET ALUM. POST WITH 54-2 & 54-9 SIGNS 0.4' NW OF CAP. NO NEW BEARING OBJECTS AVAILABLE.

202

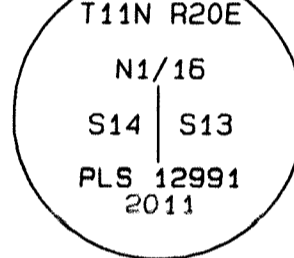

SET U.S. DEPT. OF AGRICULTURE 3-1/4" DIA. ALUM. CAP ON 2-1/2" DIA. BY 30" LONG ALUM. PIPE, WITH MAGNET BENEATH BASE. 1' ABOVE GROUND IN 3" DIA. X 0.8' HIGH MOUND OF STONE. CAP STAMPED AS SHOWN. SET ALUM. POST WITH 54-2 & 54-9 SIGNS 0.5' SW OF CAP. FROM WHICH BEARS NEW BEARING OBJECTS:
 A CHISELED "BXO" AND RED PAINTED SQUARE ON A 2.5' X 3' X 3' HIGH BOULDER, N34°W-37.0'
 A CHISELED "BXO" AND RED PAINTED SQUARE ON THE NORTH EDGE OF ROCK OUTCROP, FLUSH WITH GROUND S57°E-53.0'

203

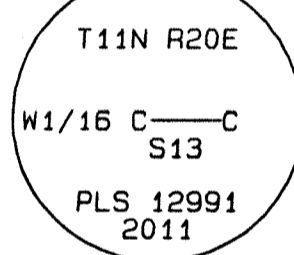

SET U.S. DEPT. OF AGRICULTURE 3-1/4" DIA. ALUM. CAP ON 2-1/2" DIA. BY 30" LONG ALUM. PIPE, WITH MAGNET BENEATH BASE. 0.5' ABOVE GROUND IN 3.5' DIA. X 0.4' HIGH MOUND OF STONE. CAP STAMPED AS SHOWN. SET ALUM. POST WITH 54-2 & 54-9 SIGNS 0.4' NW OF CAP. FROM WHICH NEW BEARING TREES BEAR:
 AN 8" DIA. PINON, N66°W-13.9'
 A 15" DIA. PINON, S88°E-5.4'
 BEARING TREES HAVE BEEN BLAZED AND SCRIBED
 'CW1/16 S13 BT' AND A 54-3 'BT' SIGN NAILED TO TREE.
 A 6" MAGSPIKE WITH AN ALUM. WASHER STAMPED 'PLS 12991' WAS PARTIALLY DRIVEN IN ON THE RIGHT SIDE (AS FACING FROM THE CORNER) CENTER AT THE BASE FOR A CHAINING POINT ON THE BEARING TREES.

204

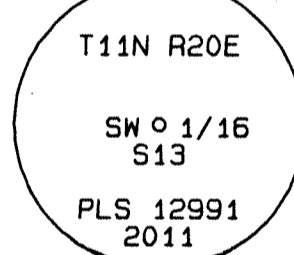

SET U.S. DEPT. OF AGRICULTURE 3-1/4" DIA. ALUM. CAP ON 2-1/2" DIA. BY 30" LONG ALUM. PIPE, WITH MAGNET BENEATH BASE. 0.6' ABOVE GROUND IN 4" DIA. X 0.5' HIGH MOUND OF STONE. CAP STAMPED AS SHOWN. SET ALUM. POST WITH 54-2 & 54-9 SIGNS 1.4' SE OF CAP. FROM WHICH NEW BEARING TREES BEAR:
 A 9" DIA. PINE, N64°W-19.4'
 AN 8" DIA. PINE, S03°E-8.5'
 BOTH BEARING TREES HAVE BEEN BLAZED AND SCRIBED
 'SW1/16 S13 BT' AND A 54-3 'BT' SIGN NAILED TO TREE.
 A 6" MAGSPIKE WITH AN ALUM. WASHER STAMPED 'PLS 12991' WAS PARTIALLY DRIVEN IN ON THE RIGHT SIDE (AS FACING FROM THE CORNER) CENTER AT THE BASE FOR A CHAINING POINT ON THE BEARING TREES.

205

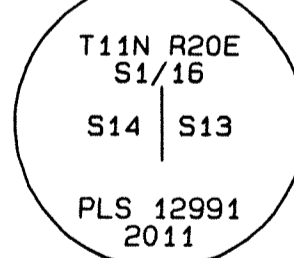

SET U.S. DEPT. OF AGRICULTURE 3-1/4" DIA. ALUM. CAP ON 2-1/2" DIA. BY 30" LONG ALUM. PIPE, WITH MAGNET BENEATH BASE. FLUSH WITH GROUND IN EMBEDDED 2.5" DIA. MOUND OF STONE. CAP STAMPED AS SHOWN. SET ALUM. POST WITH 54-2 & 54-9 SIGNS 0.4' SE OF CAP. NO NEW BEARING OBJECTS AVAILABLE.

603

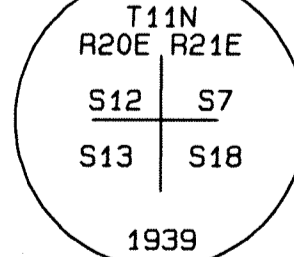

FOUND 2-1/2" U.S.G.L.O. BRASS CAP ON 2" IRON PIPE, 2.1' ABOVE THE GROUND IN THE CENTER OF A 5" DIA. X 1.4' HIGH MOUND OF STONE. CAP STAMPED AS SHOWN. FOUND ALUM. POST WITH 54-2 & 54-9 SIGNS 3.9' SW OF CAP. REBUILT 6" DIA. X 2" HIGH MOUND OF STONE AND RESET ALUM. POST WITH 54-2 & 54-9 SIGNS 4' SW OF CAP. NO BEARING TREES WERE ORIGINALLY MADE AND NO NEW BEARING OBJECTS AVAILABLE.

606

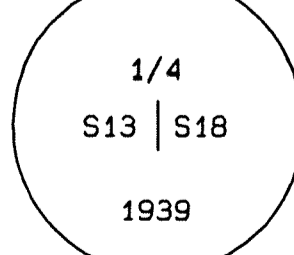

FOUND 2-1/2" U.S.G.L.O. BRASS CAP ON 1" IRON PIPE, 1.8' ABOVE THE GROUND IN THE CENTER OF A 5" DIA. X 1.6' HIGH MOUND OF STONE. CAP STAMPED AS SHOWN. FOUND ALUM. POST WITH NO SIGNS 3.4' SOUTH OF CAP. REBUILT 5" DIA. X 1.8' HIGH MOUND OF STONE AND RESET ALUM. POST WITH 54-2 & 54-9 SIGNS 0.5' NW OF CAP. NO ORIGINAL BEARING TREES FOUND AND NO NEW BEARING OBJECTS AVAILABLE.

607

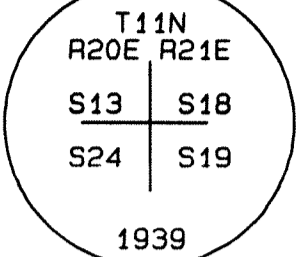

FOUND 2-1/2" U.S.G.L.O. BRASS CAP ON 2" IRON PIPE, 1.5' ABOVE THE GROUND IN THE CENTER OF A 5.5" DIA. X 1.2' HIGH MOUND OF STONE. CAP STAMPED AS SHOWN. FOUND ALUM. POST WITH 54-2 & 54-9 SIGNS 5.8' SOUTH OF CAP. REBUILT 5.5" DIA. X 1.5" HIGH MOUND OF STONE AND RESET ALUM. POST WITH 54-2 & 54-9 SIGNS 4' SW OF CAP. NO ORIGINAL BEARING TREES FOUND AND NO NEW BEARING OBJECTS AVAILABLE.

616

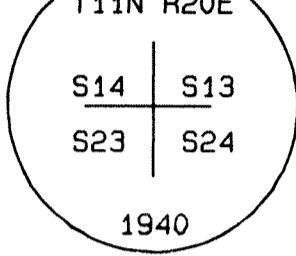

FOUND 2-1/2" U.S.G.L.O. BRASS CAP ON 2" IRON PIPE, 0.9' ABOVE GROUND IN SCATTERED 4" DIA. X 0.4' HIGH MOUND OF STONE. CAP STAMPED AS SHOWN. FOUND ALUM. POST WITH 54-2 SIGN 4' SW OF CAP AND 4" SQUARE WOOD MINING CLAIM POST 3' WEST OF CAP. REBUILT 5" DIA. X 0.7' HIGH MOUND OF STONE AND RESET ALUM. POST WITH 54-2 & 54-9 SIGNS 0.7' EAST OF CAP. NO ORIGINAL BEARING TREES FOUND AND NO NEW BEARING OBJECTS AVAILABLE.

626

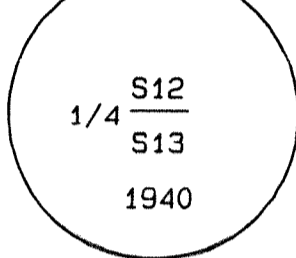

FOUND 2-1/2" U.S.G.L.O. BRASS CAP ON 1" IRON PIPE, 0.7' ABOVE GROUND IN 3" DIA. X 0.7' HIGH MOUND OF STONE. CAP STAMPED AS SHOWN. REBUILT 4" DIA. X 0.7' HIGH MOUND OF STONE AND SET ALUM. POST WITH 54-9 SIGN 0.2' WEST OF CAP. NO ORIGINAL BEARING TREES FOUND AND NO NEW BEARING OBJECTS AVAILABLE.

629

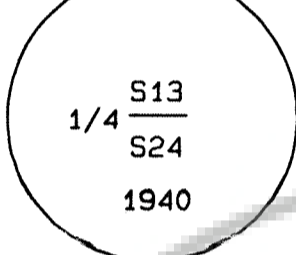

FOUND 2-1/2" U.S.G.L.O. BRASS CAP ON 1" IRON PIPE, 2.7' ABOVE GROUND IN 6" DIA. X 2.4' HIGH MOUND OF STONE. CAP STAMPED AS SHOWN. REBUILT 6" DIA. X 2.7' HIGH MOUND OF STONE AND SET ALUM. POST WITH 54-9 SIGN 3.5' NORTH OF CAP. FROM WHICH AN ORIGINAL BEARING TREE BEARS:
 1954 RECORD: 12" DIA. YELLOW PINE, N07 1/2°W, 98LKS (64.7')
 FOUND: 15" DIA. YELLOW PINE N07°W-64.3'. BLAZE IS VISIBLE.
 BUT NO SCRIBING CAN BE READ. TREE IS DEAD AND DOWN. NO WORK DONE TO THIS TREE.
 FROM WHICH NEW BEARING OBJECTS BEAR:
 A CHISELED "BXO" AND RED PAINTED SQUARE ON A 3' X 2.5' X 1.2' HIGH BOULDER, N62°W-10.2'
 A CHISELED "BXO" AND RED PAINTED SQUARE ON A 3.5' X 4' X 1.7' HIGH BOULDER, S15°E-33.2'

717

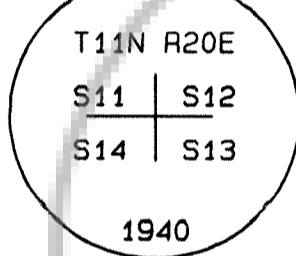

FOUND 2-1/2" U.S.G.L.O. BRASS CAP ON 2" IRON PIPE, 1.1' ABOVE GROUND 2.5' WEST OF 2.5" DIA. X 1.2' HIGH MOUND OF STONE. CAP STAMPED AS SHOWN. BUILT 4" DIA. X 0.8' HIGH MOUND OF STONE AND SET ALUM. POST WITH 54-2 & 54-9 SIGNS 0.5' NE OF CAP. FROM WHICH ORIGINAL BEARING OBJECTS BEAR:
 1954 RECORD: A CHISELED "14" ON 3' X 2' X 4' HIGH BOULDER, S33°55'W-15LKS (9.9')
 MEASURED S26°W-10.3'
 1954 RECORD: A CHISELED "+" ON 3' X 3' X 3' HIGH BOULDER, S29°20'E-63LKS (41.6')
 MEASURED S29°E-41.2'
 A RED CIRCLE WAS PAINTED AROUND THE MARKS ON BOTH BEARING OBJECTS.

858

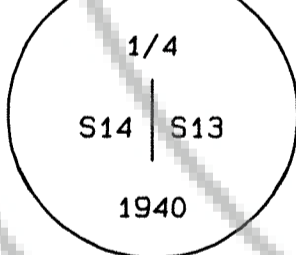

FOUND 2-1/2" U.S.G.L.O. BRASS CAP ON 1" IRON PIPE, 0.9' ABOVE GROUND IN 3" DIA. X 0.8' HIGH MOUND OF STONE. CAP STAMPED AS SHOWN. REBUILT 3.5" DIA. X 0.9' HIGH MOUND OF STONE AND SET ALUM. POST WITH 54-2 & 54-9 SIGNS 1.5' NW OF CAP. FROM WHICH NEW BEARING TREES BEAR:
 A 16" DIA. PINE, N34°W-109.2'. BEARING TREE HAS BEEN BLAZED AND SCRIBED 'T11N R20E 1/4 S14 BT' AND A 54-3 'BT' SIGN NAILED TO TREE.
 A 15" DIA. PINE, N14°E-102.3'. BEARING TREE HAS BEEN BLAZED AND SCRIBED 'T11N R20E 1/4 S13 BT' AND A 54-3 'BT' SIGN NAILED TO TREE.
 A 6" MAGSPIKE WITH AN ALUM. WASHER STAMPED 'PLS 12991' WAS PARTIALLY DRIVEN IN ON THE RIGHT SIDE (AS FACING FROM THE CORNER) CENTER AT THE BASE FOR A CHAINING POINT ON ALL BEARING TREES.
 NO ORIGINAL BEARING TREES WERE FOUND.

RECORD OF SURVEY
 FOR
U.S. DEPARTMENT OF AGRICULTURE
FOREST SERVICE
HUMBOLDT-TOIYABE NATIONAL FOREST
DEPENDENT RESURVEY
 SECTION 13, T.11N., R.20E., M.D.M.
 DOUGLAS COUNTY, NEVADA

TRI STATE SURVEYING, LTD JOB #10145.01.RM
 1925 E. PRATER WAY
 SPARKS, NEVADA 89434
 (775) 358-9491 FAX # 358-3664

SHEET 3
OF 3