



APN: 1320-02-002-022

Escrow No. 00190597 - 003 -16
RPTT \$ 0.00
When Recorded Return to:
Michael Schwartz
Jean Schwartz
1659 Hoid Road
Minden, NV 89423

Mail Tax Statements to:
Grantee - same as above

SPACE ABOVE FOR RECORDERS USE

Grant, Bargain, Sale Deed

THIS INDENTURE WITNESSETH: That Michael Schwartz and Jean Schwartz, husband and wife as joint tenants

In consideration of \$10.00, the receipt of which is hereby acknowledged, do(es) hereby Grant, Bargain, Sell and Convey to Michael Schwartz and Jean Schwartz, Trustees of the Schwartz Family Trust dated October 20, 2003

all that real property situated in the City of Minden, County of Douglas, State of Nevada, described as follows:

See Exhibit A attached hereto and made a part hereof.

Together with all and singular the tenements, hereditaments and appurtenances thereunto belonging or in anywise appertaining.

SPACE BELOW FOR RECORDER



Witness my/our hand(s) this 5th day of December, 2012

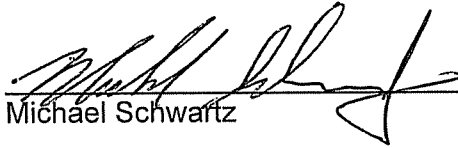

Michael Schwartz

Jean Schwartz

STATE OF NEVADA
COUNTY OF Washoe

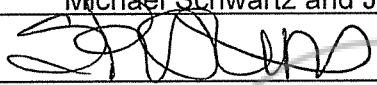
This instrument was acknowledged before me on 12.5.12,
By Michael Schwartz and Jean Schwartz

NOTARY PUBLIC

 S. PISANO
Notary Public - State of Nevada
Recorded in Washoe County - Nonresident
No: 99-51198-2 - Expires October 10, 2014

SPACE BELOW FOR RECORDER _____



Exhibit A

All that certain lot, piece or parcel of land situate in the Southwest $\frac{1}{4}$ of the Northeast $\frac{1}{4}$ of the Southwest $\frac{1}{4}$ of Section 2, Township 13 North, Range 20 East, M.D.B. & M., Douglas County, Nevada further described as follows:

Parcel B, as set forth on the Parcel Map for the Clemens, filed for record in the Office of the County Recorder of Douglas County, State of Nevada on November 16, 1990, in Book 1190, page 2674, as Document No. 239167.

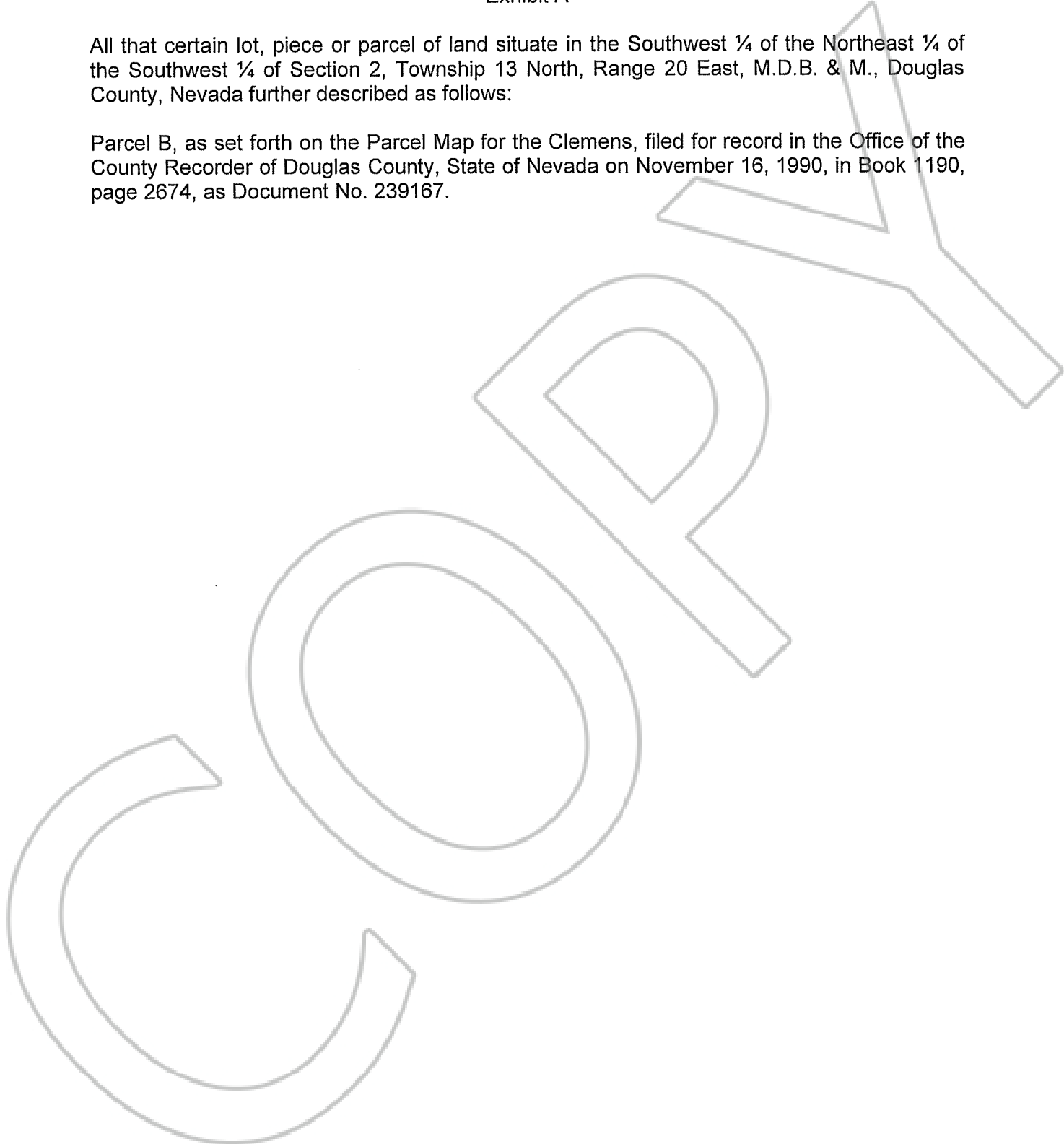

SPACE BELOW FOR RECORDER