

Doc Number: **0820692**

03/26/2013 03:33 PM

OFFICIAL RECORDS

Requested By  
**THOMAS L. BOND**

DOUGLAS COUNTY RECORDERS  
Karen Ellison - Recorder

Page: 1 of 4 Fee: \$ 17.00

Bk: 0313 Pg: 6946 RPTT # 10



Deputy. sd

Assessor's Parcel Number: 1318-03-211-001

Recording Requested By:

✓ Name: THOMAS BOND

Address: P.O. Box 752

City/State/Zip Zephyr Coe, NV 89448

Real Property Transfer Tax:

\$ \_\_\_\_\_

Deed upon Death

(Title of Document)

This page added to provide additional information required by NRS 111.312 Sections 1-2. (Additional recording fee applies)

*This cover page must be typed or legibly hand printed.*

DEED UPON DEATH

I, THOMAS L. BOND hereby convey to DAVID E. MUTZ and KAREN MUTZ, effective on my death, all right, title and interest in the real property commonly known as 126 TAHOE DR., ZEPHYR COVE, NV 89448, County of DOUGLAS, State of Nevada, and more particularly described as:

- SEE ATTACHED - *Exhibit A*

Together with all improvements, tenements, hereditaments and appurtenances, including easements and water rights, if any, thereto belonging or appertaining, and any reversions, remainders, rents, issues or profits thereof.

THIS DEED IS REVOCABLE. THIS DEED DOES NOT TRANSFER ANY OWNERSHIP UNTIL THE DEATH OF THE GRANTOR. THIS DEED REVOKES ALL PRIOR DEEDS BY THE GRANTOR WHICH CONVEY THE SAME REAL PROPERTY PURSUANT TO NRS 111.655 TO 111.699, INCLUSIVE, REGARDLESS OF WHETHER THE PRIOR DEEDS FAILED TO CONVEY THE ENTIRE INTEREST OF THE GRANTOR IN THE SAME REAL PROPERTY.

THE UNDERSIGNED HEREBY AFFIRMS THAT THIS DOCUMENT SUBMITTED FOR RECORDING DOES NOT CONTAIN A SOCIAL SECURITY NUMBER.

Dated; 3/26/13

*Thomas Bond*  
Signature  
*THOMAS BOND*



**EXHIBIT "A"**

**LEGAL DESCRIPTION**

**ESCROW NO.: 040200948**

The land referred to herein is situated in the State of Nevada, County of DOUGLAS City of ZEPHYR COVE described as follows:

Lot 102, as shown on the map of SKYLAND SUBDIVISION NO. 2, filed in the office of the County Recorder of Douglas County, Nevada, on July 22, 1959, as File No. 14668.

Together with the right of access over Lots 32 and 33; as shown on the filed map referred to herein as reserved in the Deed from STOCKTON GARDEN HOMES, INC., a California Corporation to SKYLAND WATER CO., a Nevada Corporation, recorded February 5, 1960 in Book 1 of Official Records at Page 268, Douglas County, Nevada.

Assessor's Parcel No. 1318-03-211-001

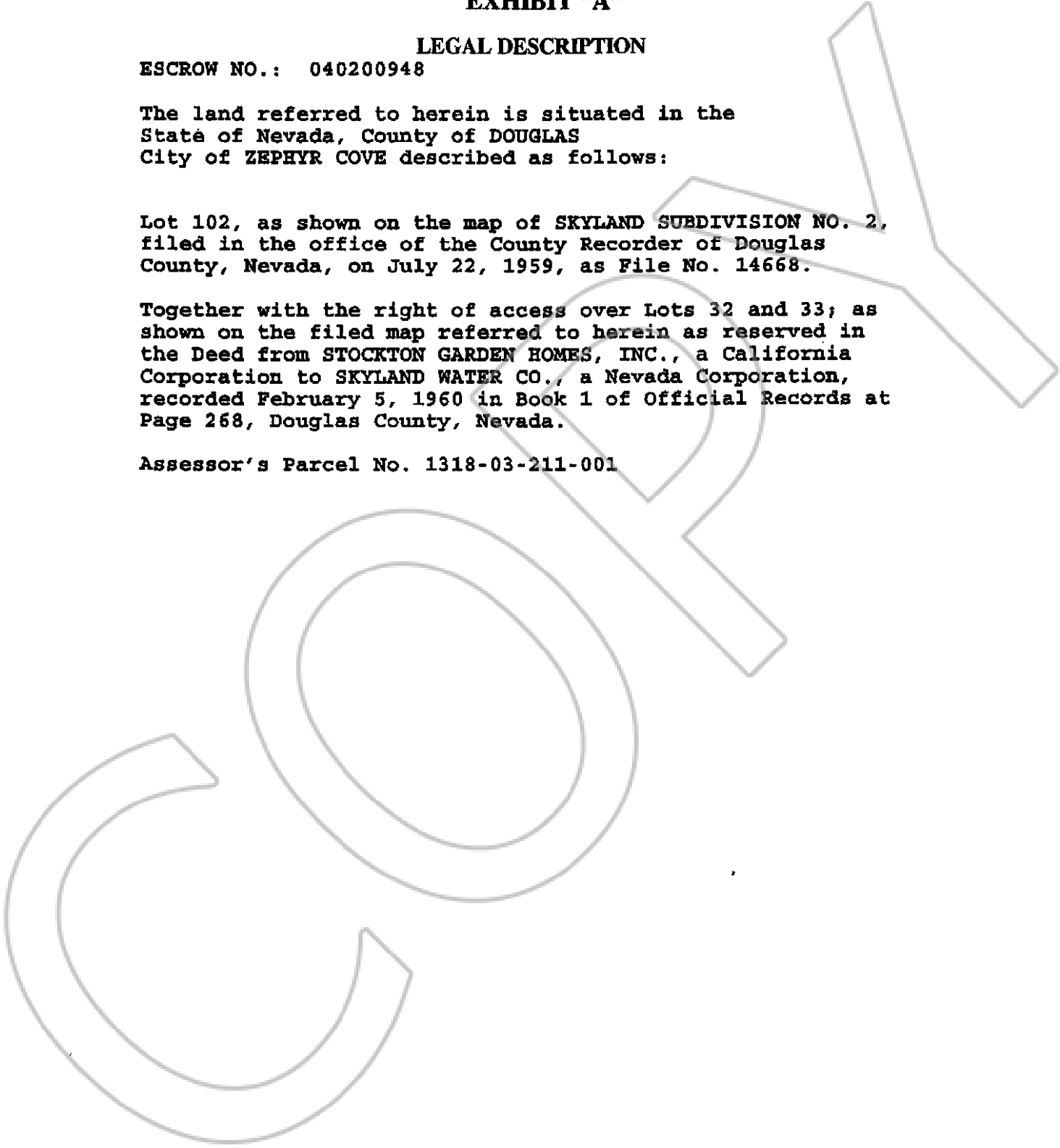

0613131

BK0504PG06304