

DOC # 826462
07/01/2013 11:47AM Deputy: GB
OFFICIAL RECORD
Requested By:
Stewart Title - Carson
Douglas County - NV
Karen Ellison - Recorder
Page: 1 of 4 Fee: \$17.00
BK-713 PG-102 RPTT: EX#003

A.P.N. #	1419-10-000=012
R.P.P.T.	0.00
Escrow No.	1014235DR
Recording Requested By:	
Stewart Title	
Mail Tax Statements To:	Same as below
When Recorded Mail To:	
Joseph Schneider	
1 Schneider Ranch Road	
Carson City, NV 89705	



GRANT. BARGAIN & SALE DEED

(Title of Document)

This document recorded 5/31/2013 as document number 824654 is being re-recorded to correct the legal description

See Exhibit "B" attached hereto and made a part hereof for correct legal description



A.P.N. #	1419-10-000-012
R.P.T.T.	\$0.00 #5
Escrow No.	1014235DR
Recording Requested By:	
	
Mail Tax Statements To:	Same as below
When Recorded Mail To:	
Joseph Schneider	
1 Schneider Ranch Road	
Carson City, Nv 89705	

Recorded Electronically	
ID	824654
County	DOUGLAS
Date	5/31/13
Time	4:09
Simplifile.com 800.460.5657	

GRANT, BARGAIN, SALE DEED

THIS INDENTURE WITNESSETH: That **Rebecca Schneider, spouse of grantee** for valuable consideration, the receipt of which is hereby acknowledged, does hereby Grant, Bargain Sell and Convey to Joseph Schneider a married man as his sole and separate property, all that real property situated in the County of Douglas, State of Nevada, bounded and described as follows:

See Exhibit "A" attached hereto and by reference made a part hereof for complete legal description.

IT IS THE EXPRESS INTENT OF THE GRANTOR, BEING THE SPOUSE OF THE GRANTEE, TO CONVEY ALL RIGHT, TITLE AND INTEREST OF THE GRANTOR, COMMUNITY OR OTHERWISE, IN AND TO THE HEREIN DESCRIBED PROPERTY TO THE GRANTEE AS GRANTEE'S SOLE AND SEPARATE PROPERTY.

Together with all and singular the tenements, hereditaments and appurtenances thereunto belonging or in anywise appertaining, and any reversions, remainders, rents, issues or profits thereof.

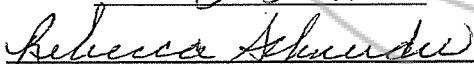
Dated: 5-30-13

 Rebecca Schneider

State of NV }
 County of Douglas } ss.

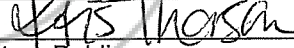
This instrument was acknowledged before me on
 by: Rebecca Schneider

Signature: 
 Notary Public

5/30/2013
May 30, 13

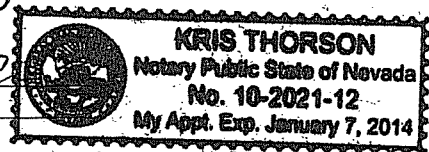



Exhibit A
LEGAL DESCRIPTION

File Number: 1014235DR

A portion of Section 10, Township 14 North, Range 19 East, M.D.M. further described as follows:

Parcel 1 of Parcel Map #LDA 12-005 for Joseph Schneider recorded in the office of the County Recorder of Douglas County, Nevada on May 6, 2013 in Book 513, Page 1060 as Document No. 823009, Official Records.

ASSESSOR'S PARCEL NO. 1419-10-000-012.

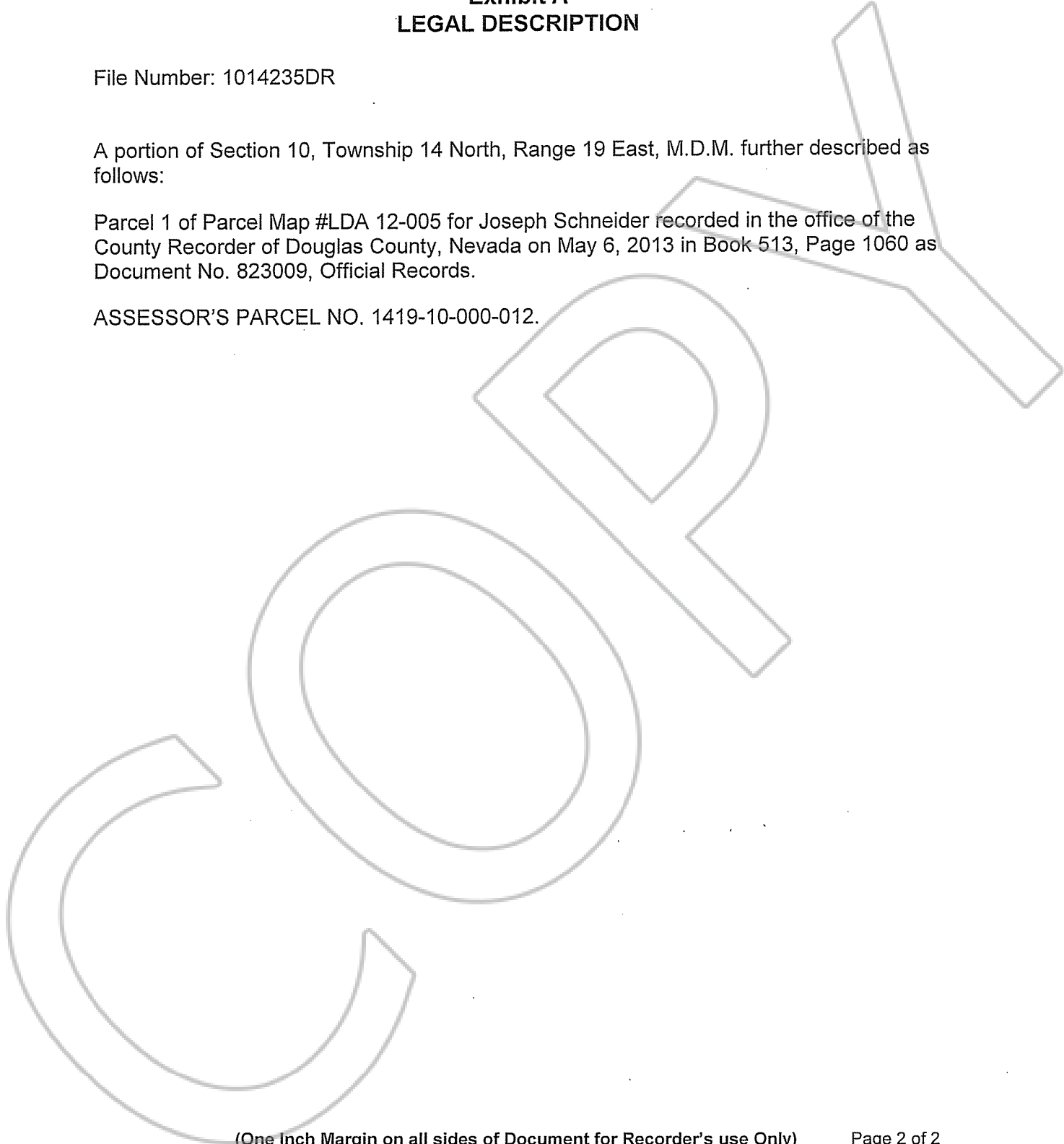



EXHIBIT "B"
LEGAL DESCRIPTION

The land referred to herein is situated in the State of Nevada, County of Douglas, described as follows:

A portion of Section 10, Township 14 North, Range 19 East, M.D.M. further described as follows:

Parcel 2 of Parcel Map #LDA 12-005 for Joseph Schneider recorded in the office of the County Recorder of Douglas County, Nevada on May 6, 2013 in Book 513, Page 1060 as Document No. 823009, Official Records.

ASSESSOR'S PARCEL NO. 1419-10-000-012.

