

15-

Doc Number: **0830666**

09/16/2013 04:43 PM

OFFICIAL RECORDS

Requested By:  
**CHRISTOPHER CADMUS**

DOUGLAS COUNTY RECORDERS  
Karen Ellison - Recorder

Page: 1 of 2 Fee: \$ 15.00

Bk: 0913 Pg: 3302



Deputy: ss

APN: 1022-09-002-079

Recording Requested by & Mail to:

Name: Christopher Cadmus

Address: 3787 Arden way

City/State/Zip: Wellington, NV 89444

**DECLARATION OF HOMESTEAD**

(CHECK ONE)

- Married (filing joint declaration)
- Married (as sole & separate property)
- By Husband (filing for joint benefit of both)
- By Wife (filing for joint benefit of both)
- By Trustee of Trust (Personal Living Trust)
- Single, Widow or Unmarried Person
- Multiple Single Persons
- Single Head of Family
- Other: \_\_\_\_\_

A. (CHECK ONE)

- Regular Home Dwelling
- Mobile Home
- Condominium Unit
- Townhouse

Name on title of property: Christopher + Shevi Cadmus

Do individually and severally certify and declare that the following named person(s) is/are residing on the land premises (or mobile home, condominium unit, townhouse) as follows: Christopher L. Cadmus

SHERI L. Cadmus

located in the City of WELLINGTON County of DOUGLAS

State of Nevada, and more particularly described as follows: (set forth legal description & street address)

3787 ARDEN WAY  
See exhibit A

B. I/we claim the land and premises herein above described, together with the dwelling house thereon, and its appurtenances, or the described mobile home, condominium unit, or townhouse as a Homestead.

In Witness, Whereof, I/we have hereunto set my hand/our hands this 16 day of September 2013

Christopher L. Cadmus

(Signature)

(Signature)

Christopher L. Cadmus

(Please print or type name here)

(Please print or type name here)

STATE OF NEVADA

COUNTY OF Douglas

This instrument was acknowledged before me on 9-16-13

By: Christopher Lee Cadmus

(Person(s) appearing before notary)

Aubrey Rowlatt

(Signature of Notarial Officer)



**AUBREY ROWLATT**  
Notary Public-State of Nevada  
APPT. NO. 10-2952-5  
My App. Expires August 17, 2014

**CONSULT AN ATTORNEY IF YOU DOUBT THIS FORM'S FITNESS FOR YOUR PURPOSE**

This form is provided as a courtesy to the taxpayer

The Recorder's Office assumes no liability for the completion of the Homestead Declaration.

**NOTE: PLEASE LEAVE 1" MARGIN ON ALL SIDES BLANK**

Ex. A

LEGAL DESCRIPTION

All that certain lot, piece or parcel of land situate in the County of Douglas, State of Nevada, described as follows:

Lot 3, as shown on the map of TOPAZ RANCH ESTATES, UNIT NO. 3, filed in the Office of the County Recorder, on March 31, 1969, as Document No. 44091, Douglas County, Nevada.

Assessment Parcel No. 37-292-04.

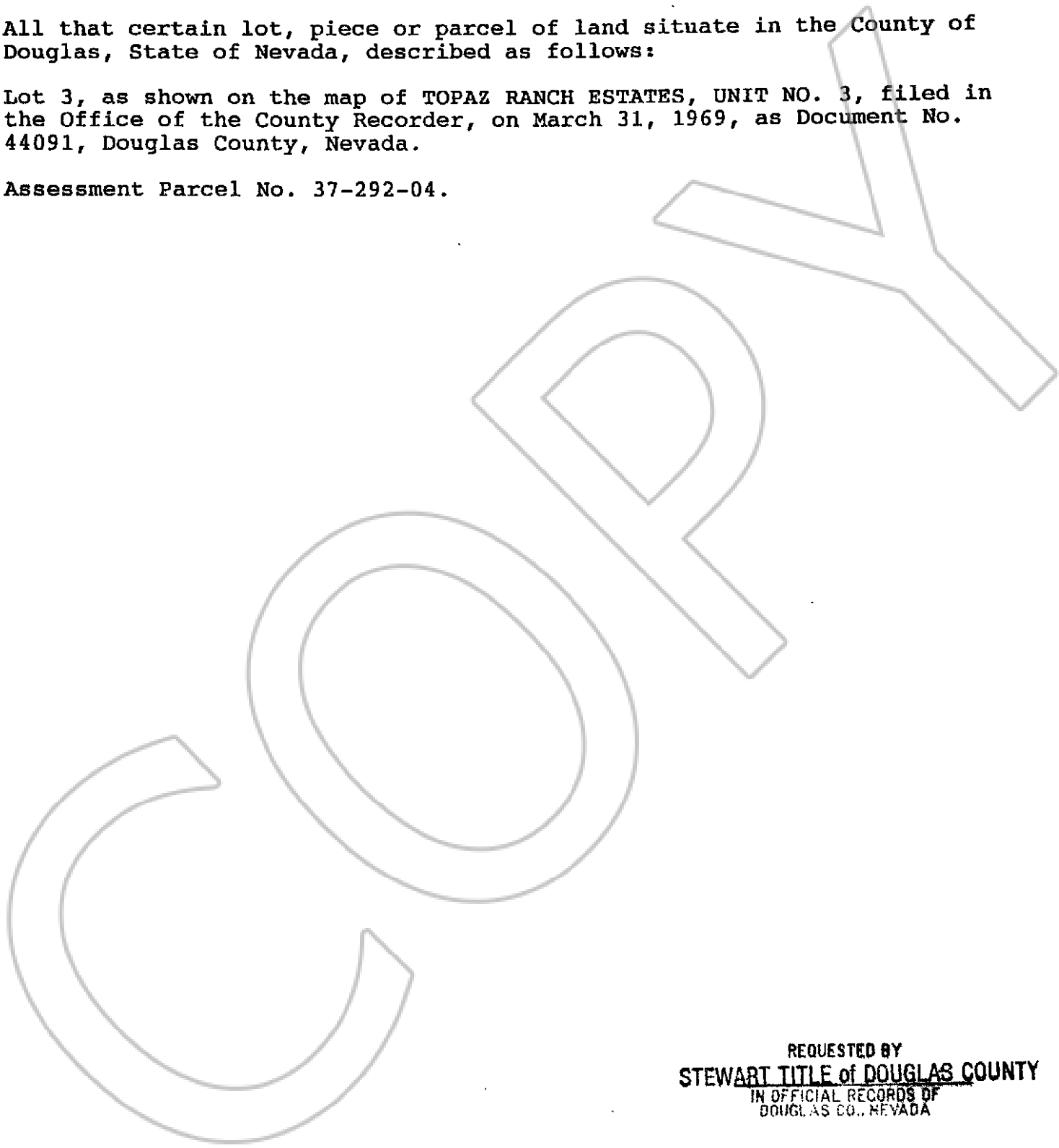

REQUESTED BY  
**STEWART TITLE of DOUGLAS COUNTY**  
IN OFFICIAL RECORDS OF  
DOUGLAS CO., NEVADA

93 SEP 10 P3:26

317245  
BK0993PG1753

SUZANNE HEAUDREAU  
RECORDER  
\$6.00 PAUL *K2* DEPUTY