

16-

Doc Number: **0837426**

01/28/2014 10:00 AM

OFFICIAL RECORDS

Requested By
TOMMY CHEN

APN: 1318-23-810-044

Escrow No.
RPTT \$842.55
When Recorded Return to
Johnny N. Chen
1025 Windsor St.
San Jose, CA 95129
Mail Tax Statements to:
Grantee same as above

168 Meadow Ln
Box 4047
Stateline, NV 89449

DOUGLAS COUNTY RECORDERS
Karen Ellison - Recorder

Page: 1 of 3 Fee: \$ 16.00
Bk: 0114 Pg: 4573 RPTT \$ 801.45



Deputy: gb

SPACE ABOVE FOR RECORDERS USE

Grant, Bargain, Sale Deed

THIS INDENTURE WITNESSETH: That
Johnny N. Chen, a single man
In consideration of \$10.00, the receipt of which is hereby acknowledged, do(es) hereby
Grant, Bargain, Sell and Convey to
**Johnny N. Chen, a single man as to a 50% interest and Tommy Nienchi Chen, a single
man as to a 50% interest, together as tenants in common,**
all that real property situate in the City of South Lake Tahoe, County of Douglas, State of
Nevada, described as follows:

See Exhibit A attached hereto and made a part hereof.

Together with all and singular the tenements, hereditaments and appurtenances thereunto
belonging or in anywise appertaining.

Witness my/our hand(s) this 29 day of November, 2013

Johnny N. Chen

STATE OF _____
COUNTY OF _____

This instrument was acknowledged before me on _____,
By Johnny N. Chen _____

NOTARY PUBLIC
SPACE BELOW FOR RECORDER

CALIFORNIA ALL-PURPOSE CERTIFICATE OF ACKNOWLEDGMENT

State of California

0837426 Page 2 of 3

BK : 0114
PG : 4574
1/28/2014

County of SANTA CLARA

On Nov. 29, 2013 before me, MABEL LUE, NOTARY PUBLIC
(Here insert name and title of the officer)

personally appeared JOHNNY N. CHEN

who proved to me on the basis of satisfactory evidence to be the person(s) whose name(s) is are subscribed to the within instrument and acknowledged to me that he/she/they executed the same in his/her/their authorized capacity(ies), and that by his/her/their signature(s) on the instrument the person(s), or the entity upon behalf of which the person(s) acted, executed the instrument.

I certify under PENALTY OF PERJURY under the laws of the State of California that the foregoing paragraph is true and correct.

WITNESS my hand and official seal.

[Signature]
Signature of Notary Public



(Notary Seal)

ADDITIONAL OPTIONAL INFORMATION

INSTRUCTIONS FOR COMPLETING THIS FORM

Any acknowledgment completed in California must contain verbiage exactly as appears above in the notary section or a separate acknowledgment form must be properly completed and attached to that document. The only exception is if a document is to be recorded outside of California. In such instances, any alternative acknowledgment verbiage as may be printed on such a document so long as the verbiage does not require the notary to do something that is illegal for a notary in California (i.e. certifying the authorized capacity of the signer). Please check the document carefully for proper notarial wording and attach this form if required

DESCRIPTION OF THE ATTACHED DOCUMENT

GRANT BARGAIN SALE DEED
(Title or description of attached document)

(Title or description of attached document continued)

Number of Pages 2 Document Date 11/29/13

(Additional information)

- State and County information must be the State and County where the document signer(s) personally appeared before the notary public for acknowledgment.
- Date of notarization must be the date that the signer(s) personally appeared which must also be the same date the acknowledgment is completed.
- The notary public must print his or her name as it appears within his or her commission followed by a comma and then your title (notary public)
- Print the name(s) of document signer(s) who personally appear at the time of notarization
- Indicate the correct singular or plural forms by crossing off incorrect forms (i.e. he/she/they, is /are) or circling the correct forms. Failure to correctly indicate this information may lead to rejection of document recording
- The notary seal impression must be clear and photographically reproducible. Impression must not cover text or lines. If seal impression smudges, re-seal if a sufficient area permits, otherwise complete a different acknowledgment form
- Signature of the notary public must match the signature on file with the office of the county clerk.
 - ❖ Additional information is not required but could help to ensure this acknowledgment is not misused or attached to a different document.
 - ❖ Indicate title or type of attached document, number of pages and date.
 - ❖ Indicate the capacity claimed by the signer. If the claimed capacity is a corporate officer, indicate the title (i.e. CEO, CFO, Secretary)
- Securely attach this document to the signed document

CAPACITY CLAIMED BY THE SIGNER

Individual (s)

Corporate Officer

(Title)

Partner(s)

Attorney-in-Fact

Trustee(s)

Other _____

Exhibit A

Lot 32, in Block B, as shown on the Official Map of KINGSBURY MEADOWS SUBDIVISION, filed for record in the office of the County Recorder of Douglas County, Nevada, on July 5, 1955, as file No. 10542.

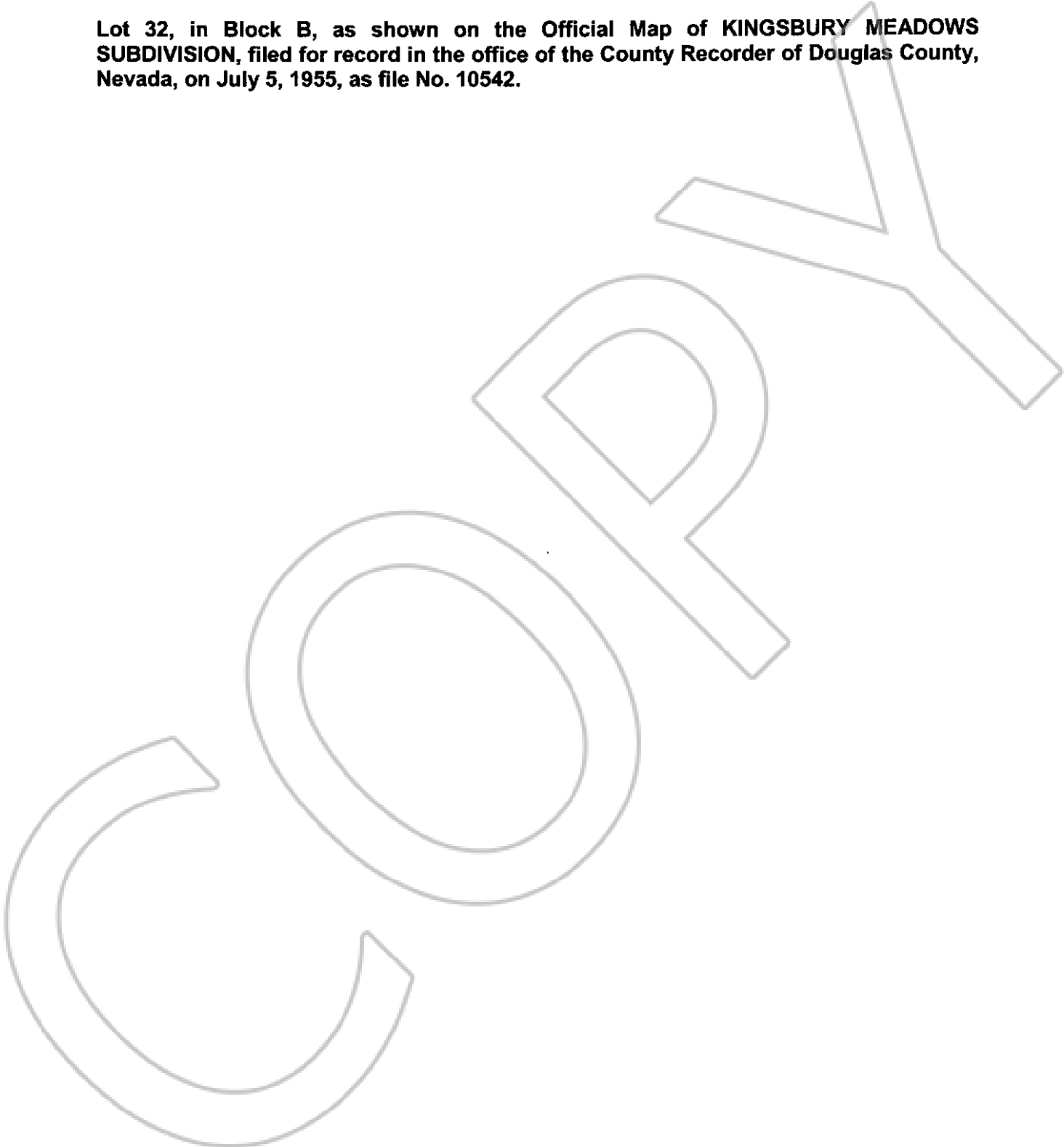

SPACE BELOW FOR RECORDER