

DOC # 843442
05/29/2014 02:16PM Deputy: AR
OFFICIAL RECORD
Requested By:
Capital Title Company of Nevada
Douglas County - NV
Karen Ellison - Recorder
Page: 1 of 8 Fee: \$21.00
BK-514 PG-5692 RPTT: 3030.30



RECORDING REQUESTED BY:
Capital Title Co. of Nevada
212 Elks Point Road #440
Zephyr Cove, NV 89448
APN: 1318-09-810-044
ESCROW NO: 10010950-003-CD3
WHEN RECORDED MAIL TO and
MAIL TAX STATEMENT TO:
WILLIAM AND JAN LAMBERT TRUST
17370 HIGH ROAD
SONOMA, CA 95476

\$ RPTT \$3,030.30 signed in counterpart
GRANT, BARGAIN, SALE DEED

THIS INDENTURE WITNESSETH: That Nancy S. Webb, a married woman as her sole and separate property and Janet E. Trefethen, a married woman as her sole and separate property and Kathryn A. Spooner, an unmarried woman who acquired title as Kathryn A. Thomas

In consideration of \$10.00, the receipt of which is hereby acknowledged, do hereby Grant, Bargain, Sell and Convey to WILLIAM D. LAMBERT AND JAN D. LAMBERT, HUSBAND AND WIFE
AS COMMUNITY PROPERTY.

all that real property situated in the County of Douglas, State of Nevada, described as follows:

See Exhibit A attached hereto and made a part hereof.

Together with all and singular the tenements, hereditaments and appurtenances thereunto belonging or in anywise appertaining.

Witness his/hers/theirs hand(s) this 4/2/14

Nancy S. Webb
Nancy S. Webb

STATE OF Washington

} SS:

COUNTY OF Whatcom

This instrument was acknowledged before me on April 2nd 2014

by Nancy S. Webb

Notary Public

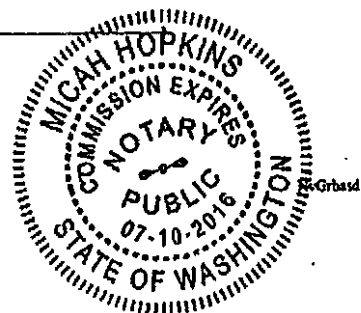



signed in counterpart

Exhibit A

Lot 6 , in Block E, on the Amended Map of Subdivision No. 2 of ZEPHYR COVE PROPERTIES, INC., according to the map thereof, filed in the office of the County Recorder of Douglas County, State of Nevada, on August 5, 1929

APN: 1318-09-810-044

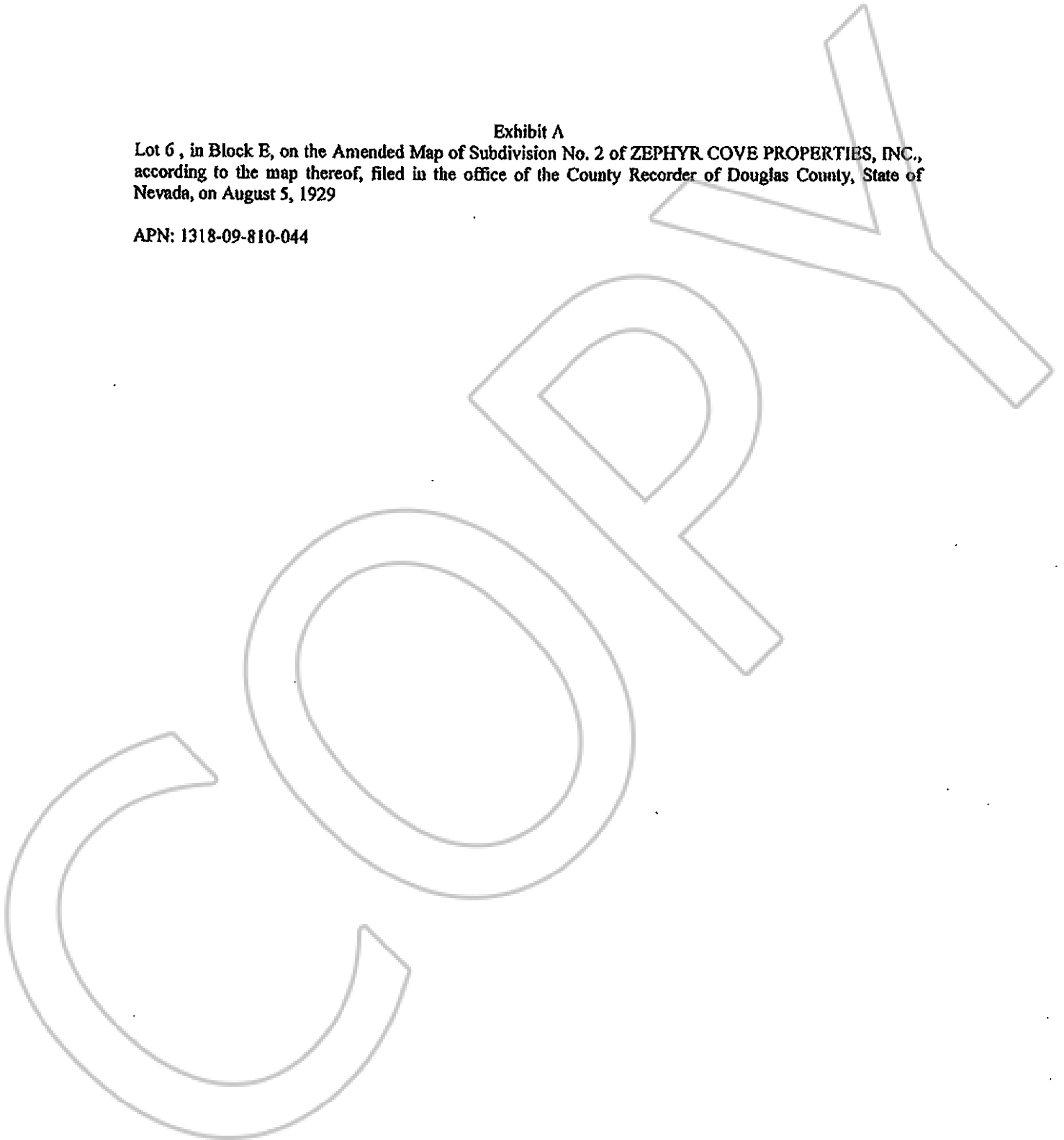

RECORDING REQUESTED BY:



BK 514
PG-5694

843442 Page: 3 of 8 05/29/2014

Capital Title Co. of Nevada
212 Elks Point Road #440
Zephyr Cove, NV 89448

APN: 1318-09-810-044
ESCROW NO: 10010950-003-CD3
WHEN RECORDED MAIL TO and
MAIL TAX STATEMENT TO:
WILLIAM AND JAN LAMBERT TRUST
17370 HIGH ROAD
SONOMA, CA 95476

GRANT, BARGAIN, SALE DEED

signed in counterpart
THIS INDENTURE WITNESSETH: That Nancy S. Webb, a married woman as her sole and separate property and Janet E. Trefethen, a married woman as her sole and separate property and Kathryn A. Spooner, an unmarried woman who acquired title as Kathryn A. Thomas
In consideration of \$10.00, the receipt of which is hereby acknowledged, do hereby Grant, Bargain, Sell and Convey to William and Jan Lambert Trust, as trustee

all that real property situated in the County of Douglas, State of Nevada, described as follows:

See Exhibit A attached hereto and made a part hereof.

Together with all and singular the tenements, hereditaments and appurtenances thereunto belonging or in anywise appertaining.

Witness his/hers/theirs hand(s) this April 9, 2014

Janet E. Trefethen
Janet E. Trefethen

STATE OF _____ } ss:

COUNTY OF _____

This instrument was acknowledged before me on _____
by _____

Notary Public



CALIFORNIA ALL-PURPOSE ACKNOWLEDGMENT

State of California } signed in counterpart
 County of Napa }
 On April 9, 2014 before me, Sandra Harmyk, Notary Public
Date Here Insert Name and Title of the Office
 personally appeared Janet E. Trefethan
Name(s) of Signer(s)

who proved to me on the basis of satisfactory evidence to be the person(s) whose name(s) is/are subscribed to the within instrument and acknowledged to me that he/she/they executed the same in his/her/their authorized capacity(ies), and that by his/her/their signature(s) on the instrument the person(s), or the entity upon behalf of which the person(s) acted, executed the instrument.

I certify under PENALTY OF PERJURY under the laws of the State of California that the foregoing paragraph is true and correct.

WITNESS my hand and official seal.

Signature

Sandra Harmyk
Signature of Notary Public



Place Notary Seal Above

OPTIONAL

Though the information below is not required by law, it may prove valuable to persons relying on the document and could prevent fraudulent removal and reattachment of this form to another document.

Description of Attached Document Grant, Bargain,
 Title or Type of Document: Sale Deed
 Document Date: 4/9/14 Number of Pages: 2
 Signer(s) Other Than Named Above: _____

Capacity(ies) Claimed by Signer(s)

Signer's Name: Janet E. Trefethan

- Individual
- Corporate Officer — Title(s): _____
- Partner — Limited General
- Attorney in Fact
- Trustee
- Guardian or Conservator
- Other: _____



Signer Is Representing: _____

Signer's Name: _____

- Individual
- Corporate Officer — Title(s): _____
- Partner — Limited General
- Attorney in Fact
- Trustee
- Guardian or Conservator
- Other: _____



Signer Is Representing: _____



signed in counterpart

Exhibit A

Lot 6, in Block E, on the Amended Map of Subdivision No. 2 of ZEPHYR COVE PROPERTIES, INC., according to the map thereof, filed in the office of the County Recorder of Douglas County, State of Nevada, on August 5, 1929

APN: 1318-09-810-044

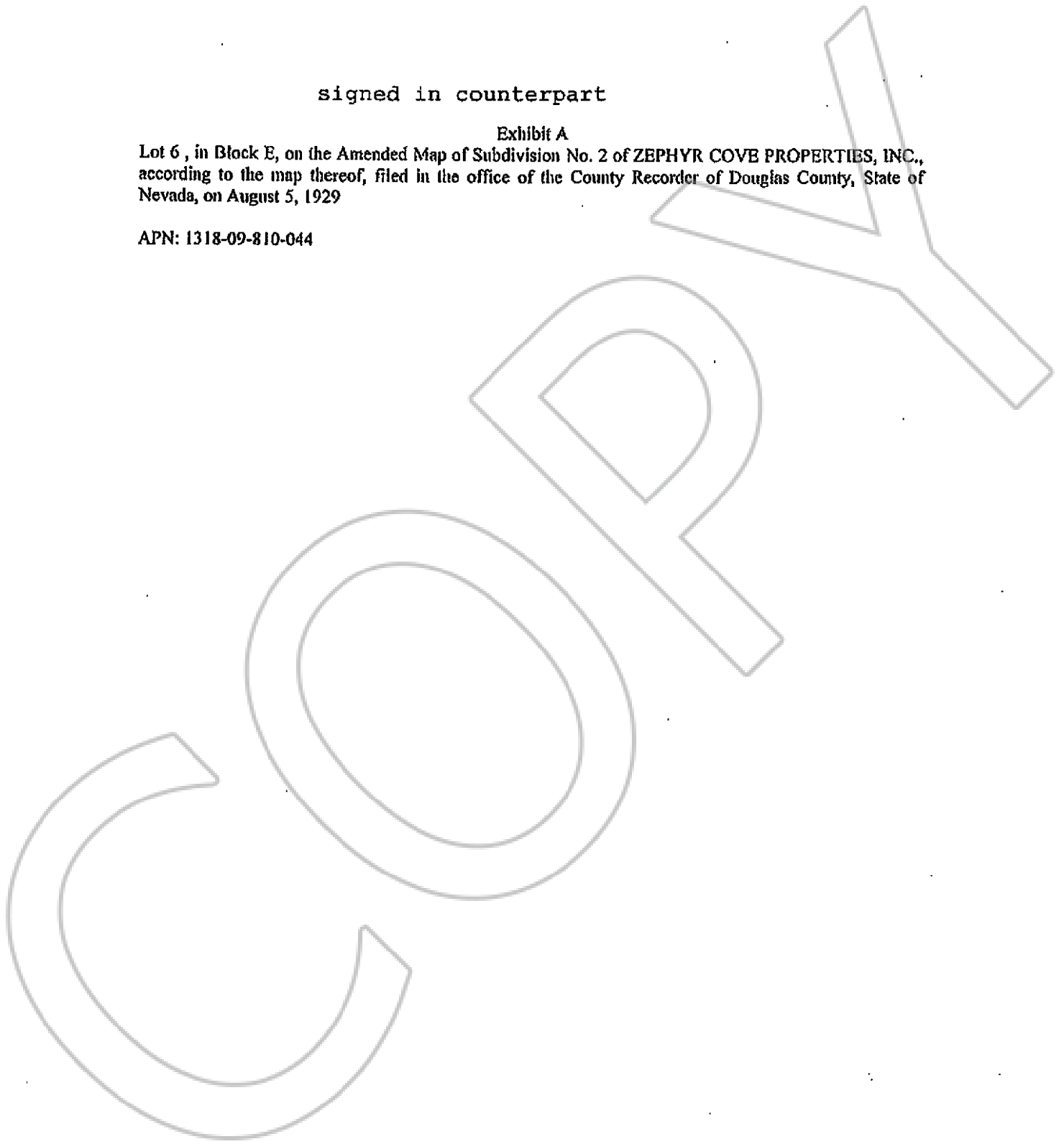



RECORDING REQUESTED BY:

Capital Title Co. of Nevada
212 Elks Point Road #440
Zephyr Cove, NV 89448

APN: 1318-09-810-044
ESCROW NO: 10010950-003-CD3
WHEN RECORDED MAIL TO and
MAIL TAX STATEMENT TO:
WILLIAM AND JAN LAMBERT TRUST
17370 HIGH ROAD
SONOMA, CA 95476

GRANT, BARGAIN, SALE DEED

THIS INDENTURE WITNESSETH: That Nancy S. Webb, a married woman as her sole and separate property and Janet E. Trefethen, a married woman as her sole and separate property and Kathryn A. Spooner, an unmarried woman who acquired title as Kathryn A. Thomas ^{signed in counterpart}
In consideration of \$10.00, the receipt of which is hereby acknowledged, do hereby Grant, Bargain, Sell and Convey to William and Jan Lambert Trust, as trustee

all that real property situated in the County of Douglas, State of Nevada, described as follows:
See Exhibit A attached hereto and made a part hereof.

Together with all and singular the tenements, hereditaments and appurtenances thereunto belonging or in anywise appertaining.

Witness his/hers/theirs hand(s) this 4-4-14

Kathryn A. Spooner
Kathryn A. Spooner

STATE OF _____ } SS:

COUNTY OF _____

This instrument was acknowledged before me on _____
by _____

See attached
Notary Public



STATE OF CALIFORNIA)
COUNTY OF COLUSA)

signed in counterpart

On April 4, 2014, before me, Kim Tyler, Notary Public, personally appeared Kathryn A. Spooner, who proved to me on the basis of satisfactory evidence to be the person(s) whose name(s) is/are subscribed to the within instrument and acknowledged to me that he/she/they executed the same in his/her/their authorized capacity(ies), and that by his/her/their signature(s) on the instrument the person(s), or the entity upon behalf of which the person(s) acted, executed the instrument.

I certify under PENALTY OF PERJURY under the laws of the State of California that the foregoing paragraph is true and correct.

WITNESS my hand and official seal.

Kim Tyler





signed in counterpart

Exhibit A

Lot 6, in Block E, on the Amended Map of Subdivision No. 2 of ZEPHYR COVE PROPERTIES, INC., according to the map thereof, filed in the office of the County Recorder of Douglas County, State of Nevada, on August 5, 1929

APN: 1318-09-810-044

