

APN: 1418-03-401-003
RPTT: \$-0-
Escrow No. 00204941 - 003-16
When Recorded Return to:
Richard Grayson Ray, jr.
516 Mint Lane
Ventura, CA 93001

Mail Tax Statements to:
Grantee same as above

DOC # 844716
06/19/2014 03:43PM Deputy: SG
OFFICIAL RECORD
Requested By:
First Centennial - Reno
Douglas County - NV
Karen Ellison - Recorder
Page: 1 of 4 Fee: \$42.00
BK-614 PG-4430 RPTT: EX#005



SPACE ABOVE FOR RECORDERS USE

DEED

THIS INDENTURE WITNESSETH: That Sharon Ray, spouse of the grantee herein, in consideration of the sum of Ten Dollars (\$10.00), the receipt of which is hereby acknowledged, do(es) hereby Grant, Bargain Sell and convey to Richard Grayson Ray, Jr., a married man as his sole and separate property all that real property situate in the City of Glenbrook, County of Douglas, State of Nevada, described as follows:

See Exhibit A attached hereto and made a part hereof.

It is the intent of Grantor herein to divest herself of any right, title and interest in and to the above described real property including any community property interest.

TOGETHER WITH all and singular the tenements, hereditaments and appurtenances thereunto belonging to in anywise appertaining.

SPACE BELOW FOR RECORDER



EXHIBIT "A"
Legal Description

Parcel No. 1:

A portion of the Southwest one-quarter of Section 3, Township 14 North, Range 18 East, MDM, and being more particularly described as follows:

Commencing at the West one-quarter corner of said Section, marked on the ground by a 2-inch pipe in a mound of stone; thence S. 89°21'E. along the east-west centerline of said Section 3, a distance of 1312.03 feet to the northeast corner of the parcel of land described in the deed to W.J. Harris, recorded in Book U, Page 89 of the Douglas County Recorder's Office; thence S. 00°39' E. along the easterly line of said Harris parcel 1109.03 feet; thence S. 75°08'50" W., 132.98 feet to the True Point of Beginning; thence S. 00°00'00" E., 329.98 feet to a point on the northerly line of Land's End Road being the exception for road easement purposes as described in Document No. 823274; thence S. 73°07'00" W., along said Northerly line, 43.21 feet; thence S. 79°10'30" W., continuing along said northerly line, 95.68 feet; thence N. 00°00'00" E., leaving said northerly line, 324.61 feet; thence N. 75°08'50" E., 140.01 feet to the Point of Beginning.

Reference is hereby made to that Record of Survey Map, recorded on October 11, 2013, in Book 1013, at Page 2749, as Document. 832014, Official Records of Douglas County, Nevada.

Parcel No. 2:

Together with a non-exclusive easement and right of way, 50 feet wide, for roadway described as follows:

Commencing at the West quarter corner of Section 3, Township 14 North, Range 18 East, M.D.B. & M., marked on the ground by a 2 inch pipe in a mound of stone; thence South 89°21' East along the East-West center line of said Section 3 a distance of 1312.03 feet to a 2 inch pipe at the Northeast corner of the parcel of land described in the deed to W.J. Harris, recorded in Book U, Page 89 Deed Records' thence South 0°39' East along the Eastern line of Harris Parcel 1432.99 feet to the true point of beginning; thence South 73°07' West 180.03 feet; thence South 73°07' West 180.83 feet; thence South 79°10'30" West 298.21 feet; thence South 71°47'50" West 74.30 feet; thence South 65°54'03" East 70.68 feet; thence North 79°10'30" East 316.59 feet; thence North 73°07" East 168.91 feet to the Easterly line of said Harris parcel; thence North 0°39' West along the last mentioned line.52.08 feet to the true point of beginning.

Further together with the non-exclusive right to use the easements and rights of way for roadway purposes conveyed to W.J. Harris, in deed recorded in Book U, at Page 67, as Document 2499, of Deed Records, Douglas County, Nevada.

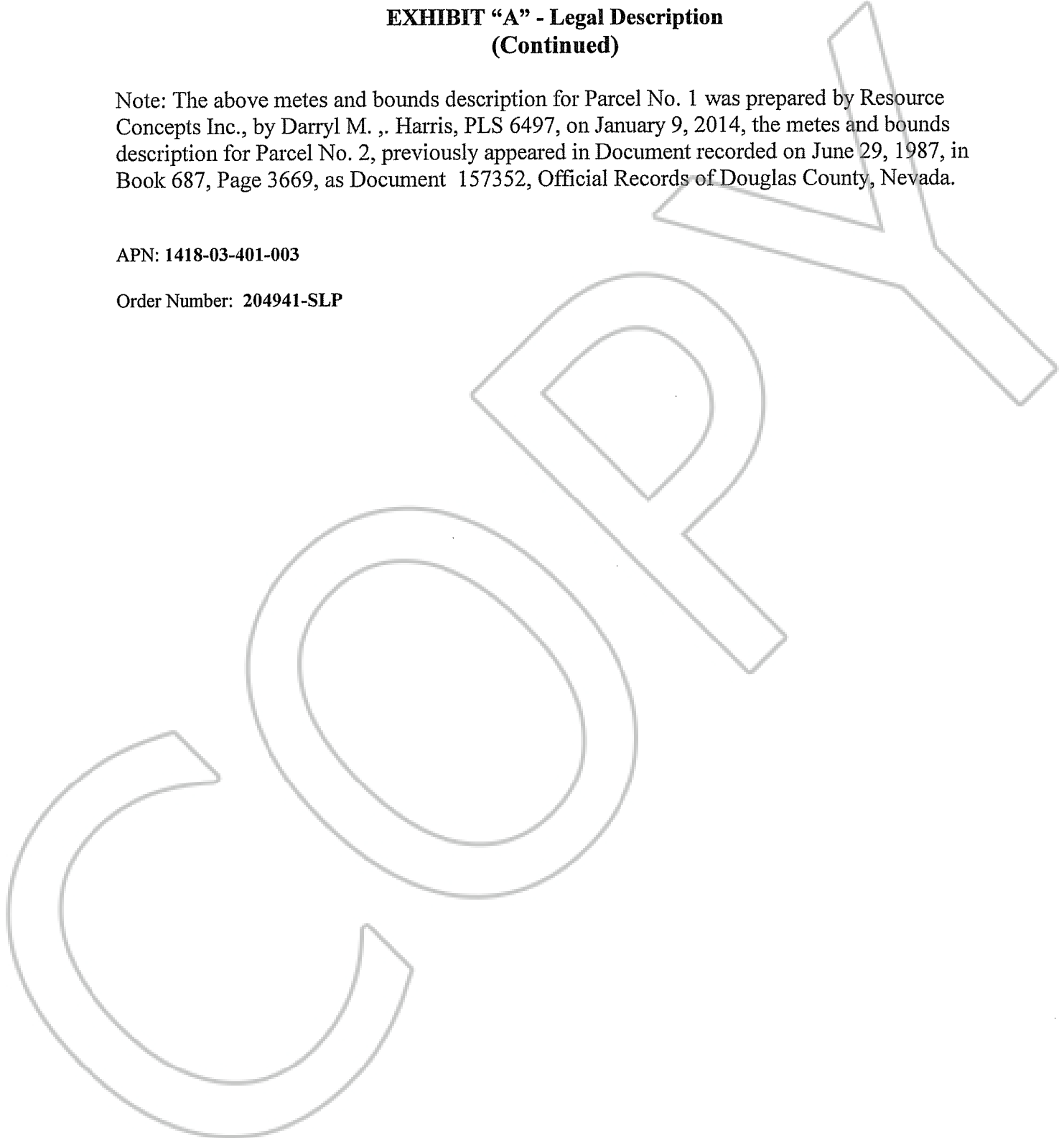

**EXHIBIT "A" - Legal Description
(Continued)**

Note: The above metes and bounds description for Parcel No. 1 was prepared by Resource Concepts Inc., by Darryl M. , Harris, PLS 6497, on January 9, 2014, the metes and bounds description for Parcel No. 2, previously appeared in Document recorded on June 29, 1987, in Book 687, Page 3669, as Document 157352, Official Records of Douglas County, Nevada.

APN: 1418-03-401-003

Order Number: 204941-SLP





DATE: 6/16/14

Sharon Ray
Sharon Ray

STATE OF California
COUNTY OF Ventura

This instrument was acknowledged before me on 16 June 2014
by Sharon Ray

Ramesh Manwani
NOTARY PUBLIC

