

Requested By:  
First Centennial - Reno  
Douglas County - NV  
Karen Ellison - Recorder  
Page: 1 of 3 Fee: \$16.00  
BK-814 PG-5621 RPTT: 1989.00



APN: 1318-16-810-045

Escrow No. 00205501 - 001 -12  
RPTT \$1,989.00  
When Recorded Return to:  
Grantee  
3899 Vistacrest Dr.  
Reno, NV 89509

Mail Tax Statements to:  
Grantee same as above

SPACE ABOVE FOR RECORDERS USE

**Grant, Bargain, Sale Deed**

THIS INDENTURE WITNESSETH: That  
Maynard B. Rotermund and Olga Jane Rotermund, Trustees of the Maynard B. Rotermund  
and Olga Jane Rotermund 1993 Trust

In consideration of \$10.00, the receipt of which is hereby acknowledged, do(es) hereby  
Grant, Bargain, Sell and Convey to  
Timothy Gilbert and Nancy Gilbert, husband and wife, as joint tenants  
D. F.

all that real property situate in the County of Douglas, State of Nevada, described as follows:

**See Exhibit A attached hereto and made a part hereof.**

Together with all and singular the tenements, hereditaments and appurtenances thereunto  
belonging or in anywise appertaining.

Witness my/our hand(s) this 1st day of August, 2014

Maynard B. Rotermund and Olga Jane  
Rotermund 1993 Trust

Maynard B. Rotermund  
Trustee  
Maynard B. Rotermund, Trustee

Olga Jane Rotermund  
Trustee  
Olga Jane Rotermund, Trustee

STATE OF CALIFORNIA  
COUNTY OF C

This instrument was acknowledged before me on \_\_\_\_\_,  
By Maynard B. Rotermund and Olga Jane Rotermund.

\_\_\_\_\_  
NOTARY PUBLIC

SPACE BELOW FOR RECORDER

SEE ATTACHMENT  
FOR NOTARIZATION



# California all purpose Certificate of Acknowledgment

State of California

County of Contra Costa } ss

On 8/11/14, Pat Blume Notary Public before me, personally  
Date (Here insert name and title of the officer)

Olga Jane Rotermond & Maynard B. Rotermond  
appeared, who proved to me on the basis of  
satisfactory evidence to be the person(s) whose name(s) is/are subscribed to the within instrument  
and acknowledged to me that he/she/they executed the same in his/her/their authorized capacity(ies),  
and that by his/her/their signature(s) on the instrument the person(s), or the entity upon behalf of which  
the person(s) acted, executed the instrument.

I certify under PENALTY OF PERJURY under the laws of the State of California  
that the foregoing paragraph is true and correct.

WITNESS my hand and official seal.

Signature [Handwritten Signature]  
Signature of Notary Public  
(Notary Seal)

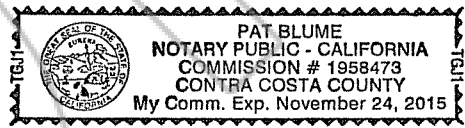

### OPTIONAL SECTION DESCRIPTION OF ATTACHED DOCUMENT

Title or Type of Document Sale Deed

Document Date 8/11/14 Number of Pages two

### CAPACITY(IES) CLAIMED BY SIGNER

Name of Signer \_\_\_\_\_

Title(s) \_\_\_\_\_

Signer is Representing: \_\_\_\_\_



**Exhibit A**

**Lot 124 and the East ½ of Lot 125, of the ELKS SUBDIVISION PLAT, according to the official map thereof, filed in the office of the County Recorder of Douglas County, Nevada, on May 5, 1927 and as shown on the Amended Plat of the Elks Subdivision, on January 5, 1928 and as shown on the Second Amended Plat of the Elks Subdivision, on June 5, 1952, as Document No. 8537.**

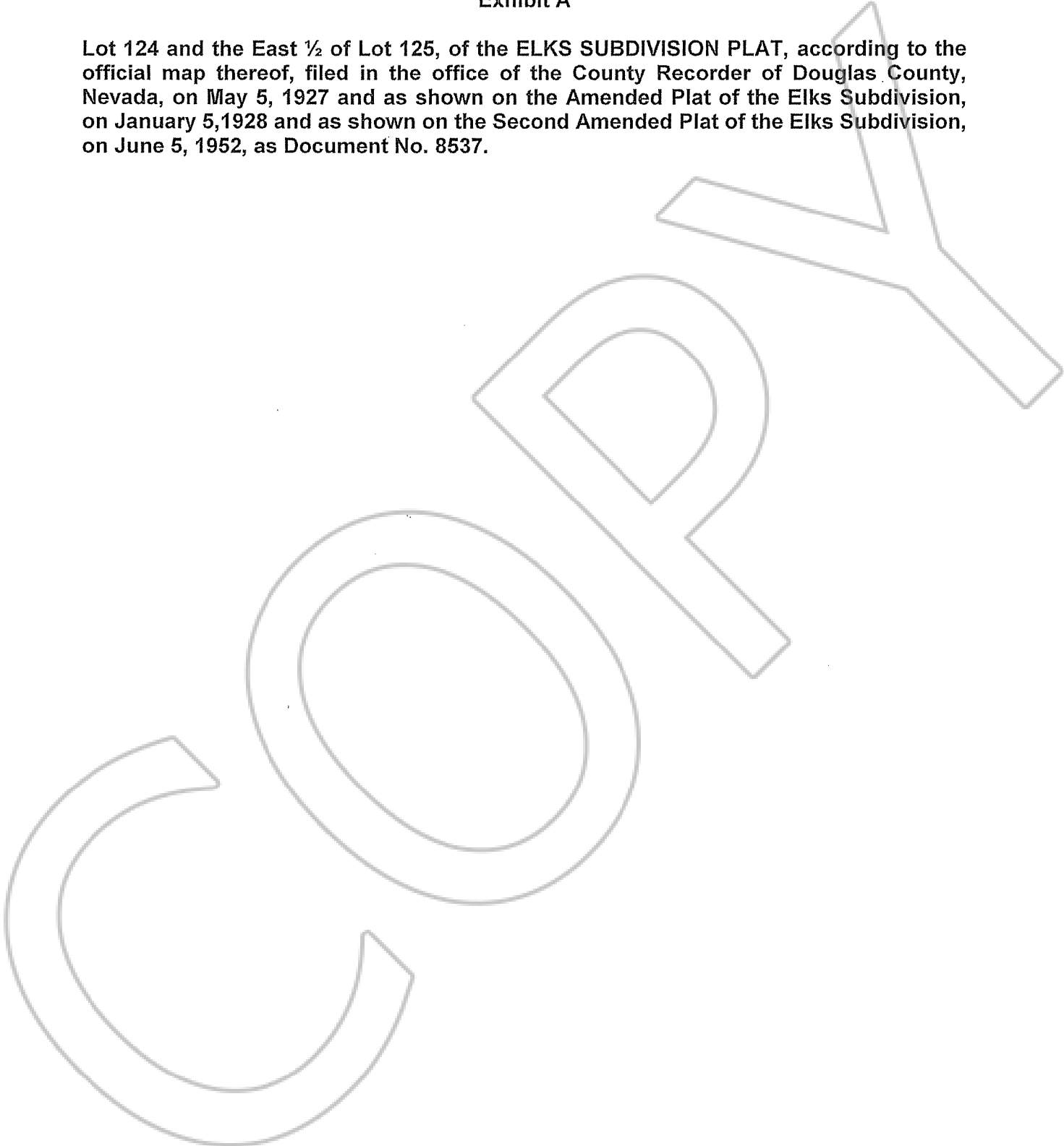

SPACE BELOW FOR RECORDER