

15-

Doc Number: **0848611**

08/26/2014 03:11 PM

OFFICIAL RECORDS

Requested By
KYLE BRANNAN

DOUGLAS COUNTY RECORDERS
Karen Ellison - Recorder

Page: 1 of 2 Fee: \$ 15.00

Bk: 0814 Pg: 6147



Deputy sg

ABANDONMENT OF HOMESTEAD

Assessor Parcel Number: 1320-33-311-009

OR

Assessor's Manufactured Home ID Number: _____

Recording Requested by and Mail to:

Name: KYLE BRANNAN

Address: 1125 MILL ST.

City/State/Zip: CARRPERSVILLE NV 89410

KATHERINE BRANNAN, KYLE BRANNAN
resident of DOUGLAS County, Nevada, hereby abandons all claims to a homestead for the real property below described and forever releases and discharges such real property from any and all claims of homestead and particularly from any such claim under Declaration of Homestead recorded on 5/11/05, in Book 0505, Official Records, Page 4858
Document No. 084107, DOUGLAS County Records.

Said real property is situate in DOUGLAS County, Nevada and is described as follows:

SEE ATTACHED EXHIBIT 'A'

In Witness, Whereof, I/we have hereunto set my hand/our hands this 26 day of August, 2014.

[Signature]
Signature
KYLE BRANNAN
Print or type name here

Signature

Print or type name here

STATE OF NEVADA, COUNTY OF Douglas

This instrument was acknowledged before me on 8/26/14

by Brendon Kyle Brannan
Person(s) appearing before notary

by _____
Person(s) appearing before notary

[Signature]
Signature of notarial officer

CONSULT AN ATTORNEY IF YOU DOUBT THIS FORM'S FITNESS FOR YOUR PURPOSE.

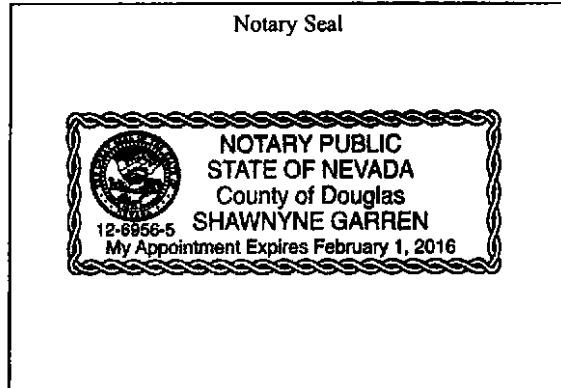

NOTE: Leave space within 1-inch margin blank on all sides.

Oct. 2009

EXHIBIT "A"

LEGAL DESCRIPTION

ESCROW NO.: 030303554

Lot 9, Block A, as set forth on Final Subdivision Map FSM-1006-2 for CHICHESTER ESTATES Phase 2, filed for record in the office of the County Recorder of Douglas County, State of Nevada, on December 9, 1996, in Book 1296 at Page 1286, as Document No. 402540, and by Certificate of Amendment recorded July 17, 2001, Book 0701, Page 3929, as Document No. 518479.

Assessors Parcel No. 1320-33-311-009

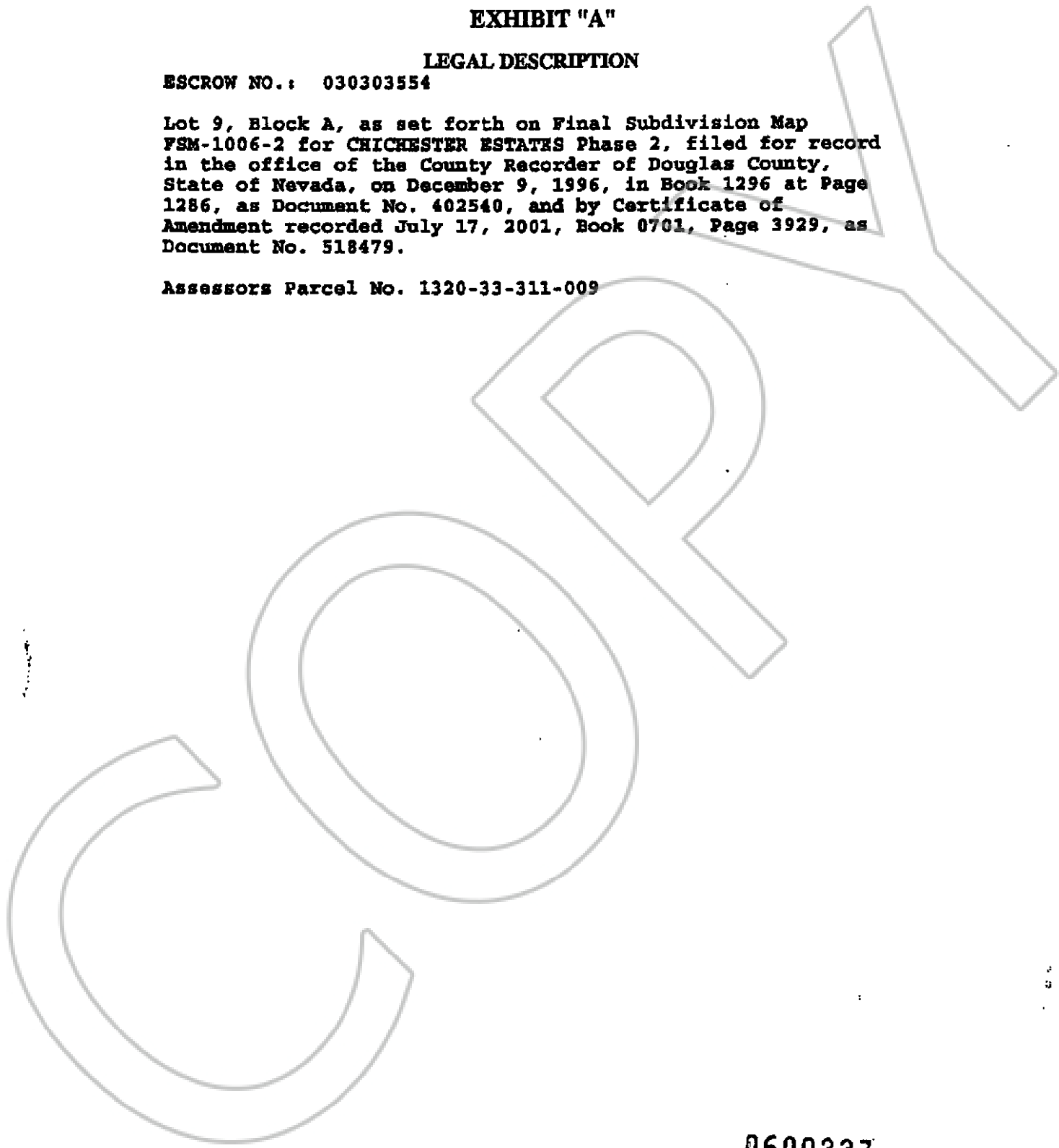

0600337

BK1203PG10300