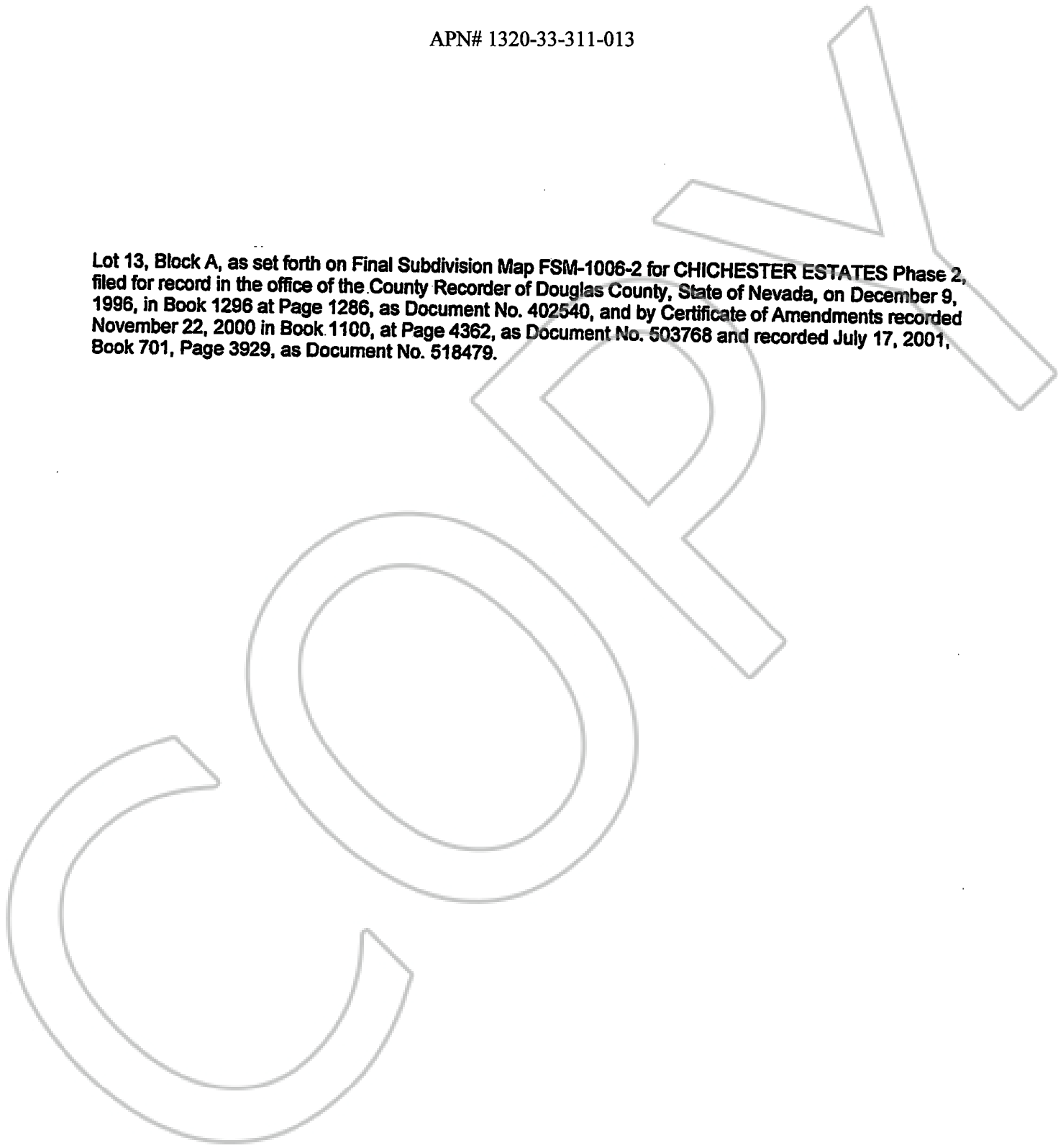



EXHIBIT "A"  
LEGAL DESCRIPTION

APN# 1320-33-311-013

Lot 13, Block A, as set forth on Final Subdivision Map FSM-1006-2 for CHICHESTER ESTATES Phase 2, filed for record in the office of the County Recorder of Douglas County, State of Nevada, on December 9, 1996, in Book 1296 at Page 1286, as Document No. 402540, and by Certificate of Amendments recorded November 22, 2000 in Book 1100, at Page 4362, as Document No. 503768 and recorded July 17, 2001, Book 701, Page 3929, as Document No. 518479.



**STATE OF NEVADA  
DECLARATION OF VALUE**

1. Assessor Parcel Number(s)  
 a. 1320-33-311-013  
 b. \_\_\_\_\_  
 c. \_\_\_\_\_  
 d. \_\_\_\_\_

2. Type of Property:
- |  |   |
|--|---|
| a. <input type="checkbox"/> Vacant Land  | b. <input checked="" type="checkbox"/> Single Fam. Res. |
| c. <input type="checkbox"/> Condo/Twnhse | d. <input type="checkbox"/> 2-4 Plex                    |
| e. <input type="checkbox"/> Apt. Bldg    | f. <input type="checkbox"/> Comm'l/Ind'l                |
| g. <input type="checkbox"/> Agricultural | h. <input type="checkbox"/> Mobile Home                 |
| <input type="checkbox"/> Other           |   |

FOR RECORDERS OPTIONAL USE ONLY	
Book _____	Page: _____
Date of Recording: _____	
Notes: <u>HT - Trust Cert OK</u>	

- 3.a. Total Value/Sales Price of Property \$ \_\_\_\_\_  
 b. Deed in Lieu of Foreclosure Only (value of property) ( \_\_\_\_\_ )  
 c. Transfer Tax Value: \$ \_\_\_\_\_  
 d. Real Property Transfer Tax Due \$ 0

4. **If Exemption Claimed:**  
 a. Transfer Tax Exemption per NRS 375.090, Section #7  
 b. Explain Reason for Exemption: to a trust without consideration

5. Partial Interest: Percentage being transferred: \_\_\_\_\_ %  
 The undersigned declares and acknowledges, under penalty of perjury, pursuant to NRS 375.060 and NRS 375.110, that the information provided is correct to the best of their information and belief, and can be supported by documentation if called upon to substantiate the information provided herein. Furthermore, the parties agree that disallowance of any claimed exemption, or other determination of additional tax due, may result in a penalty of 10% of the tax due plus interest at 1% per month. Pursuant to NRS 375.030, the Buyer and Seller shall be jointly and severally liable for any additional amount owed.

Signature [Signature] Capacity: GRANTOR  
 Signature [Signature] Capacity: \_\_\_\_\_

**SELLER (GRANTOR) INFORMATION (REQUIRED)**  
 Print Name: Michael H. Bradford, a married man as his sole and separate property  
 Address: PO Box 10387  
 City: Zephyr Cove  
 State: NV Zip: 89448

**BUYER (GRANTEE) INFORMATION (REQUIRED)** Michael H. Bradford and Kathryn H. Bradford, Trustees of  
 Print Name: The Michael and Kathryn Bradford Living Trust dated March 12, 2013  
 Address: PO Box 10387  
 City: Zephyr Cove  
 State: NV Zip: 89448

**COMPANY/PERSON REQUESTING RECORDING (Required if not seller or buyer)**  
 Print Name: \_\_\_\_\_ Escrow # \_\_\_\_\_  
 Address: \_\_\_\_\_  
 City: \_\_\_\_\_ State: \_\_\_\_\_ Zip: \_\_\_\_\_

AS A PUBLIC RECORD THIS FORM MAY BE RECORDED/MICROFILMED