

**SURVEYOR'S CERTIFICATE**

I, GREGORY S. PHILLIPS, A PROFESSIONAL LAND SURVEYOR LICENSED IN THE STATE OF NEVADA, AS AGENT FOR LUMOS AND ASSOCIATES, INC., CERTIFY THAT:

- 1) THIS PLAT REPRESENTS THE RESULTS OF A SURVEY CONDUCTED UNDER MY DIRECT SUPERVISION AT THE INSTANCE OF JOHN AND MARIA ENGELS.
- 2) THE LANDS SURVEYED LIE WITHIN A PORTION OF THE NORTH 1/2 OF SECTION 20, T.12 N., R.20 E., M.D.M., DOUGLAS COUNTY, NEVADA AND THE SURVEY WAS COMPLETED ON NOVEMBER 4, 2014.
- 3) THIS PLAT COMPLIES WITH APPLICABLE STATUTES OF THIS STATE AND ANY LOCAL ORDINANCES IN EFFECT ON THE DATE THAT THE SURVEY WAS COMPLETED AND THE SURVEY WAS CONDUCTED IN ACCORDANCE WITH CHAPTER 625 OF THE NEVADA ADMINISTRATIVE CODE.
- 4) THE MONUMENTS DEPICTED ON THIS PLAT ARE OF THE CHARACTER SHOWN, OCCUPY THE POSITIONS INDICATED, AND ARE OF SUFFICIENT NUMBER AND DURABILITY.
- 5) THIS RECORD OF SURVEY IS NOT IN CONFLICT WITH NRS 625.340 AND NO NEW LOTS ARE BEING CREATED.

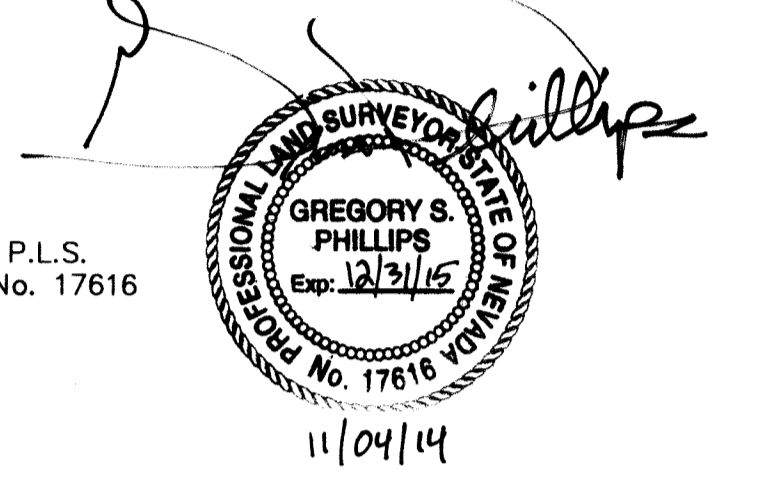

GREGORY S. PHILLIPS, P.L.S.  
NEVADA CERTIFICATE No. 17616

**REFERENCE DOCUMENTS**

- (R1) TRACT MAP FOR COUNTRY LANE SUBDIVISION, RECORDED FEBRUARY 4, 1981, FILE NO. 53226, IN BOOK 281, AT PAGE 242, OFFICIAL RECORDS OF DOUGLAS COUNTY, NEVADA.
- (R2) TRACT MAP FOR MARRON ESTATES, RECORDED SEPTEMBER 9, 1980, FILE NO. 48330, IN BOOK 980, AT PAGE 682, OFFICIAL RECORDS OF DOUGLAS COUNTY, NEVADA.
- (R3) DEED DOCUMENT NO. 851781, RECORDED OCTOBER 28, 2014, OFFICIAL RECORDS OF DOUGLAS COUNTY, NEVADA.

**BASIS OF BEARING**

THE BASIS OF BEARING FOR THIS SURVEY IS IDENTICAL TO THAT AS SHOWN ON THE TRACT MAP FOR COUNTRY LANE SUBDIVISION, RECORDED FEBRUARY 4, 1981, AS INSTRUMENT NO. 53226, IN BOOK 281 OF MAPS, AT PAGE 242, OFFICIAL RECORDS OF DOUGLAS COUNTY, NEVADA.

**LEGEND**

- ⊙ FOUND CENTERLINE MONUMENT IN WELL AS DESCRIBED
- FOUND 5/8" REBAR WITH PLASTIC CAP "LS 6200" - UNLESS OTHERWISE NOTED
- SET 5/8" REBAR WITH PLASTIC CAP "PLS 17616"
- (M) MEASURED COURSE AND DISTANCE
- (R1) RECORD COURSE AND DISTANCE PER REFERENCED DOCUMENT
- (C) CALCULATED COURSE AND DISTANCE

**RECORDER'S CERTIFICATE**

FILED FOR RECORD AT THE REQUEST OF LUMOS AND ASSOCIATES, INC., ON THIS 4<sup>th</sup> DAY OF November, 2014, AT 51 MINUTES PAST 9 O'CLOCK A.M., IN BOOK N/A, AT PAGE N/A OF OFFICIAL RECORDS OF CARSON CITY, NEVADA.

RECORDING FEE: 21<sup>00</sup> BY: Aubrey Rowlett, Deputy Recorder

Doc FILE NUMBER: 2014-852106 BY: \_\_\_\_\_

**RECORD OF SURVEY**  
FOR  
**JOHN AND MARIA ENGELS**  
BEING LOT 27 OF BLOCK "E" - COUNTRY LANE SUBDIVISION  
LOCATED WITHIN THE NORTH 1/2 OF SECTION 20  
TOWNSHIP 12 NORTH, RANGE 20 EAST, M.D.M.  
DOUGLAS COUNTY NEVADA

**LUMOS & ASSOCIATES**  
800 E. COLLEGE PARKWAY  
CARSON CITY, NV 89706  
TEL (775) 883-7077  
FAX (775) 883-7114

Drawn By : JMM  
Sheet: 1 of 1  
Job No. : 8664.000  
Dwg No. : 8664000 ROS.DWG