

LINE	BEARING	DISTANCE	LINE	BEARING	DISTANCE
L1	N 75°20'03" W	127.28	L38	N 24°07'48" E	58.50
L2	N 18°08'38" E	53.74	L39	N 34°14'08" E	58.39
L3	N 18°08'38" E	50.00	L40	N 37°06'16" E	53.97
L4	N 18°08'38" E	5.88	L41	N 37°06'16" E	50.00
L5	N 52°52'44" W	161.51	L43	N 37°06'04" E	53.13
L6	N 17°28'35" W	124.30	L44	S 50°55'04" E	110.79
L7	N 46°05'46" W	102.86	L45	N 39°04'56" E	15.00
L8	N 20°55'19" W	110.81	L46	N 50°55'04" W	111.31
L9	N 18°16'23" E	109.22	L47	N 37°06'35" E	34.53
L10	N 50°17'23" E	118.97	L48	N 36°12'39" W	53.21
L11	S 71°51'22" E	100.32	L49	N 01°05'40" W	165.93
L12	S 62°13'10" E	50.72	L50	N 24°27'56" E	191.96
L13	S 61°39'18" E	60.79	L51	N 52°54'53" E	264.91
L14	N 19°36'01" E	50.43	L52	N 52°55'10" E	50.00
L15	N 69°40'38" W	111.81	L53	N 52°54'53" E	50.00
L16	N 80°45'53" W	55.53	L54	N 52°54'35" E	54.00
L17	N 73°11'17" W	56.27	L56	N 52°54'39" E	60.92
L18	N 39°08'26" W	108.75	L57	N 89°55'15" E	12.69
L19	N 02°27'44" E	115.24	L58	S 37°05'07" E	49.09
L20	N 43°36'08" E	115.24	L59	S 03°53'19" E	27.60
L21	N 84°23'04" E	110.36	L60	N 51°53'00" E	106.78
L22	S 65°28'52" E	63.41	L61	S 35°07'00" E	50.00
L23	S 52°49'27" E	55.76	L62	S 27°23'38" E	50.89
L24	S 67°18'14" E	110.00	L63	S 27°24'09" E	23.26
L25	N 22°41'46" E	39.73	L64	N 65°29'44" E	63.68
L26	N 67°18'14" W	110.00	L65	N 66°31'30" E	56.87
L27	N 77°30'28" W	50.80	L66	N 69°17'04" E	56.78
L28	N 75°01'22" W	50.46	L67	N 72°05'49" E	59.25
L29	N 52°14'21" W	96.87	L68	N 72°51'51" E	50.00
L30	N 14°38'18" W	106.31	L69	N 73°53'21" E	50.00
L31	N 08°53'44" E	117.51	L70	N 73°53'42" E	50.00
L32	N 67°38'52" E	119.69	L71	N 75°32'35" E	50.02
L33	S 72°23'15" E	101.88	L72	N 89°55'15" E	52.02
L34	S 64°07'29" E	50.08	L74	N 89°54'55" E	118.10
L35	S 46°29'49" E	53.49	L75	N 89°55'36" E	57.34
L36	N 22°41'46" E	50.00	L76	N 89°55'14" E	187.75
L37	N 22°47'20" E	53.68	L77	S 85°50'43" E	411.16

BASIS OF BEARING

THE NORTHEAST 1/4 SECTION LINE OF SECTION 8 BEING N89°55'15"E.

REFERENCES

1. AMENDED FINAL MAP LDA #99-54-1A RECORDED DECEMBER 29, 2003.
2. FINAL MAP LDA #99-54-3 RECORDED JUNE 6, 2000.
3. FINAL MAP LDA #99-54-4 RECORDED MAY 29, 2002.
4. FINAL MAP LDA #99-54-5 RECORDED AUGUST 21, 2003.
5. FINAL MAP LDA #99-54-6 RECORDED AUGUST 24, 2004.
6. FINAL MAP LDA #99-54-7 RECORDED JUNE 6, 2005.

LEGEND:

- - SET 5/8" REBAR WITH YELLOW BRASS CAP PLS No. 7998
- - FOUND CENTERLINE MONUMENT
- TL - RECORD POINT. NOTHING FOUND OR SET

SURVEYOR'S CERTIFICATE:

1. RANDAL L. BRIGGS, A PROFESSIONAL LAND SURVEYOR, LICENSED IN THE STATE OF NEVADA, CERTIFY THAT: THIS IS A TRUE AND ACCURATE REPRESENTATION OF THE LANDS SURVEYED UNDER MY SUPERVISION AT THE INSTANCE OF THE SPRINGS PROPERTY HOME OWNERS ASSOCIATION.
2. THE LANDS SURVEYED LIE WITHIN A PORTION OF SECTION 8, T14N, R20E, M.D.M., DOUGLAS COUNTY, NEVADA AND THE SURVEY WAS COMPLETED ON JANUARY 8, 2015.
3. THIS PLAT COMPLIES WITH THE APPLICABLE STATE STATUTES AND ANY LOCAL ORDINANCES IN EFFECT ON THE DATE THE GOVERNING BODY GAVE ITS FINAL APPROVAL.
4. THE MONUMENTS DEPICTED ON THE PLAT WILL BE OF THE CHARACTER SHOWN AND OCCUPY THE POSITIONS INDICATED.

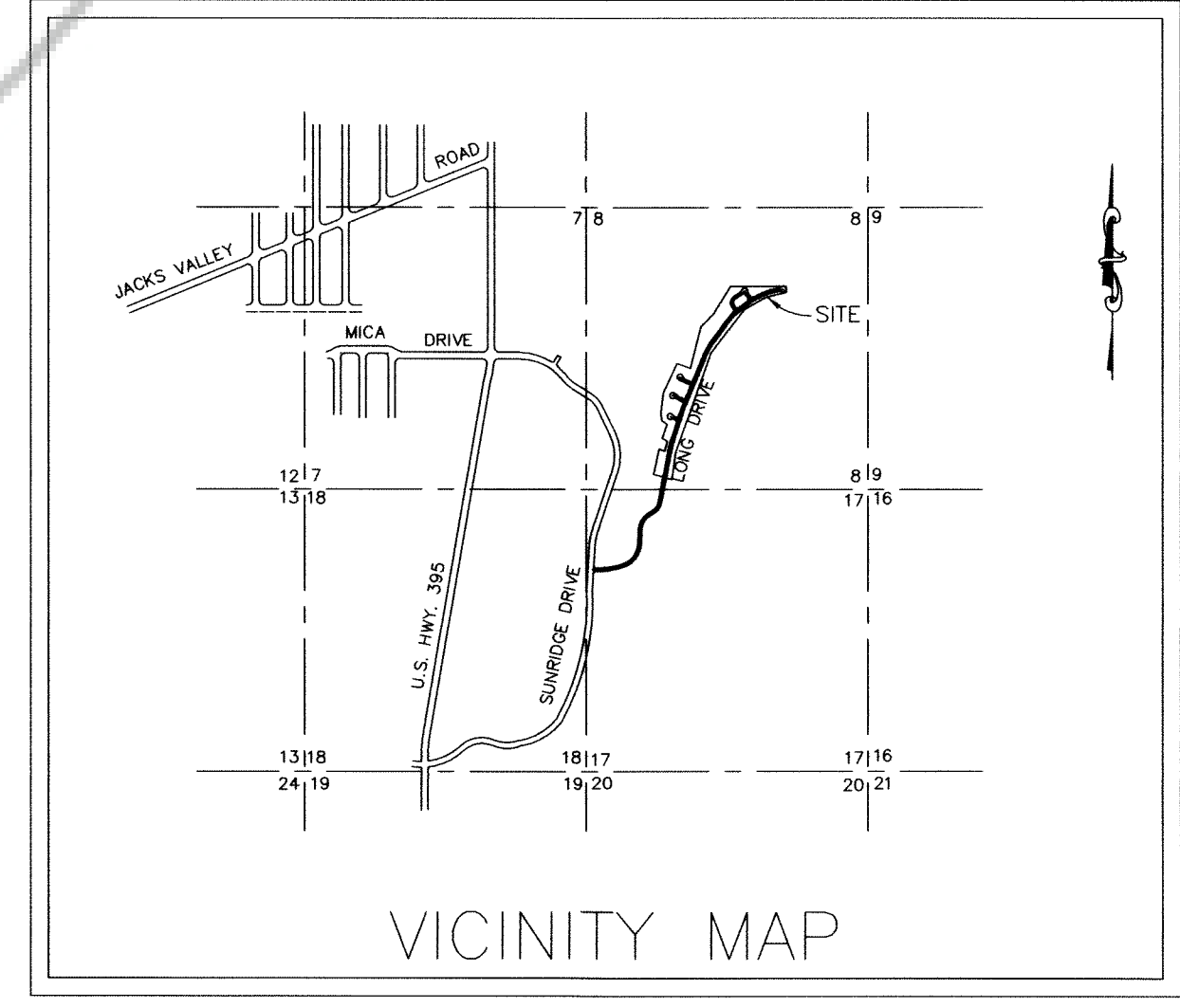

Randal L. Briggs
 RANDAL L. BRIGGS, P.L.S. 7998
 RANDAL L. BRIGGS
 RANDAL L. BRIGGS
 1-22-15
 DATE
 No. 7998
 EXP. 12/31/16

FILE NO. 2015-855979 FILED FOR RECORD AT THE REQUEST OF TEC ON THIS 23 DAY OF January 2015, AT 57 MINUTES PAST 8 O'CLOCK A.M. , OFFICIAL RECORDS OF DOUGLAS COUNTY, NEVADA. BY: <i>Karen Ellison</i> COUNTY RECORDER DEPUTY FEE: 21-	RECORD OF SURVEY FOR THE SPRINGS PROPERTY OWNERS ASSOCIATION BEING A PORTION OF SECTION 8, T14N, R20E, M.D.M.		SHEET 1 OF 1
	DOUGLAS COUNTY NEVADA 9480 Double Diamond Pkwy #200, Reno, 89521 (775)352-7800 Fax(775)352-7929		