

DOUGLAS COUNTY, NV

RPTT:\$50.70 Rec:\$17.00

\$67.70 Pgs=4

ETRCO, LLC

KAREN ELLISON, RECORDER

2015-857581

02/27/2015 04:06 PM

APN#: 1318-25-111-005

RPTT: \$50.70

Recording Requested By:

Western Title Company

Escrow No.: 068844-JMW

When Recorded Mail To:

Joel Bergman

28181 Montecito, Unit 50

Laguna Niguel 92677-4515

Mail Tax Statements to: (deeds only)

Same as Above Please

I the undersigned hereby affirm that the attached document, including any exhibits, hereby submitted for recording does not contain the social security number of any person or persons.

(Per NRS 239B.030)

Signature _____

J. Williams
J. Williams, Certified Senior Escrow Officer

Grant, Bargain, and Sale Deed

This page added to provide additional information required by NRS 111.312
(additional recording fee applies)

GRANT, BARGAIN AND SALE DEED

THIS INDENTURE WITNESSETH: That

FOR A VALUABLE CONSIDERATION, receipt of which is hereby acknowledged,

Kari Lyn, an unmarried woman, as Trustee of The Kari Lyn Living Trust

do(es) hereby GRANT(s) BARGAIN SELL and CONVEY to

Joel Bergman, an unmarried man

and to the heirs and assigns of such Grantee forever, all the following real property situated in the City of Stateline, County of Douglas State of Nevada bounded and described as follows:

See attached Exhibit A

TOGETHER with all tenements, hereditaments and appurtenances, if any, thereto belonging or appertaining, and any reversions, remainders, rents, issues or profits thereof.

Dated: 02/04/2015

EXHIBIT "A"

All that certain real property situate in the County of Douglas, State of Nevada, described as follows:

An undivided 4% interest in Lot 2, as shown on the official map of KINGSBURY PALISADES, filed in the office of the County Recorder on September 18, 1962, Document No. 20864, Official Records of Douglas County, State of Nevada.

**Assessor's Parcel Number(s):
1318-25-111-005**

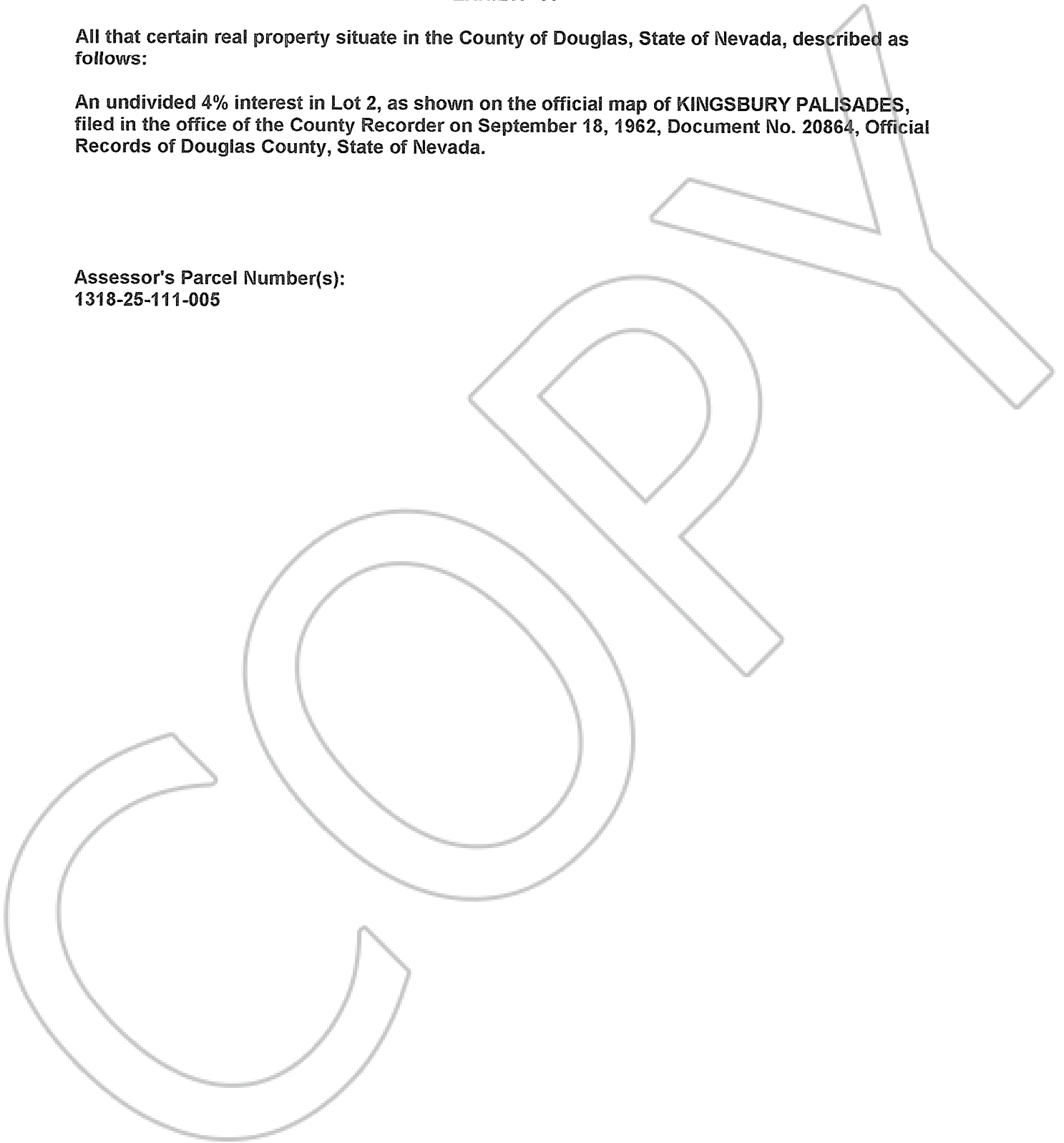

STATE OF NEVADA DECLARATION OF VALUE

1. Assessors Parcel Number(s)

- a) 1318-25-111-005
- b)
- c)
- d)

2. Type of Property:

- a) Vacant Land
- b) Single Fam. Res.
- c) Condo/Twnhse
- d) 2-4 Plex
- e) Apt. Bldg
- f) Comm'/Ind'l
- g) Agricultural
- h) Mobile Home
- i) Other _____

FOR RECORDERS OPTIONAL USE ONLY	
DOCUMENT/INSTRUMENT #:	_____
BOOK _____	PAGE _____
DATE OF RECORDING:	_____
NOTES:	_____

3. Total Value/Sales Price of Property: \$13,000.00

Deed in Lieu of Foreclosure Only (value of property) (_____)

Transfer Tax Value: \$13,000.00

Real Property Transfer Tax Due: \$50.70

4. If Exemption Claimed:

- a. Transfer Tax Exemption per NRS 375.090, Section _____
- b. Explain Reason for Exemption: _____

5. Partial Interest: Percentage being transferred: AN undivided 4/20

The undersigned declares and acknowledges, under penalty of perjury, pursuant to NRS 375.060 and NRS 375.110, that the information provided is correct to the best of their information and belief, and can be supported by documentation if called upon to substantiate the information provided herein. Furthermore, the parties agree that disallowance of any claimed exemption, or other determination of additional tax due, may result in a penalty of 10% of the tax due plus interest at 1% per month.

Pursuant to NRS 375.030, the Buyer and Seller shall be jointly and severally liable for any additional amount owed.

Signature Kari Lyn Capacity Grantor/Seller
 Signature _____ Capacity _____

SELLER (GRANTOR) INFORMATION (REQUIRED)

Print Name: The Kari Lyn Living Trust
 Address: PO Box 859
 City: Sebastopol
 State: CA Zip: 95473

BUYER (GRANTEE) INFORMATION (REQUIRED)

Print Name: Joel Bergman
 Address: 28181 Montecito, Unit 50
 City: Laguna Niguel
 State: CA Zip: 92677-4515

COMPANY/PERSON REQUESTING RECORDING

(required if not the seller or buyer)

Print Name: eTRCo, LLC. On behalf of Western Title Company
 Address: Kietzke Office
5390 Kietzke Ln Suite 101
 City/State/Zip: Reno, NV 89511

Esc. #: 068844-JMW

Please complete addresses.