

APN No.: 1022-14-001-008

Recording requested by:
First Mortgage Corporation
When recorded mail to:
✓ **FIRST MORTGAGE CORPORATION**
1131 WEST 6TH STREET, SUITE #300
ONTARIO, CA 91762



KAREN ELLISON, RECORDER

Property Address:
4045 SUNRISE COURT, WELLINGTON, NV 89444

It is hereby affirmed that this document submitted for recording does not contain the social security number of any person or persons. (Per NRS 239B.030).

Loan #: 405317

Request for Notice
Pursuant to NRS 116.31168 and NRS 107.090

The undersigned, Jose Ibarra is the authorized agent for FIRST MORTGAGE CORPORATION, A CALIFORNIA CORPORATION, the Holder of a Note secured by a Deed of Trust dated June 13, 2012 made by JERRY MOSLEY AND JANICE MOSLEY, HUSBAND AND WIFE AS JOINT TENANTS as Grantor(s), to MERS - Mortgage Electronic Registration Systems, Inc. as original Beneficiary, naming HACIENDA SERVICE CORPORATION, A CALIFORNIA CORPORATION as original Trustee, and recorded on July 02, 2012 in the Official Records of the Office of the Recorder of DOUGLAS County, Nevada, as 804978. Said Deed of Trust encumbers the real property commonly known as 4045 SUNRISE COURT WELLINGTON, NEVADA 89444, APN 1022-14-001-008, with the legal description set forth in attached "Exhibit A".

In accordance with and pursuant to NRS 116.31168 and NRS 107.090, the undersigned hereby requests that a copy of any Notice of Default, Notice of Sale, Notice of Lien, or other Notice issued, recorded, or mailed regarding the real property referenced herein against said real property by or on behalf of any lienholder, including *but not limited to*:

_____, be sent to the following address:

FIRST MORTGAGE CORPORATION, and its successors and/or assigns
c/o **FIRST MORTGAGE CORPORATION**
1131 WEST 6TH STREET, SUITE #300
ONTARIO, CA 91762

The last known property owner(s) are: JERRY MOSLEY, JANICE MOSLEY

The last known common interest communities are: _____

By: Jose Ibarra
Post Closing / Shipping Manager

Exhibit A

THE LAND REFERRED TO HEREIN BELOW IS SITUATED IN THE COUNTY OF DOUGLAS, STATE OF Nevada, AND IS DESCRIBED AS FOLLOWS:

LOT 12, BLOCK A, AS SHOWN ON THE MAP ENTITLED TOPAZ RANCH ESTATES, UNIT NO. 4, FILED IN THE OFFICE OF THE COUNTY RECORDER OF DOUGLAS COUNTY, STATE OF NEVADA, ON NOVEMBER 16, 1970, IN BOOK 1 OF MAPS, PAGE 224, AS DOCUMENT NO. 50212.

Parcel ID: 1022-14-001-008

Commonly known as 4045 Sunrise Court, Wellington, NV 89444
However, by showing this address no additional coverage is provided

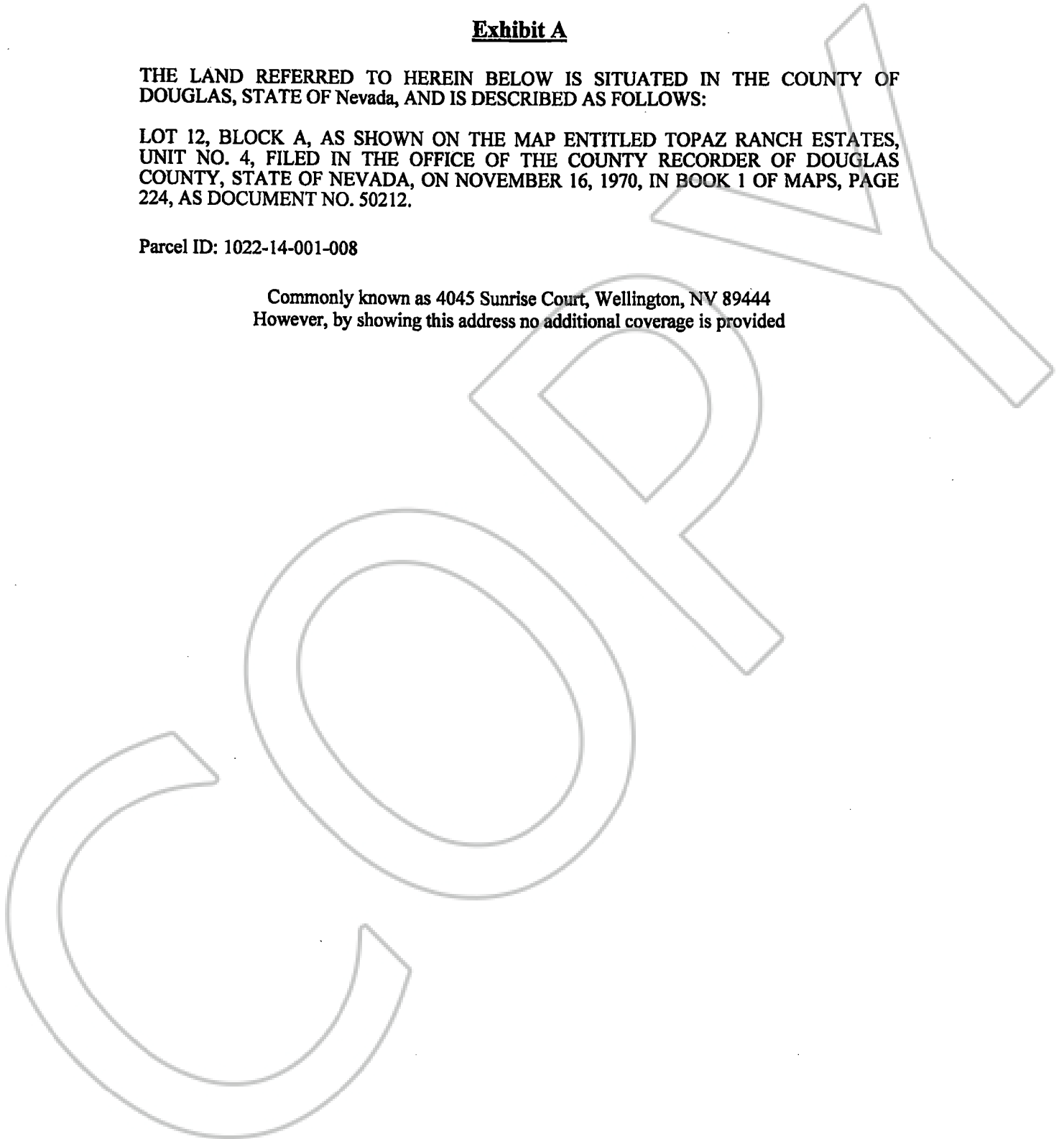

ACKNOWLEDGMENT

A notary public or other officer completing this certificate verifies only the identity of the individual who signed the document to which this certificate is attached, and not the truthfulness, accuracy, or validity of that document.

State of California
County of San Bernardino

On April 29, 2015 before me, **F. Washington, Notary Public**

personally appeared **Jose Ibarra,**

who proved to me on the basis of satisfactory evidence to be the person whose name is subscribed to the within instrument and acknowledged to me that he executed the same in his authorized capacity, and that by his signature on the instrument the person, or the entity upon behalf of which the person acted, executed the instrument.

I certify under PENALTY OF PERJURY under the laws of the State of California that the foregoing paragraph is true and correct.

WITNESS my hand and official seal.

Signature

