



KAREN ELLISON, RECORDER

DECLARATION OF HOMESTEAD

Assessor Parcel Number: 1220 -15-511-018

OR

Assessor's Manufactured Home ID Number: _____

Recording Requested by and Mail to:

Name: Mike Arraiz

Address: 933 Fairway Dr

City/State/Zip: Gardnerville NV 89460

Check One:

- Married (filing jointly) Married (filing individually)
- Head of Family Widowed
- Single Person Multiple Single Persons
- By Wife (filing for joint benefit of both)
- By Husband (filing for joint benefit of both)
- Other (describe): _____

Check One:

- Regular Home Dwelling/Manufactured Home Condominium Unit Other

Name on Title of Property

Michael E. Arraiz

do individually or severally certify and declare as follows:

Michael E. Arraiz

is/are now residing on the land, premises (or manufactured home) located in the city/town of Gardnerville,
County of Douglas, State of Nevada, and more particularly described as follows:

(set forth legal description and commonly known street address OR manufactured home description)

See Attached Exhibit "A"

I/We claim the land and premises hereinabove described, together with the dwelling house thereon, and its appurtenances, or the described manufactured home as a Homestead.

In Witness, Whereof, I/we have hereunto set my hand/our hands this 22 day of June, 2015.

[Signature]
Signature
Mike Arraiz
Print or type name here

Signature

Print or type name here

STATE OF NEVADA, COUNTY OF Douglas

This instrument was acknowledged before me on 6/22/15

by Michael Edward Arraiz (date)
Person(s) appearing before notary

by _____
Person(s) appearing before notary
Shawnyne Garren
Signature of notarial officer

CONSULT AN ATTORNEY IF YOU DOUBT THIS FORM'S FITNESS FOR YOUR PURPOSE.

Notary Seal

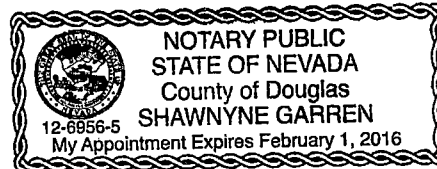

NOTE: Leave space within 1-inch margin blank on all sides.

Oct. 2009

EXHIBIT "A"

LEGAL DESCRIPTION

ESCROW NO.: 030702148

Lot 21, as said lot is shown on the Official Plat of GARDNERVILLE RANCHOS UNIT NO. 3, filed in the office of the County Recorder of Douglas County, Nevada, on June 1, 1965, and Title Sheet amended on June 4, 1965, as Document No. 28378.

Assessor's Parcel No. 1220-15-511-018

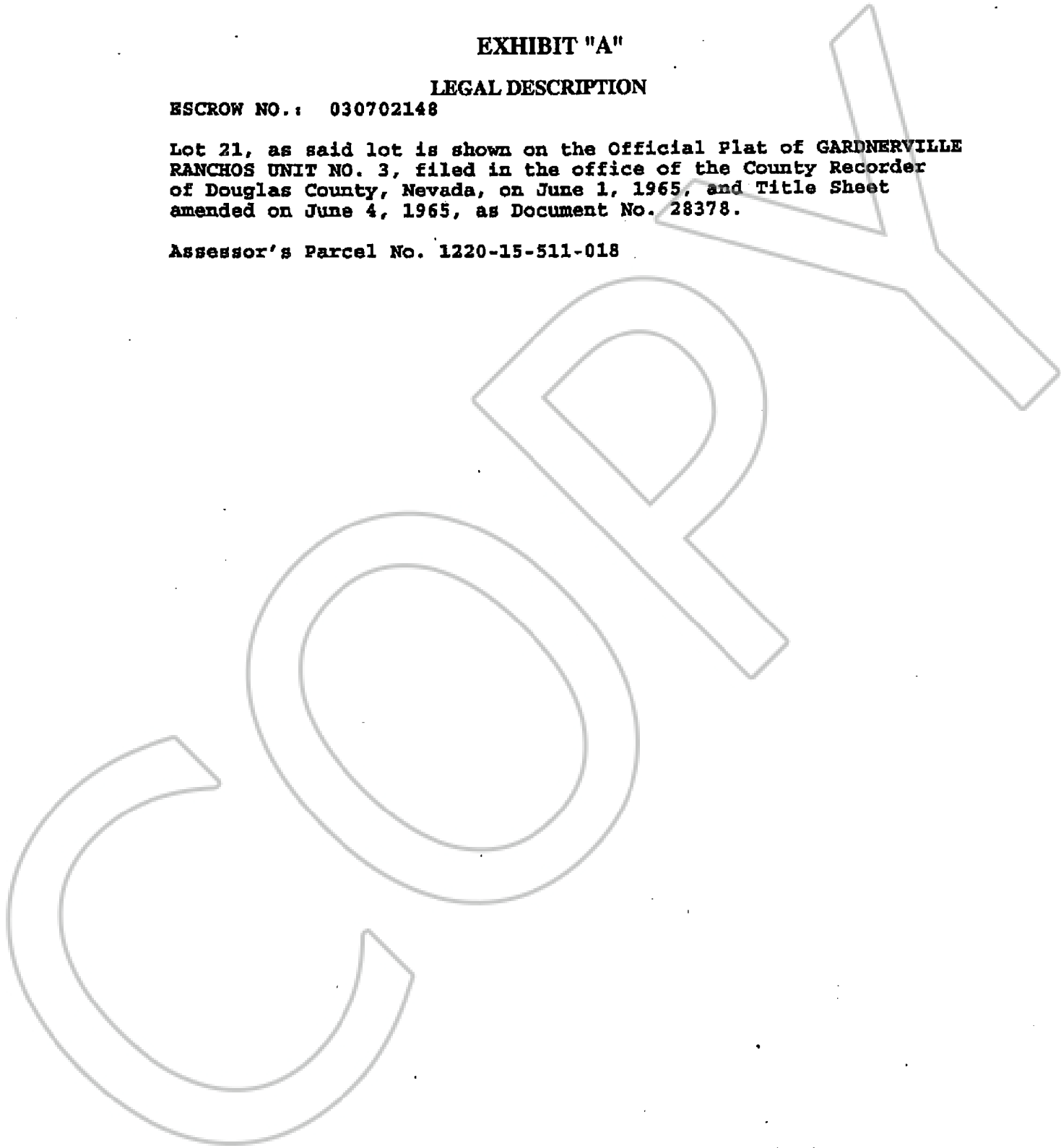

0583642

BK0703PG08316