

DOUGLAS COUNTY, NV **2015-868760**
RPTT:\$1365.00 Rec:\$15.00
\$1,380.00 Pgs=2 **08/26/2015 02:28 PM**
NORTHERN NEVADA TITLE CC
KAREN ELLISON, RECORDER

WHEN RECORDED MAIL TO:
Jeff D Ouellette
2619 Gordon Ave
Minden, NV 89423

MAIL TAX STATEMENTS TO:
Same as Above

Escrow No. N1500878-RIT

The undersigned hereby affirms that this document submitted for recording does not contain the social security number of any person or persons.
(Pursuant to NRS 239b.030)

APN No.: 1420-34-401-014
R.P.T.T. \$ *1365.00*

SPACE ABOVE FOR RECORDER'S USE ONLY

GRANT, BARGAIN, SALE DEED

THIS INDENTURE WITNESSETH: That David Mark Ruben and Sherilyn Kay Ruben, Trustees of the Ruben Family Trust dated June 16, 2009

FOR A VALUABLE CONSIDERATION, receipt of which is hereby acknowledged, do/does hereby Grant, Bargain, Sell and Convey to Jeff D Ouellette, a married man as his sole and separate property

all that real property situated in the County of Douglas, State of Nevada, described as follows:
SEE EXHIBIT "A" ATTACHED HERETO AND BY REFERENCE MADE A PART HEREOF

Together with all and singular the tenements, hereditaments and appurtenances thereunto belonging or in anywise appertaining.

David Mark Ruben and Sherilyn Kay Ruben,
Trustees of the Ruben Family Trust dated June
16, 2009

[Signature]

David Mark Ruben, Trustee

[Signature]

Sherilyn Kay Ruben, Trustee

STATE OF NEVADA }
COUNTY OF ~~DOUGLAS~~ *DC Carson City* } ss:

This instrument was acknowledged before me on, *8/24/15*
by David Mark Ruben and Sherilyn Kay Ruben, Trustees of the Ruben Family Trust dated June 16, 2009

[Signature]

NOTARY PUBLIC

 **DAWN CUELLAR**
Notary Public - State of Nevada
Appointment Recorded in Carson City
No: 14-15385-3 - Expires October 22, 2018

Escrow No. N1500878-RIT

**EXHIBIT A
LEGAL DESCRIPTION**

Parcel 1 of Parcel Map for Silver State Construction, recorded in the office of the Douglas County Recorder, State of Nevada, on December 4, 1986, in Book 1286 at Page 514, as File No. 146126, Official Records.

Said land being a portion of Lot 10, as shown on the map of ARTEMESIA SUBDIVISION, filed in the office of the Douglas County Recorder.

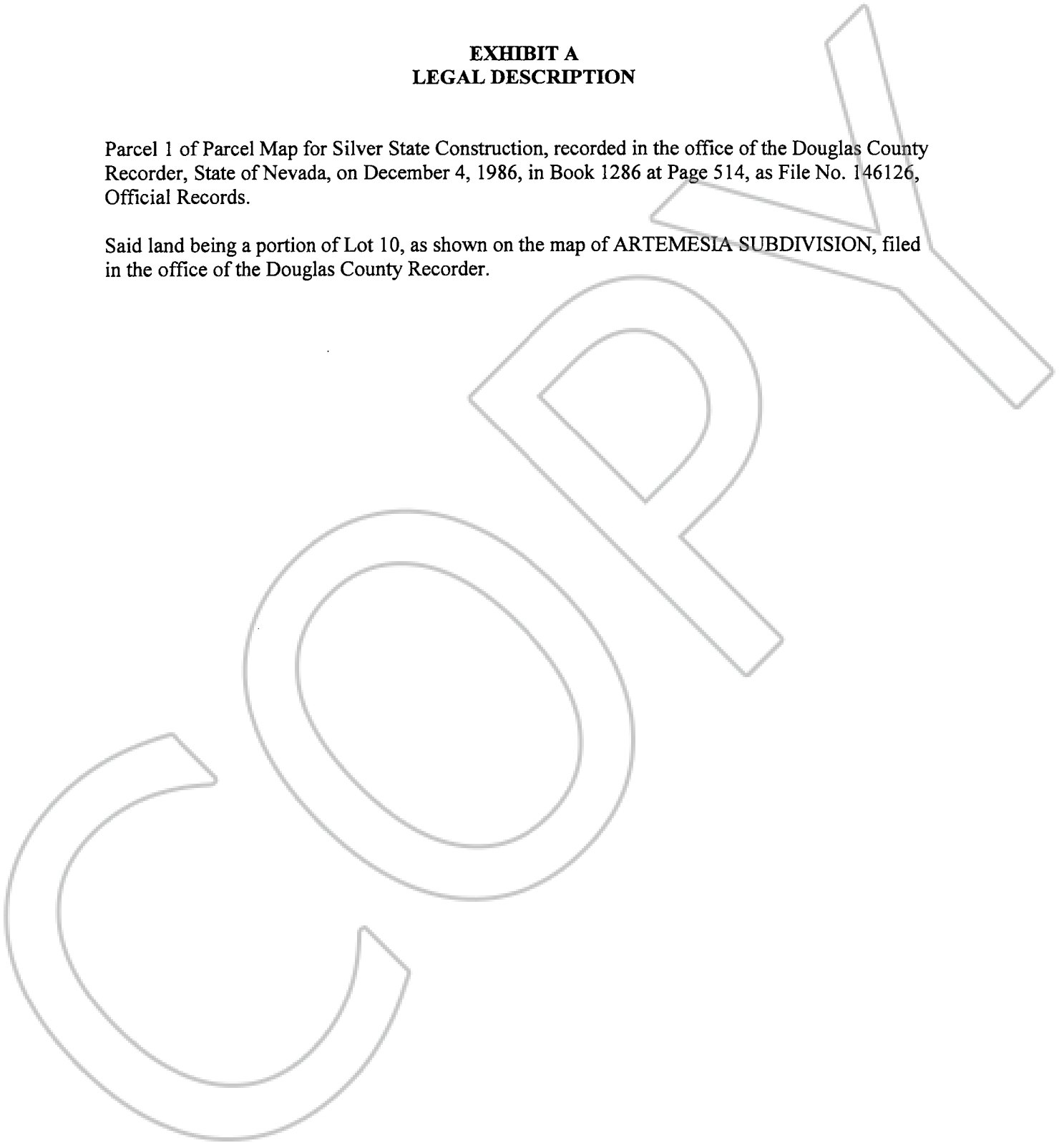

STATE OF NEVADA-DECLARATION OF VALUE FORM

1. Assessor Parcel Number(s)

- a) 1420-34-401-014
- b) _____
- c) _____
- d) _____

2. Type of Property:

- a) Vacant Land b) Single Fam. Res.
- c) Condo/Twnhse d) 2-4 Plex
- e) Apt. Bldg f) Comm'l/Ind'l
- g) Agricultural h) Mobile Home
- i) Other _____

FOR RECORDERS OPTIONAL USE ONLY	
Book _____	Page _____
Date of Recording: _____	
Notes: _____	

3. Total Value/Sales Price of Property:

\$350,000.00
 Deed in Lieu of Foreclosure Only (value of property) \$ _____
 Transfer Tax Value \$350,000.00
 Real Property Transfer Tax Due: \$1,365.00

4. If Exemption Claimed

- a. Transfer Tax Exemption, per NRS 375.090, Section _____
- b. Explain Reason for Exemption: _____

5. Partial Interest: Percentage being transferred: _____ %

The undersigned declares and acknowledges, under penalty of perjury, pursuant to NRS 375.060 and NRS 375.110, that the information provided is correct to the best of their information and belief, and can be supported by documentation if called upon to substantiate the information provided herein. Furthermore, the parties agree that disallowance of any claimed exemption, or other determination of additional tax due, may result in a penalty of 10% of the tax due plus interest at 1% per month. Pursuant to NRS 375.030, the Buyer and Seller shall be jointly and severally liable for any additional amount owed.

Signature [Signature] Capacity Grantor
 Signature _____ Capacity _____

SELLER (GRANTOR) INFORMATION (REQUIRED)

BUYER (GRANTEE) INFORMATION (REQUIRED)

Print Name: David Mark Ruben and Sherilyn Kay Ruben, Trustees of the Ruben Family Trust dated June 16, 2009

Print Name: Jeff D Ouellette

Address: 2729 Minerva
Minden NV 89423

Address: 2641 Garden Ave
Minden NV, 89423

City, State, Zip

City, State Zip

COMPANY/PERSON REQUESTING RECORDING (Required if not the Seller or Buyer)

Print Name: Northern Nevada Title Company Escrow #: N1500878-RIT

Address: 1483 Highway 395, Suite B

City, State, Zip: Gardnerville, NV 89410