

DOUGLAS COUNTY, NV
RPTT:\$815.10 Rec:\$15.00
\$830.10 Pgs=2 10/29/2015 01:32 PM
TICOR TITLE - GARDNERVILLE
KAREN ELLISON, RECORDER

WHEN RECORDED MAIL TO:
Verna Kay Allsip
1405 SUGAR MAPLE AVE.
GARDNERVILLE, NV 89410

MAIL TAX STATEMENTS TO:
Same as Above

Escrow No. N1501038-RLT

The undersigned hereby affirms that this document submitted for recording does not contain the social security number of any person or persons (Pursuant to NRS 239b 030)

APN No.: 1220-03-212-005
R.P.T.T. \$ 815.10

SPACE ABOVE FOR RECORDER'S USE ONLY

GRANT, BARGAIN, SALE DEED

THIS INDENTURE WITNESSETH: That Tyler Shea and Kimberly Shea, Husband and Wife, as Joint Tenants

FOR A VALUABLE CONSIDFRATION, receipt of which is hereby acknowledged, do/does hereby Grant, Bargain, Sell and Convey to Verna Kay Allsip ,

all that real property situated in the County of Douglas, State of Nevada, described as follows:
SEE EXHIBIT "A" ATTACHED HERETO AND BY REFERENCE MADE A PART HEREOF

Together with all and singular the tenements, hereditaments and appurtenances thereunto belonging or in anywise appertaining.



Tyler Shea

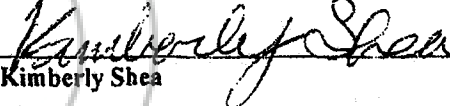

Kimberly Shea

California
STATE OF ~~NEVADA~~ *Sacramento*
COUNTY OF ~~DOUGLAS~~ *52*

} ss:

This instrument was acknowledged before me on, October 26, 2015
by Tyler Shea and Kimberly Shea

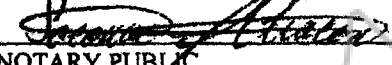

NOTARY PUBLIC

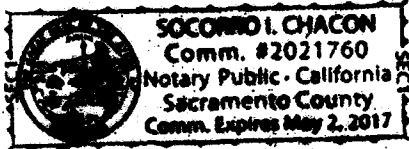

Order No.: N1501038-RLT

EXHIBIT A

All that certain real property situate in the County of Douglas, State of Nevada, described as follows:

Lot 5, in Block A, as set forth on Final Subdivision Map LDA 01-047, Planned Unit Development for ARBOR GARDENS PHASE 3, filed for record in the office of the County Recorder of Douglas County, State of Nevada on November 19, 2004 in Book 1104, Page 9523, as Document No. 629883, and by Certificate of Amendment recorded August 30, 2005 in Book 805, Page 14668, as Document No. 653714.

APN: 1220-03-212-005

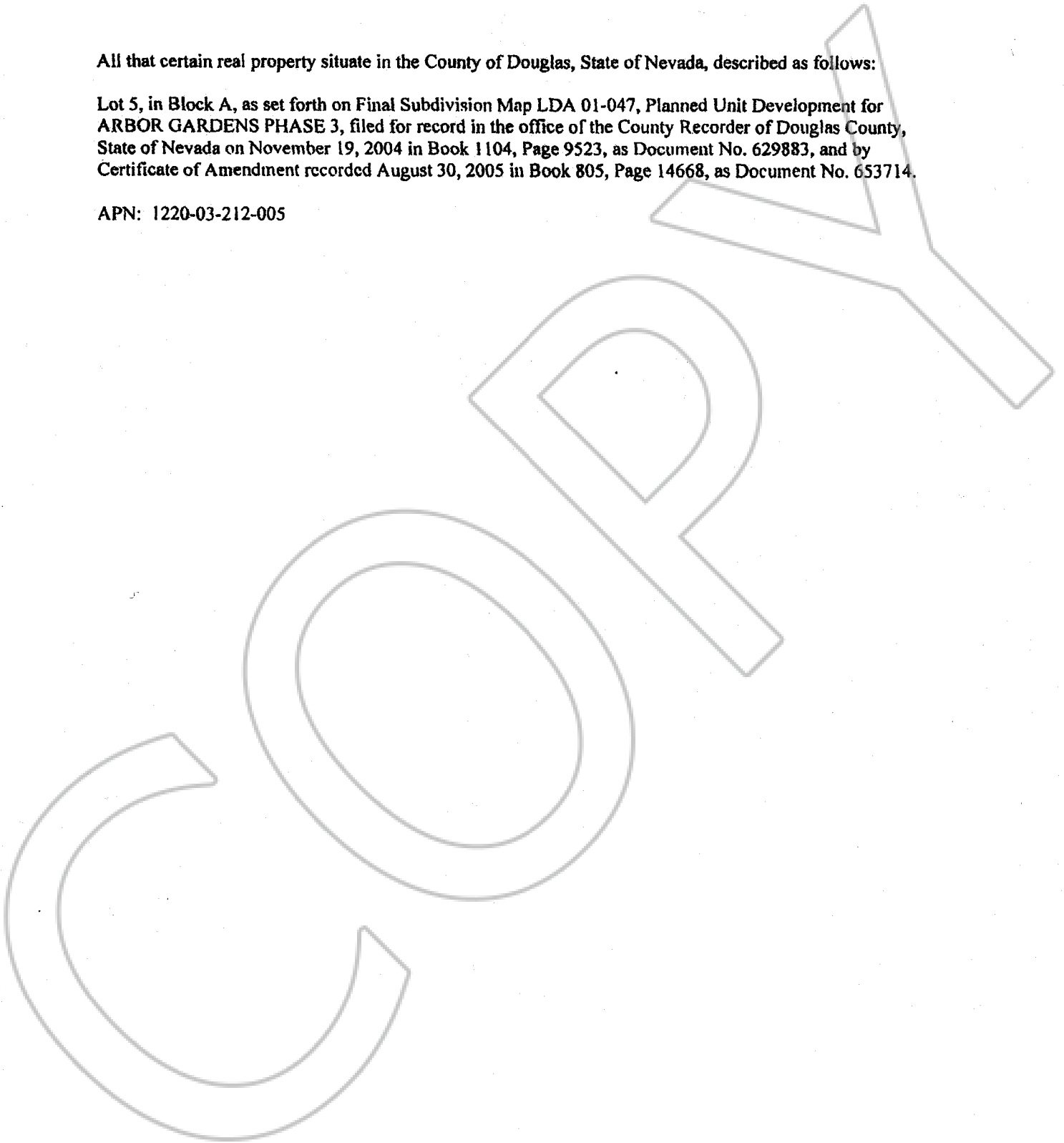

STATE OF NEVADA-DECLARATION OF VALUE FORM

1. Assessor Parcel Number(s)
 a) 1220-03-212-005
 b) _____
 c) _____
 d) _____

2. Type of Property:
- | | |
|--|---|
| a) <input type="checkbox"/> Vacant Land | b) <input checked="" type="checkbox"/> Single Fam. Res. |
| c) <input type="checkbox"/> Condo/Twnhse | d) <input type="checkbox"/> 2-4 Plex |
| e) <input type="checkbox"/> Apt. Bldg | f) <input type="checkbox"/> Comm'l/Ind'l |
| g) <input type="checkbox"/> Agricultural | h) <input type="checkbox"/> Mobile Home |
| i) <input type="checkbox"/> Other _____ | |

FOR RECORDERS OPTIONAL USE ONLY
 Book _____ Page _____
 Date of Recording: _____
 Notes: _____

3. Total Value/Sales Price of Property: \$209,000.00
 Deed in Lieu of Foreclosure Only (value of property) \$ _____
 Transfer Tax Value \$209,000.00
 Real Property Transfer Tax Due: \$815.10

4. **If Exemption Claimed**
 a. Transfer Tax Exemption, per NRS 375.090, Section _____
 b. Explain Reason for Exemption: _____

5. Partial Interest: Percentage being transferred: _____ %

The undersigned declares and acknowledges, under penalty of perjury, pursuant to NRS 375.060 and NRS 375.110, that the information provided is correct to the best of their information and belief, and can be supported by documentation if called upon to substantiate the information provided herein. Furthermore, the parties agree that disallowance of any claimed exemption, or other determination of additional tax due, may result in a penalty of 10% of the tax due plus interest at 1% per month. Pursuant to NRS 375.030, the Buyer and Seller shall be jointly and severally liable for any additional amount owed.

Signature: _____ Capacity: Grantor
 Signature: Kimberly J. Shea Capacity: Grantor

SELLER (GRANTOR) INFORMATION
 (REQUIRED)

BUYER (GRANTEE) INFORMATION
 (REQUIRED)

Print Name: Tyler Shea
 Address: 6825 SAN TOMAS DR #232
Citrus Heights, CA, 95621
 City, State, Zip

Print Name: Verna Kay Allsip
 Address: 1405 Sugar Maple Ave.
Gardnerville, NV 89410
 City, State Zip

COMPANY/PERSON REQUESTING RECORDING (Required if not the Seller or Buyer)

Print Name: Ticor Title of Nevada, Inc. Escrow #: N1501038-RLT
 Address: 1483 Highway 395, Suite B
 City, State, Zip: Gardnerville, NV 89410

AS A PUBLIC RECORD THIS FORM MAY BE RECORDED/MICROFILMED