



00025898201508728360020024

KAREN ELLISON, RECORDER

DECLARATION OF HOMESTEAD

Assessor Parcel Number: 1420.28.811.030

OR

Assessor's Manufactured Home ID Number:

Recording Requested by and Mail to

Name Barbara Knight

Address 1394 Stephanie Ws

City/State/Zip Minden, NV. 89423

Check One:

- Married (filing jointly) [checked] Married (filing individually)
Head of Family
Single Person
By Wife (filing for joint benefit of both)
By Husband (filing for joint benefit of both)
Other (describe)

Check One:

- Regular Home Dwelling/Manufactured Home [checked] Condominium Unit
Other

Name on Title of Property Parkhurst, Barbara J

do individually or severally certify and declare as follows.

John Knight - Barbara J Knight (aka Parkhurst)

is/are now residing on the land, premises (or manufactured home) located in the city/town of Minden, County of Douglas, State of Nevada, and more particularly described as follows

(set forth legal description and commonly known street address OR manufactured home description)

1394 Stephanie Ws. See attached Exhibit A
Minden, NV. 89423

I/We claim the land and premises hereinabove described, together with the dwelling house thereon, and its appurtenances, or the described manufactured home as a Homestead

In Witness, Whereof, I/we have hereunto set my hand/our hands this 17 day of November, 2015

Signature of Barbara Knight

Barbara Knight
Print or type name here

Signature of Notary

Print or type name here

STATE OF NEVADA, COUNTY OF Douglas

This instrument was acknowledged before me on 11/17/15

by Barbara Jean Knight (date)
Person(s) appearing before notary

by
Person(s) appearing before notary

Signature of notarial officer: Shawnyne Garren

CONSULT AN ATTORNEY IF YOU DOUBT THIS FORM'S FITNESS FOR YOUR PURPOSE.

NOTE: Leave space within 1-inch margin blank on all sides.

Notary Seal

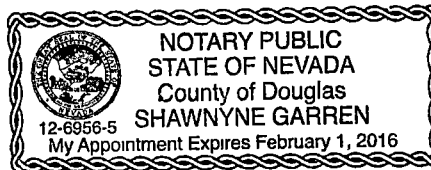

EXHIBIT "A"

LEGAL DESCRIPTION

ESCROW NO.: 030702256

Lot 2, as shown on the map of SARATOGA HEIGHTS UNIT NO. 1, filed in the Office of the County Recorder of Douglas County, Nevada, on May 15, 1961, as Document No. 17827.

Assessor's Parcel No. 1420-28-811-030

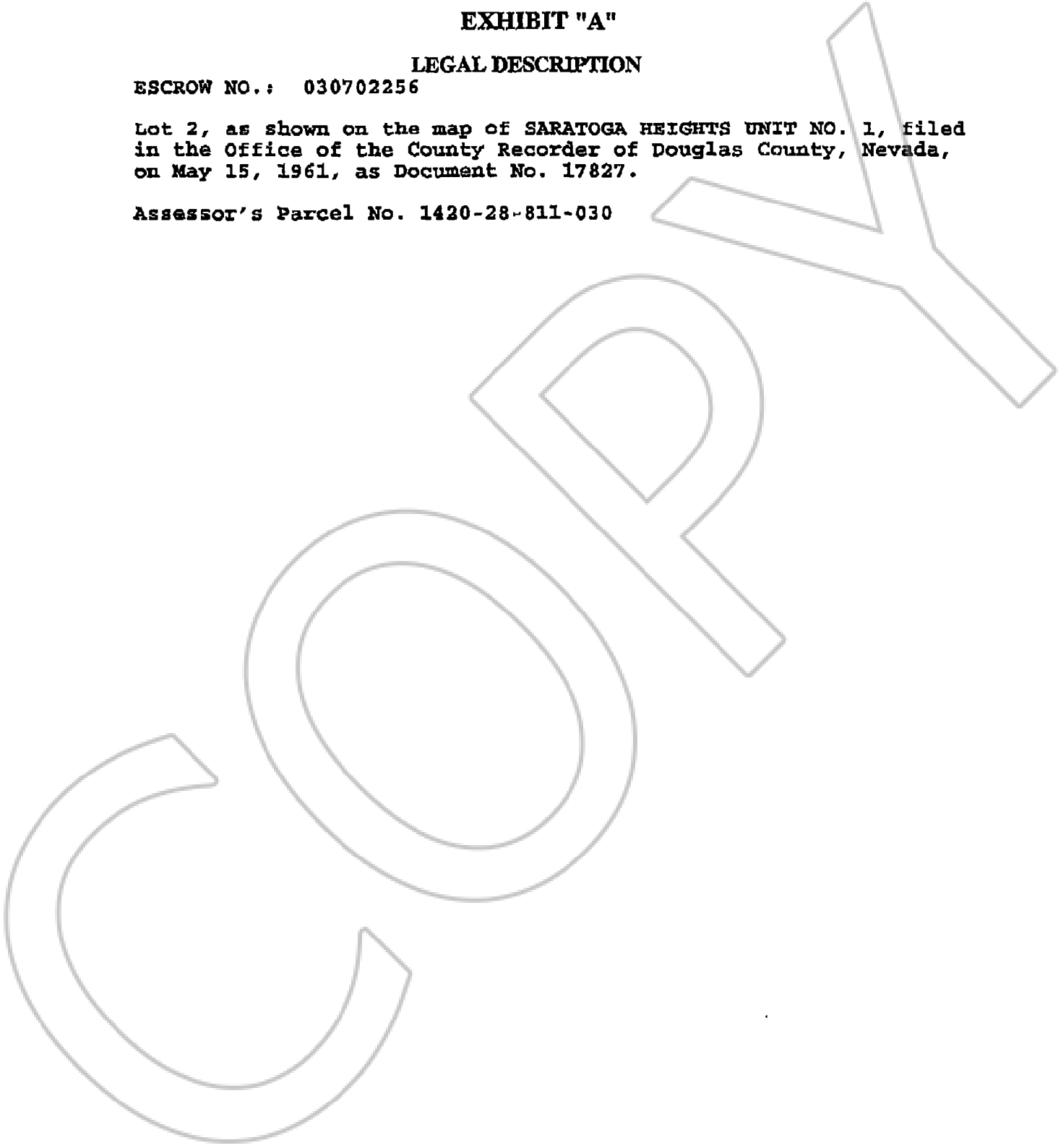

0584313

BK0703PG12146