

APN 1319-09-602-001



KAREN ELLISON, RECORDER

Recorded at the request of:
Douglas County Community Development Department
Minden NV 89423

Abandonment of Public Utility Easement

An Order of Abandonment vacating a strip of land utilized for public utility easement purposes located along the easterly property line of Parcel 2, as depicted on that certain Parcel Map for John and Margaret DeRuntz, and Robert and Juliet Brush, recorded December 10, 1975 in the official records of Douglas County, Nevada, in Book 1275, at Page 473, as Document No. 86061, located within a portion of Section 9, Township 13 North, Range 19 East, Mount Diablo Meridian, Douglas County, Nevada (APN 1319-09-602-001).

WHEREAS, Douglas County, a political subdivision of the State of Nevada, presently holds a public utility easement located within a portion of Section 9, Township 13 North, Range 19 East, Mount Diablo Meridian, as depicted on that certain Parcel Map for John and Margaret DeRuntz, and Robert and Juliet Brush, recorded December 10, 1975 in the official records of Douglas County, Nevada, in Book 1275, at Page 473, as Document No. 86061, and more particularly described in the attached Legal Description provided as Exhibits A and depicted as Exhibit B.

WHEREAS, Douglas County, pursuant to the provisions of Douglas County Code, Section 20.768.060, may vacate or abandon by formal order any portion of a public utility easement owned or controlled by Douglas County; and

WHEREAS, this abandonment request is being made in order to vacate a portion of a public utility easement owned or controlled by Douglas County; and

WHEREAS, the Community Development Department obtained written approval from all applicable public utility and video service providers indicating that they no longer request the reservation of the subject easements; and

WHEREAS, on January 8th, 2016 the Douglas County Community Development Director determined that the aforesaid easements are no longer necessary or useful to Douglas County and that the public will not be materially injured by the abandonment; and

NOW THEREFORE, be it ordered by the Douglas County Community Development Director, that the aforesaid strip of land utilized for public utility easement purposes, as described and depicted in the attached Exhibits A and B, is hereby abandoned.

DATED this 8th day of January, 2016.

Mimi Moss

Mimi Moss, AICP, Director
Douglas County Community Development Department

STATE OF NEVADA)

COUNTY OF Douglas)

This instrument was acknowledged before me on 8th day of January, 2016, by Mimi Moss on behalf of Douglas County, Nevada.

Jeanne R. Cox
NOTARY PUBLIC

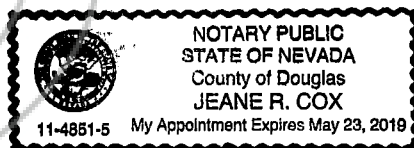

EXHIBIT 'A'

**DESCRIPTION
PUBLIC UTILITY EASEMENT RELINQUISHMENT
(OVER A.P.N. 1319-09-602-001)**

All that real property situate in the County of Douglas, State of Nevada, described as follows:

A portion of that certain five-foot (5') Public Utility Easement per that certain Parcel Map filed for record December 10, 1975 in the office of Recorder, Douglas County, Nevada as Document No. 86061, more particularly described as follows:

The easterly 5 feet of Parcel 2 per said Parcel Map, excepting therefrom the northerly and southerly 5 feet thereof.

The above-described area of relinquishment contains 591 square feet, more or less.

Prepared By: R.O. ANDERSON ENGINEERING, INC.
Clifford W. Ray, P.L.S. 15428
P.O. Box 2229
Minden, Nevada 89423

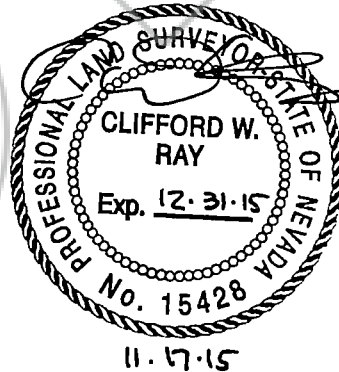

Y:\Client Files\2192-001\CAD\Survey\Exhibits\2192-001 Esmt Aband.dwg 5/6/2015 8:51:50 AM Bill C. Ray

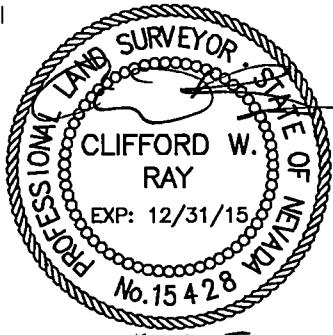
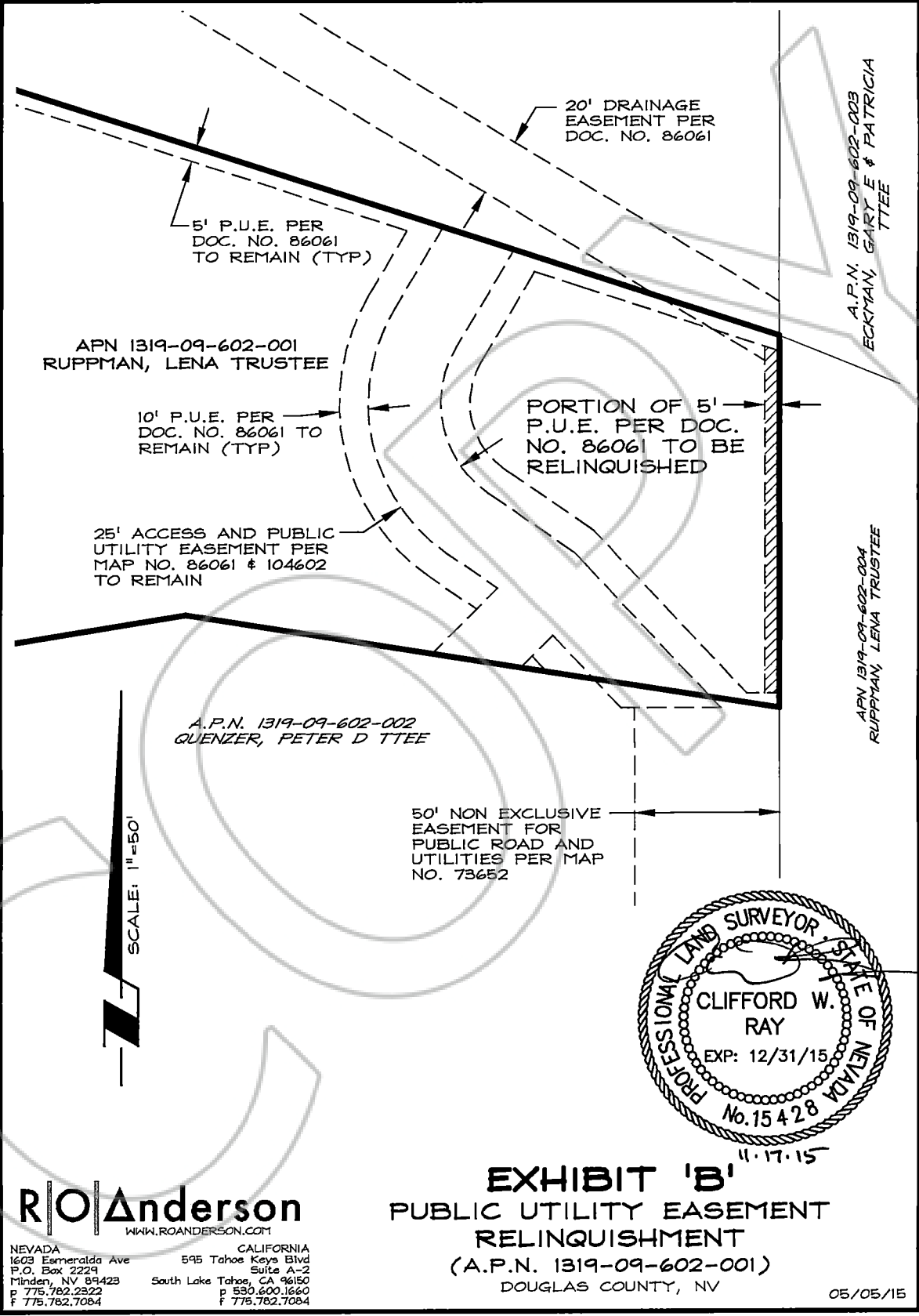

ROAnderson
 WWW.ROANDERSON.COM

NEVADA
 1603 Emeraldale Ave
 P.O. Box 2229
 Minden, NV 89423
 p 775.782.2322
 f 775.782.7084

CALIFORNIA
 595 Tahoe Keys Blvd
 Suite A-2
 South Lake Tahoe, CA 96150
 p 530.600.1660
 f 775.782.7084

EXHIBIT 'B'
PUBLIC UTILITY EASEMENT
RELINQUISHMENT
 (A.P.N. 1319-09-602-001)
 DOUGLAS COUNTY, NV

05/05/15