

EXHIBIT 'A'

**DESCRIPTION
10' PUBLIC UTILITY EASEMENT
(OVER A.P.N. 1319-09-602-001)**

A ten foot (10') wide strip of land for public utility easement purposes located within a portion of Section 9, Township 13 North, Range 19 East, Mount Diablo Meridian, Douglas County, Nevada, said strip of land being comprised of a portion of Parcel 2 per that certain Record of Survey for Robert P. Brush & Juliet Dix Brush, filed for record August 7, 1984 in the office of the Recorder, Douglas County, Nevada in Book 884, at Page 457, as Document No. 104602, said strip of land lying 5 feet on both sides of the following described centerline:

Commencing at the northeast corner of Parcel 1 as shown on said Parcel Map for Robert P. Brush & Juliet Dix Brush;
thence along the northerly line of said Parcel 1, North 72°14'45" West, 70.00 feet;
thence leaving said northerly line, South 00°05'37" East, 5.25 feet to a point on the southerly line of an existing 5' Public Utility Easement, the POINT OF BEGINNING;
thence leaving said southerly line, South 00°05'37" East, 81.05 feet to a point on the northerly line of an existing 10 foot wide Public Utility Easement, the TERMINUS of this description, containing 812 square feet, more or less.

The sidelines of said description shall be extended and shortened to begin and end on said southerly and northerly lines of said existing Public Utility Easements.

The Basis of Bearing of this description is the east line of Parcel 1 as shown on the Parcel Map for Robert P. Brush & Juliet Dix Brush filed for record August 7, 1984 in the office of the Recorder, Douglas County, Nevada in Book 884, at Page 457, as Document No. 104602.

Prepared By: R.O. ANDERSON ENGINEERING, INC.
Clifford W. Ray, P.L.S. 15428
P.O. Box 2229
Minden, Nevada 89423

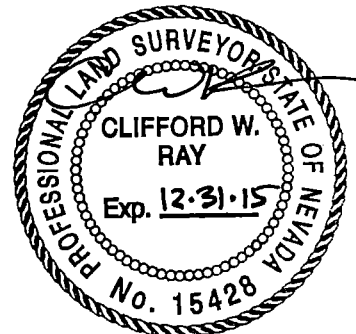

10.19.15

Y:\Client Files\2192\2192-001\CAD\Survey\Exhibits\2192-001 Esmt Dedication.dwg 5/6/2015 8:50:08 AM Bill C. Ray

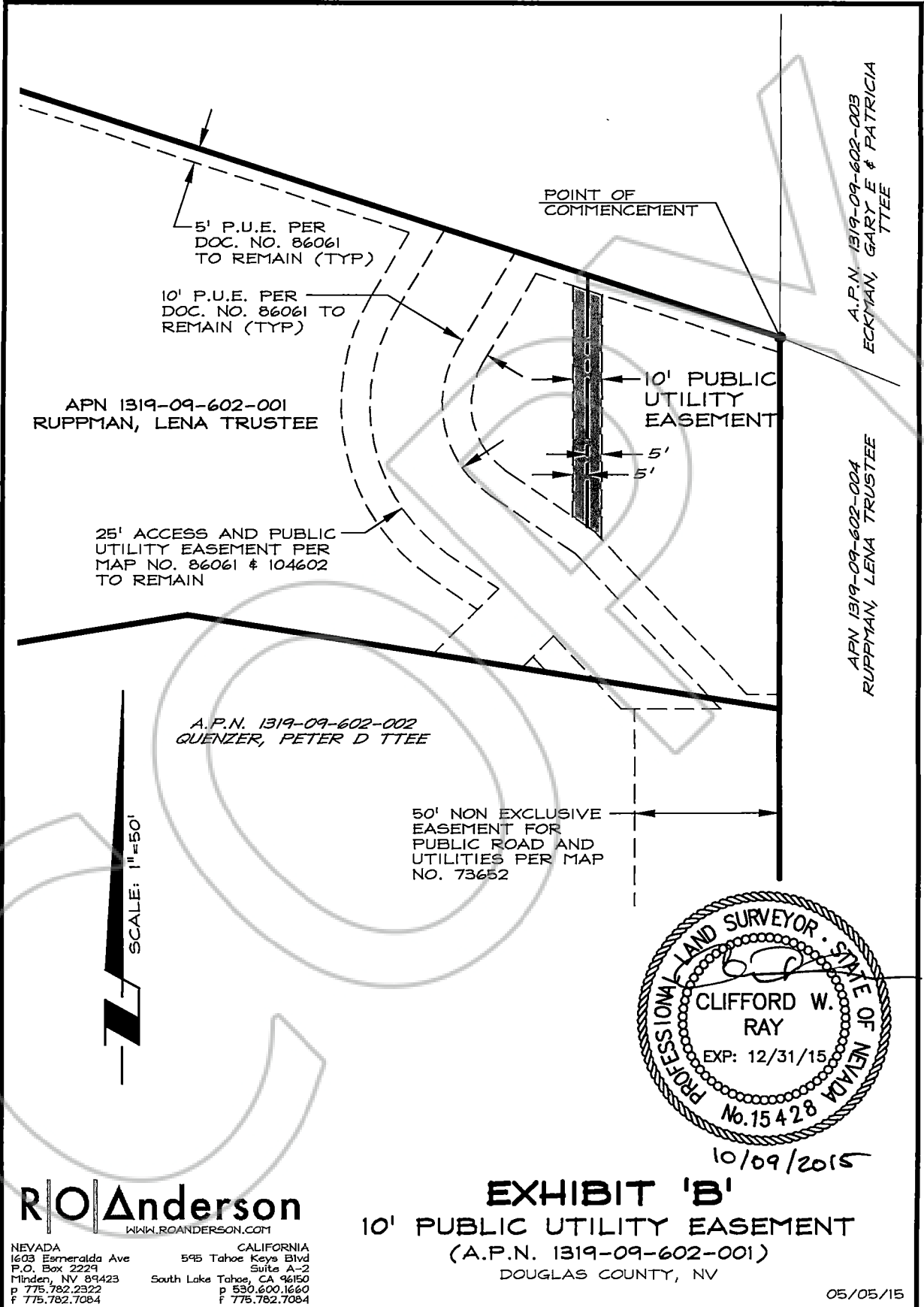

R|O|Anderson
WWW.ROANDERSON.COM

EXHIBIT 'B'
10' PUBLIC UTILITY EASEMENT
(A.P.N. 1319-09-602-001)
DOUGLAS COUNTY, NV

NEVADA	CALIFORNIA
1603 Esmeralda Ave	595 Tahoe Keys Blvd
P.O. Box 2229	Suite A-2
Minden, NV 89423	South Lake Tahoe, CA 96150
p 775.782.2322	p 530.600.1660
f 775.782.7084	f 775.782.7084

05/05/15