

RECORDING REQUESTED BY:

NV Energy



00034211201608799910070075

KAREN ELLISON, RECORDER

WHEN RECORDED RETURN TO:

NV Energy

Land Resources (S4B20)

P.O. Box 10100

Reno, NV 89520

C30- *24974e*
APN 1419-03-000-010

WORK ORDER # 3001375926

Grant of Easement for Electric
Grantor : Clear Creek OS, LLC

This page added to provide additional information required by NRS 111.312 Sections 1-2. (Additional recording fee applies)

The undersigned hereby affirms that the attached document, including any exhibits, hereby submitted for recording does not contain the personal information of any person or persons. (Per NRS 239B.030)

Nathan Hastings
Senior Right of Way Agent

APN(s): 1419-03-000-010

WHEN RECORDED MAIL TO:

Property Services
NV Energy
P.O. Box 10100 MS S4B20
Reno, NV 89520

GRANT OF EASEMENT

Clear Creek OS, LLC, a Delaware limited liability company, (“Grantor”), for One Dollar (\$1.00) and other good and valuable consideration – receipt of which is hereby acknowledged – and on behalf of itself and its successors and assigns, grants and conveys to Sierra Pacific Power Company, a Nevada corporation, d/b/a NV Energy (“Grantee”) and its successors and assigns a perpetual right and easement:

1. to construct, operate, add to, modify, maintain and remove communication facilities and electric line systems for the distribution of electricity underground, consisting of cables, conduit, duct banks, manholes, vaults, and other equipment, fixtures, apparatus, and improvements (“**Underground Utility Facilities**”) upon, over, under and through the property legally described and generally depicted in Exhibit A attached hereto and by this reference made a part of this Grant of Easement (“**Easement Area 1**”);
2. to construct, operate, add to, modify, maintain and remove communication facilities and electric line systems for the distribution of electricity underground, consisting of transformers (aboveground or underground), service boxes/meter panels (aboveground or underground), cabinets (aboveground or underground), bollards (aboveground), and other equipment, fixtures, apparatus, and improvements (“**Additional Utility Facilities**”) upon, over, under and through the property legally described and generally depicted in Exhibit B attached hereto and by this reference made a part of this Grant of Easement (“**Easement Area 2**”);
3. for the unrestricted passage of vehicles and pedestrians within, on, over and across Easement Area 1, Easement Area 2, and the property legally described in Exhibit C attached hereto and by this reference made a part of this Grant of Easement (“**Easement Area 3**”);
4. for the ingress of vehicles and pedestrians to and the egress of vehicles and pedestrians from, the Easement Area 1, Easement Area 2, and Easement Area 3; and
5. to remove, clear, cut or trim any obstruction or material (including trees, other vegetation and structures) from the surface or subsurface of Easement Area 1 and Easement Area 2 as Grantee may deem necessary or advisable for the safe and proper use and maintenance of

NH22970

Proj. # 3001375926

Project Name: E-199 CLEAR CREEK-COML-E-CLEAR CREEK RESIDENTIAL LLC

Reference Document: 825372

GOE_DESIGN

the Underground Utility Facilities in Easement Area 1 or the Additional Utility Facilities in Easement Area 2.

Grantee will be responsible for any damages, proximately caused by Grantee negligently constructing, operating, adding to, maintaining, or removing the Underground Utility Facilities and/or the Additional Utility Facilities, to any tangible, personal property or improvements owned by Grantor and located on Easement Area 1 and/or Easement Area 2 on the date Grantor signs the Grant of Easement. However, this paragraph does not apply to, and Grantee is not responsible for, any damages caused when Grantee exercises its rights under numbered paragraph 5 above.

Grantor covenants for the benefit of Grantee, its successors and assigns, that no building, structure or other real property improvements will be constructed or placed on or within the Easement Area 1 or Easement Area 2 without the prior written consent of Grantee, such structures and improvements to include, but not be limited to, drainage, trees, bridges, signage, roads, fencing, storage facilities, parking canopies, and other covered facilities. Grantee and Grantor must document Grantee's consent by both signing Grantee's standard, recordable use agreement. Grantor retains, for its benefit, the right to maintain, use and otherwise landscape Easement Area 1 and Easement Area 2 for its own purposes; provided, however, that all such purposes and uses do not interfere with Grantee's rights herein and are in all respects consistent with the Grantee's rights herein, Grantee's electrical practices, and the National Electrical Safety Code. Grantee may use this easement to provide service to any of its customers.

To the fullest extent permitted by law, Grantor and Grantee waive any right each may have to a trial by jury in respect of litigation directly or indirectly arising out of, under or in connection with this Grant of Easement. Grantor and Grantee further waive any right to consolidate any action in which a jury trial has been waived with any other action in which a jury trial cannot be or has not been waived.

[signature page follows]

APN(s):1419-03-000-010
NH22970

Proj. # 3001375926

Project Name: E-199 CLEAR CREEK-COML-E-CLEAR CREEK RESIDENTIAL LLC

Reference Document: 825372

GOE_DESIGN

GRANTOR:

CLEAR CREEK OS, LLC

By: James S. Taylor
Title: CEO

STATE OF Nevada)
COUNTY OF Douglas) ss.

This instrument was acknowledged before me on March 11, 2016 by James S. Taylor
CEO of Clear Creek OS, LLC.

M. J. Gyll
Signature of Notarial Officer

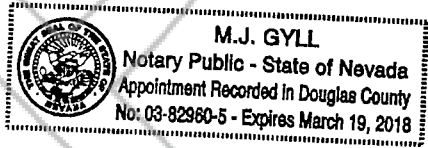

Notary Seal Area →

APN(s):1419-03-000-010
NH22970
Proj. # 3001375926
Project Name: E-199 CLEAR CREEK-COML-E-CLEAR CREEK RESIDENTIAL LLC
Reference Document: 825372
GOE DESIGN

Exhibit A

A portion of Parcel 3 as shown on that certain Record of Survey in Support of a Boundary Line Adjustment for Clear Creek Ranch, L.L.C., filed in the office of the County Recorder of Douglas County, State of Nevada on June 27, 2008, in Book 608, Page 7354, as File NO. 725936 of Official Records.

Notwithstanding the foregoing, with respect to the Underground Utility Facilities, Easement Area 1 shall be reduced to an area ten (10) feet in width, being five (5) feet on each side of the centerline of the Underground Utility Facilities originally installed in connection with **Sierra Pacific Power Company Project ID 3001375926**.

APN(s):1419-03-000-010
NH22970

Proj. # 3001375926

Project Name: E-199 CLEAR CREEK-COML-E-CLEAR CREEK RESIDENTIAL LLC

Reference Document: 825372

GOE DESIGN

Exhibit B

A portion of Parcel 3 as shown on that certain Record of Survey in Support of a Boundary Line Adjustment for Clear Creek Ranch, L.L.C., filed in the office of the County Recorder of Douglas County, State of Nevada on June 27, 2008, in Book 608, Page 7354, as File NO. 725936 of Official Records.

Notwithstanding the foregoing, with respect to the Additional Utility Facilities, Easement Area 2 shall be reduced to an area that includes the Additional Utility Facilities plus three (3) feet in all directions around the perimeter of the Additional Utility Facilities.

APN(s):1419-03-000-010

NH22970

Proj. # 3001375926

Project Name: E-199 CLEAR CREEK-COML-E-CLEAR CREEK RESIDENTIAL LLC

Reference Document: 825372

GOE_DESIGN

Exhibit C

A portion of Parcel 3 as shown on that certain Record of Survey in Support of a Boundary Line Adjustment for Clear Creek Ranch, L.L.C., filed in the office of the County Recorder of Douglas County, State of Nevada on June 27, 2008, in Book 608, Page 7354, as File NO. 725936 of Official Records.

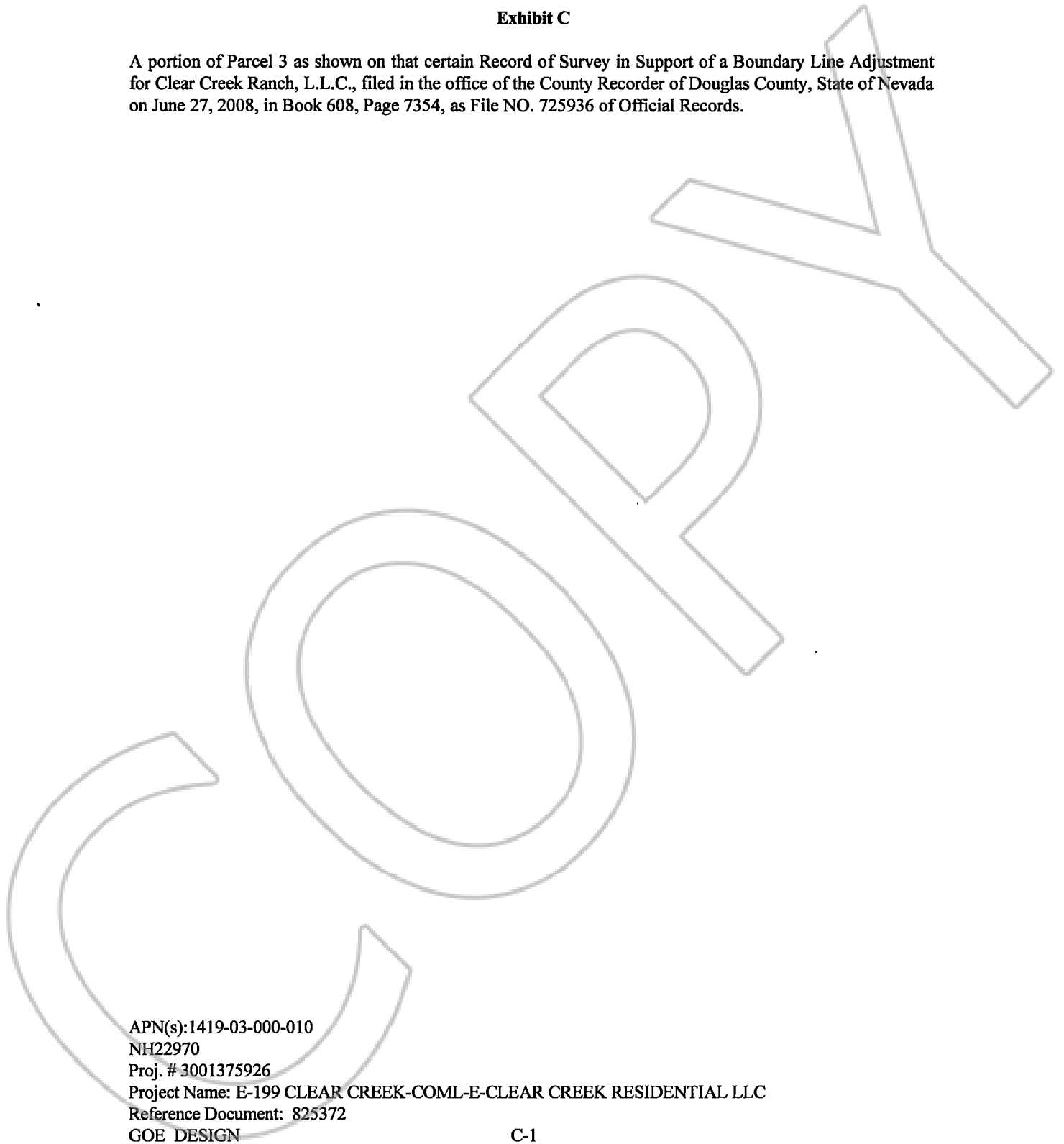

APN(s):1419-03-000-010
NH22970
Proj. # 3001375926
Project Name: E-199 CLEAR CREEK-COML-E-CLEAR CREEK RESIDENTIAL LLC
Reference Document: 825372
GOE_DESIGN