

DOUGLAS COUNTY, NV

2016-880792

Rec:\$15.00

\$15.00

Pgs=2

05/13/2016 12:08 PM

FIRST CENTENNIAL - RENO

KAREN ELLISON, RECORDER

APN: 1318-10-417-036

When Recorded Return to:  
Tahoe Douglas District  
P.O. Box 1160  
Zephyr Cove, NV 89448

SPACE ABOVE FOR RECORDERS USE

RELEASE OF LIEN

KNOW ALL MEN BY THESE PRESENTS:

Notice is hereby given that the Lien claimed by Tahoe Douglas General Improvement District against Lowell Tuttle on the real property situated in the County of Douglas, State of Nevada, described as follows:

See Exhibit A attached hereto and made a part hereof.

Commonly known as: 628 Don Drive, Zephyr Cove, NV 89448

is hereby released, the claim thereunder having been fully paid and satisfied, and that certain Notice of Lien recorded on the 30th day of April, 2012 as document no: 801638 and re-recorded June 15, 2012, as document no: 804092 Douglas County Records, is hereby satisfied and discharged.

Dated this 8th day of April, 2016.

Tahoe Douglas District

BY

Janet Murphy, it's

STATE OF NEVADA  
COUNTY OF DOUGLAS

This instrument was acknowledged before me on 5-12-16

by

Dena Reed  
NOTARY PUBLIC

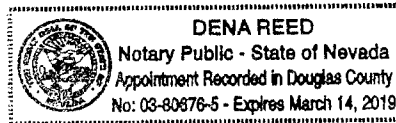

SPACE BELOW FOR RECORDER

Exhibit A

Lot 10, in Block 2, of ZEPHYR HEIGHTS SUBDIVISION, according to the map thereof filed in the Office of the County Recorder of Douglas County, Nevada, on July 5, 1947, in Book 1 of Maps, as Document No. 5160.

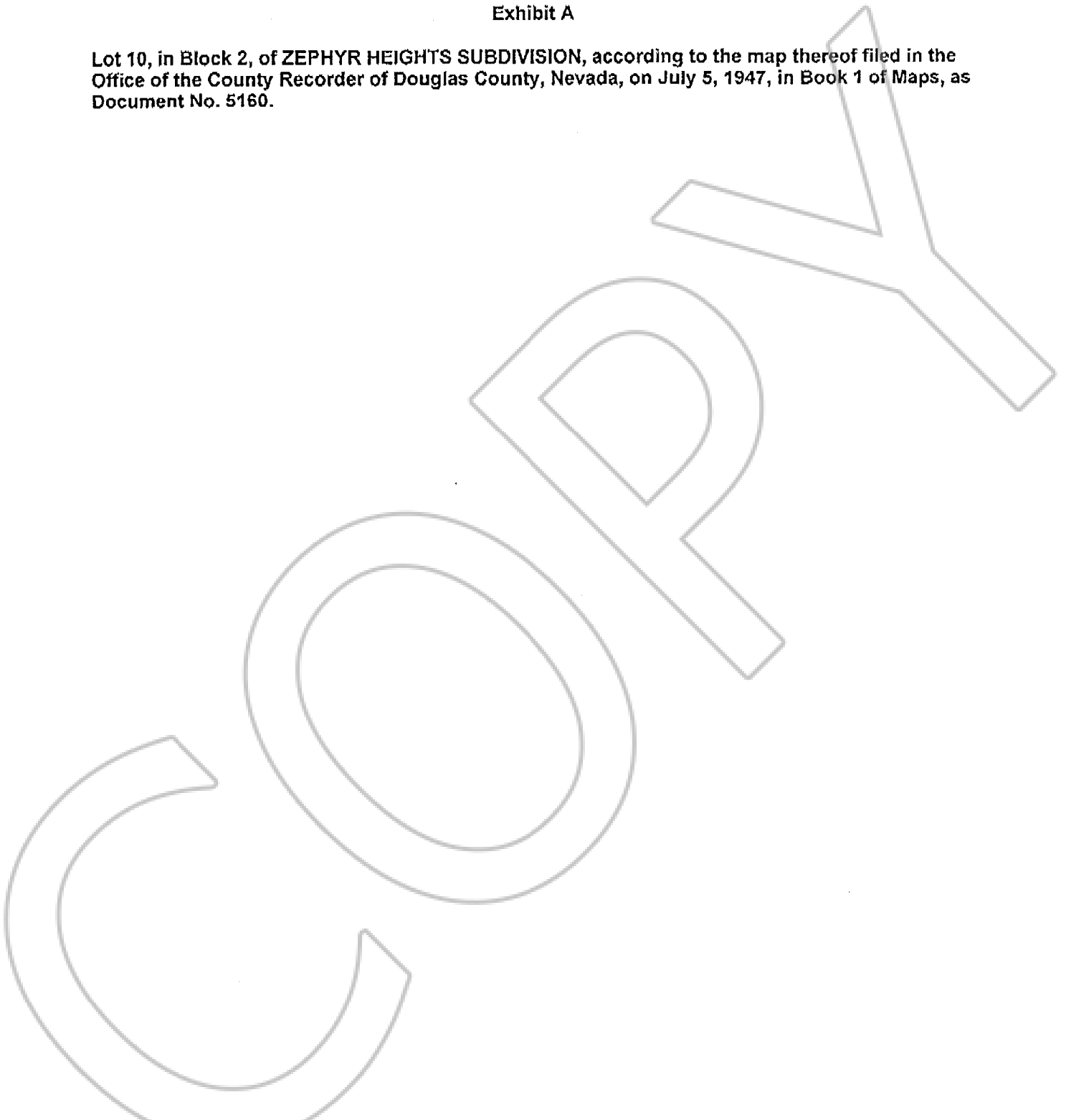

SPACE BELOW FOR RECORDER