

DOUGLAS COUNTY, NV

2016-884984

RPTT:\$1014.00 Rec:\$16.00

\$1,030.00 Pgs=3

07/26/2016 02:44 PM

TICOR TITLE - GARDNERVILLE

KAREN ELLISON, RECORDER

WHEN RECORDED MAIL TO:

John Josphe Meagher
Shelly Meagher
PO Box 10372
Bakersfield, Ca 93389

MAIL TAX STATEMENTS TO:

John Josphe Meagher
same as above

Escrow No. 1603321-RLT

The undersigned hereby affirms that this document submitted for recording does not contain the social security number of any person or persons.
(Pursuant to NRS 239b.030)

APN No.: 1320-30-110-018
R.P.T.T. \$1,014.00

SPACE ABOVE FOR RECORDER'S USE ONLY

GRANT, BARGAIN, SALE DEED

THIS INDENTURE WITNESSETH: That Norman Gray Williams, An Unmarried Man

FOR A VALUABLE CONSIDERATION, receipt of which is hereby acknowledged, do does hereby Grant, Bargain, Sell and Convey to John Josphe Meagher and Shelly Elen Meagher, **Husband and Wife, as joint tenants**

all that real property situated in the County of Douglas, State of Nevada, described as follows:

SEE EXHIBIT "A" ATTACHED HERETO AND BY REFERENCE MADE A PART HEREOF

Together with all and singular the tenements, hereditaments and appurtenances thereunto belonging or in anywise appertaining.

Norman Gray Williams
Norman Gray Williams

AK California
STATE OF ~~NEVADA~~
COUNTY OF ~~DOUGLAS~~ San Diego
R.K.

} ss:

This instrument was acknowledged before me on, 7/23/2016

by Norman Gray Williams

Ramona Khyrolomoor
NOTARY PUBLIC

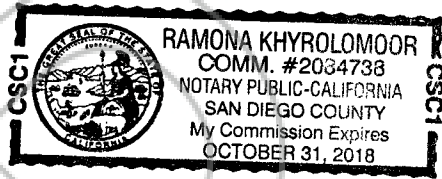

Escrow No. 1603321-RLT

**EXHIBIT A
LEGAL DESCRIPTION**

All that certain real property situate in the County of Douglas, State of Nevada, described as follows:

PARCEL 1:

Lot 24, in Block B, as set forth on the Final Map of WESTWOOD PARK UNIT NO. IV PHASE B, filed for record in the Office of the County Recorder of Douglas County, State of Nevada, on June 1, 1994, in Book 694, Page 27, as Document No. 338620.

PARCEL 2:

Together with an undivided 1/21st interest in and to the common area lying within the interior lines as set forth on Final Map of WESTWOOD PARK UNIT NO. IV PHASE B, filed for record in the Office of the County Recorder of Douglas County, State of Nevada, on June 1, 1994, in Book 694, Page 27, as Document No. 338620.

APN: 1320-30-110-018

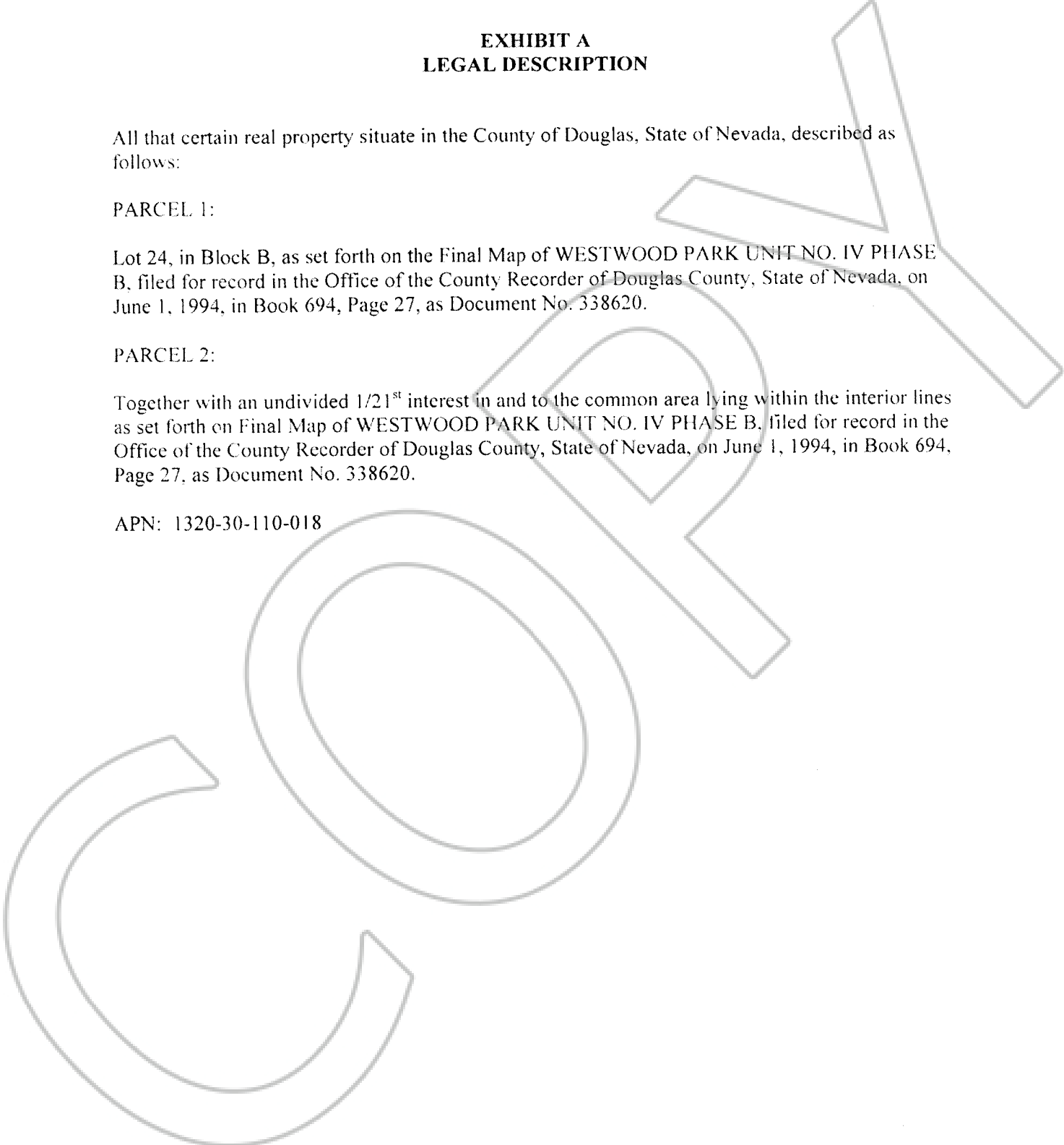

STATE OF NEVADA-DECLARATION OF VALUE FORM

1. **Assessor Parcel Number(s)**
 a) 1320-30-110-018
 b) _____
 c) _____
 d) _____

2. **Type of Property:**
 a) Vacant Land b) Single Fam. Res.
 c) Condo/Twnhse d) 2-4 Plex
 e) Apt. Bldg f) Comm'l/Ind'l
 g) Agricultural h) Mobile Home
 i) Other _____

FOR RECORDERS OPTIONAL USE ONLY	
Book _____	Page _____
Date of Recording: _____	
Notes: _____	

3. **Total Value/Sales Price of Property:** \$260,000.00
 Deed in Lieu of Foreclosure Only (value of property) \$ _____
 Transfer Tax Value \$260,000.00
 Real Property Transfer Tax Due: \$1,014.00

4. **If Exemption Claimed**
 a. Transfer Tax Exemption, per NRS 375.090, Section _____
 b. Explain Reason for Exemption: _____

5. Partial Interest: Percentage being transferred: _____ %

The undersigned declares and acknowledges, under penalty of perjury, pursuant to NRS 375.060 and NRS 375.110, that the information provided is correct to the best of their information and belief, and can be supported by documentation if called upon to substantiate the information provided herein. Furthermore, the parties agree that disallowance of any claimed exemption, or other determination of additional tax due, may result in a penalty of 10% of the tax due plus interest at 1% per month. Pursuant to NRS 375.030, the Buyer and Seller shall be jointly and severally liable for any additional amount owed.

Signature _____ Capacity GRANTOR
 Signature _____ Capacity _____

SELLER (GRANTOR) INFORMATION

BUYER (GRANTEE) INFORMATION

(REQUIRED)
 Print Name: Norman Gray Williams
 Address: 1785 Mahogany Circle
Minden, NV 89423
 City, State, Zip

(REQUIRED)
 Print Name: John Joseph Meagher *Sally Elen Meagher*
 Address: PO Box 10372
Bakersfield, CA 93389
 City, State Zip

COMPANY/PERSON REQUESTING RECORDING (Required if not the Seller or Buyer)

Print Name: Ticor Title of Nevada, Inc. Escrow #: 1603321-RLT
 Address: 1483 Highway 395 N, Suite B
 City, State, Zip: Gardnerville, NV 89410