

DOUGLAS COUNTY, NV

2016-887182

RPTT:\$1716.00 Rec:\$16.00

\$1,732.00 Pgs=3

09/06/2016 12:14 PM

TICOR TITLE - GARDNERVILLE

KAREN ELLISON, RECORDER

WHEN RECORDED MAIL TO:

Jerry Barbee
Karen Barbee
1378 Ballard Ct
Minden, NV 89423

MAIL TAX STATEMENTS TO:

Same as above

Escrow No. 1604374-RLT

The undersigned hereby affirms that this document submitted for recording does not contain the social security number of any person or persons.
(Pursuant to NRS 239b.030)

APN No.: 1420-33-710-007

R.P.T.T. \$1,716.00

SPACE ABOVE FOR RECORDER'S USE ONLY

GRANT, BARGAIN, SALE DEED

THIS INDENTURE WITNESSETH: That Linde G. Kester, Trustee or his successors in trust under the Linde Gene Kester Living Trust, dated November 15, 2013

FOR A VALUABLE CONSIDERATION, receipt of which is hereby acknowledged, do/does hereby Grant, Bargain, Sell and Convey to Jerry Barbee and Karen Barbee, husband and wife as joint tenants with right of survivorship

all that real property situated in the County of Douglas, State of Nevada, described as follows:

SEE EXHIBIT "A" ATTACHED HERETO AND BY REFERENCE MADE A PART HEREOF

Together with all and singular the tenements, hereditaments and appurtenances thereunto belonging or in anywise appertaining.

Linde G. Kester, Trustee or his successors in
trust under the Linde Gene Kester Living Trust,
dated November 15, 2013

Linde G. Kester, TRUSTEE
Linde G. Kester, Trustee

STATE OF NEVADA
COUNTY OF DOUGLAS

} ss:
9/11/16

This instrument was acknowledged before me on ,
by Linde G. Kester

[Signature]
NOTARY PUBLIC

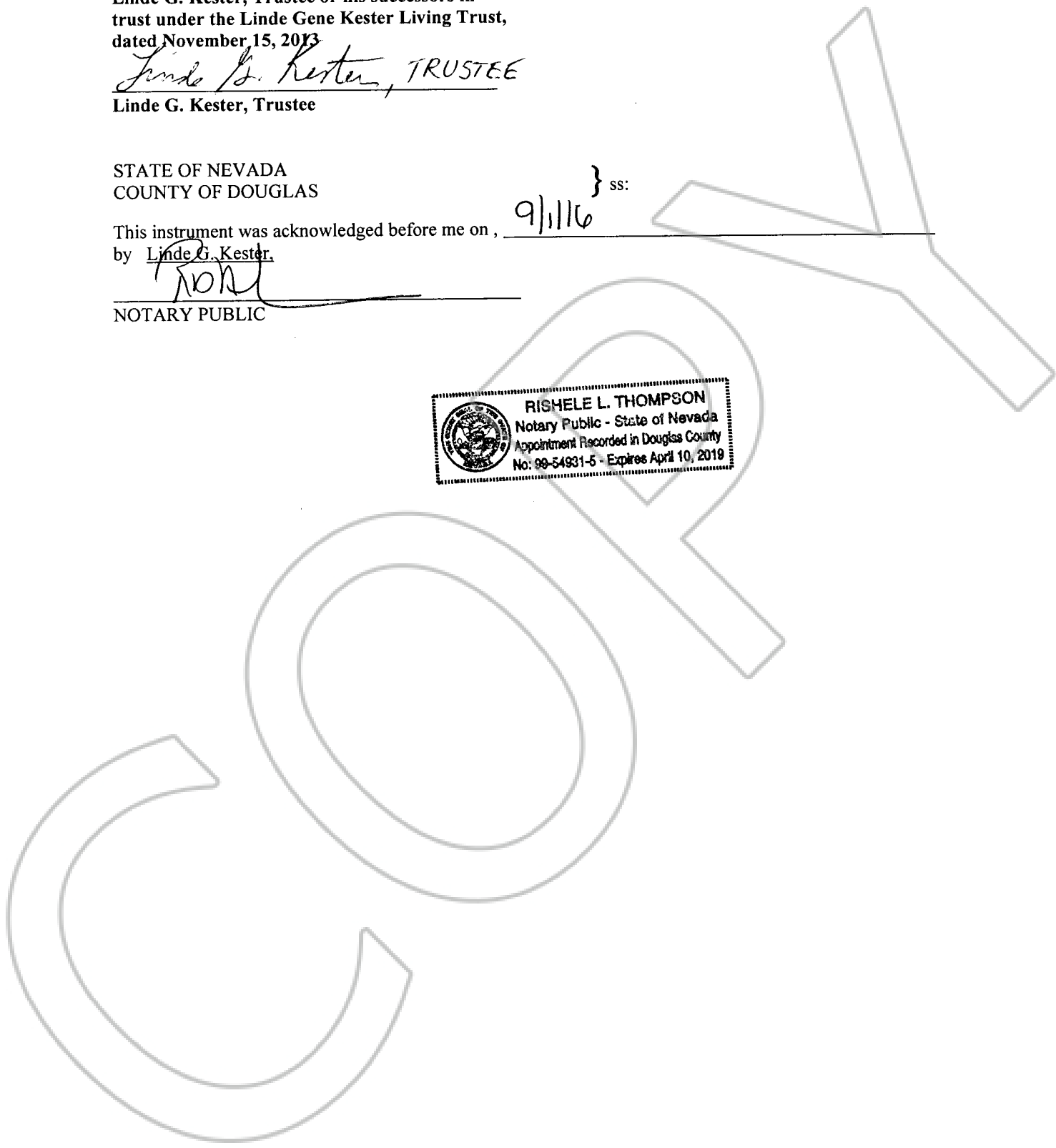

Escrow No. 1604374-RLT

**EXHIBIT A
LEGAL DESCRIPTION**

All that certain real property situate in the County of Douglas, State of Nevada, described as follows:

Lot 7, Block A, as set forth on the Final Map of ANDERSON VILLAGE filed for record in the office of the County Recorder of Douglas County, Nevada, on August 31, 1989 in Book 889 of Official Records at Page 4542 as Document No. 209869.

APN: 1420-33-710-007

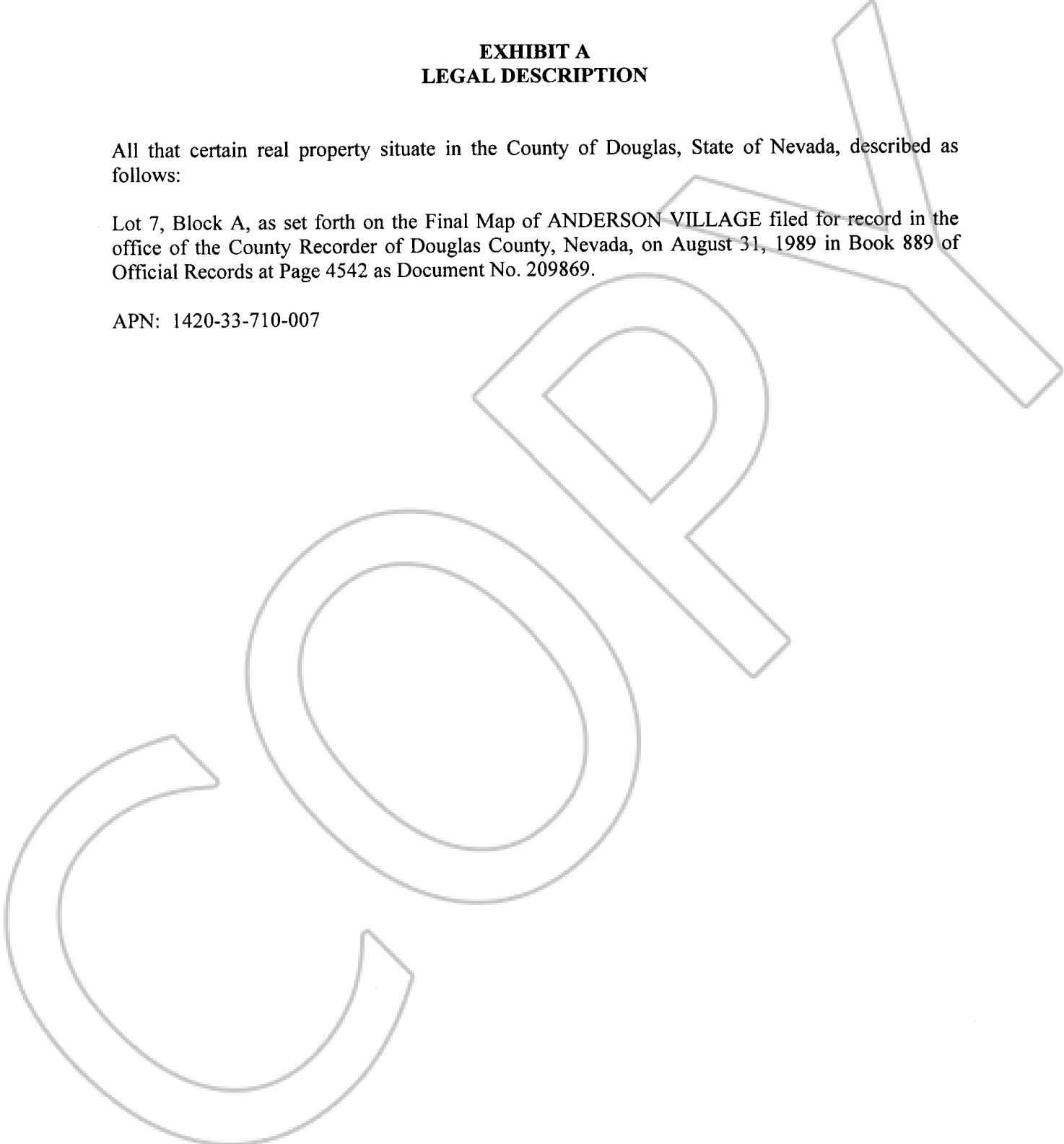

STATE OF NEVADA-DECLARATION OF VALUE FORM

1. Assessor Parcel Number(s)

- a) 1420-33-710-007
- b) _____
- c) _____
- d) _____

2. Type of Property:

- a) Vacant Land
- b) Single Fam. Res.
- c) Condo/Twnhse
- d) 2-4 Plex
- e) Apt. Bldg
- f) Comm'l/Ind'l
- g) Agricultural
- h) Mobile Home
- i) Other _____

FOR RECORDERS OPTIONAL USE ONLY

Book _____ Page _____
 Date of Recording: _____
 Notes: _____

3. Total Value/Sales Price of Property:

Deed in Lieu of Foreclosure Only (value of property) \$440,000.00
 Transfer Tax Value \$
 Real Property Transfer Tax Due: \$440,000.00
\$1,716.00

4. If Exemption Claimed

- a. Transfer Tax Exemption, per NRS 375.090, Section _____
- b. Explain Reason for Exemption: _____

5. Partial Interest: Percentage being transferred: _____ %

The undersigned declares and acknowledges, under penalty of perjury, pursuant to NRS 375.060 and NRS 375.110, that the information provided is correct to the best of their information and belief, and can be supported by documentation if called upon to substantiate the information provided herein. Furthermore, the parties agree that disallowance of any claimed exemption, or other determination of additional tax due, may result in a penalty of 10% of the tax due plus interest at 1% per month. Pursuant to NRS 375.030, the Buyer and Seller shall be jointly and severally liable for any additional amount owed.

Signature Linde G. Kester, TRUSTEE Capacity GRANTOR

Signature _____ Capacity _____

SELLER (GRANTOR) INFORMATION

BUYER (GRANTEE) INFORMATION

(REQUIRED)

(REQUIRED)

Print Name: Linde G. Kester, Trustee or his successors in trust under the Linde Gene Kester Living Trust, dated November 15, 2013

Print Name: Jerry Barbee / Karen Barbee

Address: PO BOX 47
Lorane, OR 97451

Address: 1378 Ballard Ct
Minden, NV 89423

City, State, Zip

City, State Zip

COMPANY/PERSON REQUESTING RECORDING (Required if not the Seller or Buyer)

Print Name: Ticor Title of Nevada, Inc. Escrow #: 1604374-RLT

Address: 1483 Highway 395 N, Suite B
 City, State, Zip: Gardnerville, NV 89410