

DOUGLAS COUNTY, NV
RPTT:\$1384.50 Rec:\$16.00
\$1,400.50 Pgs=3
TICOR TITLE - GARDNERVILLE
KAREN ELLISON, RECORDER

2016-887746

09/19/2016 02:04 PM

WHEN RECORDED MAIL TO:
Wilburn Johnson
Patricia Johnson
1289 Downs Drive
Minden, NV 89423

MAIL TAX STATEMENTS TO:
Wilburn Johnson
same as above

Escrow No. 1603965-RLT

The undersigned hereby affirms that this document
submitted for recording does not contain the social
security number of any person or persons.
(Pursuant to NRS 239b.030)

APN No.: 1420-33-311-010
R.P.T.T. \$ 1,384.50

SPACE ABOVE FOR RECORDER'S USE ONLY

GRANT, BARGAIN, SALE DEED

THIS INDENTURE WITNESSETH: That Harold E. Sanford and Susan F. Sanford, Trustees or their successors in Trust, under the Sanford Living Trust dated May 8, 1998

FOR A VALUABLE CONSIDERATION, receipt of which is hereby acknowledged, do/does hereby Grant, Bargain, Sell and Convey to Wilburn Johnson and Patricia Johnson , Husband and Wife, as joint tenants

all that real property situated in the County of Douglas, State of Nevada, described as follows:

SEE EXHIBIT "A" ATTACHED HERETO AND BY REFERENCE MADE A PART HEREOF

Together with all and singular the tenements, hereditaments and appurtenances thereunto belonging or in anywise appertaining.

Harold E. Sanford and Susan F. Sanford,
Trustees or their successors in Trust, under the
Sanford Living Trust dated May 8, 1998

Harold E. Sanford
Harold E. Sanford, Trustee

Susan F. Sanford
Susan F. Sanford, Trustee

STATE OF NEVADA
COUNTY OF DOUGLAS

} ss:

This instrument was acknowledged before me on , 8/30/10
by Harold E. Sanford and Susan F. Sanford,

R. Thompson
NOTARY PUBLIC



Escrow No. 1603965-RLT

**EXHIBIT A
LEGAL DESCRIPTION**

All that certain real property situate in the County of Douglas, State of Nevada, described as follows:

Lot 2, in Block E, of the Final Map of WILDHORSE, UNIT 1, according to the official map thereof, filed in the office of the County Recorder of Douglas County, Nevada, on August 3, 1989, in Book 889, Page 450, as Document No. 207982.

APN: 1420-33-311-010

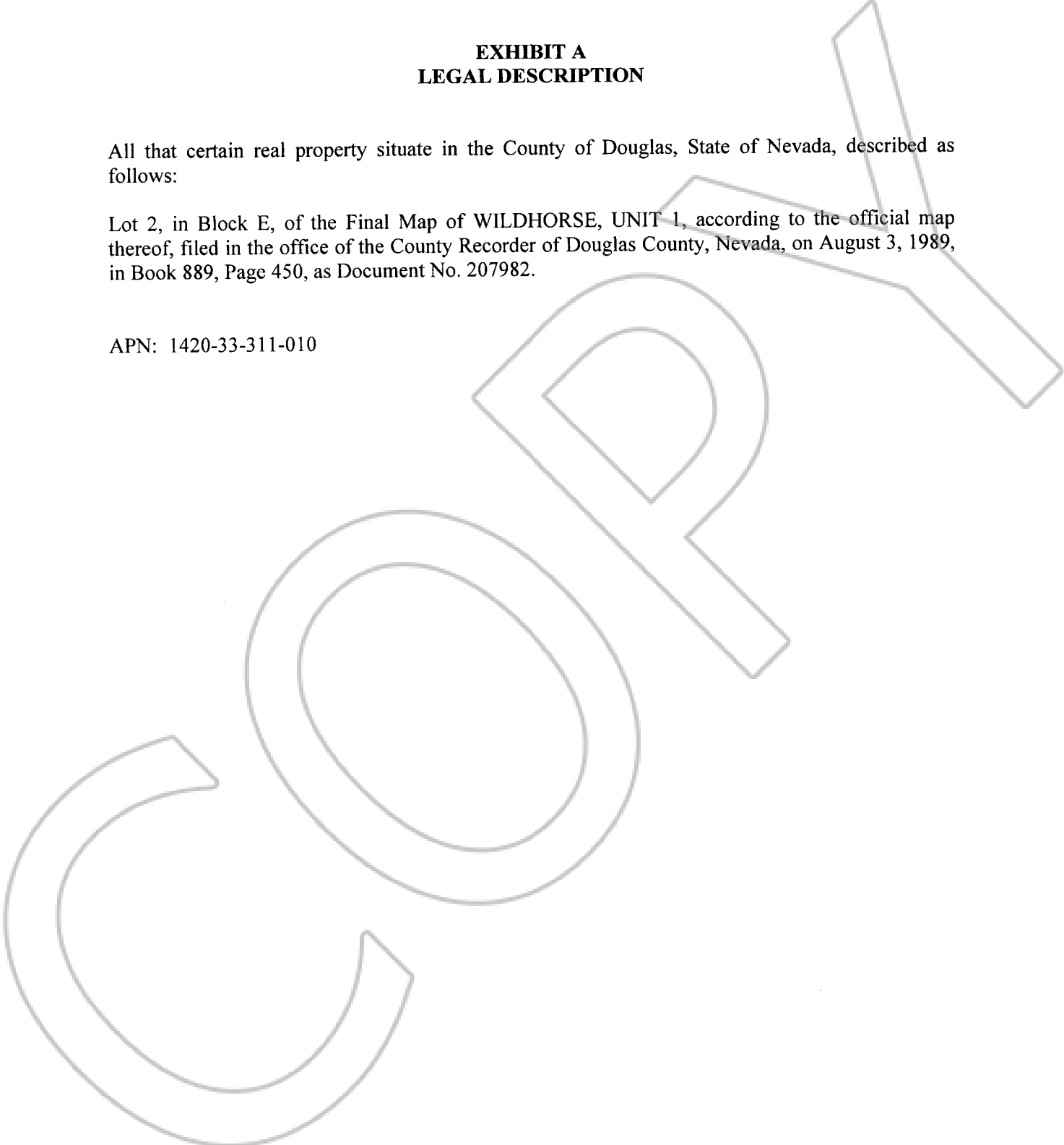

STATE OF NEVADA-DECLARATION OF VALUE FORM

1. Assessor Parcel Number(s)

- a) 1420-33-311-010 _____
- b) _____
- c) _____
- d) _____

2. Type of Property:

- a) Vacant Land b) Single Fam. Res.
- c) Condo/Twnhse d) 2-4 Plex
- e) Apt. Bldg f) Comm'l/Ind'l
- g) Agricultural h) Mobile Home
- i) Other _____

FOR RECORDERS OPTIONAL USE ONLY
 Book _____ Page _____
 Date of Recording: _____
 Notes: _____

3. Total Value/Sales Price of Property:

Deed in Lieu of Foreclosure Only (value of property) \$354,900.00
 Transfer Tax Value \$
 Real Property Transfer Tax Due: \$354,900.00
\$1,384.50

4. If Exemption Claimed

- a. Transfer Tax Exemption, per NRS 375.090, Section _____
- b. Explain Reason for Exemption: _____

5. Partial Interest: Percentage being transferred: _____ %

The undersigned declares and acknowledges, under penalty of perjury, pursuant to NRS 375.060 and NRS 375.110, that the information provided is correct to the best of their information and belief, and can be supported by documentation if called upon to substantiate the information provided herein. Furthermore, the parties agree that disallowance of any claimed exemption, or other determination of additional tax due, may result in a penalty of 10% of the tax due plus interest at 1% per month. Pursuant to NRS 375.030, the Buyer and Seller shall be jointly and severally liable for any additional amount owed.

Signature Harold E. Sanford, Trustee Capacity grantor
 Signature Susan F. Sanford, Trustee Capacity grantor

SELLER (GRANTOR) INFORMATION

BUYER (GRANTEE) INFORMATION

(REQUIRED)

(REQUIRED)

Print Name: Harold E. Sanford and Susan F. Sanford, Trustees or their successors in Trust, under the Sanford Living Trust dated May 8, 1998

Print Name: Wilburn Johnson/ Patricia Johnson

Address: 865 LARAMORE TRAIL
RENO NV 89523

Address: 1289 Downs Drive
Minden NV 89423

City, State, Zip

City, State Zip

COMPANY/PERSON REQUESTING RECORDING (Required if not the Seller or Buyer)

Print Name: Ticor Title of Nevada, Inc. Escrow #: 1603965-RLT
 Address: 1483 Highway 395 N, Suite B
 City, State, Zip: Gardnerville, NV 89410