

SURVEYOR'S CERTIFICATE

I, GREGORY S. PHILLIPS, A PROFESSIONAL LAND SURVEYOR LICENSED IN THE STATE OF NEVADA, AS AGENT FOR LUMOS AND ASSOCIATES, CERTIFY THAT:

- 1) THIS PLAT REPRESENTS THE RESULTS OF A SURVEY CONDUCTED UNDER MY DIRECT SUPERVISION AT THE INSTANCE OF THE TAHOE TRANSPORTATION DISTRICT.
- 2) THE LAND SURVEYED LIES WITHIN A PORTION OF THE SOUTH 1/2 OF SECTION 22, T.13 N., R.18 E., M.D.M., DOUGLAS COUNTY, NEVADA AND THE SURVEY WAS COMPLETED ON DECEMBER 23, 2016.
- 3) THIS PLAT COMPLIES WITH APPLICABLE STATUTES OF THIS STATE AND ANY LOCAL ORDINANCES IN EFFECT ON THE DATE THAT THE SURVEY WAS COMPLETED AND THE SURVEY WAS CONDUCTED IN ACCORDANCE WITH CHAPTER 625 OF THE NEVADA ADMINISTRATIVE CODE.
- 4) THE MONUMENTS DEPICTED ON THIS PLAT ARE OF THE CHARACTER SHOWN, OCCUPY THE POSITIONS INDICATED, AND ARE OF SUFFICIENT NUMBER AND DURABILITY.
- 5) THIS MAP IS NOT IN CONFLICT WITH THE PROVISIONS OF NRS 278.010 TO 278.630 INCLUSIVE. NO NEW PARCELS HAVE BEEN CREATED.

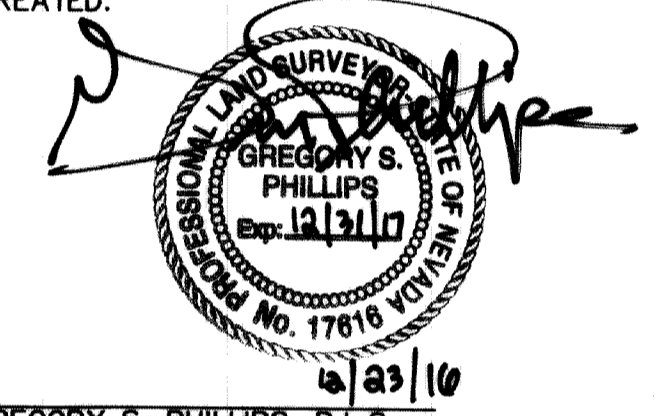

GREGORY S. PHILLIPS, P.L.S.
NEVADA CERTIFICATE No. 17616

BASIS OF BEARING

THE BASIS OF BEARING FOR THIS SURVEY IS IDENTICAL TO THAT OF OLIVER PARK, FILED FOR RECORD ON FEBRUARY 2, 1959, IN BOOK 1 AT PAGE 138, AS DOCUMENT NO. 14034, OFFICIAL RECORDS OF THE COUNTY OF DOUGLAS, STATE OF NEVADA.

REFERENCE DOCUMENTS

(R1) OLIVER PARK, FILED FOR RECORD ON FEBRUARY 2, 1959, IN BOOK 1 AT PAGE 138, AS DOCUMENT NO. 14034. OFFICIAL RECORDS OF THE COUNTY OF DOUGLAS, STATE OF NEVADA.

RECORDER'S CERTIFICATE

FILED FOR RECORD AT THE REQUEST OF LUMOS AND ASSOCIATES, ON THIS 10th DAY OF JANUARY, 2017 AT 27 MINUTES PAST 4 O'CLOCK P.M. IN BOOK N/A AT PAGE N/A OF OFFICIAL RECORDS OF DOUGLAS COUNTY, NEVADA.
RECORDING FEE: 21.00 BY: John D. Small RECORDER DEPUTY
FILE NUMBER: 2017-893214 BY: _____

- LEGEND**
- FOUND 2" IRON PIPE WITH BRASS PLUG OR AS NOTED
 - ⊙ SET 2" ALUMINUM CAP "PLS 17616" IN MONUMENT WELL
 - R&C REBAR AND CAP
 - IP IRON PIPE

RECORD OF SURVEY
FOR
THE TAHOE TRANSPORTATION DISTRICT
WITHIN THE SOUTH 1/2 OF SECTION 22
TOWNSHIP 13 NORTH, RANGE 18 EAST, M.D.M.
DOUGLAS COUNTY NEVADA

LUMOS & ASSOCIATES
800 E. COLLEGE PARKWAY
CARSON CITY, NV 89706
TEL (775) 883-7077
FAX (775) 883-7114

Drawn By: GSP
Date: 12-23-16
Job No.: 7649.012
Dwg No.: 7649012 ROS.DWG