



00049621201708936670030037

KAREN ELLISON, RECORDER

After Recordation Return to:
Manhard Consulting
Attn. James Bedard
9850 Double R Boulevard, Suite 100
Reno, Nevada 89521

CERTIFICATE OF AMENDMENT

December 27, 2016

Mr. Greg Phillips, P.L.S.
Douglas County Surveyor.
800 East College Pkwy
Carson City, NV 89706

Re: Final Map PD 03-004-7 for Clear Creek Tahoe – Phase 1A & 1B, recorded November 18, 2016 as File No. 2016-890939, Official Records of Douglas County, Nevada, situate in Sections 3, 4, 9, and 10, Township 14 North, Range 19 East, Mount Diablo Base and Meridian.

Dear Mr. Phillips:

In accordance with NRS 278.473, I am notifying you of the following omissions and corrections to the above referenced map.

1. The lot numbers for Lot 244 and Lot 245 are shown correctly on Sheet 2 of 18, but are transposed on Sheet 16 of 18. The correct lot numbers are sequential in a counter-clockwise direction around Cartwright Court.
2. The curve data for four (4) curves was omitted on Cartwright Court, shown on Sheet 16 of 18. The missing data is shown on Exhibit A, attached.
3. A dimension on the northerly line of Parcel B shown on Sheet 8 of 18 is shown incorrectly as South 82°59'40" East, 523.73 feet. The correct dimension is South 89°59'40" East, 591.93 feet, to match that Record of Survey in Support of a

Boundary Line Adjustment recorded June 27, 2008 as Document No. 725936 in Book 0608, Page 7354, Official Records of Douglas County, Nevada.

4. A dimension on the westerly line of Lot 179, west of the line labelled North 79°58'47" West, 201.95 feet, on Sheet 14 of 18, was omitted. The omitted dimension is North 12°56'46" East, 29.91 feet.

The corrections of these errors and omissions do not change or purport to change the physical location of any monument, property line or boundary line.

Respectfully Submitted,

James R. Bedard
Nevada PLS 17044
For and on behalf of



9850 DOUBLE R BLVD, SUITE 101
RENO, NEVADA 89521
(775) 743-3500

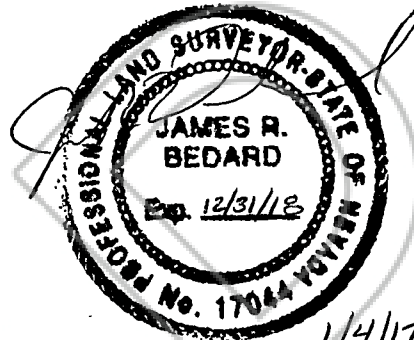

Douglas County Surveyor's statement:

I hereby certify that I have examined the certificate of amendment and that the changes to the original document specified therein are provided for in applicable sections of NRS 278.010 to 278.630 inclusive, 625.340 to 625.380 inclusive, and local ordinances adopted pursuant thereto, and I am satisfied that this certificate of amendment so amends or corrects the document as to make it technically correct.

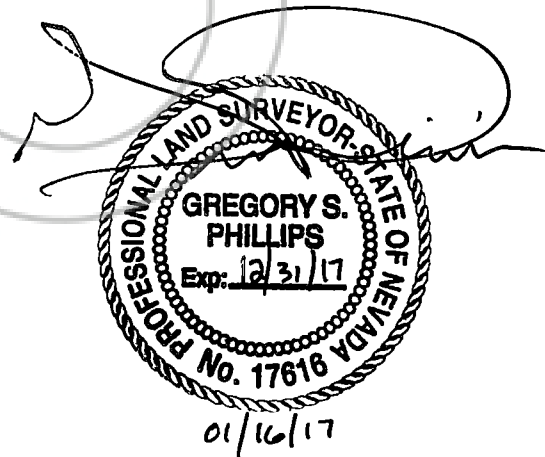

Greg Phillips, P.L.S.
Douglas County Surveyor

1"=60'



LOT 245
112,714 S.F.
2.59 AC.±

LOT 244
164,473 S.F.
3.78 AC.±

LOT 246

CARTWRIGHT CT.

LOT 247

SGSDE

DE

$\Delta = 59^{\circ}17'42''$
R=25.00'
L=25.87'

$\Delta = 23^{\circ}42'43''$
R=227.50'
L=94.15'

$N67^{\circ}19'03''W$
38.08'

$\Delta = 30^{\circ}50'03''$
R=250.00'
L=134.54'

$\Delta = 49^{\circ}25'59''$
R=25.00'
L=21.57'

$\Delta = 25^{\circ}35'25''$
R=272.50'
L=121.71'

 **Manhard**
CONSULTING LTD

9850 Double R Blvd, Suite 101, Reno, NV 89521
tel: (775) 746-3500 fax: (775) 746-3520 www.manhard.com

CLEAR CREEK TAHOE PH. 1A & 1B

DOUGLAS COUNTY, NEVADA

CERTIFICATE OF AMENDMENT

PROJ. MGR.: AM
DRAWN BY: JRB
DATE: DEC. 2016
SCALE: 1"=60'

SHEET
EXHIBIT A
CCPDCN 130470

Dwg Name: \\mc-re-nos\Projects-RE\CCpdcn\dwg\Surv\Final Drawings\Plot of Subdivision\CCPDCN Unit 1.dwg Updated By: JIFower 12:22