

DOUGLAS COUNTY, NV

2017-898567

RPTT:\$0.00 Rec:\$15.00

\$15.00 Pgs=2

05/12/2017 01:07 PM

TICOR TITLE - GARDNERVILLE

KAREN ELLISON, RECORDER

E07

WHEN RECORDED MAIL TO:

Carol Ann Drew
1434 Roselli Drive
Livermore, Ca 94550

MAIL TAX STATEMENTS TO:

Same as above

Escrow No. 1701415-RLT

The undersigned hereby affirms that this document submitted for recording does not contain the social security number of any person or persons. (Pursuant to NRS 239b.030)

This document is recorded as an ACCOMMODATION ONLY and without liability for the consideration therefor, or as to the validity or sufficiency of said instrument, or for the effect of such recording on the title of the property involved.

APN No.: 1420-34-610-025

R.P.T.T. \$2,203.50

SPACE ABOVE FOR RECORDER'S USE ONLY

GRANT, BARGAIN, SALE DEED

THIS INDENTURE WITNESSETH: That Jay Harrison Drew and Carol Ann Drew, Husband and Wife, as joint tenants

FOR A VALUABLE CONSIDERATION, receipt of which is hereby acknowledged, do/does hereby Grant, Bargain, Sell and Convey to Jay H Drew and Carol A Drew, Trustees, or their successors in trust, under he Drew Family Living Trust, dated April 6, 1999, and any amendments thereto

all that real property situated in the County of Douglas, State of Nevada, described as follows:

SEE EXHIBIT "A" ATTACHED HERETO AND BY REFERENCE MADE A PART HEREOF

Together with all and singular the tenements, hereditaments and appurtenances thereunto belonging or in anywise appertaining.

Jay Harrison Drew

Carol Ann Drew

STATE OF NEVADA
COUNTY OF DOUGLAS

} ss:

This instrument was acknowledged before me on, 5.12.17
by Jay Harrison Drew and Carol Ann Drew.

NOTARY PUBLIC

Escrow No. 1701415-RLT

**EXHIBIT A
LEGAL DESCRIPTION**

All that certain real property situate in the County of Douglas, State of Nevada, described as follows:

Lot 58, in Block 2, as set forth on the Final Subdivision Map LDA# 01-069 for BRAMWELL HOMESTEAD, filed for record in the office of the Douglas County Recorder on August 12, 2002, in Book 0802, at Page 3324, as Document No. 0549307, of Official Records.

APN: 1420-34-610-025

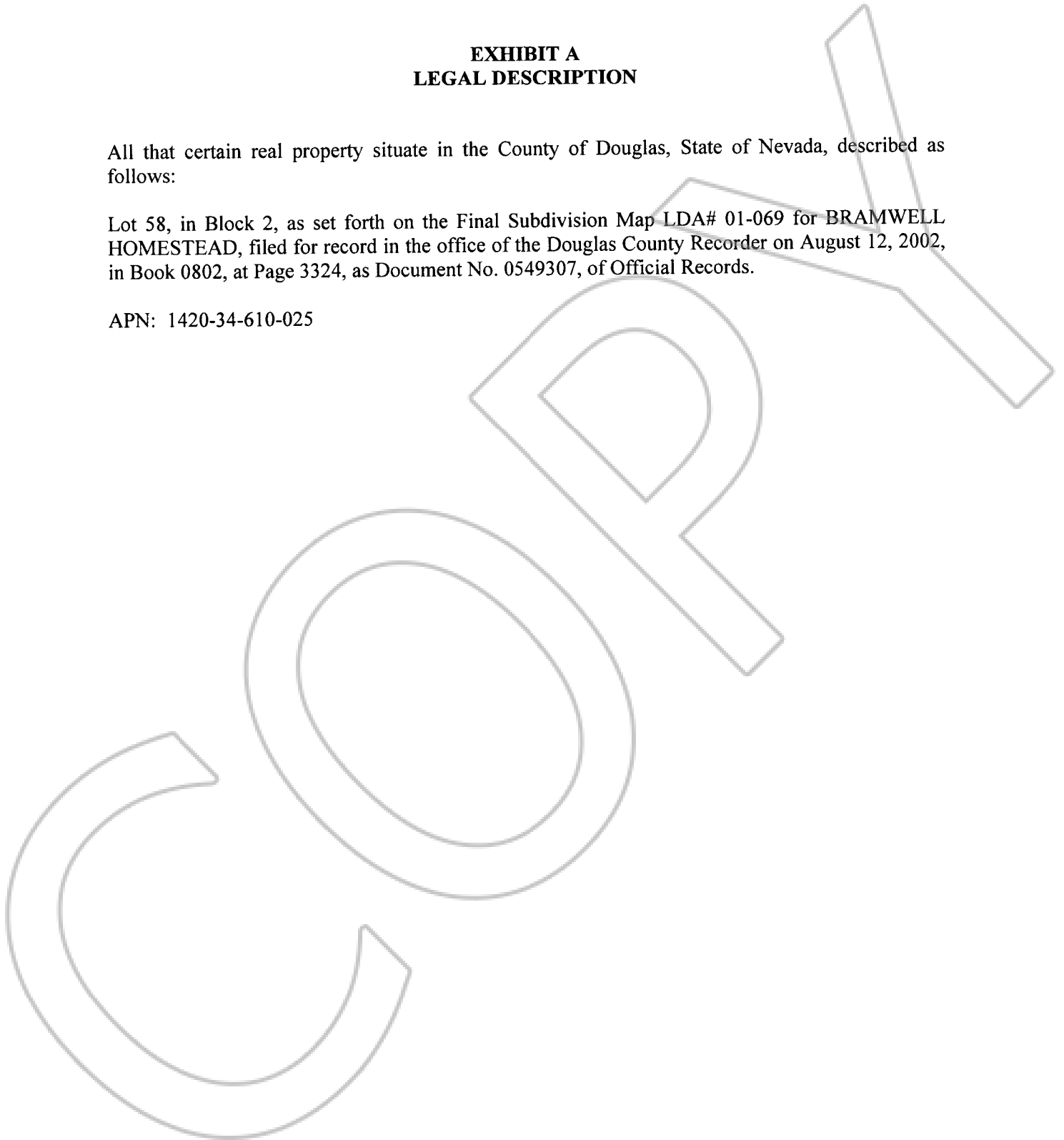

**STATE OF NEVADA
DECLARATION OF VALUE FORM**

1. Assessor Parcel Number(s)
 a. 1420-34-610-025
 b. _____
 c. _____
 d. _____

2. Type of Property:
 a. Vacant Land b. Single Fam. Res.
 c. Condo/Twnhse d. 2-4 Plex
 e. Apt. Bldg f. Comm'l/Ind'l
 g. Agricultural h. Mobile Home
 i. Other _____

FOR RECORDERS OPTIONAL USE ONLY	
Book _____	Page _____
Date of Recording: _____	
Notes: <u>Trust OK BC</u>	

3. a. Total Value/Sales Price of Property: \$ _____
 b. Deed in Lieu of Foreclosure Only (value of property) \$ _____
 c. Transfer Tax Value \$ _____
 d. Real Property Transfer Tax Due: \$ _____

4. **If Exemption Claimed**
 a. Transfer Tax Exemption, per NRS 375.090, Section 7
 b. Explain Reason for Exemption: Transfer to Trust WITHOUT CONSIDERATION

5. Partial Interest: Percentage being transferred: _____ %

The undersigned declares and acknowledges, under penalty of perjury, pursuant to NRS 375.060 and NRS 375.110, that the information provided is correct to the best of their information and belief, and can be supported by documentation if called upon to substantiate the information provided herein. Furthermore, the parties agree that disallowance of any claimed exemption, or other determination of additional tax due, may result in a penalty of 10% of the tax due plus interest at 1% per month. Pursuant to NRS 375.030, the Buyer and Seller shall be jointly and severally liable for any additional amount owed.

Signature _____ Capacity Agent
 Signature _____ Capacity _____

**SELLER (GRANTOR) INFORMATION
(REQUIRED)**
 Print Name: Jay Harrison Drew and Carol Ann Drew
 Address: 1434 Roselli Drive
 City: Livermore
 State: CA Zip: 94550

**BUYER (GRANTEE) INFORMATION
(REQUIRED)**
 Print Name: The Drew Living Trust, JAY HARRISON DREW AND CAROL ANN DREW TRUSTEES
 Address: 1434 Roselli Drive
 City: LIVERMORE
 State: CA Zip: 94550

COMPANY/PERSON REQUESTING RECORDING (Required if not Seller or Buyer)
 Print Name: TICOR TITLE Escrow No.: _____
 Address: 307 W WENNIE LANE
 City, State, Zip: CANSON CITY, NV 89701

AS A PUBLIC RECORD THIS FORM MAY BE RECORDED/MICROFILMED