

**AMENDED FINAL MAP  
PD 05-003-3  
A PLANNED DEVELOPMENT  
COTTAGES AT CARSON VALLEY, PHASE 1**

**LOCATED WITHIN A PORTION OF SECTION 21,  
TOWNSHIP 12 NORTH, RANGE 20 EAST, M.D.M., DOUGLAS COUNTY, NEVADA**

**OWNER'S CERTIFICATE**

KNOW ALL MEN BY THESE PRESENTS, THAT THE UNDERSIGNED OWNERS OF RECORD TITLE INTEREST HEREBY CONSENT TO THE PREPARATION AND RECORDING OF THIS MAP IN ACCORDANCE WITH AND FOR THE USES AND PURPOSES SET FORTH IN THE NEVADA REVISED STATUTES, CHAPTERS 116 AND 278, AND SUBSEQUENT AMENDMENTS THERETO, AND DOUGLAS COUNTY CODE CHAPTER 20, AND DOES HEREBY OFFER AND DEDICATE FOR PARTICULAR PURPOSES THE RIGHTS OF WAY AND EASEMENTS SHOWN FOR PRIVATE STORM DRAINAGE, PUBLIC UTILITIES, MAILBOX, NATURAL GAS, WATER, SEWER, FOR POLES, ANCHORS, GUYS FOR CONDUCTOR WIRE AND CONDUIT FOR ELECTRICAL, CABLE T.V. AND TELEPHONE SERVICE TOGETHER WITH ANY AND ALL APPURTENANCES THERETO, ON, ACROSS, AND UNDER ALL LAND LYING OUTSIDE THE INDIVIDUAL SITES SHOWN THEREON.

LANDSMITH APPRECIATION FUND, LLC

DOOSTON GARDNERVILLE, LLC

BY: [Signature]  
AS: Authorizing Officer

BY: [Signature]  
AS: MANAGER

THE WHITAKER FAMILY INVESTMENT CO.,  
LLC, NEVADA LIMITED LIABILITY  
COMPANY

LOT 28

[Signature]  
AS: MANAGER  
WHITAKER FAMILY INVESTMENT CO  
JEFFERY C. WHITAKER LLC

[Signature]  
JANE A. GALES, TRUSTEE

LOT 24

[Signature]  
MICHAEL W. TODD

LOT 26

[Signature]  
DONNA CRISTICH

LOT 25

[Signature]  
DANIEL C. GUNTHER  
BY [Signature] HIS ATTORNEY IN FACT

LOT 25

[Signature]  
MARILYN C. GUNTHER  
BY [Signature] HER ATTORNEY IN FACT

LOT 30 # 31

[Signature]  
RAYMOND L. GRAY, TRUSTEE

LOT 30 # 31

[Signature]  
LUCIA L. GRAY, TRUSTEE

LOT 30

[Signature]  
FRANK E. STROBANT

LOT 43

[Signature]  
RICHARD L. CLARK, TRUSTEE

LOT 32

[Signature]  
VINCENT MARDESICH, TRUSTEE

LOT 32

[Signature]  
TERESA MARDESICH, TRUSTEE

COUNTY OF Douglas  
STATE OF Nevada SS:

ON THIS 15 DAY OF March IN THE YEAR 2017 BEFORE ME Sherry Ackermann, NOTARY PUBLIC, PERSONALLY APPEARED Michael W. Todd WHO PROVED TO ME ON THE BASIS OF SATISFACTORY EVIDENCE TO BE THE PERSON(S) WHOSE NAME(S) IS/ARE SUBSCRIBED TO THE WITHIN INSTRUMENT AND ACKNOWLEDGED TO ME THAT HE/SHE/THEY EXECUTED THE SAME IN HIS/HER/THEIR AUTHORIZED CAPACITY(IES) AND THAT BY HIS/HER/THEIR SIGNATURE(S) ON THE INSTRUMENT, THE PERSON(S), OR THE ENTITY ON BEHALF OF WHICH THE PERSON(S) ACTED, EXECUTED THE INSTRUMENT.

I CERTIFY UNDER PENALTY OF PERJURY UNDER THE LAWS OF THE STATE OF Nevada THAT THE FOREGOING PARAGRAPH IS TRUE AND CORRECT.

WITNESS MY HAND AND OFFICIAL SEAL

NOTARY'S SIGNATURE [Signature]

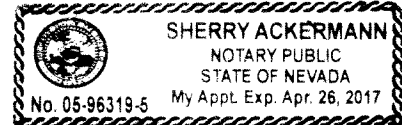

COUNTY OF Douglas  
STATE OF Nevada SS:

ON THIS 16 DAY OF March IN THE YEAR 2017 BEFORE ME Sherry Ackermann, NOTARY PUBLIC, PERSONALLY APPEARED Vincent & Teresa Mardesich WHO PROVED TO ME ON THE BASIS OF SATISFACTORY EVIDENCE TO BE THE PERSON(S) WHOSE NAME(S) IS/ARE SUBSCRIBED TO THE WITHIN INSTRUMENT AND ACKNOWLEDGED TO ME THAT HE/SHE/THEY EXECUTED THE SAME IN HIS/HER/THEIR AUTHORIZED CAPACITY(IES) AND THAT BY HIS/HER/THEIR SIGNATURE(S) ON THE INSTRUMENT, THE PERSON(S), OR THE ENTITY ON BEHALF OF WHICH THE PERSON(S) ACTED, EXECUTED THE INSTRUMENT.

I CERTIFY UNDER PENALTY OF PERJURY UNDER THE LAWS OF THE STATE OF Nevada THAT THE FOREGOING PARAGRAPH IS TRUE AND CORRECT.

WITNESS MY HAND AND OFFICIAL SEAL

NOTARY'S SIGNATURE [Signature]

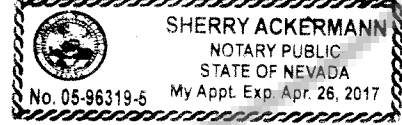

COUNTY OF Douglas  
STATE OF Nevada SS:

ON THIS 16 DAY OF March IN THE YEAR 2017 BEFORE ME Sherry Ackermann, NOTARY PUBLIC, PERSONALLY APPEARED James A. Davis WHO PROVED TO ME ON THE BASIS OF SATISFACTORY EVIDENCE TO BE THE PERSON(S) WHOSE NAME(S) IS/ARE SUBSCRIBED TO THE WITHIN INSTRUMENT AND ACKNOWLEDGED TO ME THAT HE/SHE/THEY EXECUTED THE SAME IN HIS/HER/THEIR AUTHORIZED CAPACITY(IES) AND THAT BY HIS/HER/THEIR SIGNATURE(S) ON THE INSTRUMENT, THE PERSON(S), OR THE ENTITY ON BEHALF OF WHICH THE PERSON(S) ACTED, EXECUTED THE INSTRUMENT.

I CERTIFY UNDER PENALTY OF PERJURY UNDER THE LAWS OF THE STATE OF Nevada THAT THE FOREGOING PARAGRAPH IS TRUE AND CORRECT.

WITNESS MY HAND AND OFFICIAL SEAL

NOTARY'S SIGNATURE [Signature]

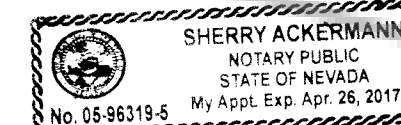

COUNTY OF Douglas  
STATE OF Nevada SS:

ON THIS 17 DAY OF March IN THE YEAR 2017 BEFORE ME Sherry Ackermann, NOTARY PUBLIC, PERSONALLY APPEARED Debra Whitaker WHO PROVED TO ME ON THE BASIS OF SATISFACTORY EVIDENCE TO BE THE PERSON(S) WHOSE NAME(S) IS/ARE SUBSCRIBED TO THE WITHIN INSTRUMENT AND ACKNOWLEDGED TO ME THAT HE/SHE/THEY EXECUTED THE SAME IN HIS/HER/THEIR AUTHORIZED CAPACITY(IES) AND THAT BY HIS/HER/THEIR SIGNATURE(S) ON THE INSTRUMENT, THE PERSON(S), OR THE ENTITY ON BEHALF OF WHICH THE PERSON(S) ACTED, EXECUTED THE INSTRUMENT.

I CERTIFY UNDER PENALTY OF PERJURY UNDER THE LAWS OF THE STATE OF Nevada THAT THE FOREGOING PARAGRAPH IS TRUE AND CORRECT.

WITNESS MY HAND AND OFFICIAL SEAL

NOTARY'S SIGNATURE [Signature]

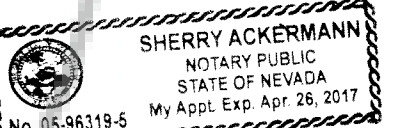

COUNTY OF Douglas  
STATE OF Nevada SS:

ON THIS 23 DAY OF March IN THE YEAR 2017 BEFORE ME Sherry Ackermann, NOTARY PUBLIC, PERSONALLY APPEARED Raymond L. Gray & Lucia L. Gray WHO PROVED TO ME ON THE BASIS OF SATISFACTORY EVIDENCE TO BE THE PERSON(S) WHOSE NAME(S) IS/ARE SUBSCRIBED TO THE WITHIN INSTRUMENT AND ACKNOWLEDGED TO ME THAT HE/SHE/THEY EXECUTED THE SAME IN HIS/HER/THEIR AUTHORIZED CAPACITY(IES) AND THAT BY HIS/HER/THEIR SIGNATURE(S) ON THE INSTRUMENT, THE PERSON(S), OR THE ENTITY ON BEHALF OF WHICH THE PERSON(S) ACTED, EXECUTED THE INSTRUMENT.

I CERTIFY UNDER PENALTY OF PERJURY UNDER THE LAWS OF THE STATE OF Nevada THAT THE FOREGOING PARAGRAPH IS TRUE AND CORRECT.

WITNESS MY HAND AND OFFICIAL SEAL

NOTARY'S SIGNATURE [Signature]

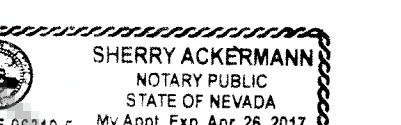

COUNTY OF Douglas  
STATE OF Nevada SS:

ON THIS 22 DAY OF March IN THE YEAR 2017 BEFORE ME Wendy Dunbar, NOTARY PUBLIC, PERSONALLY APPEARED Daniel C. Gunther & Marilyn C. Gunther WHO PROVED TO ME ON THE BASIS OF SATISFACTORY EVIDENCE TO BE THE PERSON(S) WHOSE NAME(S) IS/ARE SUBSCRIBED TO THE WITHIN INSTRUMENT AND ACKNOWLEDGED TO ME THAT HE/SHE/THEY EXECUTED THE SAME IN HIS/HER/THEIR AUTHORIZED CAPACITY(IES) AND THAT BY HIS/HER/THEIR SIGNATURE(S) ON THE INSTRUMENT, THE PERSON(S), OR THE ENTITY ON BEHALF OF WHICH THE PERSON(S) ACTED, EXECUTED THE INSTRUMENT.

I CERTIFY UNDER PENALTY OF PERJURY UNDER THE LAWS OF THE STATE OF Nevada THAT THE FOREGOING PARAGRAPH IS TRUE AND CORRECT.

WITNESS MY HAND AND OFFICIAL SEAL

NOTARY'S SIGNATURE [Signature]

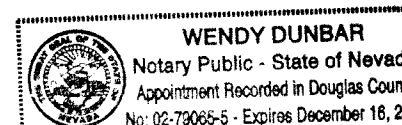

COUNTY OF Douglas  
STATE OF Nevada SS:

ON THIS 22 DAY OF March IN THE YEAR 2017 BEFORE ME Wendy Dunbar, NOTARY PUBLIC, PERSONALLY APPEARED Marilyn C. Gunther & Daniel C. Gunther WHO PROVED TO ME ON THE BASIS OF SATISFACTORY EVIDENCE TO BE THE PERSON(S) WHOSE NAME(S) IS/ARE SUBSCRIBED TO THE WITHIN INSTRUMENT AND ACKNOWLEDGED TO ME THAT HE/SHE/THEY EXECUTED THE SAME IN HIS/HER/THEIR AUTHORIZED CAPACITY(IES) AND THAT BY HIS/HER/THEIR SIGNATURE(S) ON THE INSTRUMENT, THE PERSON(S), OR THE ENTITY ON BEHALF OF WHICH THE PERSON(S) ACTED, EXECUTED THE INSTRUMENT.

I CERTIFY UNDER PENALTY OF PERJURY UNDER THE LAWS OF THE STATE OF Nevada THAT THE FOREGOING PARAGRAPH IS TRUE AND CORRECT.

WITNESS MY HAND AND OFFICIAL SEAL

NOTARY'S SIGNATURE [Signature]

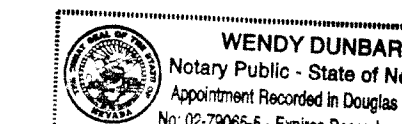

COUNTY OF Douglas  
STATE OF Nevada SS:

ON THIS 22 DAY OF March IN THE YEAR 2017 BEFORE ME Wendy Dunbar, NOTARY PUBLIC, PERSONALLY APPEARED Frank Stroobant WHO PROVED TO ME ON THE BASIS OF SATISFACTORY EVIDENCE TO BE THE PERSON(S) WHOSE NAME(S) IS/ARE SUBSCRIBED TO THE WITHIN INSTRUMENT AND ACKNOWLEDGED TO ME THAT HE/SHE/THEY EXECUTED THE SAME IN HIS/HER/THEIR AUTHORIZED CAPACITY(IES) AND THAT BY HIS/HER/THEIR SIGNATURE(S) ON THE INSTRUMENT, THE PERSON(S), OR THE ENTITY ON BEHALF OF WHICH THE PERSON(S) ACTED, EXECUTED THE INSTRUMENT.

I CERTIFY UNDER PENALTY OF PERJURY UNDER THE LAWS OF THE STATE OF Nevada THAT THE FOREGOING PARAGRAPH IS TRUE AND CORRECT.

WITNESS MY HAND AND OFFICIAL SEAL

NOTARY'S SIGNATURE [Signature]

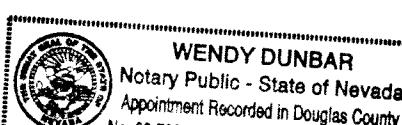

COUNTY OF Franklin  
STATE OF Washington SS:

ON THIS 22 DAY OF MAY IN THE YEAR 2017 BEFORE ME Richard L. Clark, NOTARY PUBLIC, PERSONALLY APPEARED Richard L. Clark WHO PROVED TO ME ON THE BASIS OF SATISFACTORY EVIDENCE TO BE THE PERSON(S) WHOSE NAME(S) IS/ARE SUBSCRIBED TO THE WITHIN INSTRUMENT AND ACKNOWLEDGED TO ME THAT HE/SHE/THEY EXECUTED THE SAME IN HIS AUTHORIZED CAPACITY AND THAT BY HIS SIGNATURE ON THE INSTRUMENT, THE PERSON, OR THE ENTITY ON BEHALF OF WHICH THE PERSON ACTED, EXECUTED THE INSTRUMENT.

I CERTIFY UNDER PENALTY OF PERJURY UNDER THE LAWS OF THE STATE OF Nevada THAT THE FOREGOING PARAGRAPH IS TRUE AND CORRECT.

WITNESS MY HAND AND OFFICIAL SEAL

NOTARY'S SIGNATURE [Signature]



COUNTY OF Douglas  
STATE OF Nevada SS:

ON THIS 13 DAY OF April IN THE YEAR 2017 BEFORE ME Sherry Ackermann, NOTARY PUBLIC, PERSONALLY APPEARED Dana Trisch WHO PROVED TO ME ON THE BASIS OF SATISFACTORY EVIDENCE TO BE THE PERSON(S) WHOSE NAME(S) IS/ARE SUBSCRIBED TO THE WITHIN INSTRUMENT AND ACKNOWLEDGED TO ME THAT HE/SHE/THEY EXECUTED THE SAME IN HIS/HER/THEIR AUTHORIZED CAPACITY(IES) AND THAT BY HIS/HER/THEIR SIGNATURE(S) ON THE INSTRUMENT, THE PERSON(S), OR THE ENTITY ON BEHALF OF WHICH THE PERSON(S) ACTED, EXECUTED THE INSTRUMENT.

I CERTIFY UNDER PENALTY OF PERJURY UNDER THE LAWS OF THE STATE OF Nevada THAT THE FOREGOING PARAGRAPH IS TRUE AND CORRECT.

WITNESS MY HAND AND OFFICIAL SEAL

NOTARY'S SIGNATURE [Signature]

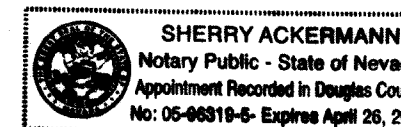

COUNTY OF Douglas  
STATE OF Nevada SS:

ON THIS 12 DAY OF April IN THE YEAR 2017 BEFORE ME Wendy Dunbar, NOTARY PUBLIC, PERSONALLY APPEARED Fred Musser WHO PROVED TO ME ON THE BASIS OF SATISFACTORY EVIDENCE TO BE THE PERSON(S) WHOSE NAME(S) IS/ARE SUBSCRIBED TO THE WITHIN INSTRUMENT AND ACKNOWLEDGED TO ME THAT HE/SHE/THEY EXECUTED THE SAME IN HIS/HER/THEIR AUTHORIZED CAPACITY(IES) AND THAT BY HIS/HER/THEIR SIGNATURE(S) ON THE INSTRUMENT, THE PERSON(S), OR THE ENTITY ON BEHALF OF WHICH THE PERSON(S) ACTED, EXECUTED THE INSTRUMENT.

I CERTIFY UNDER PENALTY OF PERJURY UNDER THE LAWS OF THE STATE OF Nevada THAT THE FOREGOING PARAGRAPH IS TRUE AND CORRECT.

WITNESS MY HAND AND OFFICIAL SEAL

NOTARY'S SIGNATURE [Signature]

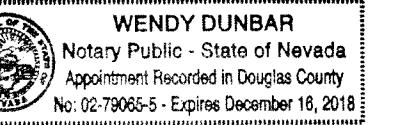

COUNTY OF San Mateo  
STATE OF California SS:

ON THIS 17 DAY OF April IN THE YEAR 2017 BEFORE ME K. Ingalls, NOTARY PUBLIC, PERSONALLY APPEARED James S. Ingalls WHO PROVED TO ME ON THE BASIS OF SATISFACTORY EVIDENCE TO BE THE PERSON(S) WHOSE NAME(S) IS/ARE SUBSCRIBED TO THE WITHIN INSTRUMENT AND ACKNOWLEDGED TO ME THAT HE/SHE/THEY EXECUTED THE SAME IN HIS/HER/THEIR AUTHORIZED CAPACITY(IES) AND THAT BY HIS/HER/THEIR SIGNATURE(S) ON THE INSTRUMENT, THE PERSON(S), OR THE ENTITY ON BEHALF OF WHICH THE PERSON(S) ACTED, EXECUTED THE INSTRUMENT.

I CERTIFY UNDER PENALTY OF PERJURY UNDER THE LAWS OF THE STATE OF California THAT THE FOREGOING PARAGRAPH IS TRUE AND CORRECT.

WITNESS MY HAND AND OFFICIAL SEAL

NOTARY'S SIGNATURE [Signature]

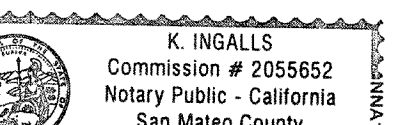

**SURVEYOR'S CERTIFICATE**

I, CLIFFORD W. RAY, A PROFESSIONAL LAND SURVEYOR LICENSED IN THE STATE OF NEVADA CERTIFY THAT:

- 1) THIS PLAT REPRESENTS THE RESULTS OF A SURVEY CONDUCTED UNDER MY DIRECT SUPERVISION AT THE INSTANCE OF DOOSTON GARDNERVILLE, LLC.
- 2) THE LANDS SURVEYED LIE WITHIN A PORTION OF SECTION 21, T.12N., R.20E., M.D.M. AND THE SURVEY WAS COMPLETED ON 05-01-17
- 3) THIS PLAT COMPLIES WITH THE APPLICABLE STATE STATUTES AND ANY LOCAL ORDINANCES IN EFFECT ON THE DATE THAT THE GOVERNING BODY GAVE ITS FINAL APPROVAL.
- 4) THE MONUMENTS DEPICTED ON THE PLAT WILL BE OF THE CHARACTER SHOWN AND OCCUPY THE POSITIONS INDICATED BY 05-20-18 AND AN APPROPRIATE PERFORMANCE BOND HAS BEEN POSTED WITH THE GOVERNING BODY TO ASSURE THEIR INSTALLATION.

[Signature] 05-30-17  
CLIFFORD W. RAY, P.L.S. 15428 DATE



**RECORDER'S CERTIFICATE**

FILED FOR RECORD THIS 20th DAY OF June, 2017, AT 26 MINUTES PAST 3 O'CLOCK P.M., IN OFFICIAL RECORDS AS DOCUMENT NO. 2017-900311

RECORDED AT THE REQUEST OF DOOSTON GARDNERVILLE, LLC.  
[Signature]  
DOUGLAS COUNTY RECORDER

**R O Anderson**  
WWW.ROANDERSON.COM

NEVADA: 1605 Emeralda Ave, P.O. Box 2292, Pringle, NV 89423, P: 775.782.2922, F: 775.782.7064  
CALIFORNIA: 3079 Harrison Avenue, Suite 2, South Lake Tahoe, CA 96160, P: 830.600.1660, F: 775.782.7064



**AMENDED FINAL MAP  
PD 05-003-3  
A PLANNED DEVELOPMENT  
COTTAGES AT CARSON VALLEY, PHASE 1**

**LOCATED WITHIN A PORTION OF SECTION 21,  
TOWNSHIP 12 NORTH, RANGE 20 EAST, M.D.M., DOUGLAS COUNTY, NEVADA**

**UTILITY COMPANIES' CERTIFICATE**

THE UTILITY EASEMENTS SHOWN ON THIS PLAT HAVE BEEN APPROVED AND ACCEPTED, ACCEPTANCE DOES NOT GUARANTEE ACCESSIBILITY. ANY INTEREST IN THE EASEMENTS SHOWN ON THIS MAP AS BEING ABANDONED HAS BEEN RELINQUISHED IN FAVOR OF THE EASEMENTS GRANTED ON THIS MAP.

THE GARDNERVILLE RANCHOS GENERAL IMPROVEMENT DISTRICT BY SIGNING THIS FINAL MAP ACKNOWLEDGES IT WILL SERVE WATER AND SEWER SERVICE TO THIS SUBDIVISION UPON ACCEPTANCE OF ALL WATER AND SEWER IMPROVEMENTS BY THE DISTRICT'S BOARD OF TRUSTEES.

GARDNERVILLE RANCHOS GENERAL IMPROVEMENT DISTRICT  
SIGNATURE: [Signature] DATE: 3/13/17  
PRINTED NAME: Robert Spillberg

FRONTIER COMMUNICATIONS  
SIGNATURE: [Signature] DATE: 3/14/17  
PRINTED NAME: LOREY BOLTON

A PUBLIC UTILITY EASEMENT IS HEREBY GRANTED TO SOUTHWEST GAS WITHIN EACH PARCEL AS SHOWN FOR THE EXCLUSIVE PURPOSE OF INSTALLING AND MAINTAINING UTILITY SERVICE FACILITIES TO THAT PARCEL, WITH THE RIGHT TO EXIT THAT PARCEL WITH SAID UTILITY FACILITIES FOR THE PURPOSE OF SERVING ADJACENT PARCELS.

SOUTHWEST GAS COMPANY  
SIGNATURE: [Signature] DATE: 3-16-17  
PRINTED NAME: STEVEN YOUNG

A PUBLIC UTILITY EASEMENT IS HEREBY GRANTED TO NV ENERGY WITHIN EACH PARCEL AS SHOWN FOR THE EXCLUSIVE PURPOSE OF INSTALLING AND MAINTAINING UTILITY SERVICE FACILITIES TO THAT PARCEL, WITH THE RIGHT TO EXIT THAT PARCEL WITH SAID UTILITY FACILITIES FOR THE PURPOSE OF SERVING ADJACENT PARCELS, AT LOCATIONS MUTUALLY AGREED UPON BY THE OWNER OF RECORD AT THAT TIME OF INSTALLATION AND THE UTILITY COMPANY.

SIERRA PACIFIC POWER COMPANY D/B/A NV ENERGY  
SIGNATURE: [Signature] DATE: 03-11-17  
PRINTED NAME: WILLIAM KRUGER

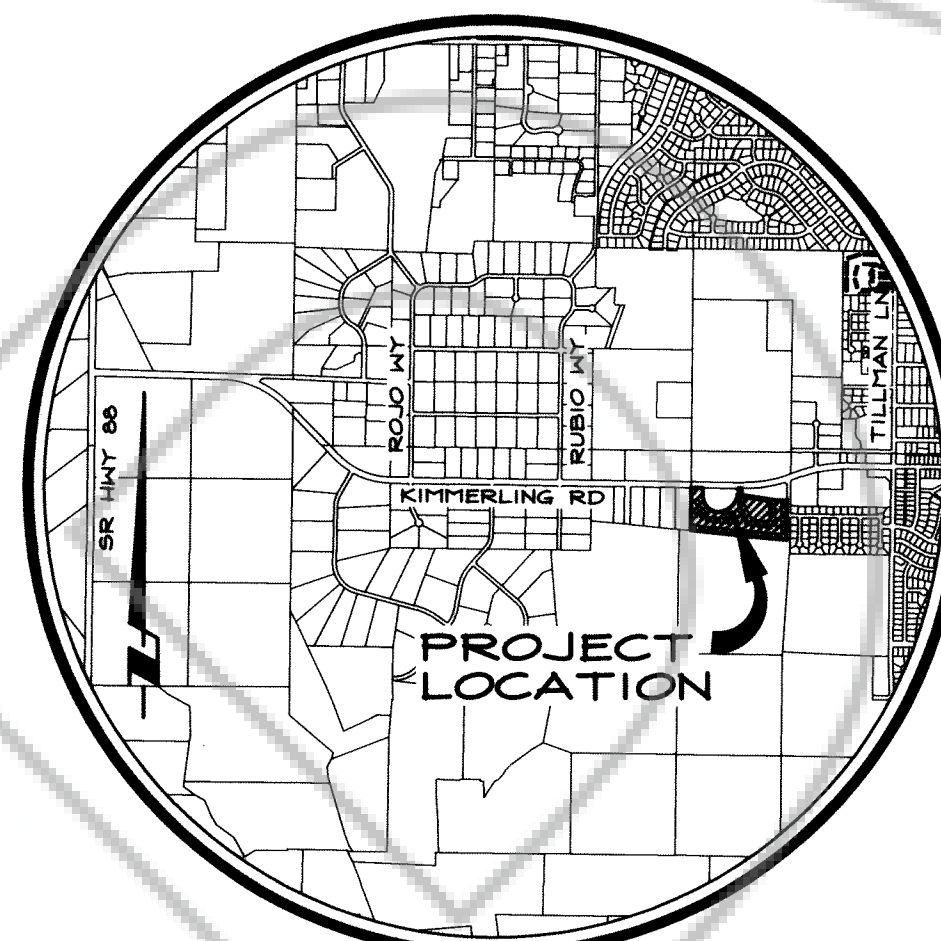

**VICINITY MAP**  
NO SCALE

**COUNTY CLERK'S CERTIFICATE**

IT IS HEREBY CERTIFIED THAT THIS PLAT WAS PRESENTED TO THE DEPARTMENT OF COMMUNITY DEVELOPMENT ON THE 20th DAY OF June, 2017, AND WAS DULY APPROVED. THERE ARE NO PUBLIC ROADS OFFERED FOR DEDICATION AS PART OF THIS MAP AND ALL OFFERS OF DEDICATION FOR OTHER PUBLIC USE ELEMENTS WERE REJECTED WITH THE RESERVATION TO ACCEPT SAID OFFERS AT A LATER DATE.

[Signature] 6-20-17  
KATHY LEWIS DATE  
COUNTY CLERK [Signature]  
DEBRA LARK

**COMMUNITY DEVELOPMENT DEPARTMENT CERTIFICATE**

IT IS HEREBY CERTIFIED THAT THIS PLAT WAS REVIEWED AND APPROVED BY THE DOUGLAS COUNTY DEPARTMENT OF COMMUNITY DEVELOPMENT ON THE 19th DAY OF June, 2017. THIS PLAT IS IN SUBSTANTIAL CONFORMANCE WITH THE TENTATIVE MAP AND ALL CONDITIONS OF APPROVAL HAVE BEEN SATISFIED. THERE ARE NO PUBLIC ROADS OFFERED FOR DEDICATION AS A PART OF THIS MAP AND ALL OFFERS OF DEDICATION FOR OTHER PUBLIC USE ELEMENTS WERE REJECTED WITH THE RESERVATION TO ACCEPT SAID OFFERS AT A LATER DATE.

[Signature] 6-19-17  
MIMI MOSS DATE  
COMMUNITY DEVELOPMENT DIRECTOR

**NEVADA DIVISION OF ENVIRONMENTAL PROTECTION**

THIS AMENDED FINAL MAP IS APPROVED BY THE NEVADA DIVISION OF ENVIRONMENTAL PROTECTION OF THE DEPARTMENT OF CONSERVATION AND NATURAL RESOURCES. THIS APPROVAL CONCERNS SEWAGE DISPOSAL, WATER POLLUTION, WATER QUALITY AND WATER SUPPLY FACILITIES AND IS PREDICATED UPON PLANS FOR A PUBLIC WATER SUPPLY AND A COMMUNITY SEWAGE DISPOSAL SYSTEM.

[Signature] 3-13-17  
BY: PATRICK MOHN, P.E. DATE  
BUREAU OF WATER POLLUTION CONTROL

**COUNTY ENGINEER'S CERTIFICATE**

I, ERIK NILSSEN, DOUGLAS COUNTY ENGINEER, DO HEREBY CERTIFY THAT I HAVE EXAMINED THIS AMENDED FINAL MAP CONSISTING OF THREE (3) SHEETS, ENTITLED 'COTTAGES AT CARSON VALLEY, PHASE 1' AND I AM SATISFIED THAT THIS MAP IS TECHNICALLY CORRECT. AN APPROPRIATE FINANCIAL SECURITY HAS BEEN POSTED TO INSURE THE COMPLETION OF THE REQUIRED PHYSICAL IMPROVEMENTS AND THE SETTING OF THE SURVEY MONUMENTS PRIOR TO 05-30-18.

[Signature] 6-16-17  
ERIK NILSSEN, P.E. DATE  
DOUGLAS COUNTY ENGINEER

**TITLE CERTIFICATE**

THIS IS TO CERTIFY THAT THE PARTIES AS LISTED WITHIN THE OWNERS CERTIFICATE ARE THE ONLY PARTIES OF RECORD HAVING INTEREST IN THE TRACTS OF LAND EMBRACED WITHIN THE GRAPHIC BORDER SHOWN ON THIS PLAT. THE FOLLOWING IS A COMPLETE LIST OF LIEN AND/OR MORTGAGE HOLDERS OF RECORD:

- DOC. NO. 787020 - LOT 24
- DOC. NO. 743302 - LOT 25
- DOC. NO. 028053 - LOT 26
- DOC. NO. 843003 - LOT 28
- DOC. NO. 777599 - LOT 30
- DOC. NO. 092204 - MULTIPLE LOTS
- DOC. NO. 897682 - LOT 37

[Signature]  
BY: Debbie H. Cimijetti, AUP DATE 5-22-17  
WESTERN TITLE COMPANY, LLC

**DIVISION OF WATER RESOURCES CERTIFICATE**

THIS AMENDED FINAL MAP IS APPROVED BY THE DIVISION OF WATER RESOURCES OF THE NEVADA DEPARTMENT OF CONSERVATION AND NATURAL RESOURCES CONCERNING WATER QUANTITY SUBJECT TO THE REVIEW OF APPROVAL ON FILE IN THIS OFFICE.

[Signature] 3/13/2017  
BY: Mark Sivazlian, Section Chief, Water Rights DATE  
DIVISION OF WATER RESOURCES

**COUNTY TAX COLLECTOR'S CERTIFICATE**

I, KATHY LEWIS, DOUGLAS COUNTY CLERK-TREASURER AND EX-OFFICIO TAX COLLECTOR, DO HEREBY CERTIFY THAT ALL PROPERTY TAXES ON THIS LAND FOR THE FISCAL YEAR HAVE BEEN PAID. (A.P.N.'S 1220-21-111-001, -002, -003, -004, -005, -006, -007, -008, -009, -010, -011, -012, -013, -014, -015, -016, -017, -018, -019, -020, -021, -022, -023, -024, -025, -026, -027, -028, -029, -030, -031, -032, -033, -034, -035, -039, -040, -041, -042, -043, -044, -045, -046, -047, -048, -049, -050, -051, -052, -053, -054, -055, -056, -057, -058, -059, -060, -061, -063, -064, -065 & -066)

[Signature] 6-20-17  
KATHY LEWIS DATE  
DOUGLAS COUNTY CLERK-TREASURER  
by [Signature] Chief Deputy Treasurer

**FIRE DEPARTMENT'S CERTIFICATE**

THE FIRE FIGHTING FACILITIES AND ACCESS SHOWN ON THESE PLANS ARE HEREBY APPROVED BY THE EAST FORK FIRE PROTECTION DISTRICT.

[Signature] 3/14/17  
STEVE EISELE DATE  
EAST FORK FIRE PROTECTION SERVICE

**OWNER'S CERTIFICATE (CONTINUED)**

LOT 37 [Signature]  
DAVID R. DEL MARTO

LOT 37 [Signature]  
KERRY A. DEL MARTO

COUNTY OF Douglas STATE OF Nevada  
ON THIS 24 DAY OF May IN THE YEAR 2017, BEFORE ME, [Signature] NOTARY PUBLIC, PERSONALLY APPEARED DAVID R. AND KERRY A. DEL MARTO, WHO PROVED TO ME ON THE BASIS OF SATISFACTORY EVIDENCE TO BE THE PERSONS WHOSE NAMES ARE SUBSCRIBED TO THE WITHIN INSTRUMENT AND ACKNOWLEDGED TO ME THAT THEY EXECUTED THE SAME IN THEIR AUTHORIZED CAPACITIES AND THAT BY THEIR SIGNATURES ON THE INSTRUMENT, THE PERSONS, OR THE ENTITY ON BEHALF OF WHICH THE PERSONS ACTED, EXECUTED THE INSTRUMENT.  
I CERTIFY UNDER PENALTY OF PERJURY UNDER THE LAWS OF THE STATE OF Nevada THAT THE FOREGOING PARAGRAPH IS TRUE AND CORRECT.  
WITNESS MY HAND AND OFFICIAL SEAL  
NOTARY'S SIGNATURE [Signature]

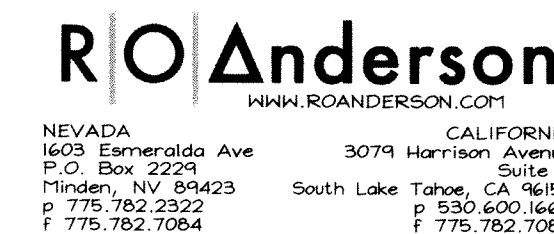
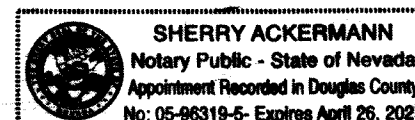



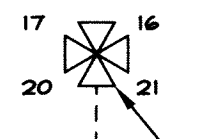

### BASIS OF BEARING

N85°21'36"W - THE SOUTHERLY BOUNDARY OF "HERITAGE NEVADA SENIOR HOUSING" AS SHOWN ON THE FINAL MAP RECORDED IN THE OFFICIAL RECORDS OF DOUGLAS COUNTY, NEVADA AS DOCUMENT NO. 684198.

### LEGEND

- FOUND CENTERLINE MONUMENT PLS 6304
- SET CENTERLINE MONUMENT PLS 15428
- FOUND MONUMENT AS NOTED
- △ SET 5/8" REBAR WITH CAP PLS 15428 ON PROJECT BOUNDARY
- └ SET 5/8" REBAR WITH CAP OR NAIL AND TAG PLS 15428 AT ALL PROPERTY CORNERS

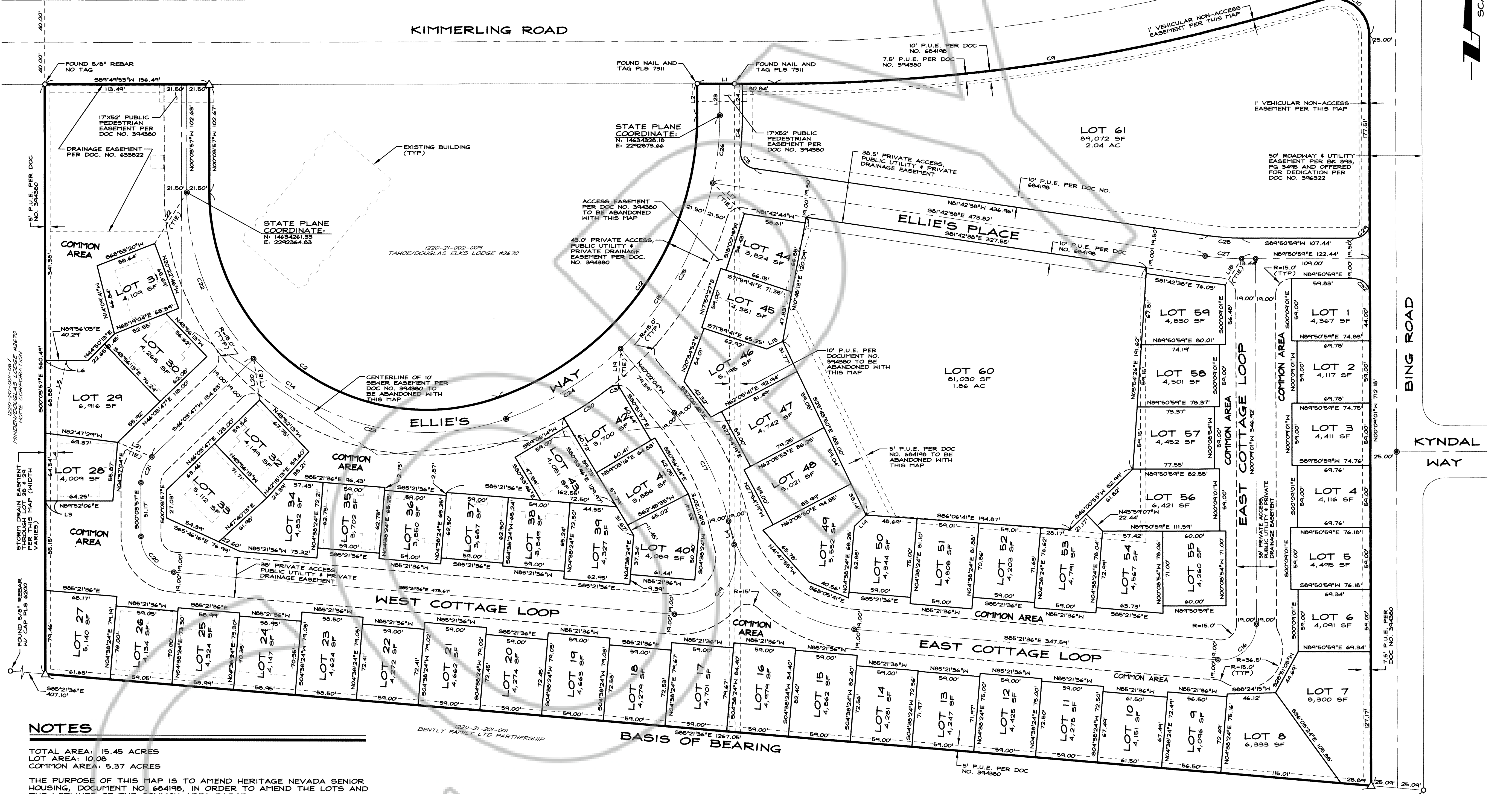

### NOTES

TOTAL AREA: 15.45 ACRES  
 LOT AREA: 10.06 ACRES  
 COMMON AREA: 5.37 ACRES

THE PURPOSE OF THIS MAP IS TO AMEND HERITAGE NEVADA SENIOR HOUSING, DOCUMENT NO. 684198, IN ORDER TO AMEND THE LOTS AND THE LOTLINES OF THE COMMON AREA PARCEL.

THE FOLLOWING NOTES ARE LISTED ON THE FINAL MAP FOR HERITAGE NEVADA SENIOR HOUSING, DOCUMENT NO. 684198, AND REMAIN IN PLACE:

ANY FURTHER DIVISION OF THESE PARCELS SHALL BE SUBJECT TO SUBDIVISION IMPROVEMENTS AS PROVIDED UNDER NRS 278.462(3).

MAINTENANCE OF ALL DRAINAGE FACILITIES AND EASEMENTS SHALL BE THE RESPONSIBILITY OF THE INDIVIDUAL PROPERTY OWNERS OR OTHER PRIVATE ENTITY, INCLUDING A HOMEOWNER'S ASSOCIATION. DOUGLAS COUNTY REJECTS ANY OFFER OF DEDICATION OF DRAINAGE FACILITIES OR DRAINAGE EASEMENTS.

OBSTRUCTING THE FLOW OR ALTERING THE COURSE OF A DRAINAGE CHANNEL IS PROHIBITED, UNLESS PERMITTED BY AN AUTHORIZING AGENCY.

ALL AREAS INDICATED HEREON AS "COMMON AREA" SHALL BE DESIGNATED AS PUBLIC UTILITY EASEMENTS, EASEMENTS FOR CLUSTER MAILBOXES AND PRIVATE DRAINAGE EASEMENTS.

NEVADA STATE PLANE, WEST ZONE (NAD83) COORDINATES SHOWN HEREON WERE DETERMINED USING THE NORTHERN NEVADA COOPERATIVE REAL TIME NETWORK (NNCRN GPS).

LINE	BEARING	LENGTH
L1	S89°41'53"W	73.84'
L2	S00°03'57"E	29.96'
L3	N84°52'06"E	12.00'
L4	N00°05'57"W	94.61'
L5	N11°44'49"E	39.64'
L6	S89°56'09"W	20.12'
L7	S46°30'44"W	15.46'
L8	N6°41'10"E	16.71'
L9	S45°57'22"E	41.77'
L10	N81°41'17"E	29.48'
L11	N08°46'25"E	35.14'
L12	S08°04'52"E	39.80'
L13	N87°26'42"W	44.80'
L14	S67°15'57"E	35.38'
L15	S00°09'57"E	30.00'
L16	S00°09'57"E	30.04'

CURVE	DELTA	RADIUS	LENGTH	CURVE	DELTA	RADIUS	LENGTH
C2	Δ=109°28'16"	206.50'	394.55'	C21	Δ=46°07'44"	34.00'	27.37'
C3	Δ=87°35'21"	15.00'	22.93'	C22	Δ=43°52'16"	228.00'	174.50'
C4	Δ=05°56'40"	327.50'	33.98'	C23	Δ=65°36'00"	228.00'	261.05'
C9	Δ=17°13'22"	1760.00'	529.05'	C24	Δ=24°10'18"	306.00'	129.49'
C10	Δ=107°14'28"	35.00'	65.51'	C25	Δ=34°14'19"	306.00'	182.85'
C12	Δ=70°31'44"	284.50'	350.21'	C26	Δ=12°07'19"	306.00'	64.73'
C14	Δ=109°28'16"	228.00'	435.62'	C27	Δ=08°26'23"	236.00'	34.76'
C15	Δ=70°31'44"	306.00'	376.67'	C28	Δ=08°26'23"	216.50'	31.84'
C16	Δ=94°47'25"	34.00'	56.28'	C29	Δ=90°00'00"	15.00'	23.56'
C17	Δ=28°37'07"	250.00'	116.15'	C30	Δ=08°55'53"	327.50'	51.05'
C18	Δ=71°56'58"	134.01'	168.28'	C31	Δ=37°44'11"	15.00'	9.88'
C19	Δ=108°09'21"	54.00'	101.84'	C32	Δ=90°00'00"	15.00'	23.56'
C20	Δ=85°17'39"	34.00'	50.61'				

**RO Anderson**  
 REALTOR  
 1629 Emerald Ave  
 P.O. Box 2294  
 Minden, NV 89423  
 P 775.782.2322  
 F 775.782.7084

CALIFORNIA  
 3079 Harrison Avenue  
 Suite 2  
 South Lake Tahoe, CA 96150  
 P 530.600.1860  
 F 775.782.7084

SCALE: 1" = 50'

SHEET 3 OF 3

**AMENDED FINAL MAP**  
 PD 05-003-3  
 A PLANNED DEVELOPMENT  
 FOR  
**COTTAGES AT CARSON VALLEY, PHASE I**

LOCATED WITHIN A PORTION OF  
 SECTION 21, T.12N., R.20E., M.D.M.  
 DOUGLAS COUNTY, NEVADA

2361-001 AMENDED FP1.dwg 03/10/17