

DOUGLAS COUNTY, NV **2017-904131**
RPTT:\$1326.00 Rec:\$16.00
\$1,342.00 Pgs=3 **09/15/2017 03:49 PM**
TICOR TITLE - GARDNERVILLE
KAREN ELLISON, RECORDER

WHEN RECORDED MAIL TO:
Thomas M. Ely
1326 Windsor Drive
Gardnerville, NV 89460

MAIL TAX STATEMENTS TO:
Thomas M. Ely
Same as Above

Escrow No. 1703800-RLT

The undersigned hereby affirms that this document submitted for recording does not contain the social security number of any person or persons.
(Pursuant to NRS 239b.030)

APN No.: 1320-33-813-020
R.P.T.T. \$1,326.00

SPACE ABOVE FOR RECORDER'S USE ONLY

GRANT, BARGAIN, SALE DEED

THIS INDENTURE WITNESSETH: That David J. Whittemore and Mary A. Wertjes, husband and wife as joint tenants

FOR A VALUABLE CONSIDERATION, receipt of which is hereby acknowledged, do/does hereby Grant, Bargain, Sell and Convey to Thomas M. Ely, a single man

all that real property situated in the County of Douglas, State of Nevada, described as follows:

SEE EXHIBIT "A" ATTACHED HERETO AND BY REFERENCE MADE A PART HEREOF

Together with all and singular the tenements, hereditaments and appurtenances thereunto belonging or in anywise appertaining.

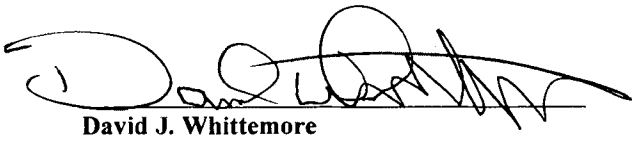

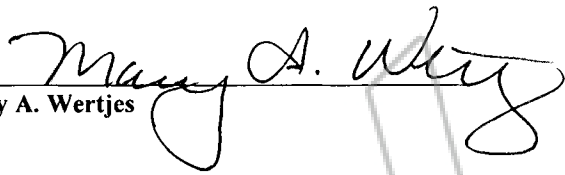
David J. Whittemore



Mary A. Wertjes

STATE OF NEVADA
COUNTY OF DOUGLAS

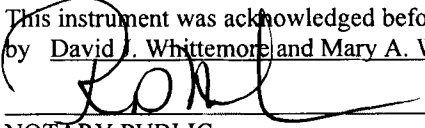
} ss:

This instrument was acknowledged before me on, 9/17/17
by David J. Whittemore and Mary A. Wertjes

NOTARY PUBLIC

 **RISHELE L. THOMPSON**
Notary Public - State of Nevada
Appointment Recorded in Douglas County
No: 99-54931-5 - Expires April 10, 2019

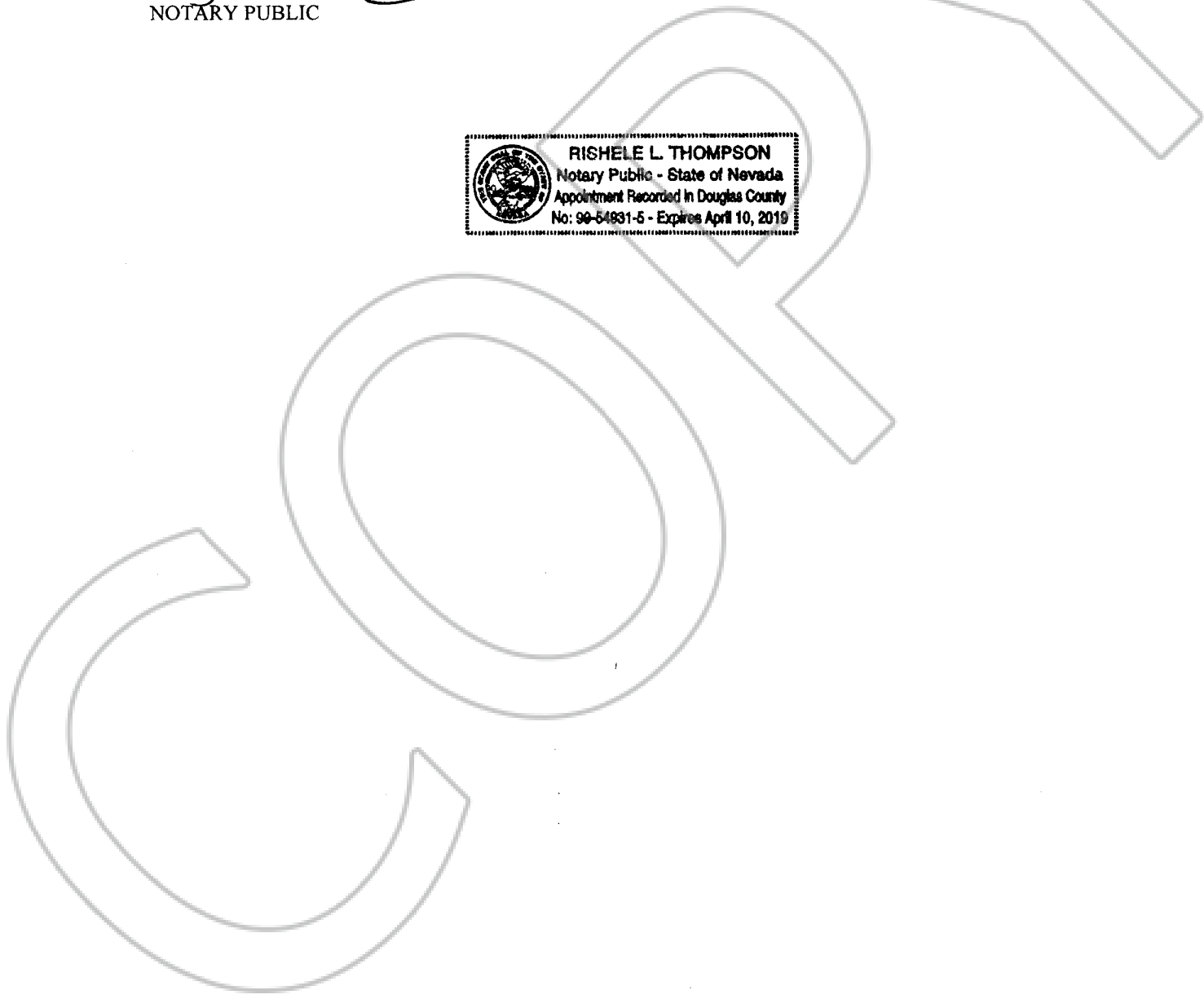

Escrow No. 1703800-RLT

**EXHIBIT A
LEGAL DESCRIPTION**

All that certain real property situate in the County of Douglas, State of Nevada, described as follows:

Lot 27, in Block D, as set forth on FINAL SUBDIVISION MAP #1006-5 CHICHESTER ESTATES PHASE 5, filed in the office of the County Recorder of Douglas County, Nevada recorded on April 9, 1999 in Book 499 at Page 1900 as Document No. 465394, Official Records.

APN: 1320-33-813-020

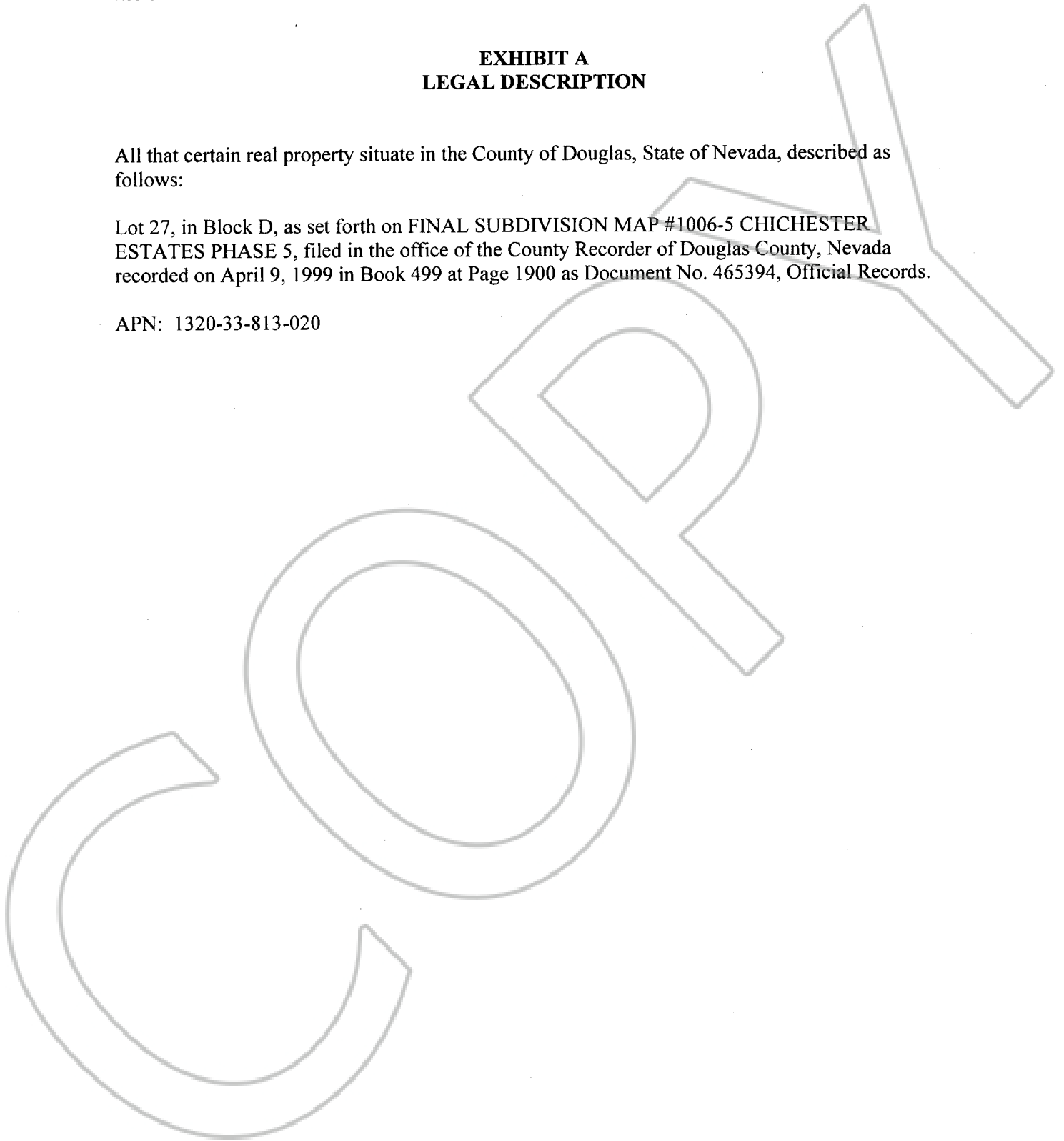

**STATE OF NEVADA
DECLARATION OF VALUE FORM**

1. Assessor Parcel Number(s)
 a. 1320-33-813-020
 b. _____
 c. _____
 d. _____

2. Type of Property:
 a. Vacant Land
 b. Single Fam. Res.
 c. Condo/Twnhse
 d. 2-4 Plex
 e. Apt. Bldg
 f. Comm'l/Ind'l
 g. Agricultural
 h. Mobile Home
 i. Other _____

FOR RECORDERS OPTIONAL USE ONLY
 Book _____ Page _____
 Date of Recording: _____
 Notes: _____

3. a. Total Value/Sales Price of Property: \$ 340,000.00
 b. Deed in Lieu of Foreclosure Only (value of property) \$ _____
 c. Transfer Tax Value \$ 340,000.00
 d. Real Property Transfer Tax Due: \$ 1,326.00

4. **If Exemption Claimed**
 a. Transfer Tax Exemption, per NRS 375.090, Section _____
 b. Explain Reason for Exemption: _____

5. Partial Interest: Percentage being transferred: _____ %

The undersigned declares and acknowledges, under penalty of perjury, pursuant to NRS 375.060 and NRS 375.110, that the information provided is correct to the best of their information and belief, and can be supported by documentation if called upon to substantiate the information provided herein. Furthermore, the parties agree that disallowance of any claimed exemption, or other determination of additional tax due, may result in a penalty of 10% of the tax due plus interest at 1% per month. Pursuant to NRS 375.030, the Buyer and Seller shall be jointly and severally liable for any additional amount owed.

Signature [Signature] Capacity Seller/Grantor
 Signature [Signature] Capacity Seller/Grantor

**SELLER (GRANTOR) INFORMATION
(REQUIRED)**
 Print Name: David J. Whittemore, ETAL
 Address: 1326 Windsor Drive
 City: Gardnerville
 State: NV Zip: 89410

**BUYER (GRANTEE) INFORMATION
(REQUIRED)**
 Print Name: Thomas M. Ely
 Address: 1326 Windsor Drive
 City: Gardnerville
 State: NV Zip: 89460

COMPANY/PERSON REQUESTING RECORDING (Required if not Seller or Buyer)
 Print Name: Ticor Title of Nevada, Inc. Escrow No.: 01703800-020-RLT
 Address: 1483 Highway 395 N, Suite B
 City, State, Zip: Gardnerville, NV 89410

AS A PUBLIC RECORD THIS FORM MAY BE RECORDED/MICROFILMED