

**CURVE TABLE**

CURVE	RADIUS	DELTA	LENGTH	CURVE	RADIUS	DELTA	LENGTH
C1	1040.00'	1°34'40"	28.64'	C12	43.00'	60°07'53"	45.13'
C2	24.00'	50°24'28"	21.11'	C13	200.00'	06°59'11"	24.39'
C3	56.00'	38°44'30"	37.87'	C14	200.00'	06°43'35"	23.48'
C4	217.00'	13°42'46"	51.94'	C15	72.00'	16°52'19"	21.20'
C5	183.00'	24°33'28"	78.44'	C16	72.00'	11°39'04"	14.64'
C6	60.00'	29°05'24"	30.46'	C17	106.50'	45°26'27"	84.46'
C7	60.00'	59°51'27"	62.68'	C18	88.00'	148°41'45"	228.38'
C8	20.00'	90°33'00"	31.61'	C19	81.50'	45°26'27"	64.64'
C9	72.00'	38°44'30"	48.68'	C20	47.00'	28°31'23"	23.40'
C10	200.00'	24°33'28"	85.72'	C21	32.00'	32°52'52"	18.36'
C11	77.00'	29°05'24"	39.09'	C22	2540.00'	1°33'52"	69.36'

**LINE TABLE**

LINE	DIRECTION	LENGTH	LINE	DIRECTION	LENGTH
L1	N1°06'55"E	35.24'	L16	N71°31'19"E	69.47'
L2	N39°51'25"E	110.83'	L17	N51°3'22"W	15.12'
L3	N37°13'56"E	32.79'	L18	N89°11'34"W	18.48'
L4	N1°06'55"E	13.39'	L19	N0°48'26"E	85.40'
L5	N39°51'25"E	68.75'	L20	N51°3'22"W	48.92'
L6	N0°48'26"E	91.40'	L21	N38°06'14"W	27.80'
L7	N89°11'34"W	141.50'	L22	N38°06'14"W	28.20'
L8	N0°48'26"E	21.00'	L23	N79°57'18"W	19.34'
L9	N88°53'34"W	100.00'	L24	N0°02'30"W	46.51'
L10	N0°50'02"E	30.47'	L25	N89°16'37"W	75.41'
L11	N11°56'07"E	56.92'	L26	N89°06'58"W	14.35'
L12	N19°06'22"W	38.14'	L27	N53°10'48"W	52.83'
L13	N18°28'41"W	8.37'	L28	N87°24'14"W	66.23'
L14	N71°31'19"E	46.52'	L29	N30°05'43"E	60.66'
L15	N71°31'19"E	69.47'			

**NOTES**

1) ADDITIONAL EASEMENTS MAY EXIST THAT ARE NOT SHOWN HEREON.

**BASIS OF BEARING**

THE BASIS OF BEARING FOR THIS SURVEY IS BASED ON THE NEVADA COORDINATE SYSTEM OF 1983, WEST ZONE, NAD 83/94. DISTANCES SHOWN ARE GROUND DISTANCES USING A PROJECT COMBINED GRID TO GROUND SCALE FACTOR OF 1.00023000.

**LEGEND**

- ▲ FOUND NEVADA DEPARTMENT OF TRANSPORTATION CONTROL POINT
  - FOUND COPPER WELD IN MONUMENT WELL STAMPED "PLS 6497", OR AS NOTED
  - SET 5/8" REBAR W/ PLASTIC CAP OR NAIL & TAG STAMPED "PLS 17616"
  - FOUND 5/8" REBAR W/ PLASTIC CAP OR NAIL & TAG STAMPED "PLS 17616" OR AS NOTED
- (R1) RECORD COURSE & DISTANCE PER REFERENCE NUMBER  
 (C) CALCULATED COURSE & DISTANCE  
 (M) MEASURED COURSE & DISTANCE  
 RAD. RADIAL BEARING

**SURVEYOR'S CERTIFICATE**

I, GREGORY S. PHILLIPS, A PROFESSIONAL LAND SURVEYOR LICENSED IN THE STATE OF NEVADA, AS AGENT FOR LUMOS AND ASSOCIATES, CERTIFY THAT:

- THIS PLAT REPRESENTS THE RESULTS OF A SURVEY CONDUCTED UNDER MY DIRECT SUPERVISION AT THE INSTANCE OF DOUGLAS COUNTY.
- THE LANDS SURVEYED LIE WITHIN PORTIONS OF THE SW 1/4 OF THE SW 1/4 OF SECTION 23, T.13N., R.18E., M.D.M., AND THE SURVEY WAS COMPLETED ON OCTOBER 12, 2017.
- THIS PLAT COMPLIES WITH APPLICABLE STATUTES OF THIS STATE AND ANY LOCAL ORDINANCES IN EFFECT ON THE DATE THAT THE SURVEY WAS COMPLETED, AND THE SURVEY WAS CONDUCTED IN ACCORDANCE WITH CHAPTER 625 OF THE NEVADA ADMINISTRATIVE CODE.
- THE MONUMENTS DEPICTED ON THIS PLAT ARE OF THE CHARACTER SHOWN, OCCUPY THE POSITIONS INDICATED, AND ARE OF SUFFICIENT NUMBER AND DURABILITY.

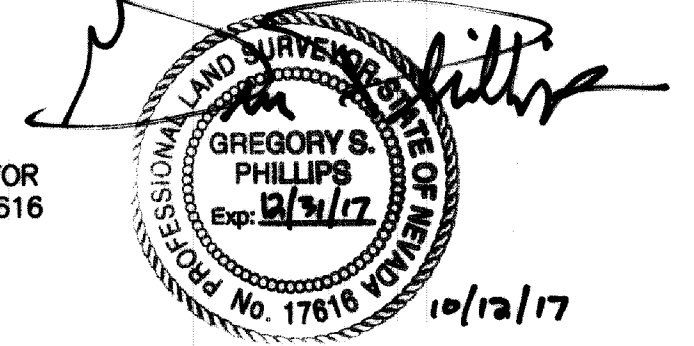

GREGORY S. PHILLIPS  
 PROFESSIONAL LAND SURVEYOR  
 NEVADA CERTIFICATE NO. 17616

**REFERENCES**

- RESOLUTION NUMBER 2003R-019, RECORDED MARCH 27, 2003, IN BOOK 303, AT PAGE 13002, AS DOCUMENT NO. 571413.
  - DEPENDENT RESURVEY AND SECTION SUBDIVISION, RECORDED MAY 9, 1975, IN BOOK 575, AT PAGE 401, AS DOCUMENT NO. 80110.
  - RECORD OF SURVEY, RECORDED OCTOBER 12, 1976, IN BOOK 1076, AT PAGE 455, AS DOCUMENT NO. 3893.
  - RECORD OF SURVEY, RECORDED OCTOBER 14, 1982, IN BOOK 1082, AT PAGE 629, AS DOCUMENT NO. 71687.
  - RECORD OF SURVEY, RECORDED DECEMBER 21, 1987, IN BOOK 1287, AT PAGE 2841, AS DOCUMENT NO. 169178.
  - PARCEL MAP, RECORDED SEPTEMBER 21, 1990, IN BOOK 990, AT PAGE 3206, AS DOCUMENT NO. 235099.
  - RECORD OF SURVEY, RECORDED SEPTEMBER 27, 1999, IN BOOK 999, AT PAGE 5096, AS DOCUMENT NO. 477533.
  - DEED DOCUMENTS, RECORDED SEPTEMBER 3, 1982, IN BOOK 982, AT PAGES 105 & 108, AS DOCUMENT NO.'S 70692 & 70693.
  - DEED DOCUMENT, RECORDED FEBRUARY 26, 2010, IN BOOK 210, AT PAGE 5407, AS DOCUMENT NO. 759331.
  - GRANT DEED FOR PUBLIC ROADWAY, RECORDED MAY 23, 2001, IN BOOK 501, AT PAGE 6406, AS DOCUMENT NO. 514638, OFFICIAL RECORDS OF DOUGLAS COUNTY, STATE OF NEVADA.
  - STATE OF NEVADA DEPARTMENT OF HIGHWAYS MAP SHOWING RIGHT OF WAY TO BE ACQUIRED FROM W.M. & ELIZABETH S. RABE, DATED NOVEMBER 27, 1931.
  - PUBLIC HIGHWAY DEED DOCUMENT, RECORDED OCTOBER 23, 1935, IN BOOK U OF DEEDS, AT PAGE 110, AS INSTRUMENT NO. 2695.
  - GRANT DEED, RECORDED NOVEMBER 23, 1994, IN BOOK 1194, AT PAGE 3716, AS DOCUMENT NO. 351217.
  - WATER LINE EASEMENT, RECORDED MAY 9, 1988, IN BOOK 588, AT PAGE 1210, AS DOCUMENT NO. 177757.
  - EASEMENT DEED, RECORDED MAY 18, 2001, IN BOOK 501, AT PAGE 5329, AS DOCUMENT NO. 514436.
  - RECORD OF SURVEY IN SUPPORT OF A BOUNDARY LINE ADJUSTMENT, RECORDED SEPTEMBER 24, 2014, IN BOOK 914, AT PAGE 4367, AS DOCUMENT NO. 849816.
  - DOUGLAS COUNTY MAP SHOWING ALIGNMENT AND RIGHT OF WAY FOR COUNTY ROAD IMPROVEMENT ALONG KINGSBURY GRADE, DATED APRIL 27, 1957.
  - RECORD OF SURVEY IN SUPPORT OF A BOUNDARY LINE ADJUSTMENT, RECORDED MAY 31, 2007, IN BOOK 567, AT PAGE 10333, AS DOCUMENT NO. 702136.
  - RECORD OF SURVEY, RECORDED NOVEMBER 14, 1997, IN BOOK 1197, AT PAGE 2829, AS DOCUMENT NO. 426354.
  - QUITCLAIM DEED, RECORDED SEPTEMBER 28, 1998, IN BOOK 0988, AT PAGE 5765, AS DOCUMENT NO. 450469.
  - BOUNDARY LINE ADJUSTMENT DEED, RECORDED SEPTEMBER 24, 2014, IN BOOK 0914, AT PAGE 4351, AS DOCUMENT NO. 849813.
- ALL OFFICIAL RECORDS OF DOUGLAS COUNTY, STATE OF NEVADA, EXCLUDING R11 & R17.

**RECORDER'S CERTIFICATE**

FILED FOR RECORD THIS 16 DAY OF October, 2017, AT 33 MINUTES PAST 2 O'CLOCK P.M., AS DOCUMENT NO. 2017-905648 RECORDED AT THE REQUEST OF DOUGLAS COUNTY.

*Shawna Lauer, Deputy*  
 DOUGLAS COUNTY RECORDER

**RECORD OF SURVEY**  
 IN SUPPORT OF  
**A DEED OF COMBINATION FOR**  
**DOUGLAS COUNTY**

LYING WITHIN A PORTION OF THE SOUTHWEST 1/4 OF THE SOUTHWEST 1/4 OF SEC. 23, TOWNSHIP 13 N., RANGE 18 E., M.D.M.  
 DOUGLAS COUNTY NEVADA

800 E. COLLEGE PARKWAY  
 CARSON CITY, NV 89708  
 TEL (775) 883-7077  
 FAX (775) 883-7114

Drawn By : GSP  
 Date : OCTOBER 2017  
 Job No. : 8454.000  
 SHEET 1 OF 1