

**SURVEYOR'S CERTIFICATE**

I, JEFFERY W. TURNER, A PROFESSIONAL LAND SURVEYOR REGISTERED IN THE STATE OF NEVADA, CERTIFY THAT: THIS PLAT HAS BEEN PREPARED FROM RECORD INFORMATION AS SHOWN ON THE AMENDED MAP OF ZEPHYR COVE PROPERTY RECORDED AUGUST 5, 1929 AS DOCUMENT NO. 266, OFFICIAL RECORDS, DOUGLAS COUNTY, NEVADA, AND DOCUMENT NUMBER 2013-0832727. THIS REVERSION TO ACREAGE IS AT THE INSTANCE OF DAVID L. SCOTT. I ASSUME NO RESPONSIBILITY FOR THE CORRECTNESS OF OTHER INFORMATION SHOWN ON OR COPIED FROM THIS DOCUMENT.

*Jeffery W. Turner*  
 JEFFERY W. TURNER  
 P.L.S. 21260  
 14 Nov 17  
 DATE

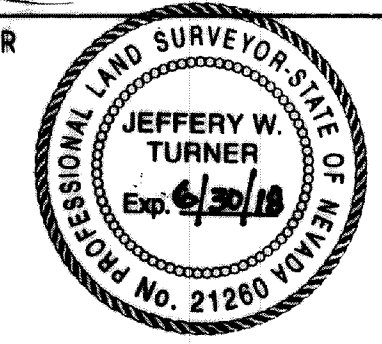

**VICINITY MAP**

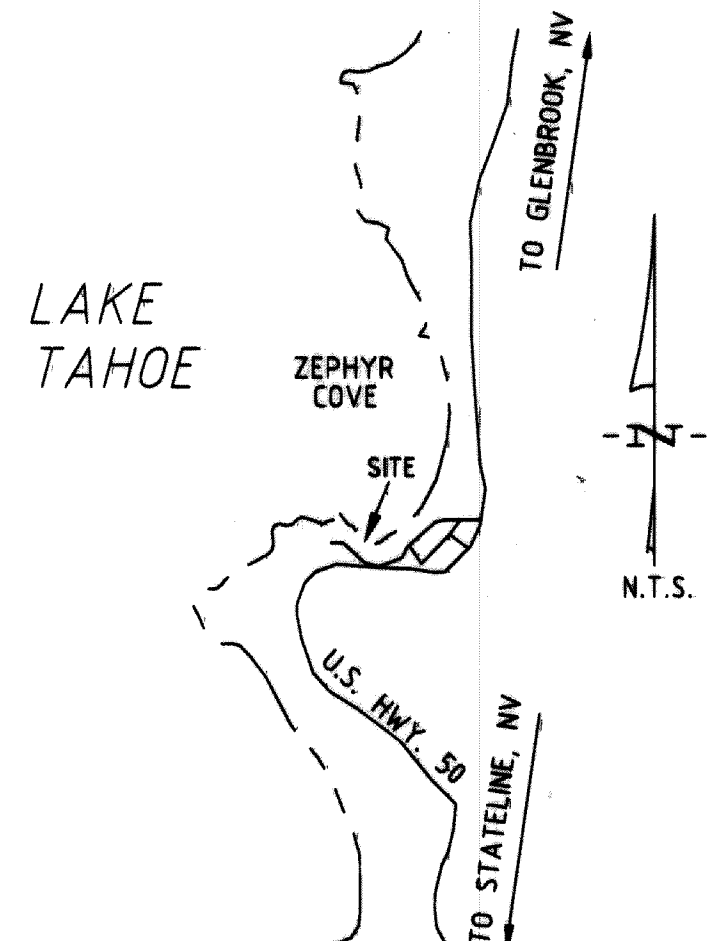

MICHAEL & LOREN GORDON FAMILY TRUST &  
 JEFF AND LISA GORDON TRUST  
 A.P.N. 1318-10-310-013

PROPERTY LINE EXTENDED TO APPROX. LOW WATER LINE OF LAKE TAHOE PER NRS 321.595

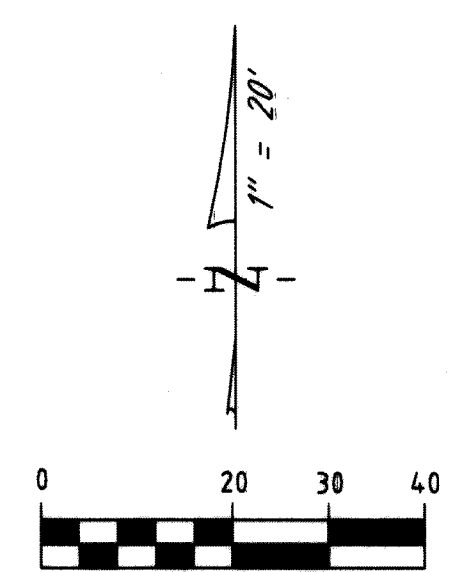

**OWNERS' CERTIFICATE**

THE UNDERSIGNED OWNER OF THE AFFECTED PARCEL AS SHOWN ON THIS MAP DO HEREBY STATE:  
 1. WE HAVE EXAMINED THIS PLAT AND APPROVE AND AUTHORIZE ITS RECORDING;  
 2. ALL PROPERTY TAXES ON THE LAND FOR THE FISCAL YEAR HAVE BEEN PAID; AND  
 3. ANY LENDER WITH AN IMPOUND ACCOUNT FOR THE PAYMENT OF TAXES HAS BEEN NOTIFIED OF THE ADJUSTMENT OF THE BOUNDARY LINE FOR THE TRANSFER OF LAND.

*David L. Scott, Trustee*  
 DAVID L. SCOTT, TRUSTEE  
 DAVID L. SCOTT REVOCABLE TRUST UTA

**NOTARY CERTIFICATE**

STATE OF Nevada  
 COUNTY OF Douglas JSS  
 THIS 15 DAY OF November, 2017  
 BEFORE ME, R. Davison A NOTARY PUBLIC,  
 PERSONALLY APPEARED David L. Scott &

PERSONALLY KNOWN BY ME (OR PROVED TO ME ON THE BASIS OF SATISFACTORY EVIDENCE) TO BE THE PERSON WHOSE NAMES ARE SUBSCRIBED TO THIS INSTRUMENT AND ACKNOWLEDGED TO ME THAT THEY EXECUTED IT.

WITNESS MY HAND AND OFFICIAL SEAL.  
*R. Davison*  
71812020  
 MY COMMISSION EXPIRES

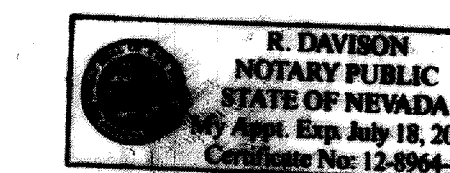

**REFERENCES**

- (R1) AMENDED MAP OF ZEPHYR COVE PROPERTY RECORDED AUGUST 5, 1929 AS DOCUMENT NUMBER 266
- (R2) GRANT, BARGAIN AND SALE DEED, FILED FOR RECORD ON OCTOBER 28, 2013 AS DOCUMENT NUMBER 0832727

**COMMUNITY DEVELOPMENT DEPT. CERT.**

IT IS HEREBY CERTIFIED THAT THIS REVERSION TO ACREAGE WAS PRESENTED TO THE DOUGLAS COUNTY COMMUNITY DEVELOPMENT DEPARTMENT AND WAS DULY APPROVED. THERE ARE NO PUBLIC ROADS OR OTHER PUBLIC USE ELEMENTS OFFERED FOR DEDICATION AS PART OF THIS MAP.

*Steve Mason*  
 Steve Mason, Planner  
 11-16-17  
 DATE  
 COMMUNITY DEVELOPMENT DEPARTMENT

**TAHOE REGIONAL PLANNING AGENCY CERTIFICATE**

THIS REVERSION TO ACREAGE CONFORMS TO TAHOE REGIONAL PLANNING AGENCY REQUIREMENTS.

N/A  
 SIGNATURE DATE  
 PRINT NAME

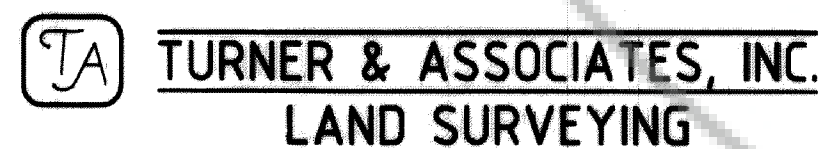

TURNER & ASSOCIATES, INC.  
 LAND SURVEYING  
 (775) 588-5658  
 FAX (775) 588-9296  
 308 DORLA COURT, SUITE 203 - ROUND HILL, NEVADA 89448  
 P.O. BOX 5067 - STATILINE, NEVADA 89449

**COUNTY ENGINEER CERTIFICATE**

I, ERIK NILSSEN, COUNTY ENGINEER, DO HEREBY CERTIFY THAT I HAVE EXAMINED THIS PLAT AND IT IS TECHNICALLY CORRECT.

*Erik Nilsson*  
 Erik Nilsson, P.E., COUNTY ENGINEER  
 11-16-17  
 DATE

**CLERK TREASURER'S CERTIFICATE**

ALL PROPERTY TAXES FOR THE PARCELS SHOWN ON THIS MAP HAVE BEEN PAID IN FULL FOR THE FISCAL TAX YEAR. ASSESSOR'S PARCEL NUMBER(S): 1318-10-310-012.

*Kathy Lewis*  
 KATHY LEWIS,  
 DOUGLAS COUNTY CLERK / TREASURER  
 BY: *Leann Tetel*  
 Leann Tetel  
 Senior Deputy Treasurer  
 11/22/17  
 DATE

**NOTES**

THIS MAP IS BEING FILED TO DELINEATE "DELETED" PROPERTY LINES AS DESCRIBED IN THAT GRANT, BARGAIN AND SALE DEED RECORDED ON OCTOBER 28, 2013 AS DOCUMENT NUMBER 2013-0832727, OFFICIAL RECORDS OF DOUGLAS COUNTY, NEVADA.

WEST 1/2 OF LOT 10

EAST 1/2 OF LOT 10

DAVID L. SCOTT  
 REVOCABLE TRUST  
 PER DOC. NO.  
 2013-0832727  
 37,442 SQ. FT.

PROPERTY LINE EXTENDED TO APPROX. LOW WATER LINE OF LAKE TAHOE PER NRS 321.595

**COUNTY RECORDER'S CERTIFICATE**

FILED FOR RECORD THIS 27<sup>th</sup> DAY OF November, 2017  
 AT 4 MINUTES PAST 11 O'CLOCK a. M., AS  
 DOCUMENT NUMBER 2017-907291  
 RECORDED AT THE REQUEST OF DAVID L. SCOTT.  
*Shannon DeCove*  
 SHANNON DECOVE  
 DOUGLAS COUNTY RECORDER

SCALE: 1"=20' SHEET 1 OF 1

**REVERSION TO ACREAGE**  
 FOR  
 DAVID L. SCOTT  
 PORTION OF SECTION 10, T.13N., R.18E., M.D.M.  
 BEING LOT 9 & THE EAST 1/2 LOT 10. BLK. F OF  
 AMENDED MAP OF ZEPHYR COVE PROPERTY  
 DOUGLAS COUNTY, NEVADA

FILE NO. 13128 Rev to Acreage.DWG NOVEMBER 2017