

LEGEND

- FOUND 5/8" REBAR WITH PLASTIC CAP PLS 3209
- ⊗ SET NAIL & WASHER PLS 11172
- FOUND 5/8" REBAR NO REFERENCE
- FOUND POSITION AS INDICATED
- ⊙ DIMENSION POINT, NOTHING FOUND OR SET
- △ SET 5/8" REBAR WITH PLASTIC CAP PLS 11172
- ▲ FOUND 5/8" REBAR NO REFERENCE, SET PLASTIC CAP PLS 11172
- (C) CALCULATED POSITION
- (M) MEASURED POSITION
- (R) RECORD INFORMATION PER REFERENCED DOCUMENT
- (1) ORIGINAL LOT NUMBER PER MAP OF MINDEN (R1)

NOTES

AREA: A.P.N. 1920-32-111-052 = 10,500 SF
 A.P.N. 1920-32-111-093 = 7,946 SF

THIS RECORD OF SURVEY HAS BEEN PREPARED TO INDICATE THE LIMITS OF A.P.N.'S 1920-32-111-052 & 1920-32-111-093.

THIS MAP IS NOT IN CONFLICT WITH N.R.S. 278.010 TO 278.630 INCLUSIVE.

REFERENCE DOCUMENTS

- (R1) MAP OF MINDEN, RECORDED BOOK B MISC, AT PAGE 215
- (R2) RECORD OF SURVEY FOR DOUGLAS COUNTY RECORDED IN BOOK 0406, AT PAGE 3620, AS DOCUMENT NO. 672497
- (R3) RECORD OF SURVEY FOR FRANCISCO AND MARISOL SANCHEZ RECORDED AS DOCUMENT NO. 2014-849853
- (R4) RECORD OF SURVEY FOR DONALD G. PARK RECORDED IN BOOK 0607, AT PAGE 9473, AS DOCUMENT NO. 701997
- (R5) RECORD OF SURVEY FOR PIONEER MOTOR CO. RECORDED IN BOOK 594, AT PAGE 899, AS DOCUMENT NO. 336892
- (R6) GRANT DEED RECORDED IN BOOK 914, AT PAGE 3795, AS DOCUMENT NO. 849706
- (R7) GRANT DEED RECORDED IN BOOK 1180, AT PAGE 490, AS DOCUMENT NO. 50610

BASIS OF BEARING

N63°25'00"W - THE SOUTHERLY LINE OF BLOCKS 'H' & 'M' AS SHOWN ON THE MAP OF MINDEN DATED JULY OF 1906 IN BOOK B MISC, AT PAGE 215.

SURVEYOR'S CERTIFICATE

I, MATTHEW P. BERNARD, A PROFESSIONAL LAND SURVEYOR LICENSED IN THE STATE OF NEVADA CERTIFY THAT:

- 1) THIS PLAT REPRESENTS THE RESULTS OF A SURVEY CONDUCTED UNDER MY DIRECT SUPERVISION AT THE INSTANCE OF WILLIAM J. & PAIGE SHAW.
- 2) THE LANDS SURVEYED LIE WITHIN A PORTION OF SECTION 32, T.13N., R.20E., M.D.M. AND THE SURVEY WAS COMPLETED ON JANUARY 11, 2018.
- 3) THIS PLAT COMPLIES WITH THE APPLICABLE STATE STATUTES AND ANY LOCAL ORDINANCE IN EFFECT ON THE DATE THAT THE SURVEY WAS COMPLETED.
- 4) THE MONUMENTS DEPICTED ON THE PLAT ARE OF THE CHARACTER SHOWN, OCCUPY THE POSITIONS INDICATED AND ARE OF SUFFICIENT NUMBER AND DURABILITY.

Matthew P. Bernard
 MATTHEW P. BERNARD, P.L.S. 11172

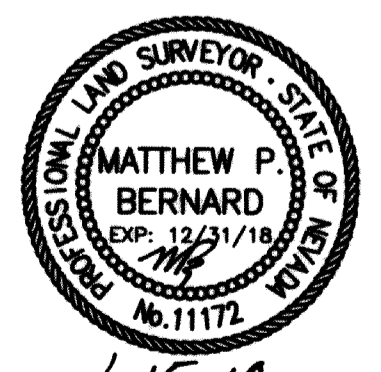

RECORDER'S CERTIFICATE

FILED FOR RECORD THIS 17 DAY OF January, 2018, AT 44 MINUTES PAST 10 O'CLOCK A.M., AS DOCUMENT NO. 2018-909252 OF OFFICIAL RECORDS. RECORDED AT THE REQUEST OF WILLIAM J. & PAIGE SHAW.

Sherrilee Larren, Deputy
 DOUGLAS COUNTY RECORDER

SCALE: 1" = 40' SHEET 1 OF 1

RECORD OF SURVEY
 OF
 LOTS 1,2,3 & 4 OF BLOCK 'R'
 AND LOTS 10,11,12 & 13 OF BLOCK 'N'
 MAP OF MINDEN, BK. B, PG. 215
 FOR
WILLIAM J. & PAIGE SHAW
 LOCATED WITHIN A PORTION OF SECTION 32,
 T.13N., R.20E., M.D.M.
 DOUGLAS COUNTY, NEVADA

2437-001
 2437-001RCS.dwg
 01/12/18

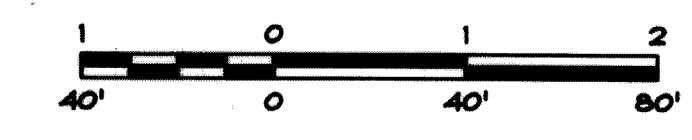

R|O Anderson
 www.roanderson.com

MINDEN
 1629 Esmeralda Ave
 P.O. Box 2224
 Minden, NV 89423
 P 775.782.2322
 F 775.782.7084

RENO
 140 W. Huffaker Lane
 Suite 507
 Reno, NV 89501
 P 775.782.2322
 F 775.782.7084