

DOUGLAS COUNTY, NV

2018-910351

RPTT:\$390.00 Rec:\$35.00

\$425.00 Pgs=3

02/13/2018 02:00 PM

TICOR TITLE - GARDNERVILLE

KAREN ELLISON, RECORDER

WHEN RECORDED MAIL TO:

Jeffrey James LeGrand and Shelley Lynn LeGrand,
Trustees of the Family Trust of Jeffrey James LeGrand
and Shelley Lynn LeGrand dated February 14, 2002

10851 Beltramo Circle

Riverside, CA 92503

MAIL TAX STATEMENTS TO:

Jeffrey James LeGrand and Shelley Lynn LeGrand,
Trustees of the Family Trust of Jeffrey James LeGrand
and Shelley Lynn LeGrand dated February 14, 2002
10851 Beltramo Circle

Riverside, CA 92503

Escrow No. 1800531-RLT

The undersigned hereby affirms that this document
submitted for recording does not contain the social
security number of any person or persons.
(Pursuant to NRS 239b.030)

APN No.: 1022-18-002-070

SPACE ABOVE FOR RECORDER'S USE ONLY

R.P.T.T. \$ 390 00

GRANT, BARGAIN, SALE DEED

THIS INDENTURE WITNESSETH: That Linda Bartlett and Bruce Bartlett, Trustees of The Linda and Bruce Bartlett Living Trust dated March 12, 2007

FOR A VALUABLE CONSIDERATION, receipt of which is hereby acknowledged, do/does hereby Grant, Bargain, Sell and Convey to Jeffrey James LeGrand and Shelley Lynn LeGrand, Trustees of the Family Trust of Jeffrey James LeGrand and Shelley Lynn LeGrand dated February 14, 2002

all that real property situated in the County of Douglas, State of Nevada, described as follows:

SEE EXHIBIT "A" ATTACHED HERETO AND BY REFERENCE MADE A PART HEREOF

Together with all and singular the tenements, hereditaments and appurtenances thereunto belonging or in anywise appertaining.

Linda Bartlett and Bruce Bartlett, Trustees
of The Linda and Bruce Bartlett Living
Trust dated March 12, 2007

Linda Bartlett, Trustee
Linda Bartlett, Trustee
Bruce Bartlett, TRUSTEE
Bruce Bartlett, Trustee

STATE OF ~~NEVADA~~ CALIFORNIA
COUNTY OF ~~DOUGLAS~~ SANTA CRUZ

(P)

} ss.

This instrument was acknowledged before me on FEBRUARY 10, 2019
by Linda Bartlett and Bruce Bartlett, Trustees of The Linda and Bruce Bartlett Living Trust dated March 12, 2007

Terry N. Osterdock
NOTARY PUBLIC

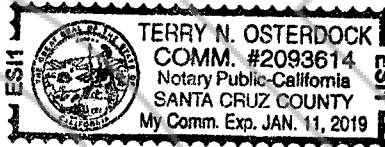

Escrow No. 1800531-RLT

**EXHIBIT A
LEGAL DESCRIPTION**

All that certain real property situate in the County of Douglas, State of Nevada, described as follows:

Lot 8 of Final Subdivision Map LDA 04 064 for HOLBROOK ESTATES filed for record in the office of the Douglas County Recorder on November 2, 2006 in Book 1106, Page 839, Document No. 687834.

APN: 1022-18-002-070

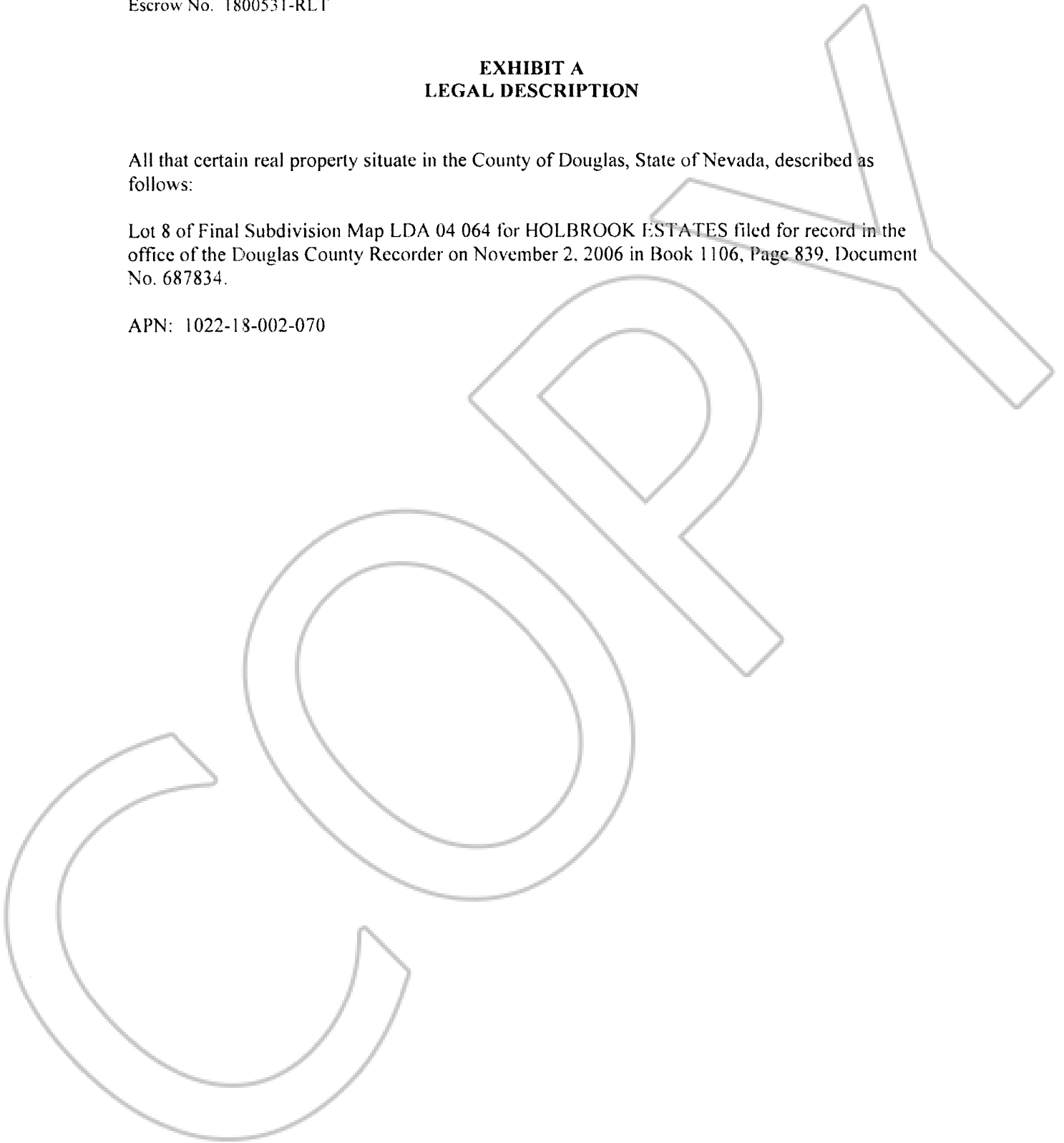

**STATE OF NEVADA
DECLARATION OF VALUE FORM**

1. Assessor Parcel Number(s)
 a. 1022-18-002-070
 b. _____
 c. _____
 d. _____

2. Type of Property:
 a. Vacant Land b. Single Fam. Res.
 c. Condo/Twnhse d. 2-4 Plex
 e. Apt. Bldg f. Comm'l/Ind'l
 g. Agricultural h. Mobile Home
 i. Other _____

| | |
|---------------------------------|------------|
| FOR RECORDERS OPTIONAL USE ONLY | |
| Book _____ | Page _____ |
| Date of Recording: _____ | |
| Notes: _____ | |

3. a. Total Value/Sales Price of Property: \$ 100,000.00
 b. Deed in Lieu of Foreclosure Only (value of property) \$ _____
 c. Transfer Tax Value \$ 100,000.00
 d. Real Property Transfer Tax Due: \$ 390.00

4. **If Exemption Claimed**
 a. Transfer Tax Exemption, per NRS 375.090, Section _____
 b. Explain Reason for Exemption: _____

5. Partial Interest: Percentage being transferred: 100%

The undersigned declares and acknowledges, under penalty of perjury, pursuant to NRS 375.060 and NRS 375.110, that the information provided is correct to the best of their information and belief, and can be supported by documentation if called upon to substantiate the information provided herein. Furthermore, the parties agree that disallowance of any claimed exemption, or other determination of additional tax due, may result in a penalty of 10% of the tax due plus interest at 1% per month. Pursuant to NRS 375.030, the Buyer and Seller shall be jointly and severally liable for any additional amount owed.

Signature Linda & Bruce Bartlett Capacity OWNERS
 Signature Bruce Capacity OWNER

**SELLER (GRANTOR) INFORMATION
(REQUIRED)**

Print Name: Linda Bartlett and Bruce Bartlett,
Trustees of The Linda and Bruce Bartlett Living
Trust dated March 12, 2007

Address: 1290 SANDSTONE
 City: WELLINGTON, NV
 State: Zip: 89444

**BUYER (GRANTEE) INFORMATION
(REQUIRED)**

Print Name: Jeffrey James LeGrand and Shelley
Lynn LeGrand, Trustees of the Family Trust of
Jeffrey James LeGrand and Shelley Lynn LeGrand
dated February 14, 2002

Address: 10851 Beltramo Circle
 City: Riverside
 State: CA Zip: 92503

COMPANY/PERSON REQUESTING RECORDING (Required if not Seller or Buyer)

Print Name: Ticor Title of Nevada, Inc. Escrow No.: 01800531-020-RLT
 Address: 1483 Highway 395 N, Suite B
 City, State, Zip: Gardnerville, NV 89410

AS A PUBLIC RECORD THIS FORM MAY BE RECORDED/MICROFILMED