

DOUGLAS COUNTY, NV **2018-913827**
RPTT:\$1288.95 Rec:\$35.00
\$1,323.95 Pgs=3 05/04/2018 01:02 PM
SIGNATURE TITLE - ZEPHYR COVE
KAREN ELLISON, RECORDER

APN: 1419-04-002-054

**RECORDING REQUESTED BY:
SIGNATURE TITLE COMPANY,
LLC
212 ELKS POINT RD, STE 445
P.O. BOX 10297
ZEPHYR COVE, NV 89448**

**MAIL RECORDABLE DOCS AND
TAX STATEMENTS TO:
DAVID MARTIN BROOKS AND
LORI LYNN BROOKS, TRUSTEES
OF THE BROOKS FAMILY TRUST
DATED JULY 18, 2007
2895 GLENVIEW WAY
ESCONDIDO, CA 92025**

ESCROW NO: 11000312-ZCT

RPTT \$1,288.95

GRANT, BARGAIN, SALE DEED

THIS INDENTURE WITNESSETH: That Clear Creek Residential, LLC a Delaware Limited Liability Company

FOR A VALUABLE CONSIDERATION, receipt of which is hereby acknowledged, do/does hereby Grant, Bargain, Sell, and Convey to:

David Martin Brooks and Lori Lynn Brooks, Trustees of the Brooks Family Trust Dated July 18, 2007

all that real property situated in the City of Carson City, County of Douglas, State of Nevada, described as follows:

See Exhibit A attached hereto and made a part hereof.

Together with all and singular the tenements, hereditaments and appurtenances thereunto belonging or in anywise appertaining.

Clear Creek Residential, LLC
By: CH-B Clear Creek, LLC
Its Manager

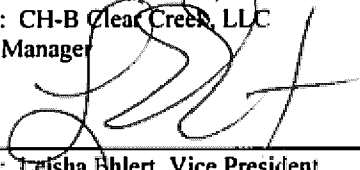

By: Leisha Ehlert, Vice President

STATE OF TEXAS
COUNTY OF TRAVIS

} ss:

This instrument was acknowledged before me on April 27TH 2018.

by LEISHA EHLERT

Notary Public (seal)

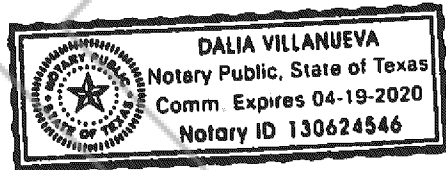

Exhibit A

Parcel 1:

Lot 207 of the Final Map for CLEAR CREEK TAHOE - PHASE IA & IB, Subdivision Map No. 890939, recorded in the Office of the Douglas County Recorder on November 18, 2016, as Document No. 2016-890939.

Parcel 2:

Easements granted in that certain Master Declaration of Covenants, Conditions, and Restrictions and Reservation of Easements for Clear Creek Tahoe, recorded September 27, 2016 as Document No. 2016-888265, Official Records.

APN: 1419-04-002-054

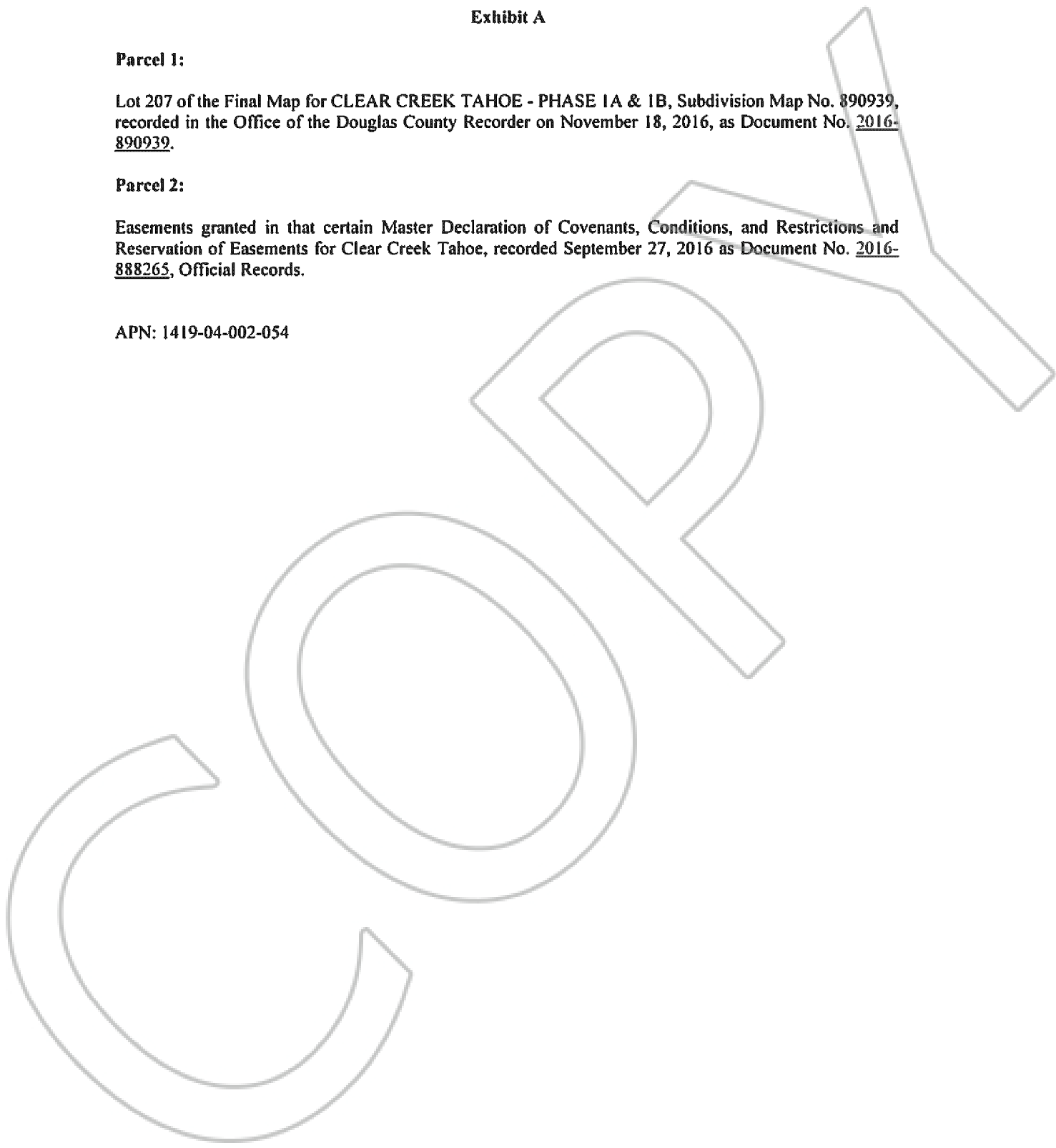

**STATE OF NEVADA
DECLARATION OF VALUE FORM**

1. Assessor Parcel Number(s)

- a) 1419-04-002-054
- b) _____
- c) _____
- d) _____

2. Type of Property:

- a) Vacant Land
- b) Single Fam. Res.
- c) Condo/Twnhse
- d) 2-4 Plex
- e) Apt. Bldg
- f) Comm'l/Ind'l
- g) Agricultural
- h) Mobile Home
- Other

FOR RECORDER'S OPTIONAL USE ONLY	
Book: _____	Page: _____
Date of Recording: _____	
Notes: _____	

3. Total Value/Sales Price of Property:

\$330,500.00

Deed in Lieu of Foreclosure Only (value of property) (_____)

Transfer Tax Value \$330,500.00

Real Property Transfer Tax Due: \$1,288.95

4. If Exemption Claimed

- a. Transfer Tax Exemption, per NRS 375.090, Section _____
- b. Explain Reason for Exemption: _____

5. Partial Interest: Percentage being transferred: _____ %

The undersigned declares and acknowledges, under penalty of perjury, pursuant to NRS 375.060 and NRS 375.110, that the information provided is correct to the best of their information and belief, and can be supported by documentation if called upon to substantiate the information provided herein. Furthermore, the parties agree that disallowance of any claimed exemption, or other determination of additional tax due, may result in a penalty of 10% of the tax due plus interest at 1% per month. Pursuant to NRS 375.030, the Buyer and Seller shall be jointly and severally liable for any additional amount owed.

Signature _____ Capacity Grantor

Signature David Martin Brooks, Trustee Capacity Grantee

SELLER (GRANTOR) INFORMATION

BUYER (GRANTEE) INFORMATION

(Required)

(Required)

Print Name: Clear Creek Residential, LLC a Delaware Limited Liability Company

Print Name: David Martin Brooks and Lori Lynn Brooks, Trustees of the Brooks Family Trust Dated July 18, 2007

Address: 199 Old Clear Creek Road Clear Creek, NV 89705

Address: 2895 Glenview Way Escondido, CA 92025

COMPANY/PERSON REQUESTING RECORDING (required if not seller or buyer)

Print Name: Signature Title Company LLC Escrow #: 11000312-ZCT

Address: 212 Elks Point Road, Suite 445, PO Box 10297 Zephyr Cove, NV 89448

AS A PUBLIC RECORD THIS FORM MAY BE RECORDED/MICROFILMED