

DOUGLAS COUNTY, NV

2018-913829

Rec:\$35.00

\$35.00

Pgs=3

05/04/2018 01:02 PM

SIGNATURE TITLE - ZEPHYR COVE

KAREN ELLISON, RECORDER

APN: 1419-04-002-054

WHEN RECORDED MAIL TO and
MAIL TAX STATEMENT TO:
CLEAR CREEK RESIDENTIAL, LLC
A DELAWARE LIMITED LIABILITY
COMPANY
199 OLD CLEAR CREEK ROAD
CLEAR CREEK, NV 89705

ESCROW NO: 11000312-ZCT

PARTIAL RECONVEYANCE

WHEREAS, the indebtedness to be paid, secured by the Deed of Trust executed by Clear Creek Residential, LLC a Delaware Limited Liability Company Trustors, to Sierra Clouds, LLC a Nevada Limited Liability Company, Substituted Trustee, for Sierra Clouds, LLC a Nevada Limited Liability Company Beneficiary, dated June 14, 2013 and recorded as Document No. 825396, in the office of the County Recorder of Douglas County, Nevada, on June 14, 2013, has been paid insofar as the hereinafter described property is affected thereby:

NOW, THEREFORE, Sierra Clouds, LLC a Nevada Limited Liability Company, Trustee, does hereby grant and reconvey unto the parties entitled thereto, without warranty, all the estate and interest derived to it under said Deed of Trust in the lands situate in the County of Douglas, State of Nevada, described as follows:

See Exhibit A attached hereto and made a part hereof.

As to all other property described in said Deed of Trust, the said Deed of Trust remains in full force and effect.

IN WITNESS WHEREOF, the said Trustee has caused its corporate name to be hereunto subscribed and its corporate seal affixed by its duly authorized officer this 23rd day of April, 2018.

Sierra Clouds, LLC a Nevada Limited Liability
Company

By: Nevada Rental Fund Ventures, LLC, a Nevada
Limited Liability Company
It's Manager:

BY 
John Serpa, Jr., Manager

Part



STATE OF NEVADA
~~COUNTY OF CLATSOP~~ CARSON CITY } SS:

This instrument was acknowledged before me on April 23, 2018
by John Serpa, Jr.

Wendy A. McMartin
NOTARY PUBLIC

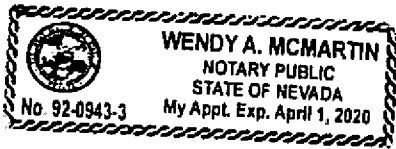

COPY

21

Exhibit A

Parcel 1:

Lot 207 of the Final Map for CLEAR CREEK TAHOE - PHASE 1A & 1B, Subdivision Map No. 890939, recorded in the Office of the Douglas County Recorder on November 18, 2016, as Document No. 2016-890939.

Parcel 2:

Easements granted in that certain Master Declaration of Covenants, Conditions, and Restrictions and Reservation of Easements for Clear Creek Tahoe, recorded September 27, 2016 as Document No. 2016-888265, Official Records.

APN: 1419-04-002-054

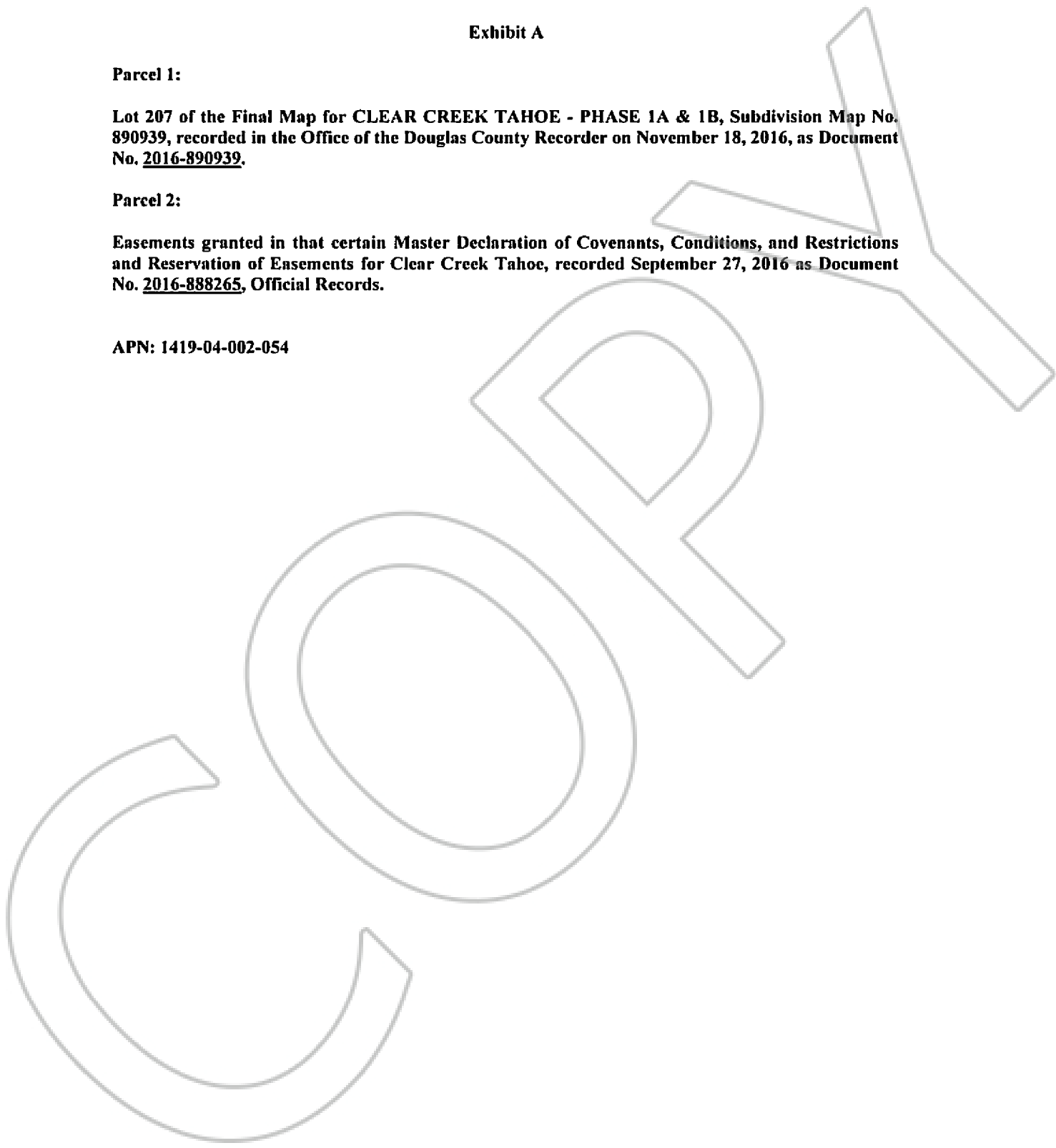

Handwritten initials