

DOUGLAS COUNTY, NV

2018-914836

Rec:\$35.00

\$35.00

Pgs=3

05/30/2018 11:09 AM

SIGNATURE TITLE - ZEPHYR COVE

KAREN ELLISON, RECORDER

APN: 1419-04-002-010

WHEN RECORDED MAIL TO and
MAIL TAX STATEMENT TO:
CLEAR CREEK RESIDENTIAL, LLC A
DELAWARE LIMITED LIABILITY
COMPANY
199 OLD CLEAR CREEK ROAD
CLEAR CREEK, NV 89705

ESCROW NO: 11000152-ZCT

PARTIAL RECONVEYANCE

WHEREAS, the indebtedness to be paid, secured by the Deed of Trust executed by Clear Creek Residential, LLC a Delaware Limited Liability Company Trustors, to Sierra Clouds, LLC a Nevada Limited Liability Company, Substituted Trustee, for Sierra Clouds, LLC a Nevada Limited Liability Company Beneficiary, dated June 14, 2013 and recorded as Document No. 825396, in the office of the County Recorder of Douglas County, Nevada, on June 14, 2013, has been paid insofar as the hereinafter described property is affected thereby:

NOW, THEREFORE, Sierra Clouds, LLC a Nevada Limited Liability Company, Trustee, does hereby grant and reconvey unto the parties entitled thereto, without warranty, all the estate and interest derived to it under said Deed of Trust in the lands situate in the County of Douglas, State of Nevada, described as follows:

See Exhibit A attached hereto and made a part hereof.

As to all other property described in said Deed of Trust, the said Deed of Trust remains in full force and effect.

IN WITNESS WHEREOF, the said Trustee has caused its corporate name to be hereunto subscribed and its corporate seal affixed by its duly authorized officer this 7th day of May, 2018.

Sierra Clouds, LLC a Nevada Limited Liability Company

By: Nevada Rental Fund Ventures, LLC, a Nevada Limited Liability Company
It's Manager

BY 
John Serpa, Jr., Manager

Pen



STATE OF NEVADA
COUNTY OF ~~Carson City~~ ^{Douglas} } SS:

This instrument was acknowledged before me on 05/07/2018
by JOHN SERPA JR.

T. Peterson
NOTARY PUBLIC

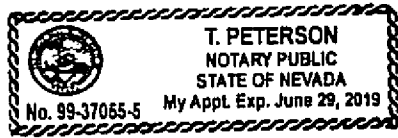

COPY

PH

Exhibit A

Parcel 1

Lot 194 of CLEAR CREEK TAHOE-PHASE 1A & 1B, according to the map thereof, filed in the office of the County Recorder of Douglas County, state of Nevada, on November 18, 2016, as File No. 2016-890939, Official Records, as amended by Certificate of Amendment recorded January 23, 2017, as File No. 2017-893667.

Parcel 2

Easements granted in that certain Master Declaration of Covenants, Conditions, and Restrictions and Reservation of Easements for Clear Creek Tahoe, recorded September 27, 2016 as Document No. 2016-888265, Official Records.

APN: 1419-04-002-010

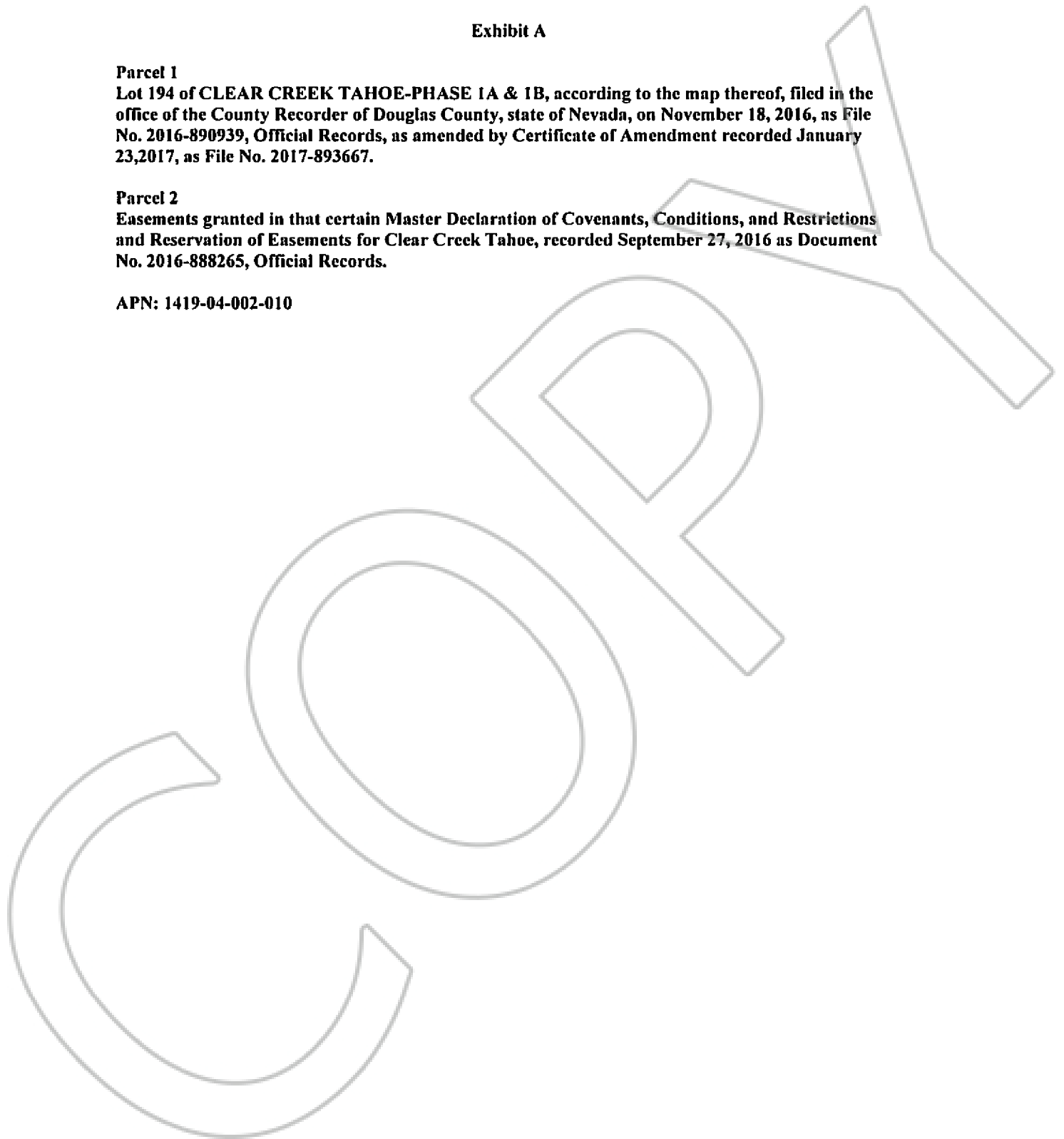

A small, handwritten signature or set of initials in black ink is located in the bottom right corner of the page.