

APN: 1418-34-110-042

Recording Requested By and
When Recorded Mail To:

Lance N. McKenzie, Esq.
McDonald Carano, LLP
P. O. Box 2670
Reno, NV 89505

Grantee's Address Is and
Mail Tax Statements To:

Jean M. Rottman, Trustee
The Jean M. Rottman Trust
450 Anitra Drive
Reno, Nevada 89511

DOUGLAS COUNTY, NV
RPTT:\$0.00 Rec:\$35.00
\$35.00 Pgs=3
MCDONALD CARANO LLP
KAREN ELLISON, RECORDER
2018-915159
06/06/2018 02:35 PM
E07

The undersigned hereby affirms that this document submitted for recording does not contain the personal information of any person or persons per N.R.S. 239B.030.

QUITCLAIM DEED

THIS DEED is entered into this 4th day of June, 2018, by and between JEAN M. ROTTMAN, as Grantor, and JEAN M. ROTTMAN, Trustee of The JEAN M. ROTTMAN TRUST, dated April 12, 2018, as Grantee.

Grantor, without consideration, hereby quitclaims and conveys to the Grantee, and to its successors, all of its right, title and interest, which comprises of an undivided fifty percent (50%) interest, in and to that certain real property situate in County of Douglas, State of Nevada, and particularly described as Exhibit "A" attached hereto.

TOGETHER WITH the tenements, hereditaments, improvements and appurtenances, including easements and water rights, if any, thereunto belonging or appertaining, and any reversions, remainders, rents, issues and profits thereof.

TO HAVE AND TO HOLD with all the appurtenances, unto the Grantee, and to its successors in trust.

IN WITNESS WHEREOF, the Grantor has hereunto set her hand on the day and year first above written.

Jean M. Rottman
JEAN M. ROTTMAN

STATE OF NEVADA)
) ss:
COUNTY OF WASHOE)

This instrument was acknowledged before me on June 4, 2018, by
JEAN M. ROTTMAN.

Courtney Edwards
Notary Public

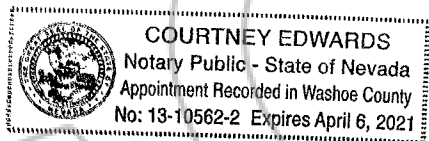
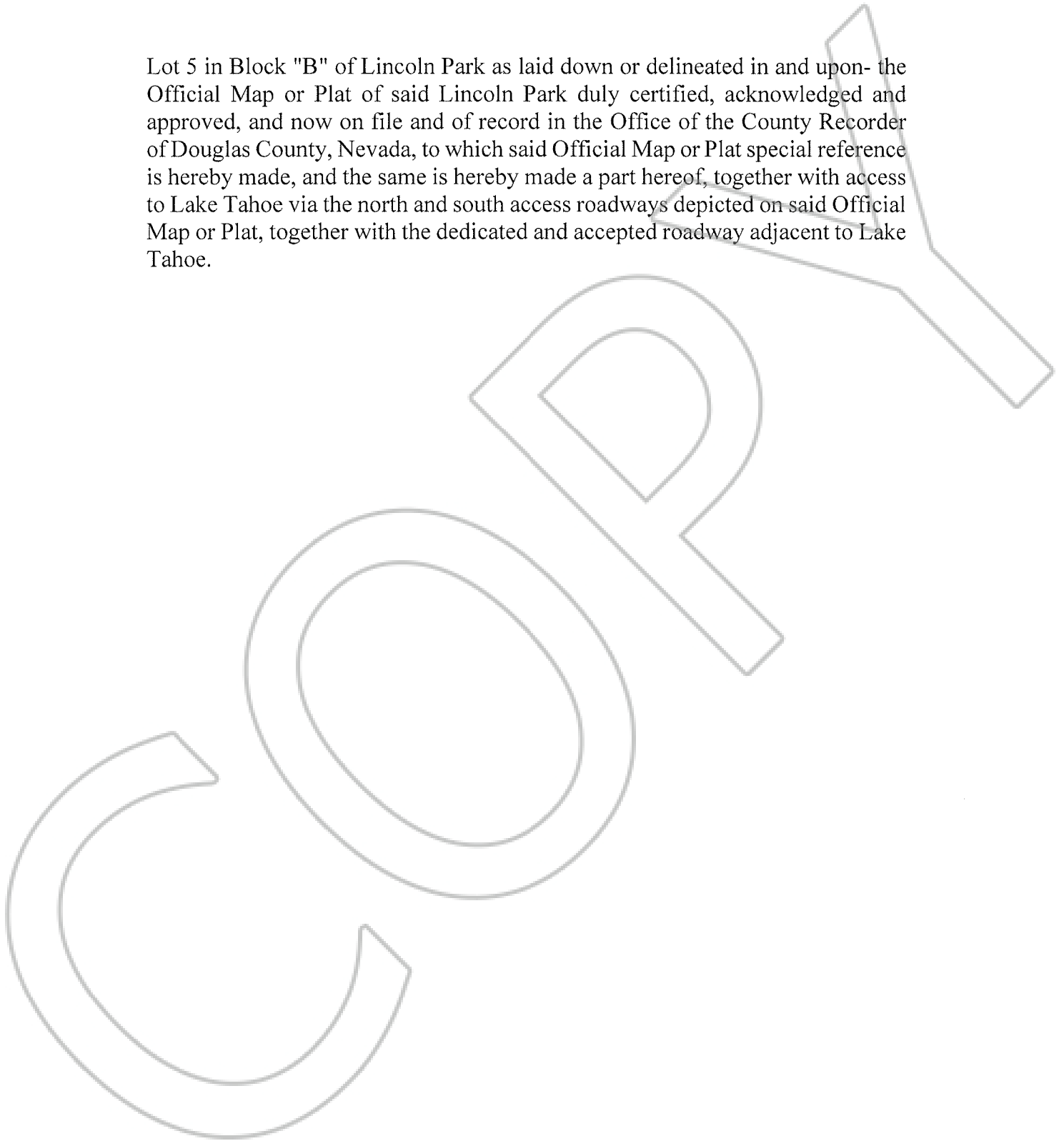

Exhibit "A"
Legal Description

Lot 5 in Block "B" of Lincoln Park as laid down or delineated in and upon- the Official Map or Plat of said Lincoln Park duly certified, acknowledged and approved, and now on file and of record in the Office of the County Recorder of Douglas County, Nevada, to which said Official Map or Plat special reference is hereby made, and the same is hereby made a part hereof, together with access to Lake Tahoe via the north and south access roadways depicted on said Official Map or Plat, together with the dedicated and accepted roadway adjacent to Lake Tahoe.



STATE OF NEVADA DECLARATION OF VALUE

1. Assessor Parcel Number (s)

- a) 1418-34-110-042
- b) _____
- c) _____
- d) _____

2. Type of Property:

- | | | | |
|-----------------------------|--------------|--|-----------------|
| a) <input type="checkbox"/> | Vacant Land | b) <input checked="" type="checkbox"/> | Single Fam Res. |
| c) <input type="checkbox"/> | Condo/Twnhse | d) <input type="checkbox"/> | 2-4 Plex |
| e) <input type="checkbox"/> | Apt. Bldg. | f) <input type="checkbox"/> | Comm'l/Ind'l |
| g) <input type="checkbox"/> | Agricultural | h) <input type="checkbox"/> | Mobile Home |
| i) <input type="checkbox"/> | Other | | |

FOR RECORDERS OPTIONAL USE ONLY
Notes: Verified Trust

3. Total Value/Sales Price of Property:

Deed in Lieu of Foreclosure Only (value of property) \$ _____
 Transfer Tax Value: \$ _____
 Real Property Transfer Tax Due: \$ _____

4. If Exemption Claimed:

- a. Transfer Tax Exemption, per NRS 375.090, Section: 7
- b. Explain Reason for Exemption: This property is being transferred to The Jean M. Rottman Trust without Consideration.

5. Partial Interest: Percentage being transferred: 50 %

The undersigned declares and acknowledges, under penalty of perjury, pursuant to NRS 375.060 and NRS 375.110, that the information provided is correct to the best of their information and belief, and can be supported by documentation if called upon to substantiate the information provided herein. Furthermore, the disallowance of any claimed exemption, or other determination of additional tax due, may result in a penalty of 10% of the tax due plus interest at 1% per month.

Pursuant to NRS 375.030, the Buyer and Seller shall be jointly and severally liable for any additional amount owed.

Signature [Signature] Capacity for Grantor/Grantee
 Signature _____ Capacity _____

SELLER (GRANTOR) INFORMATION

(REQUIRED)

Print Name: Jean M. Rottman
 Address: 450 Anita Drive
 City: Reno
 State: NV Zip: 89511

BUYER (GRANTEE) INFORMATION

(REQUIRED) Jean M. Rottman, Trustee

Print Name: The Jean M. Rottman Trust
 Address: 450 Anita Drive
 City: Reno
 State: NV Zip: 89511

COMPANY/PERSON REQUESTING RECORDING

(REQUIRED IF NOT THE SELLER OR BUYER)

Print Name: McDonald Carano LLP Escrow # _____
 Address: P.O. Box 2670
 City: Reno State: NV Zip: 89505

(AS A PUBLIC RECORD THIS FORM MAY BE RECORDED)