

Assessor's Parcel Number: N/A

Date: JUNE 12, 2018

Recording Requested By:

Name: AUBREY BOUDREAU/COMMUNITY DEVELOPMENT

Address: \_\_\_\_\_

City/State/Zip: \_\_\_\_\_

Real Property Transfer Tax: \$ N/A



00074758201809154180030031

KAREN ELLISON, RECORDER

CERTIFICATE OF AMENDMENT #2018.103

(Title of Document)

FILED

NO. 2018-103

2018 JUN 12 AM 9:11

DOUGLAS COUNTY  
CLERK

*[Signature]*

After Recordation Return to:  
Manhard Consulting  
Attn. Jerry Juarez, PLS  
9850 Double R Boulevard, Suite 100  
Reno, Nevada 89521

---

**CERTIFICATE OF AMENDMENT**

May 8, 2018

Mr. Greg Phillips, P.L.S.  
Douglas County Surveyor  
800 East College Pkwy  
Carson City, NV 89706

Re: Record of Survey in Support of a Boundary Line Adjustment for Clear Creek Residential, LLC, recorded September 15, 2017 as File No. 2017-904050, Official Records of Douglas County, Nevada, situate in Sections 3, 4, and 10, Township 14 North, Range 19 East, Mount Diablo Base and Meridian.

Dear Mr. Phillips:

In accordance with NRS 278.473, I am notifying you of the following corrections to the above referenced map.

1. The triangle symbol shown in the legend is described as "FOUND 5/8" REBAR W/ CAP "PLS 17044". The description for the symbol should read "DIMENSION POINT, NOTHING FOUND OR SET".
2. A 5/8" rebar capped "PLS 5665" was found at the following locations:
  - a) The Northeast corner of Lot 19
  - b) The most Northerly corner of Lot 14
  - c) The Southwest corner of Lot 21-A
  - d) The Northwest corner of Lot 13

3. A 5/8" rebar capped "PLS 17044" was found at the following locations:
- a) Each end point of the line bearing North 38°21'31" East, 45.00 feet, shown in Detail C on sheet 6 of 8.

The corrections of these errors and omissions do not change or purport to change the physical location of any monument, property line or boundary line.

Respectfully Submitted,

Gerald D. Juarez  
Nevada PLS 12140  
For and on behalf of



9850 DOUBLE R BLVD, SUITE 101  
RENO, NEVADA 89521  
(775) 743-3500

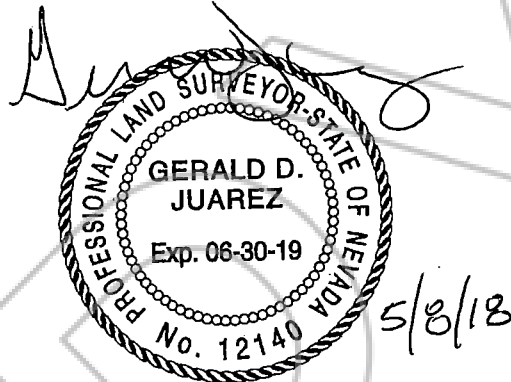

Douglas County Surveyor's statement:

I hereby certify that I have examined the certificate of amendment and that the changes to the original document specified therein are provided for in applicable sections of NRS 278.010 to 278.630 inclusive, 625.340 to 625.380 inclusive, and local ordinances adopted pursuant thereto, and I am satisfied that this certificate of amendment so amends or corrects the document as to make it technically correct.

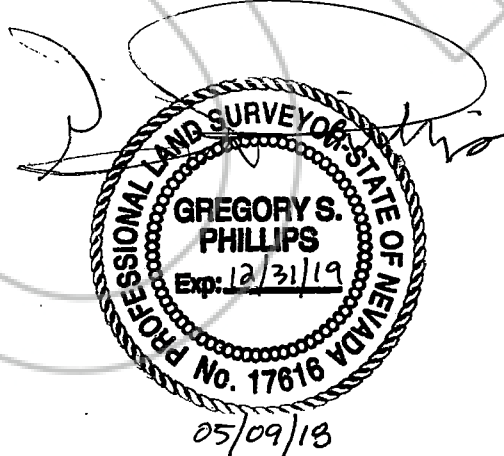

Greg Phillips, P.L.S.  
Douglas County Surveyor

Douglas County State of Nevada

CERTIFIED COPY

I certify that the document to which this certificate is attached is a full and correct copy of the original record on file in the Clerk/Treasurer's Office on this

12th day of June, 2018  
By *[Signature]* Deputy