

DOUGLAS COUNTY, NV

2018-915733

Rec:\$35.00

\$35.00 Pgs=3

06/19/2018 12:47 PM

SIGNATURE TITLE - ZEPHYR COVE

KAREN ELLISON, RECORDER

APN: 1419-04-002-019

WHEN RECORDED MAIL TO and
MAIL TAX STATEMENT TO:
CLEAR CREEK RESIDENTIAL, LLC
A DELAWARE LIMITED LIABILITY
COMPANY
199 OLD CLEAR CREEK
CLEAR CREEK, NV 89705

ESCROW NO: 11000143-ZCT

PARTIAL RECONVEYANCE

WHEREAS, the indebtedness to be paid, secured by the Deed of Trust executed by Clear Creek Residential, LLC a Delaware Limited Liability Company Trustees, to Sierra Clouds, LLC a Nevada Limited Liability Company, Substituted Trustee, for Sierra Clouds, LLC, a Nevada Limited Liability Company, beneficiary, dated June 14, 2013 and recorded as Document No. 825396, in the office of the County Recorder of Douglas County, Nevada, on June 14, 2013, has been paid insofar as the hereinafter described property is affected thereby:

NOW, THEREFORE, Sierra Clouds, LLC a Nevada Limited Liability Company, Trustee, does hereby grant and reconvey unto the parties entitled thereto, without warranty, all the estate and interest derived to it under said Deed of Trust in the lands situate in the County of Douglas, State of Nevada, described as follows:

See Exhibit A attached hereto and made a part hereof.

As to all other property described in said Deed of Trust, the said Deed of Trust remains in full force and effect.

IN WITNESS WHEREOF, the said Trustee has caused its corporate name to be hereunto subscribed and its corporate seal affixed by its duly authorized officer this 30th day of May, 2018.

Sierra Clouds, LLC a Nevada Limited Liability
Company

By: Nevada Rental Fund Ventures, LLC, a Nevada
Limited Liability Company
It's Manager

BY



John Seppa, Jr., Manager

Part

STATE OF NEVADA
~~COUNTY OF DOUGLAS~~ CARSON CITY } SS:

This instrument was acknowledged before me on May 30, 2018

by John Serpa, Jr.

Wendy A. McMartin
NOTARY PUBLIC

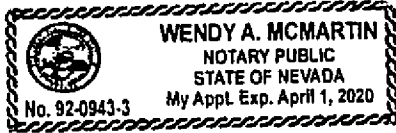

COPY

A small, handwritten mark or signature in the bottom right corner of the page.

Exhibit A

Parcel

Lot 185 of CLEAR CREEK TAHOE-PHASE 1A & 1B, according to the map thereof, filed in the office of the County Recorder of Douglas County, state of Nevada, on November 18, 2016, as File No. 2016-890939, Official Records, as amended by Certificate of Amendment recorded January 23, 2017, as File No. 2017-893667.

Parcel

Easements granted in that certain Master Declaration of Covenants, Conditions, and Restrictions and Reservation of Easements for Clear Creek Tahoe, recorded September 27, 2016 as Document No. 2016-888265, Official Records.

APN: 1419-04-002-019

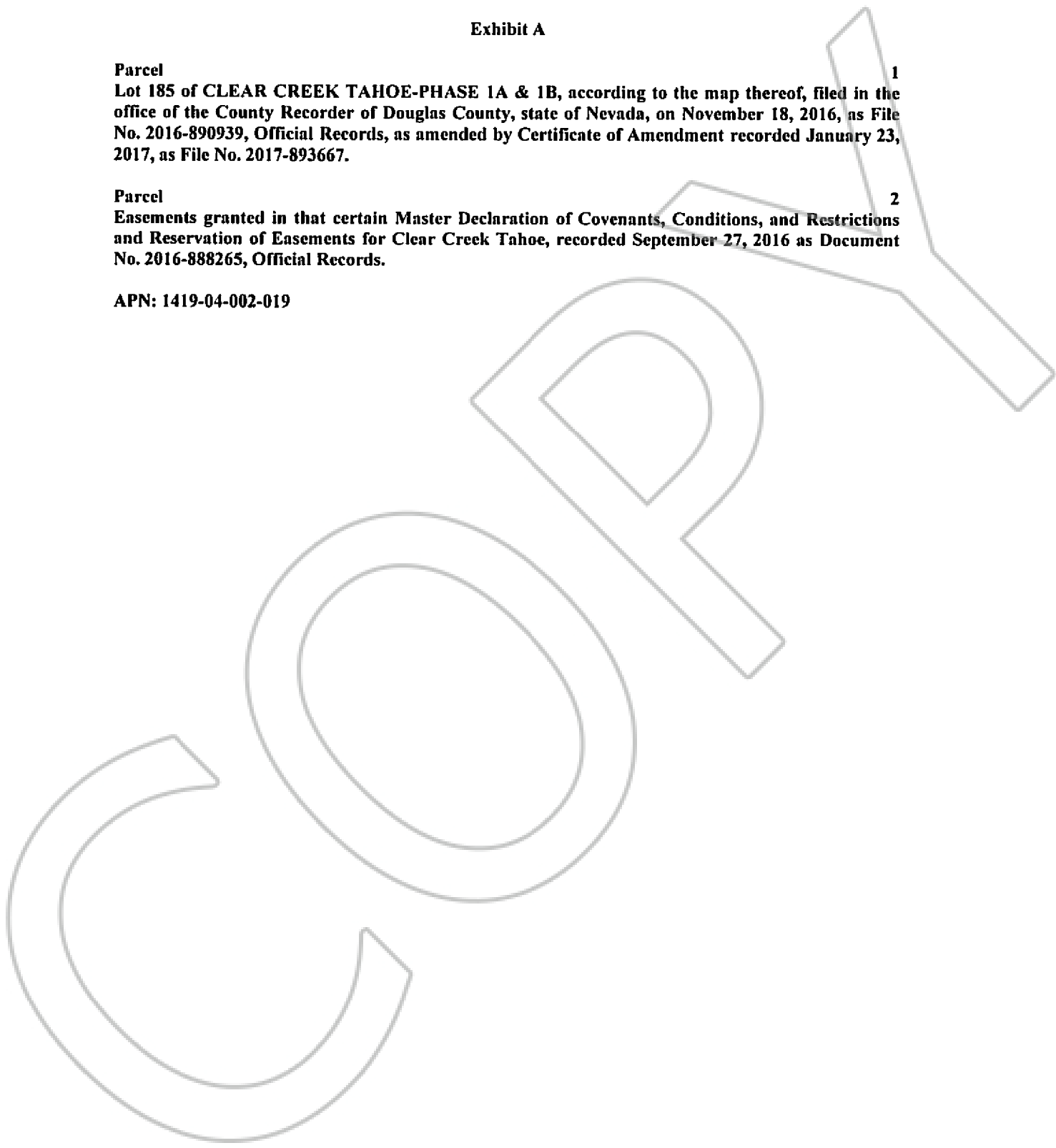

A small, handwritten signature or set of initials in black ink is located in the bottom right corner of the page.