

DOUGLAS COUNTY, NV
RPTT:\$4017.00 Rec:\$35.00
\$4,052.00 Pgs=4
ETRCO
KAREN ELLISON, RECORDER

2018-917985

08/13/2018 09:44 AM

APN# : 1320-36-002-054

RPTT: \$4,017.00

Recording Requested By:

Western Title Company

Escrow No.: 098501-WLD

When Recorded Mail To:

Pierrugues-Chanu, LLC, a Nevada
limited liability company

P.O. Box 2710

Minden, NV 89423

Mail Tax Statements to: (deeds only)

Same as Above

I the undersigned hereby affirm that the attached document, including any exhibits, hereby submitted
for recording does not contain the social security number of any person or persons.

(Per NRS 229B.030)

Signature _____

Wendy Dunbar

Escrow Officer

Grant, Bargain, and Sale Deed

This page added to provide additional information required by NRS 111.312
(additional recording fee applies)

GRANT, BARGAIN AND SALE DEED

THIS INDENTURE WITNESSETH: That

FOR A VALUABLE CONSIDERATION, receipt of which is hereby acknowledged,

Laurence M. Small and Evelyn E. Small, husband and wife as community property with right of survivorship

do(es) hereby GRANT(s) BARGAIN SELL and CONVEY to

Pierrugues-Chanu, LLC, a Nevada limited liability company

and to the heirs and assigns of such Grantee forever, all the following real property situated in the City of Gardnerville, County of Douglas State of Nevada bounded and described as follows:

See attached Exhibit A

TOGETHER with all tenements, hereditaments and appurtenances, if any, thereto belonging or appertaining, and any reversions, remainders, rents, issues or profits thereof.

Dated: 08/03/2018



Laurence M. Small

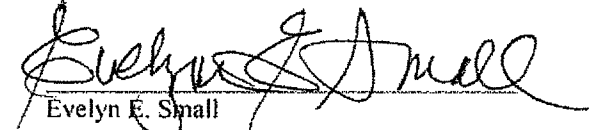

Evelyn E. Small

STATE OF Nevada }
COUNTY OF Douglas } ss
This instrument was acknowledged before me on

8.8.18

By Laurence M. Small and Evelyn E. Small.

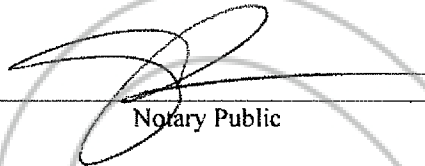

Notary Public



EXHIBIT "A"

All that certain real property situate in the County of Douglas, State of Nevada, described as follows:

A portion of Parcel 8-C and 8-D, as set forth on Parcel Map No. 2 for K.W. Emerson, Inc., according to the map thereof, filed in the office of the County Recorder of Douglas County, State of Nevada, on February 27, 1990, in Book 290, Page 3907, Document No. 220873, Official Records, further described as follows:

Parcel 1 as set forth on Parcel Map LDA 01-072 for Rouse Living Trust and David T. and Debra L. McNeil, according to the map thereof, filed in the office of the County Recorder of Douglas County, State of Nevada, on January 30, 2002, in Book 102, Page 8892, Document No. 533508, Official Records.

**Assessor's Parcel Number(s):
1320-36-002-054**

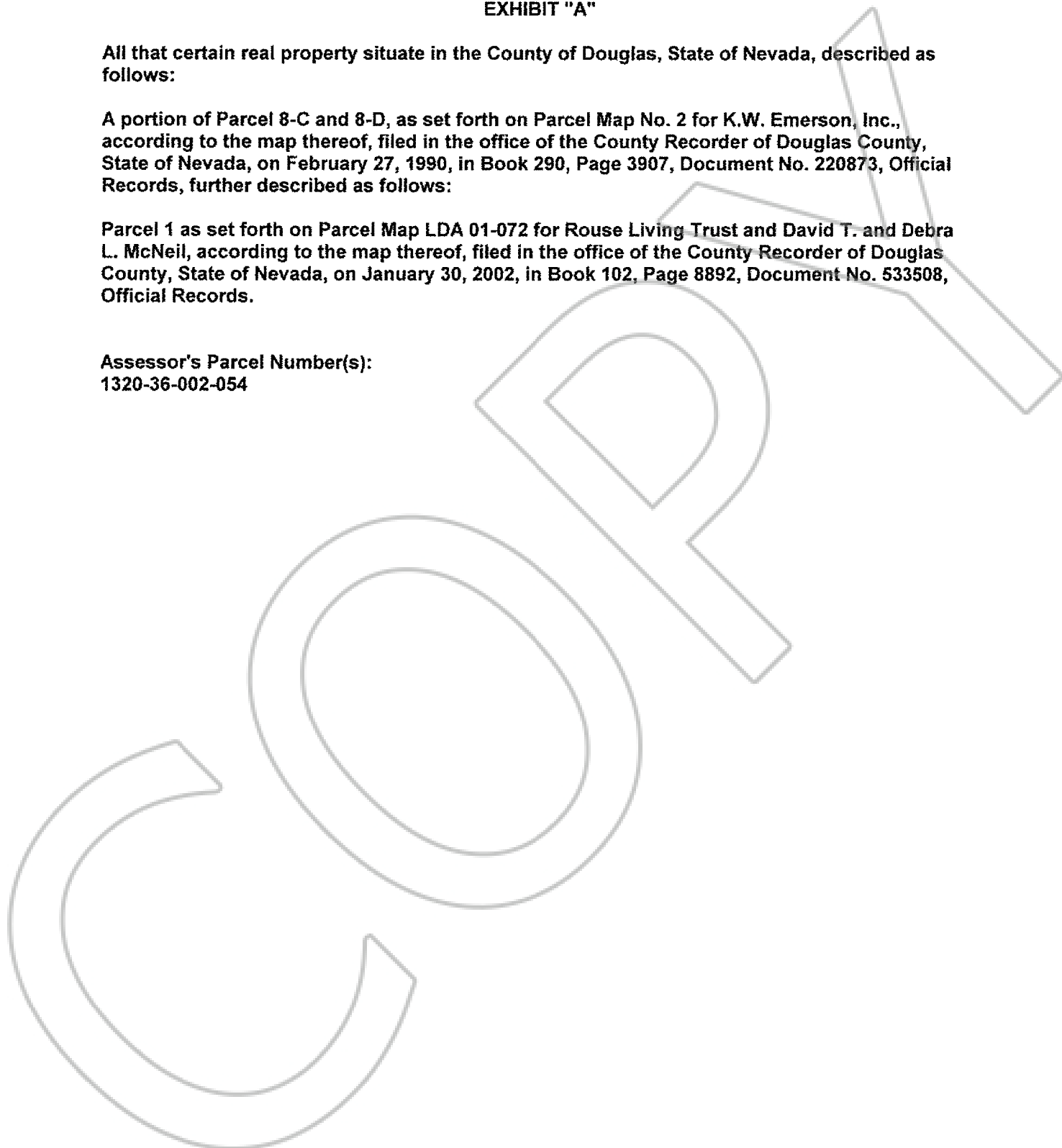

STATE OF NEVADA DECLARATION OF VALUE

1. Assessors Parcel Number(s)
a) 1320-36-002-054

2. Type of Property:
 a) Vacant Land
 c) Condo/Twnhse
 e) Apt. Bldg
 g) Agricultural
 i) Other _____
 b) Single Fam. Res.
 d) 2-4 Plex
 f) Comm' l/Ind'l
 h) Mobile Home

FOR RECORDERS OPTIONAL USE ONLY	
DOCUMENT/INSTRUMENT #:	_____
BOOK _____	PAGE _____
DATE OF RECORDING: _____	
NOTES: _____	

3. Total Value/Sales Price of Property: \$1,030,000.00
 Deed in Lieu of Foreclosure Only (value of property) (_____)
 Transfer Tax Value: \$1,030,000.00
 Real Property Transfer Tax Due: \$4,017.00

4. If Exemption Claimed:
 a. Transfer Tax Exemption per NRS 375.090, Section _____
 b. Explain Reason for Exemption: _____

5. Partial Interest: Percentage being transferred: 100 %

The undersigned declares and acknowledges, under penalty of perjury, pursuant to NRS 375.060 and NRS 375.110, that the information provided is correct to the best of their information and belief, and can be supported by documentation if called upon to substantiate the information provided herein. Furthermore, the parties agree that disallowance of any claimed exemption, or other determination of additional tax due, may result in a penalty of 10% of the tax due plus interest at 1% per month.

Pursuant to NRS 375.030, the Buyer and Seller shall be jointly and severally liable for any additional amount owed.

Signature _____ Capacity Escrow Agent
 Signature _____ Capacity _____

SELLER (GRANTOR) INFORMATION (REQUIRED)

BUYER (GRANTEE) INFORMATION (REQUIRED)

Print Name: Laurence M. Small and Evelyn E. Small
 Address: 1477 Meadow Vista Rd.
 City: Meadow Vista
 State: CA Zip: 95722

Print Name: Pierrugues-Chanu, LLC, a Nevada limited liability company
 Address: P.O. Box 2710
 City: Minden
 State: NV Zip: 89423

COMPANY/PERSON REQUESTING RECORDING

(required if not the seller or buyer)

Print Name: eTRCo, LLC. On behalf of Western Title Company
 Address: Douglas Office
1362 Highway 395, Ste. 109
 City/State/Zip: Gardnerville, NV 89410

Esc. #: 098501-WLD

(AS A PUBLIC RECORD THIS FORM MAY BE RECORDED/MICROFILMED)